

TEMPORARY 4 INCH WHITE LINE, PAINT
 DURABLE 4 INCH WHITE LINE (OPTION ITEM)
 N 491+50 TO N 493+65 SOLID LT
 N 491+50 TO N 493+33 SOLID RT
 N 494+18 TO N 494+38 SOLID LT (NO PARKING)
 N 494+18 TO N 494+39 SOLID RT (NO PARKING)
 N 494+38 TO N 494+99 SOLID LT (PARKING)
 N 494+39 TO N 495+46 SOLID RT (PARKING)
 N 495+34 TO N 495+95 SOLID LT (PARKING)
 N 495+46 TO N 495+79 SOLID RT (NO PARKING)
 N 495+76 TO N 496+82 SOLID RT (PARKING)
 N 496+21 TO N 496+62 SOLID LT (PARKING)
 N 496+62 TO N 496+72 SOLID LT (NO PARKING)
 N 496+79 TO N 497+01 SOLID RT (NO PARKING)
 N 497+31 TO N 479+50 SOLID RT (NO PARKING)
 N 497+32 TO N 479+50 SOLID LT (NO PARKING)
 US 302
 M 244+76 TO M 246+50 SOLID LT
 M 244+91 TO M 246+50 SOLID RT

TEMPORARY 4 INCH YELLOW LINE, PAINT
 DURABLE 4 INCH YELLOW LINE (OPTION ITEM)
 N 491+50 TO N 493+51 SOLID LT & RT
 N 494+25 TO N 496+76 SOLID LT & RT
 N 497+24 TO N 479+50 SOLID LT & RT
 US 302
 M 244+86 TO M 246+50 SOLID LT & RT

TEMPORARY 24 INCH STOP BAR, PAINT
 DURABLE 24 INCH STOP BAR (OPTION ITEM)
 US 302
 M 244+85 LT
 TEMPORARY LETTER OR SYMBOL, PAINT
 DURABLE LETTER OR SYMBOL (OPTION ITEM)
 N 495+45 RT ACCESSIBLE PARKING SYMBOL
 N 496+74 RT ACCESSIBLE PARKING SYMBOL
 US 302
 M 244+92 LT "STOP"

DETECTABLE WARNING SURFACE (DWS)
 N 493+24 RT N 494+15 LT
 N 493+90 LT N 497+12 LT
 N 494+06 RT N 497+20 LT
 N 494+14 LT N 497+20 RT

ADJUST ELEVATION OF VALVE BOX (NON-PART)
 N 494+05 RT

REMOVING SIGNS
 AS SHOWN - 36

ERECTING SALVAGED SIGNS
 AS SHOWN - 4

REHAB. DROP INLETS, CATCH BASINS,
 OR MANHOLES, CLASS I, CLASS II

N 492+63 RT
 N 493+10 LT
 N 493+25 RT
 N 493+96 LT
 N 494+53 RT
 N 494+95 LT
 N 495+71 LT
 N 495+75 RT
 N 496+24 LT
 N 496+67 RT
 N 497+47 LT

CHANGING ELEVATION
 OF SEWER MANHOLES (NON-PART)
 N 494+02 LT
 N 497+00 LT
 US 302
 M 245+96 RT

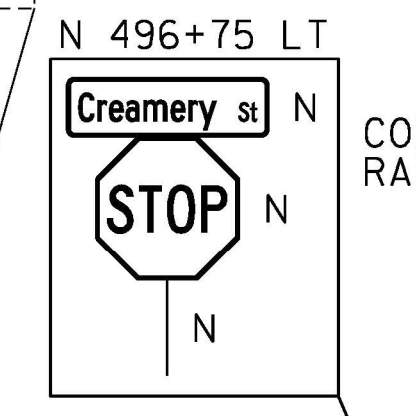
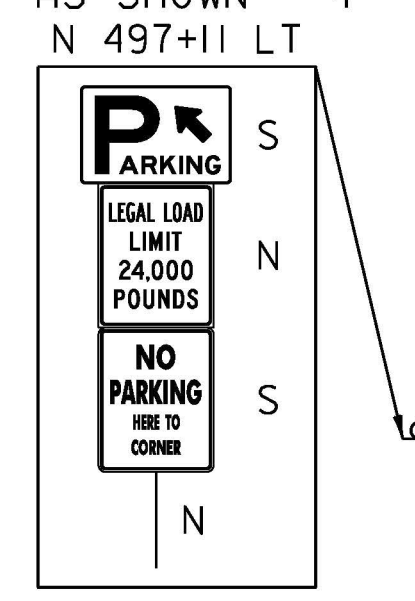
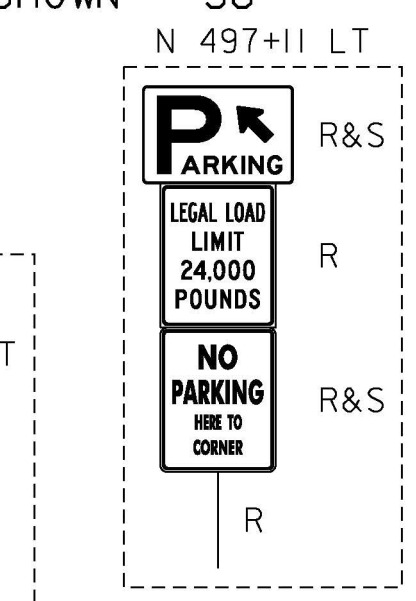

CONSTRUCT 12' X 6' CONCRETE
 RAMP TYPE 3 W/2 DWS
 CREAMERY ST
 TH 406
 N 496+96
 (MM 9.412)
 PAVED ROAD

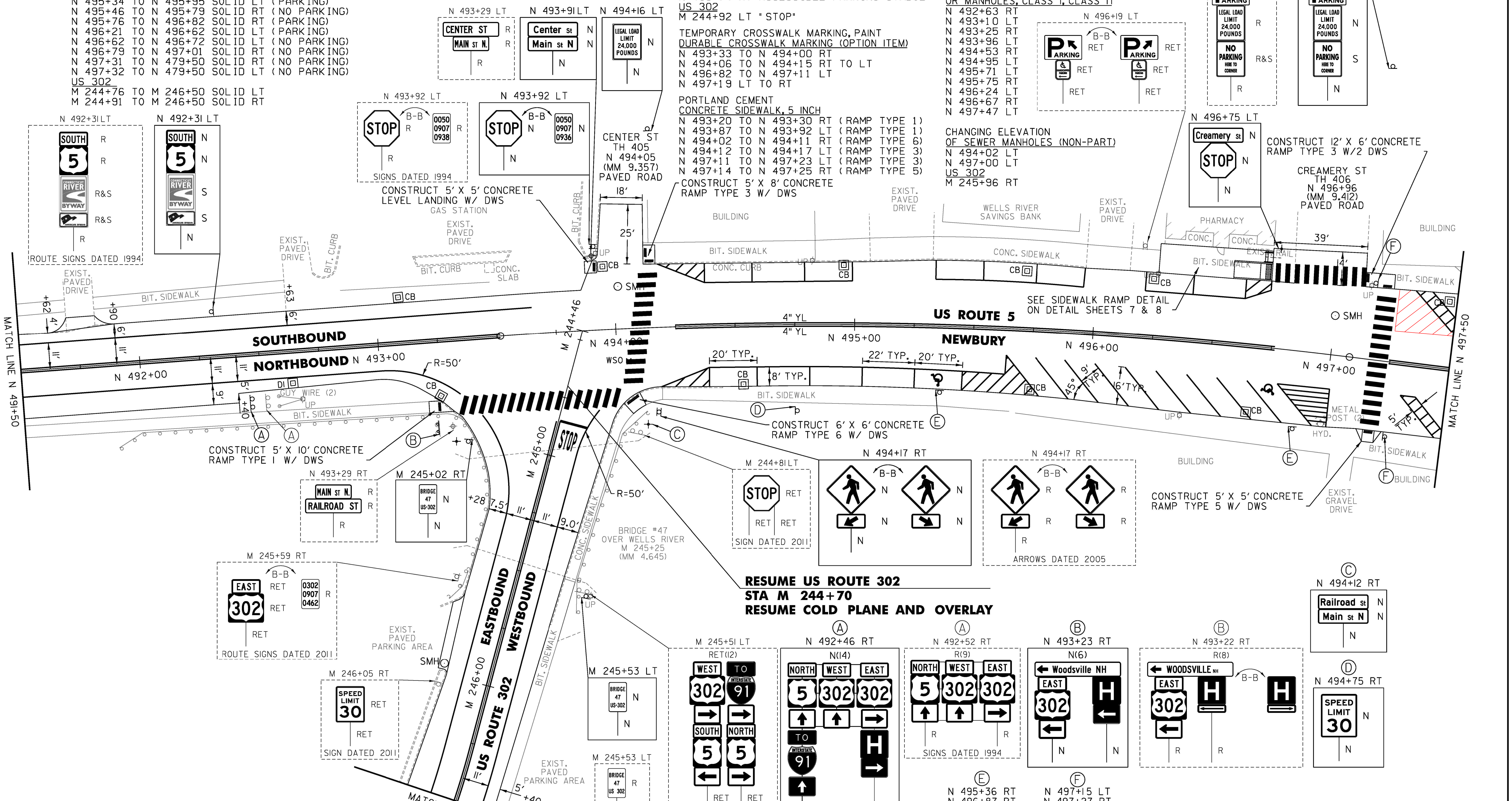

TEMPORARY CROSSWALK MARKING, PAINT
 DURABLE CROSSWALK MARKING (OPTION ITEM)
 N 493+33 TO N 494+00 RT
 N 494+06 TO N 494+15 RT TO LT
 N 496+82 TO N 497+11 LT
 N 497+19 LT TO RT

PORTLAND CEMENT
 CONCRETE SIDEWALK, 5 INCH
 N 493+20 TO N 493+30 RT (RAMP TYPE 1)
 N 493+87 TO N 493+92 LT (RAMP TYPE 1)
 N 494+02 TO N 494+11 RT (RAMP TYPE 6)
 N 494+12 TO N 494+17 LT (RAMP TYPE 3)
 N 497+11 TO N 497+23 LT (RAMP TYPE 5)
 N 497+14 TO N 497+25 RT (RAMP TYPE 5)

CONSTRUCT 5' X 8' CONCRETE
 RAMP TYPE 3 W/ DWS

CONSTRUCT 5' X 5' CONCRETE
 LEVEL LANDING W/ DWS
 GAS STATION

CONSTRUCT 6' X 6' CONCRETE
 RAMP TYPE 6 W/ DWS

CONSTRUCT 5' X 10' CONCRETE
 RAMP TYPE 1 W/ DWS

CONSTRUCT 5' X 5' CONCRETE
 RAMP TYPE 5 W/ DWS

CONSTRUCT 5' X 5' CONCRETE
 RAMP TYPE 5 W/ DWS

CONSTRUCT 5' X 5' CONCRETE
 RAMP TYPE 5 W/ DWS

CONSTRUCT 5' X 5' CONCRETE
 RAMP TYPE 5 W/ DWS

CONSTRUCT 5' X 5' CONCRETE
 RAMP TYPE 5 W/ DWS

CONSTRUCT 5' X 5' CONCRETE
 RAMP TYPE 5 W/ DWS

CONSTRUCT 5' X 5' CONCRETE
 RAMP TYPE 5 W/ DWS

CONSTRUCT 5' X 5' CONCRETE
 RAMP TYPE 5 W/ DWS

CONSTRUCT 5' X 5' CONCRETE
 RAMP TYPE 5 W/ DWS

CONSTRUCT 5' X 5' CONCRETE
 RAMP TYPE 5 W/ DWS

CONSTRUCT 5' X 5' CONCRETE
 RAMP TYPE 5 W/ DWS

CONSTRUCT 5' X 5' CONCRETE
 RAMP TYPE 5 W/ DWS

CONSTRUCT 5' X 5' CONCRETE
 RAMP TYPE 5 W/ DWS

CONSTRUCT 5' X 5' CONCRETE
 RAMP TYPE 5 W/ DWS

CONSTRUCT 5' X 5' CONCRETE
 RAMP TYPE 5 W/ DWS

CONSTRUCT 5' X 5' CONCRETE
 RAMP TYPE 5 W/ DWS

CONSTRUCT 5' X 5' CONCRETE
 RAMP TYPE 5 W/ DWS

CONSTRUCT 5' X 5' CONCRETE
 RAMP TYPE 5 W/ DWS

CONSTRUCT 5' X 5' CONCRETE
 RAMP TYPE 5 W/ DWS

CONSTRUCT 5' X 5' CONCRETE
 RAMP TYPE 5 W/ DWS

CONSTRUCT 5' X 5' CONCRETE
 RAMP TYPE 5 W/ DWS

CONSTRUCT 5' X 5' CONCRETE
 RAMP TYPE 5 W/ DWS

CONSTRUCT 5' X 5' CONCRETE
 RAMP TYPE 5 W/ DWS

CONSTRUCT 5' X 5' CONCRETE
 RAMP TYPE 5 W/ DWS

CONSTRUCT 5' X 5' CONCRETE
 RAMP TYPE 5 W/ DWS

CONSTRUCT 5' X 5' CONCRETE
 RAMP TYPE 5 W/ DWS

CONSTRUCT 5' X 5' CONCRETE
 RAMP TYPE 5 W/ DWS

**RESUME US ROUTE 302
 STA M 244+70
 RESUME COLD PLANE AND OVERLAY**

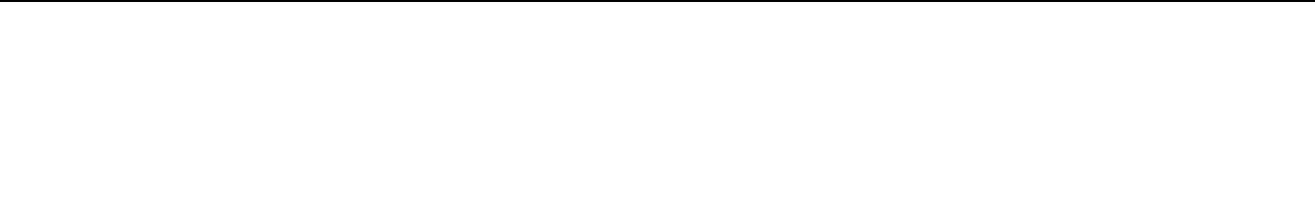
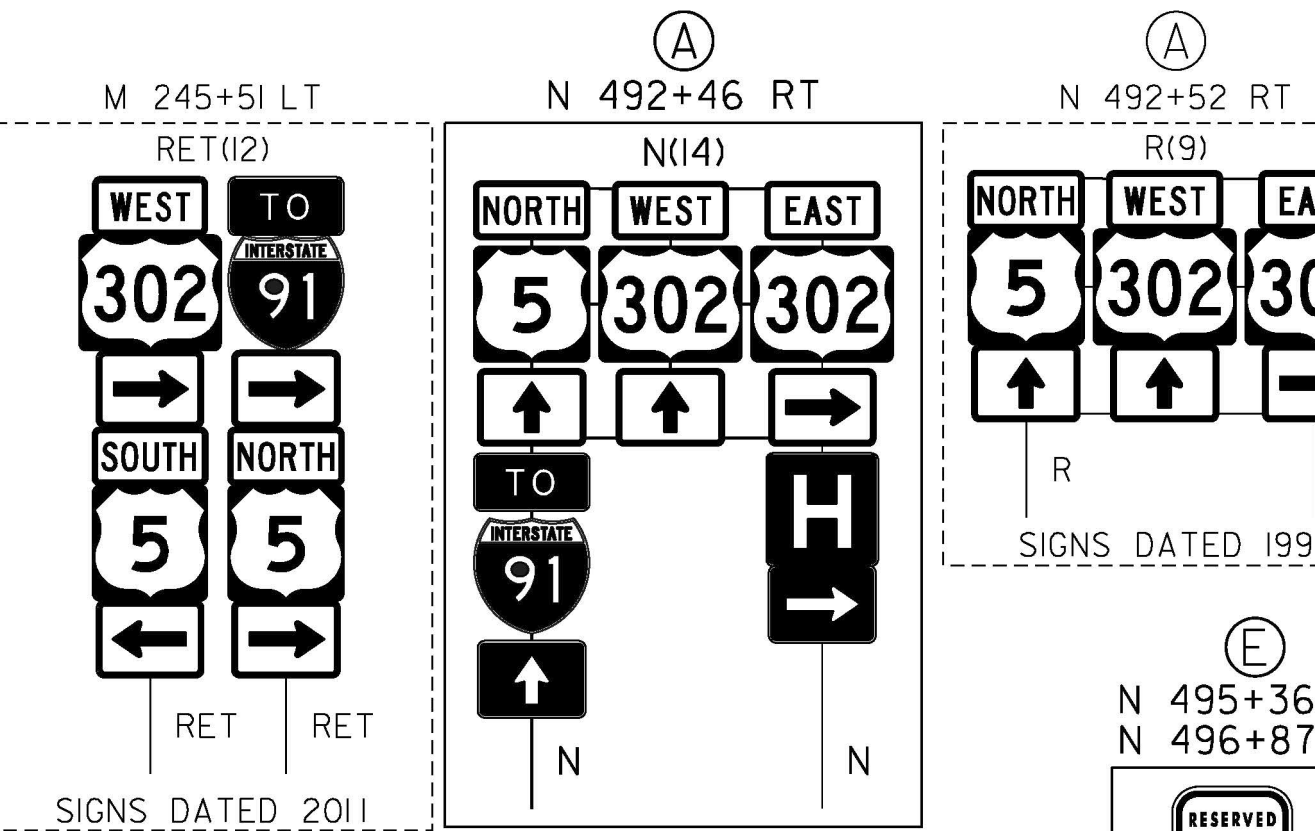

PROJECT NAME: BRADFORD-RYEGATE
 PROJECT NUMBER: STP 2929(I)
 FILE NAME: z10c264bdr.dgn
 PROJECT LEADER: P. SHEDD
 DESIGNED BY: N. LEMAY
 US 5 PLAN SHEET I23
 PLOT DATE: 2/4/2016
 DRAWN BY: W. GORDON
 CHECKED BY: P. SHEDD
 SHEET 181 OF 239

NOT TO SCALE

CLD 14-0278