

PORTLAND CEMENT CONCRETE SIDEWALK, 5 INCH  
 N 496+26 TO N 496+72 LT  
 VERTICAL GRANITE CURB  
 N 496+57 TO N 496+72 LT  
 N 496+57 TO N 496+72 LT (BACK CURB)  
 N 496+69 TO N 496+72 LT (BACK CURB)  
 N 496+72 TO N 496+72 LT (FLUSH MOUNTED)

DETECTABLE WARNING SURFACE  
 N 496+70 LT  
 SPECIAL PROVISION (PEDESTRIAN HAND RAILING)  
 N 496+68 TO N 496+72 LT  
 N 496+68 TO N 496+72 LT

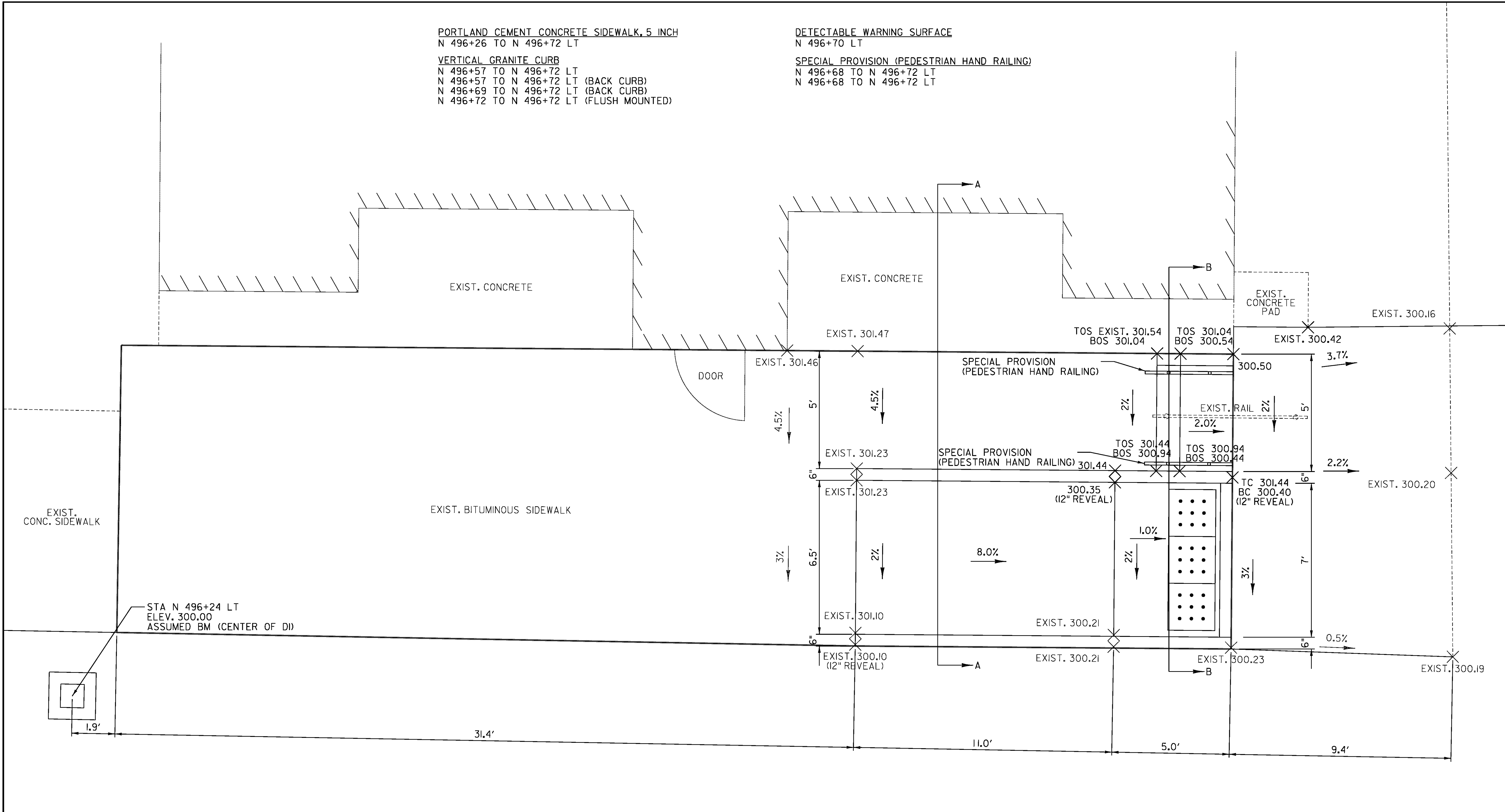

STA N 496+24 LT  
 ELEV. 300.00  
 ASSUMED BM (CENTER OF DI)

**US ROUTE 5 / CREAMERY STREET ADA SIDEWALK RAMP DETAIL**

SEE DETAIL SHEET 8 FOR SECTION A-A & B-B



PROJECT NAME:	BRADFORD-RYEGATE
PROJECT NUMBER:	STP 2929(I)
FILE NAME:	z10c264frm.dgn
PROJECT LEADER:	P. SHEDD
DESIGNED BY:	N. LEMAY
DETAIL SHEET	7
PLOT DATE:	2/4/2016
DRAWN BY:	W. GORDON
CHECKED BY:	P. SHEDD
SHEET	36 OF 239

CLD 14-0278