

GPS CONTROL POINTS

HVCTRL #1

PLACEY

NORTH = 571735.2000  
EAST = 1755957.6700  
ELEV. = 504.100

HVCTRL #2

VTNH BRM 34

NORTH = 571534.2966  
EAST = 1758165.1480  
ELEV. = 405.320

NEWBURY, VT.

IT IS 0.3 MI SOUTH OF NEWBURY CROSSING ROAD. THE MARK IS SET IN THE TOP OF THE SOUTHEAST END OF A MASSIVE ROCK OUTCROP. IT IS 43.3 M NORTHWEST OF AND ABOUT 9 M HIGHER THAN THE CENTERLINE OF US ROUTE 5, 30.7 M NORTH OF A FENCE CORNER AT THE EAST CORNER OF SMALL FENCED-IN FIELD, 44.7 M SOUTHWEST OF THE WEST CORNER OF A GARAGE, AND 18.2 M SSW OF THE EAST CORNER OF A 1.2 M X 1.4 M CEMENT BLOCK BARBEQUE GRILLE.

AT THE HAVERHILL BRIDGE FISHING ACCESS IN NEWBURY, VT.

THE MARK IS A 12.5 CM DIAMETER USSC REFERENCE MARK DISK SET IN THE TOP OF A 25 CM SQUARE GRANITE MONUMENT WHICH PROJECTS ABOUT 0.1 M ABOVE GROUND SURFACE. IT IS 2.5 M NE OF AND ABOUT 0.1 M HIGHER THAN THE CENTERLINE OF A GRAVEL DRIVE, 3.4 M SW OF A WIRE FENCE, 7.5 M NORTH OF THE MOST SOUTHERLY GUARD RAIL POST AT THE SE CORNER OF A PARKING AREA, AND 70.3 M SE OF THE CENTER OF THE NE (INLET) END OF A 50 CM DIAMETER METAL CULVERT.

TRAVERSE TIES

HVCTRL #3

NORTH = 572285.8570  
EAST = 1757274.1983  
ELEV. = 406.824

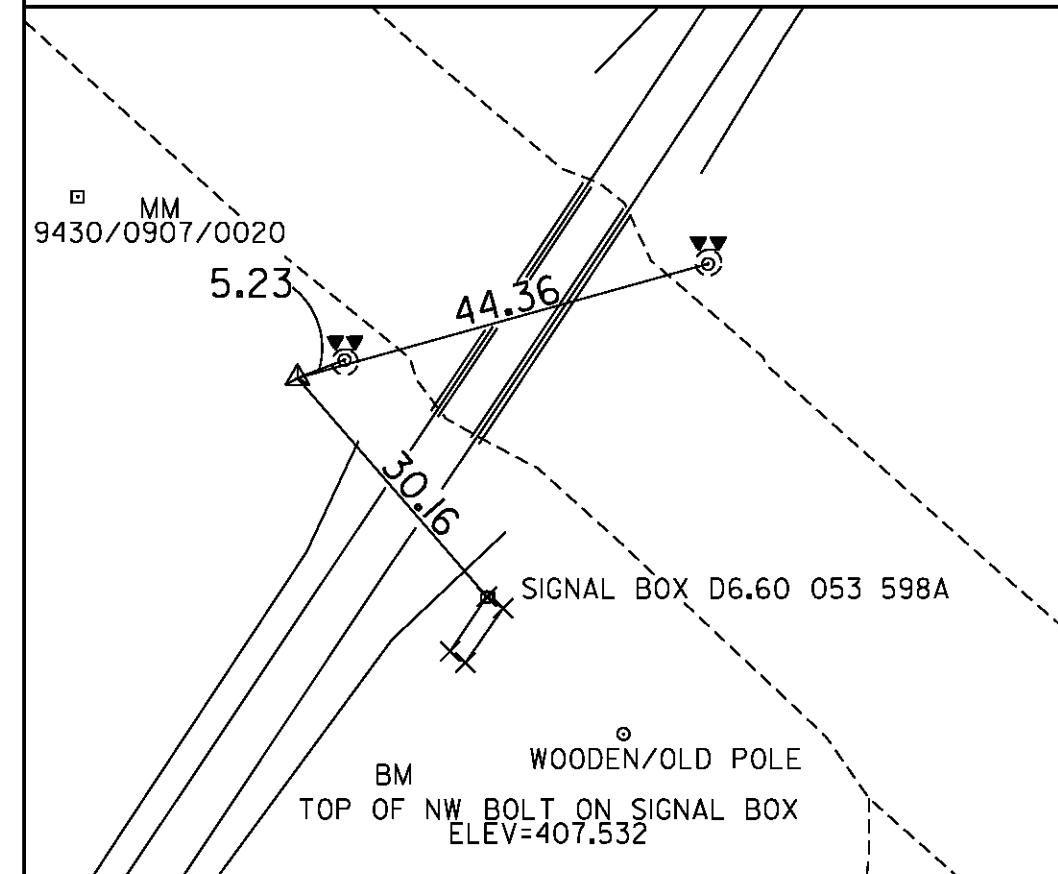

HVCTRL #4

NORTH = 571677.0099  
EAST = 1756119.4953  
ELEV. = 479.578

NOT TIED

NORTH =  
EAST =  
ELEV. =

NORTH =  
EAST =  
ELEV. =

NORTH =  
EAST =  
ELEV. =

ALIGNMENT TIES

NORTH =  
EAST =  
ELEV. =

NORTH =  
EAST =  
ELEV. =

NORTH =  
EAST =  
ELEV. =

NORTH =  
EAST =  
ELEV. =

NORTH =  
EAST =  
ELEV. =

DATUM	
VERTICAL	NAVD88
HORIZONTAL	NAD83(2011)
ADJUSTMENT	COMPASS

PROJECT NAME:	BRADFORD-RYEGATE	
PROJECT NUMBER:	STP 2929(I)	
FILE NAME:	xI0c264+1	PLOT DATE: 2/4/2016
PROJECT LEADER:	BRANDON KIPP	DRAWN BY: C. CYR
DESIGNED BY:	VTrans	CHECKED BY: P. BEYOR
TIE SHEET I		SHEET 4 OF 239

CLD 14-0278