

MILLED RUMBLE STRIPS
STA. 26+00 TO 31+00, LT

RELOCATE MAILBOX, MULTIPLE SUPPORT
STA. 29+78, RT

STEEL BEAM GUARDRAIL, GALVANIZED
STA. 26+00.0 TO 26+16.5, RT

ANCHOR FOR STEEL BEAM RAIL
STA. 26+16.5, RT

REMOVAL AND DISPOSAL OF GUARDRAIL
STA. 26+00.0 TO 26+16.5, RT

DURABLE & TEMPORARY 4 INCH WHITE LINE
(ALL LINES WILL INCLUDE EDGE LINE BREAKS
AND RADIUS FOR SIDE ROADS)
STA. 26+00 TO 31+00, SOLID LT & RT
STA. 26+00 TO 31+00, DASHED RT (LANE LINE)

DURABLE & TEMPORARY 4 INCH YELLOW LINE
(ALL LINES WILL INCLUDE $\frac{1}{2}$ BREAKS FOR SIDE ROADS)
STA. 26+00 TO 31+00, DOUBLE SOLID LT

REMOVING SIGNS
AS SHOWN - 2

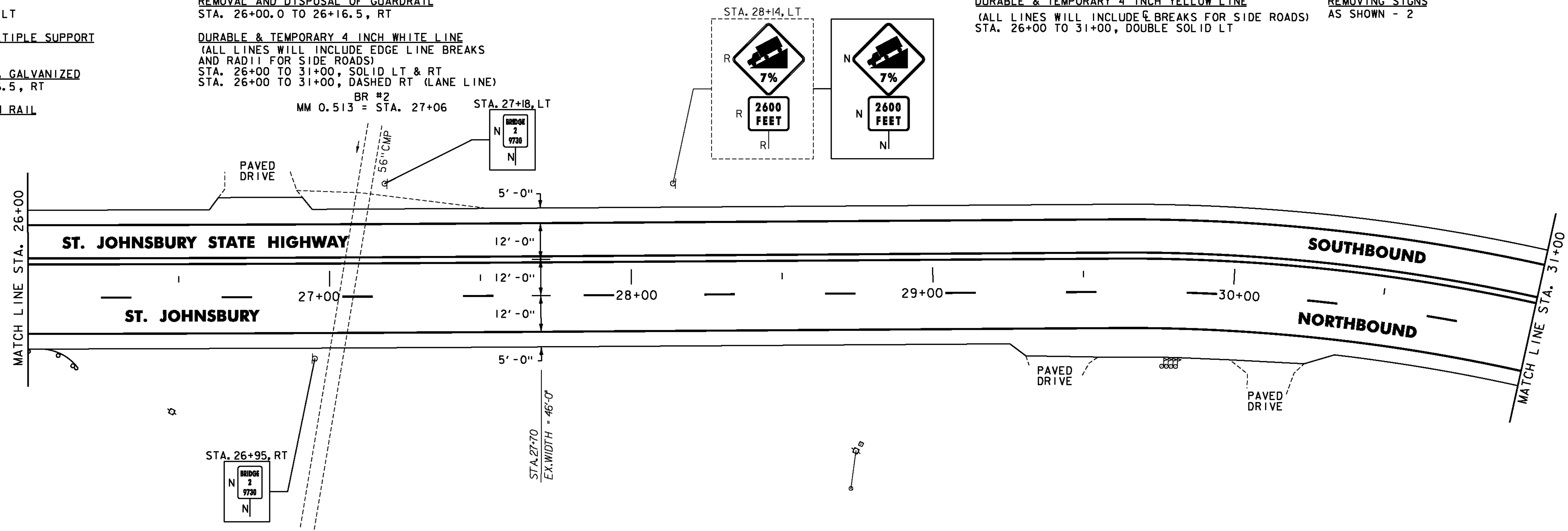

MILLED RUMBLE STRIPS
STA. 31+00 TO 35+00, LT
(BREAK FOR SIDE ROADS PER
DETAIL ON SHEET 27)

DURABLE & TEMPORARY 4 INCH WHITE LINE
(ALL LINES WILL INCLUDE EDGE LINE BREAKS
AND RADIUS FOR SIDE ROADS)
STA. 31+00 TO 35+00, SOLID LT & RT
STA. 31+00 TO 35+00, DASHED RT (LANE LINE)
STA. 33+12, SOLID RT (EDGE LINES, DEPOT HILL ROAD TH-85)

DURABLE & TEMPORARY 4 INCH YELLOW LINE
(ALL LINES WILL INCLUDE $\frac{1}{2}$ BREAKS FOR SIDE ROADS)
STA. 31+00 TO 35+00, DOUBLE SOLID LT
STA. 33+12, DOUBLE SOLID RT (DEPOT HILL ROAD TH-85)

DURABLE & TEMPORARY 24 INCH STOP BAR
STA. 33+12, RT (DEPOT HILL ROAD TH-85)

DURABLE & TEMPORARY LETTER OR SYMBOL
STA. 33+12, RT (DEPOT HILL ROAD TH-85) "STOP"

REMOVING SIGNS
AS SHOWN - 7

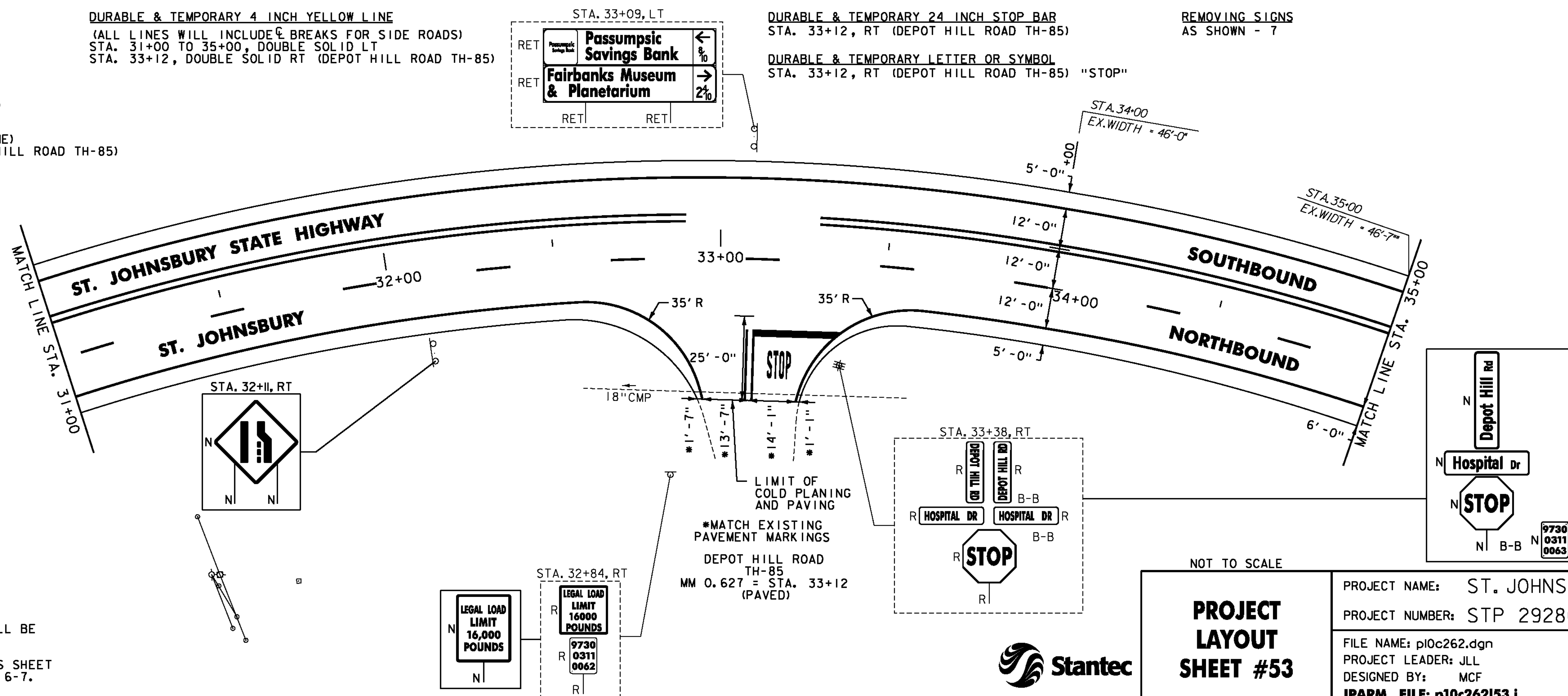

- NOTES:
- FOR LEGENDS, SEE SHEET 33.
 - ALL EXISTING SIGNS NOT SHOWN SHALL BE RETAINED.
 - DURABLE MARKINGS DETAILED ON THIS SHEET ARE OPTION BID ITEMS. SEE SHEETS 6-7.

NOT TO SCALE

PROJECT LAYOUT SHEET #53

PROJECT NAME: ST. JOHNSBURY-LYNDON

PROJECT NUMBER: STP 2928(I)

FILE NAME: p10c262.dgn

PROJECT LEADER: JLL

DESIGNED BY: MCF

IPARM FILE: p10c262153.i

PLOT DATE: 10/17/2013

DRAWN BY: STANTEC

CHECKED BY: JLL

SHEET 85 OF 133

