

MILLED RUMBLE STRIPS
STA. 1+00 TO 6+00, LT

REHAB. Dis. CBs OR MHS, CLASS 1 OR 11
STA. 3+22, RT
STA. 3+24, LT

TREATED TIMBER CURB
STA. 3+14.5 TO 3+94.5, LT
STA. 3+18.0 TO 3+81.0, RT

STEEL BEAM GUARDRAIL, GALVANIZED
STA. 2+18.0 TO 3+56.0, RT
STA. 2+45.0 TO 3+69.5, LT

TERMINAL CONNECTOR FOR STEEL BEAM GUARDRAIL
STA. 3+56 TO 3+81, RT
STA. 3+69.5 TO 3+94.5, LT
FOR DETAIL, SEE SHEET 19

ANCHOR FOR STEEL BEAM RAIL
STA. 2+18.0, RT
STA. 2+45.0, LT

REMOVAL AND DISPOSAL OF GUARDRAIL
STA. 2+18.0 TO 3+81.0, RT
STA. 2+45.0 TO 3+94.5, LT

DURABLE & TEMPORARY 4 INCH WHITE LINE
(ALL LINES WILL INCLUDE EDGE LINE BREAKS AND RADII FOR SIDE ROADS)
STA. 1+00 TO 6+00, SOLID LT & RT
STA. 1+00 TO 6+00, DASHED RT (LANE LINE)
STA. 1+00 TO 1+30, SOLID LT (LANE LINE)

DURABLE & TEMPORARY LETTER OR SYMBOL
STA. 1+26, LT ARROW (3)

REMOVING SIGNS
AS SHOWN - 22

DURABLE & TEMPORARY 4 INCH YELLOW LINE
(ALL LINES WILL INCLUDE $\frac{1}{2}$ BREAKS FOR SIDE ROADS)
STA. 1+00 TO 6+00, DOUBLE SOLID LT

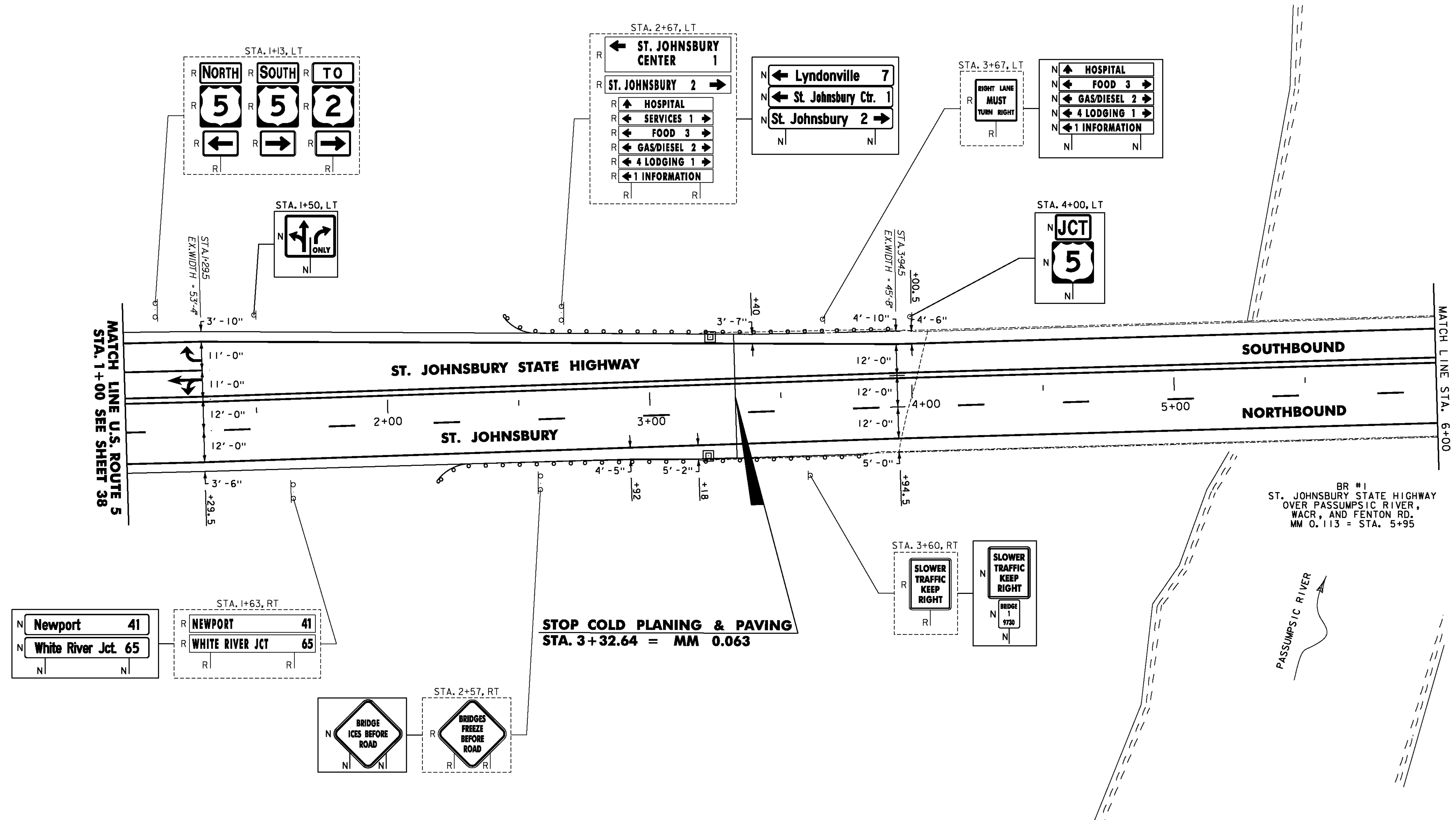

- NOTES:
- FOR LEGENDS, SEE SHEET 33.
 - ALL EXISTING SIGNS NOT SHOWN SHALL BE RETAINED.
 - DURABLE MARKINGS DETAILED ON THIS SHEET ARE OPTION BID ITEMS. SEE SHEETS 6-7.



NOT TO SCALE

PROJECT LAYOUT SHEET #49

PROJECT NAME: ST. JOHNSBURY-LYNDON	PLOT DATE: 10/17/2013
PROJECT NUMBER: STP 2928(I)	DRAWN BY: STANTEC
FILE NAME: p10c262.dgn	CHECKED BY: JLL
PROJECT LEADER: JLL	SHEET 81 OF 133
DESIGNED BY: MCF	
IPARM FILE: p10c262149.i	