

MILLED RUMBLE STRIPS
STA. 5+00 TO 10+00, ☉
(BREAK FOR SIDE ROADS PER
DETAIL ON SHEET 27)

DURABLE & TEMPORARY 4 INCH WHITE LINE
(ALL LINES WILL INCLUDE EDGE LINE BREAKS
AND RADII FOR SIDE ROADS)
STA. 5+00 TO 10+00, SOLID LT & RT

DURABLE & TEMPORARY 4 INCH YELLOW LINE
(ALL LINES WILL INCLUDE ☉ BREAKS FOR SIDE ROADS)
STA. 5+00 TO 10+00, SOLID LT & RT
STA. 8+08, DOUBLE SOLID RT (GREAT FALLS ROAD TH-67)

DURABLE & TEMPORARY 24 INCH STOP BAR
STA. 8+08, RT (GREAT FALLS ROAD TH-67)

DURABLE & TEMPORARY LETTER OR SYMBOL
STA. 8+08, RT (GREAT FALLS ROAD TH-67) "STOP"

REMOVING SIGNS
AS SHOWN - 5

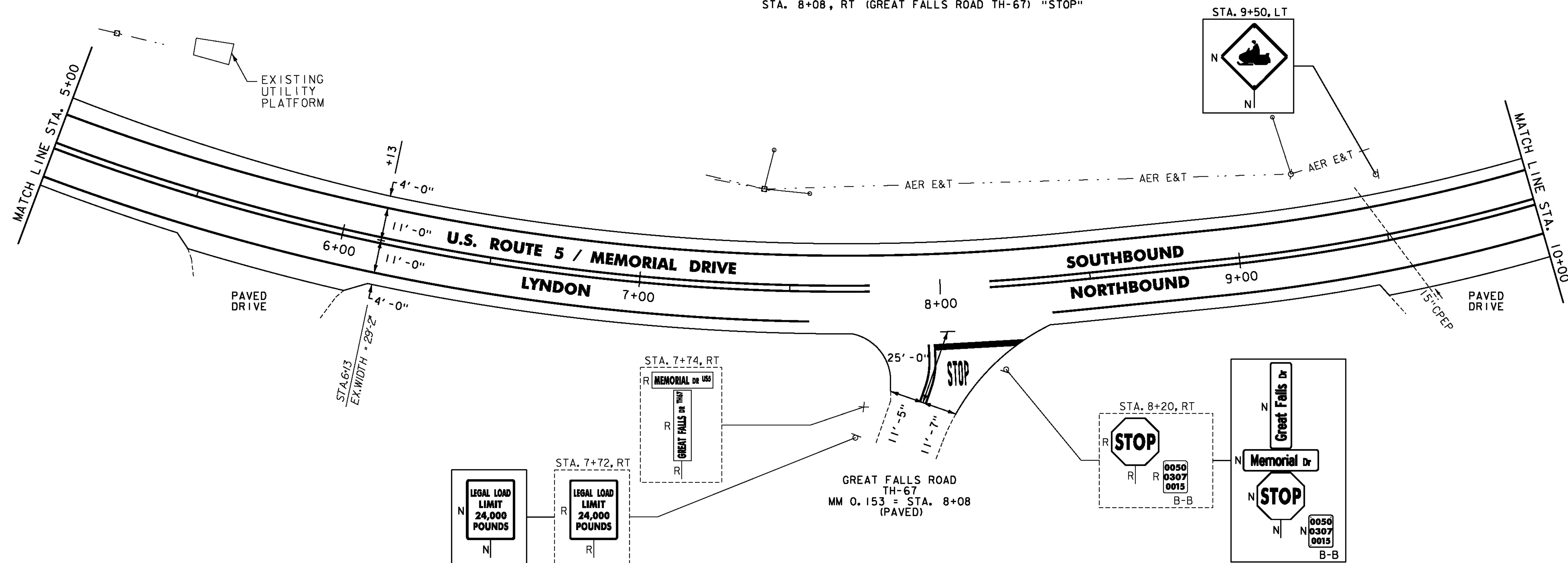

MILLED RUMBLE STRIPS
STA. 10+00 TO 15+00, ☉

DURABLE & TEMPORARY 4 INCH WHITE LINE
(ALL LINES WILL INCLUDE EDGE LINE BREAKS
AND RADII FOR SIDE ROADS)
STA. 10+00 TO 15+00, SOLID LT & RT

DURABLE & TEMPORARY 4 INCH YELLOW LINE
(ALL LINES WILL INCLUDE ☉ BREAKS FOR SIDE ROADS)
STA. 10+00 TO 15+00, SOLID LT & RT

REMOVING SIGNS
AS SHOWN - 2

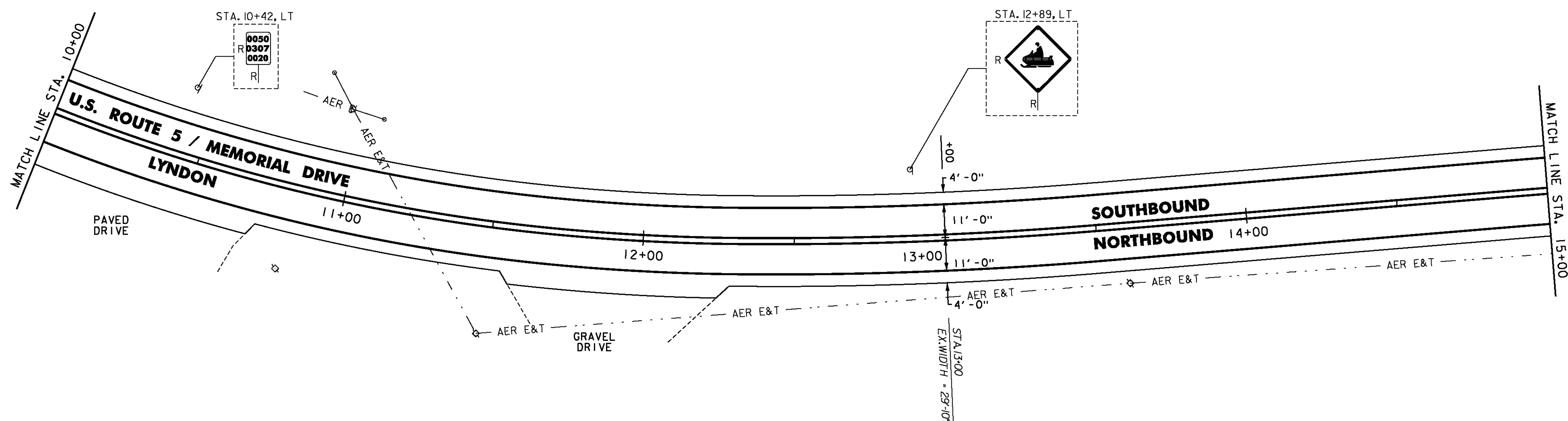

NOTES:

1. FOR LEGENDS, SEE SHEET 33.
2. ALL EXISTING SIGNS NOT SHOWN SHALL BE RETAINED.
3. DURABLE MARKINGS DETAILED ON THIS SHEET ARE OPTION BID ITEMS. SEE SHEETS 6-7.

NOT TO SCALE



**PROJECT
LAYOUT
SHEET #31**

PROJECT NAME: ST. JOHNSBURY-LYNDON

PROJECT NUMBER: STP 2928(I)

FILE NAME: p10c262.dgn

PROJECT LEADER: JLL

DESIGNED BY: MCF

IPARM FILE: p10c262i31.i

PLOT DATE: 10/17/2013

DRAWN BY: STANTEC

CHECKED BY: JLL

SHEET 63 OF 133