

RELOCATE MAILBOX, SINGLE SUPPORT  
STA. 243+66, LT

REHAB. Dis. CBS OR MHS, CLASS I OR II  
STA. 243+65, LT

CHANGING ELEVATION OF SEWER MANHOLES  
STA. 241+51, RT  
STA. 242+58, RT

PORTLAND CEMENT CONCRETE  
SIDEWALK, 5 INCH  
STA. 242+53, RT  
STA. 242+75, RT

DETECTABLE WARNING SURFACE  
STA. 242+53, RT  
STA. 242+75, RT

ADJUST ELEVATION OF VALVE BOX  
STA. 242+67, RT  
STA. 242+72, RT

DURABLE & TEMPORARY 4 INCH WHITE LINE  
(ALL LINES WILL INCLUDE EDGE LINE BREAKS  
AND RADII FOR SIDE ROADS)  
STA. 240+00 TO 245+00, SOLID LT & RT

DURABLE & TEMPORARY 4 INCH YELLOW LINE  
(ALL LINES WILL INCLUDE  $\frac{1}{2}$  BREAKS FOR SIDE ROADS)  
STA. 240+00 TO 245+00, SOLID LT & RT

DURABLE & TEMPORARY 8 INCH WHITE LINE  
STA. 242+75 TO 242+81, RT (HYDRANT)  
SEE DETAIL ON SHEET 29

DURABLE & TEMPORARY CROSSWALK MARKING  
STA. 242+65, RT (SANGER CIRCLE TH-50)  
SEE SHEET 29 (TYPICAL)

REMOVING SIGNS  
AS SHOWN - 6

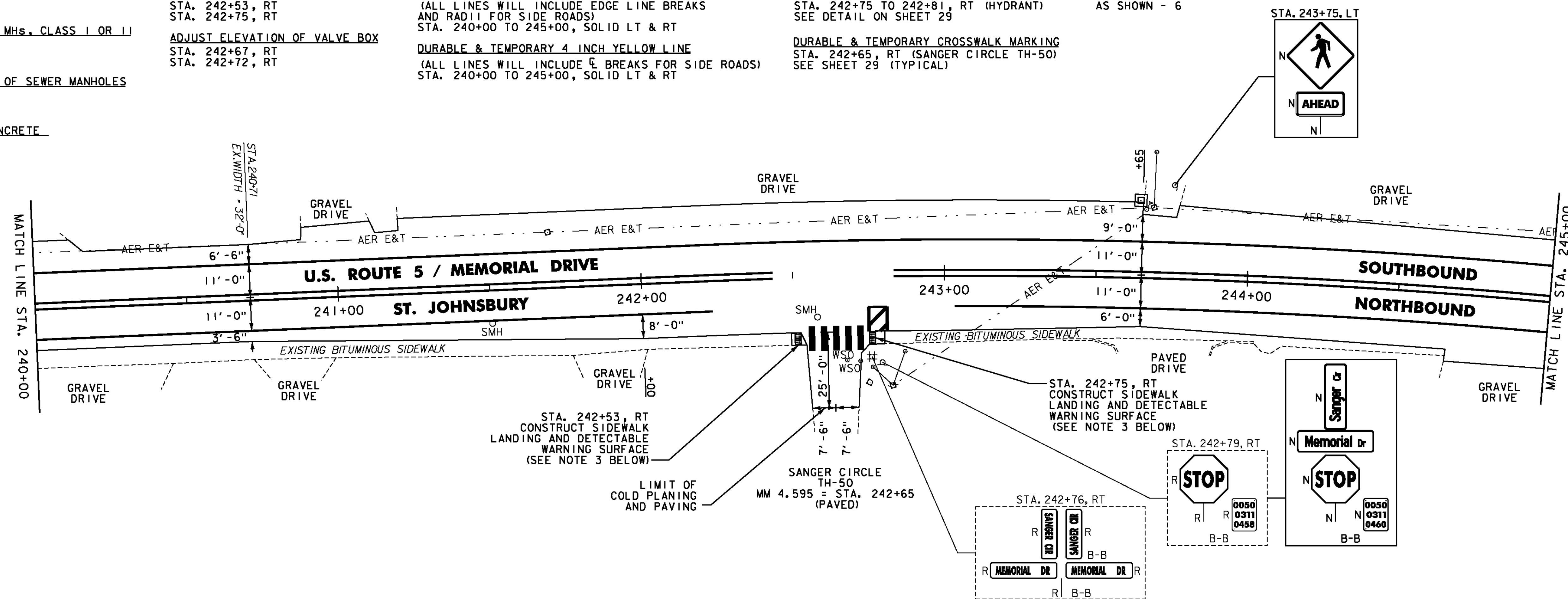

STEEL BEAM GUARDRAIL, GALVANIZED  
STA. 247+02 TO 250+00, LT

ANCHOR FOR STEEL BEAM RAIL  
STA. 247+02, LT

REMOVAL AND DISPOSAL OF GUARDRAIL  
STA. 247+02 TO 250+00, LT

DURABLE & TEMPORARY 4 INCH WHITE LINE  
(ALL LINES WILL INCLUDE EDGE LINE BREAKS  
AND RADII FOR SIDE ROADS)  
STA. 245+00 TO 250+00, SOLID LT & RT

DURABLE & TEMPORARY 4 INCH YELLOW LINE  
(ALL LINES WILL INCLUDE  $\frac{1}{2}$  BREAKS FOR SIDE ROADS)  
STA. 245+00 TO 250+00, SOLID LT & RT

REMOVING SIGNS  
AS SHOWN - 4

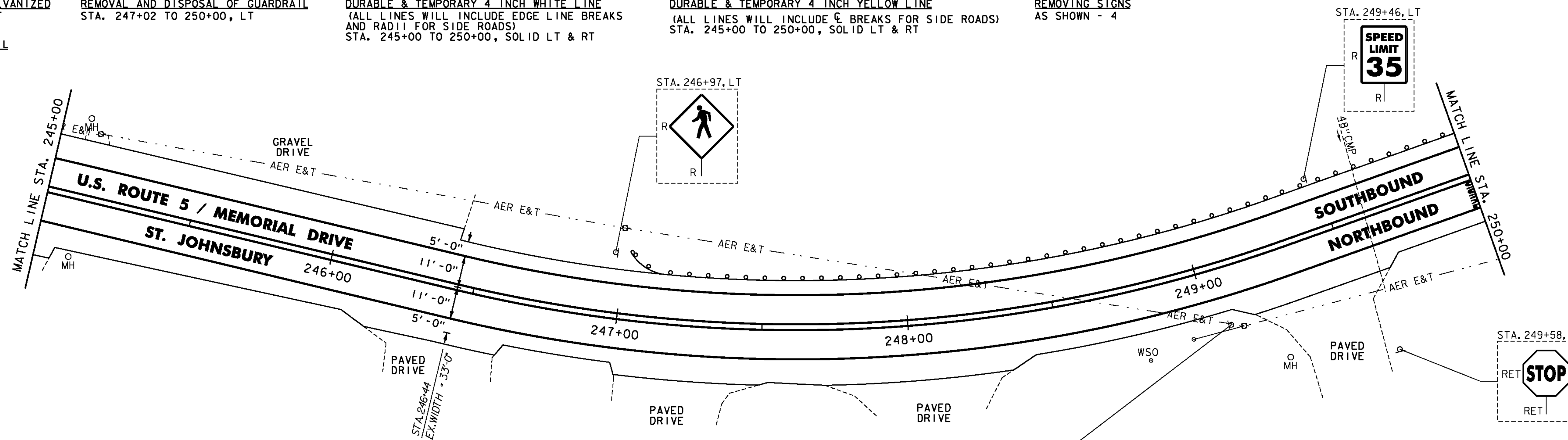

NOTES:

- FOR LEGENDS, SEE SHEET 33.
- ALL EXISTING SIGNS NOT SHOWN SHALL BE RETAINED.
- THE SIDEWALK "LANDINGS" NOTED CONSIST OF REMOVAL OF EXISTING CONCRETE AND SIDEWALK AS SHOWN AND REPLACING IT WITH NEW SUBBASE, CONCRETE AND DETECTABLE WARNING SURFACE.
- DURABLE MARKINGS DETAILED ON THIS SHEET ARE OPTION BID ITEMS. SEE SHEETS 6-7.

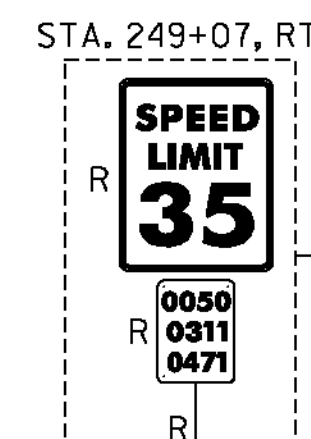
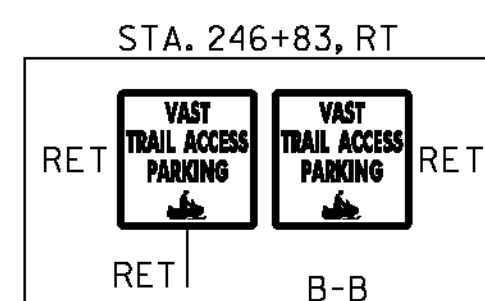

NOT TO SCALE

PROJECT LAYOUT SHEET #12



PROJECT NAME: ST. JOHNSBURY-LYNDON

PROJECT NUMBER: STP 2928(I)

FILE NAME: p10c262.dgn  
PROJECT LEADER: JLL  
DESIGNED BY: MCF  
IPARM FILE: p10c262I12.i

PLOT DATE: 10/17/2013  
DRAWN BY: STANTEC  
CHECKED BY: JLL  
SHEET 44 OF 133