

REHAB. DIS. CBS OR MHS. CLASS I OR II
 STA. 234+69, RT
 STA. 237+97, RT
 STA. 237+99, LT
 STA. 238+95, RT

CHANGING ELEVATION OF SEWER MANHOLES
 STA. 239+16, RT

CAST-IN-PLACE CONCRETE CURB, TYPE B
 STA. 237+96, RT

REMOVAL OF EXISTING CURB
 STA. 237+96, RT

PORTLAND CEMENT CONCRETE
 SIDEWALK, 5 INCH
 STA. 236+83, RT
 STA. 237+96, RT
 STA. 238+54, RT

DETECTABLE WARNING SURFACE
 STA. 236+83, RT
 STA. 237+96, RT
 STA. 238+54, RT

STEEL BEAM GUARDRAIL, GALVANIZED
 STA. 234+71 TO 234+95, RT
 STA. 234+72 TO 234+95.5, LT

ANCHOR FOR STEEL BEAM RAIL
 STA. 234+71, RT
 STA. 234+72, LT
 STA. 234+95, RT
 STA. 234+95.5, LT

REMOVAL AND DISPOSAL OF GUARDRAIL
 STA. 234+71 TO 234+95, RT
 STA. 234+72 TO 234+95.5, LT

ADJUST ELEVATION OF VALVE BOX
 STA. 238+39, RT
 STA. 238+40, RT

DURABLE & TEMPORARY 4 INCH WHITE LINE
 (ALL LINES WILL INCLUDE EDGE LINE BREAKS
 AND RADII FOR SIDE ROADS)
 STA. 234+50 TO 240+00, SOLID LT & RT
 STA. 235+36, SOLID RT (EDGE LINES, ROBERTS BROOK LANE TH-34)
 STA. 238+23, SOLID RT (EDGE LINES, BREEZY HILL ROAD TH-6)

DURABLE & TEMPORARY 4 INCH YELLOW LINE
 (ALL LINES WILL INCLUDE 1/2" BREAKS FOR SIDE ROADS)
 STA. 234+50 TO 240+00, SOLID LT & RT
 STA. 235+36, DOUBLE SOLID RT (ROBERTS BROOK LANE TH-34)
 STA. 238+23, DOUBLE SOLID RT (BREEZY HILL ROAD TH-6)

DURABLE & TEMPORARY 24 INCH STOP BAR
 STA. 235+36, RT (ROBERTS BROOK LANE TH-34)
 STA. 238+23, RT (BREEZY HILL ROAD TH-6)

DURABLE & TEMPORARY LETTER OR SYMBOL
 STA. 235+36, RT (ROBERTS BROOK LANE TH-34) "STOP"
 STA. 238+23, RT (BREEZY HILL ROAD TH-6) "STOP"

DURABLE & TEMPORARY CROSSWALK MARKING
 STA. 236+83, LT-RT
 STA. 238+23, RT (BREEZY HILL ROAD TH-34)
 SEE SHEET 29 (TYPICAL)

REMOVING SIGNS
 AS SHOWN - 20

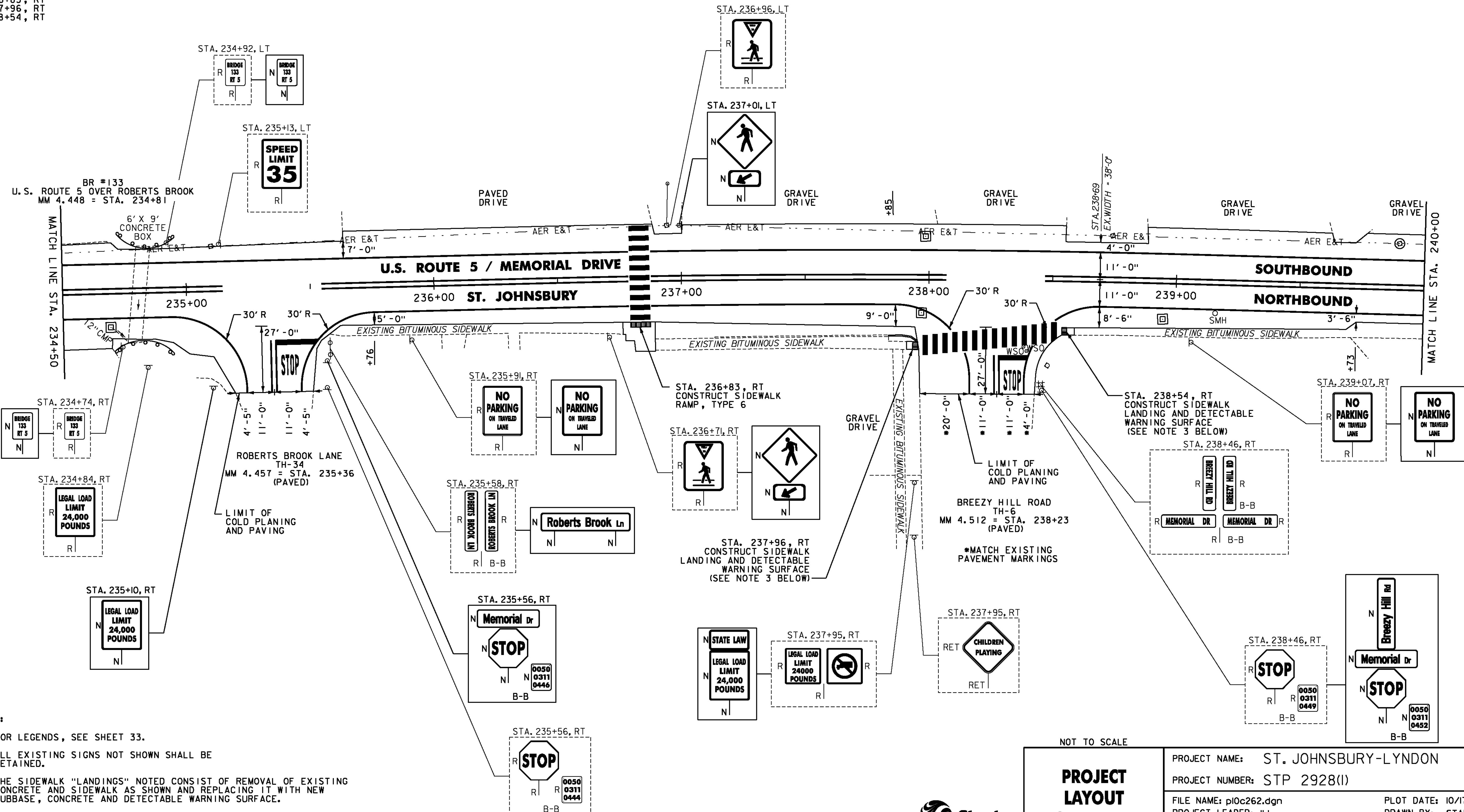

- NOTES:
- FOR LEGENDS, SEE SHEET 33.
 - ALL EXISTING SIGNS NOT SHOWN SHALL BE RETAINED.
 - THE SIDEWALK "LANDINGS" NOTED CONSIST OF REMOVAL OF EXISTING CONCRETE AND SIDEWALK AS SHOWN AND REPLACING IT WITH NEW SUBBASE, CONCRETE AND DETECTABLE WARNING SURFACE.
 - DURABLE MARKINGS DETAILED ON THIS SHEET ARE OPTION BID ITEMS. SEE SHEETS 6-7.

NOT TO SCALE

PROJECT LAYOUT SHEET #11	PROJECT NAME: ST. JOHNSBURY-LYNDON
	PROJECT NUMBER: STP 2928(I)
FILE NAME: p10c262.dgn	PLOT DATE: 10/17/2013
DESIGNED BY: MCF	DRAWN BY: STANTEC
IPARM FILE: p10c262111.i	CHECKED BY: JLL
	SHEET 43 OF 133

