

**BEGIN STP 2928(1) U.S. ROUTE 5  
ST. JOHNSBURY STA. 151+85.28 = (MM 2.876)**

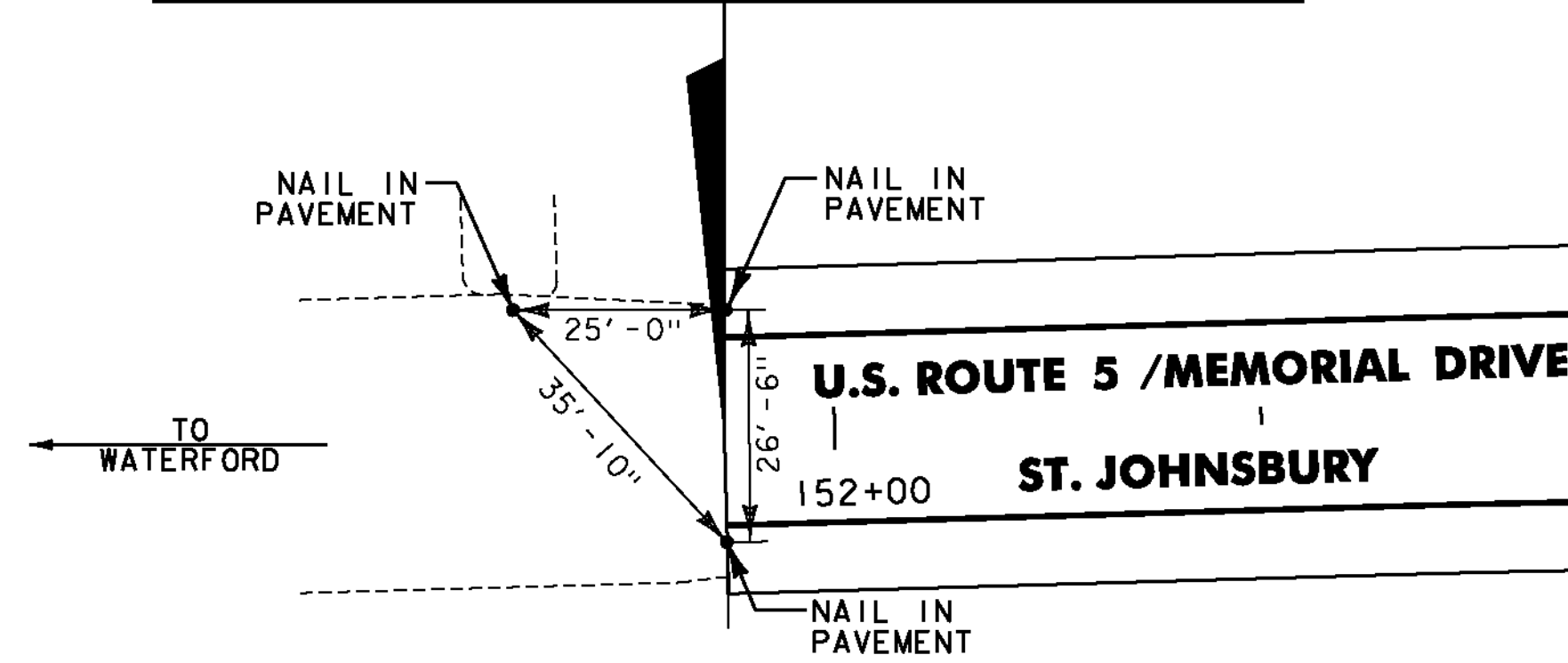

**U.S. ROUTE 5 ST. JOHNSBURY BEGIN PROJECT LOCATION TIES**

**END STP 2928(1) U.S. ROUTE 5  
LYNDON STA. 139+49.76 = (MM 2.642)**

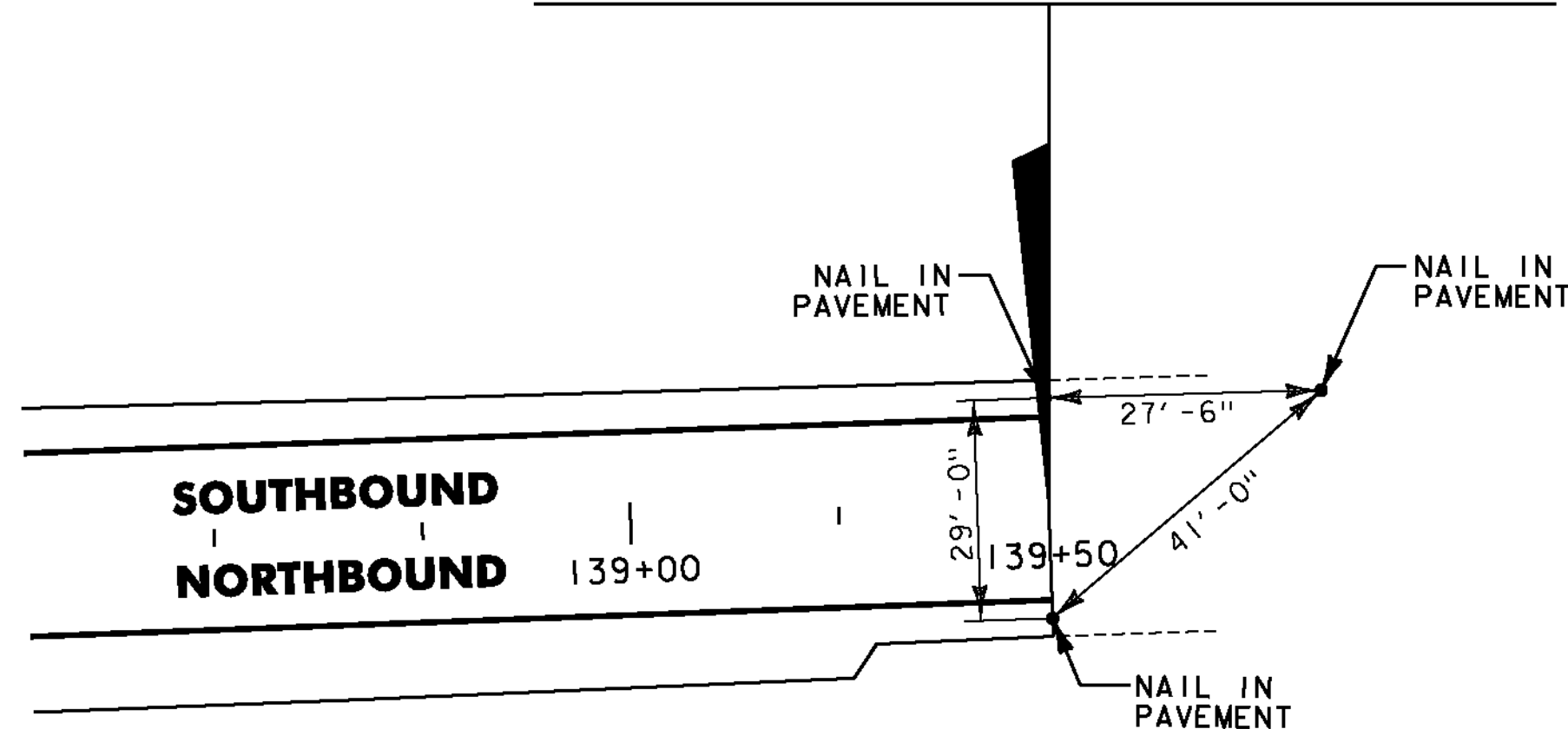

**U.S. ROUTE 5 LYNDON END PROJECT LOCATION TIES**

**END STP 2928(1) ST. JOHNSBURY STATE HIGHWAY  
ST. JOHNSBURY STA. 54+96.48 = (MM 1.041)**

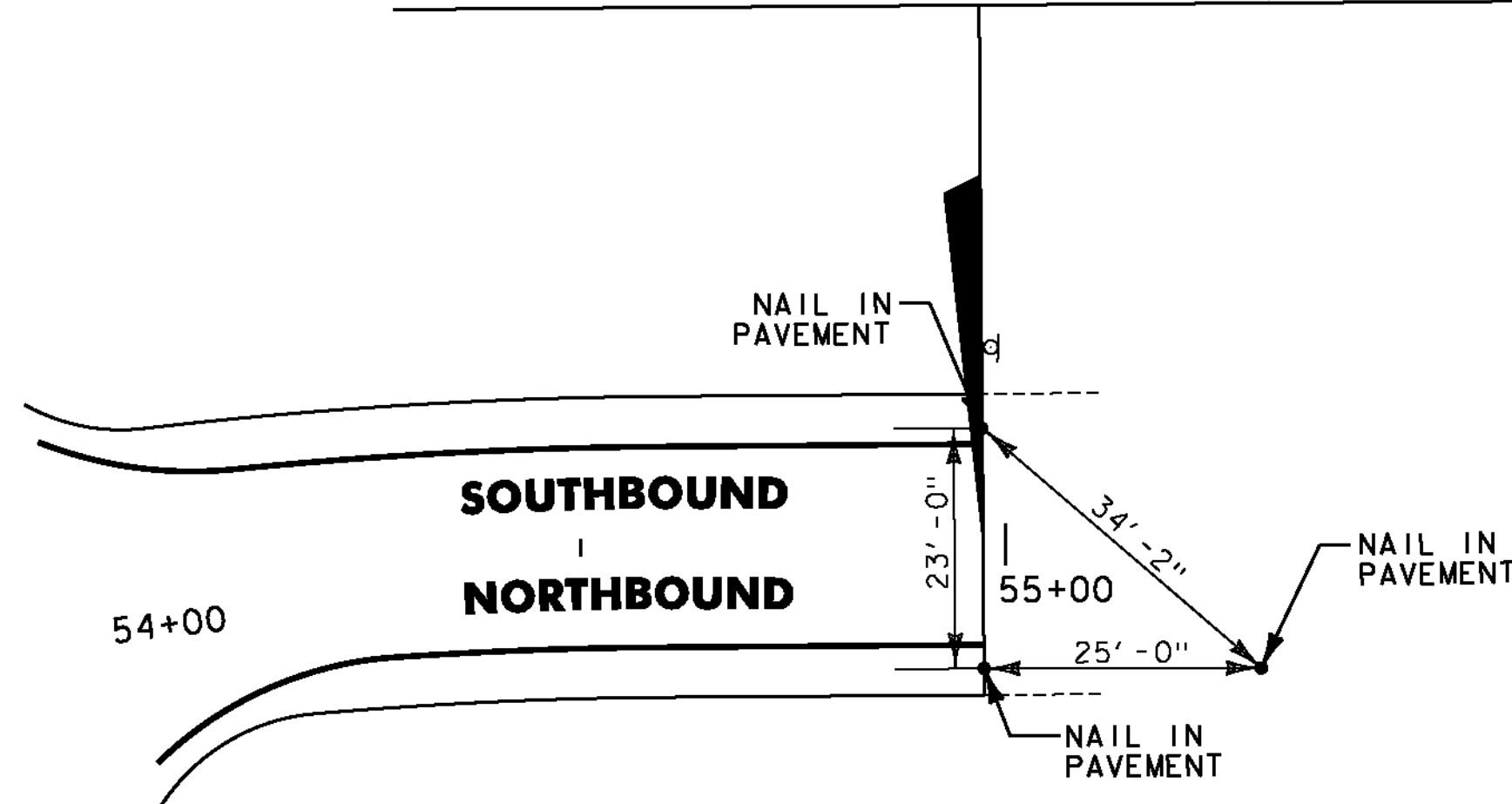

**STATE HIGHWAY ST. JOHNSBURY END PROJECT LOCATION TIES**

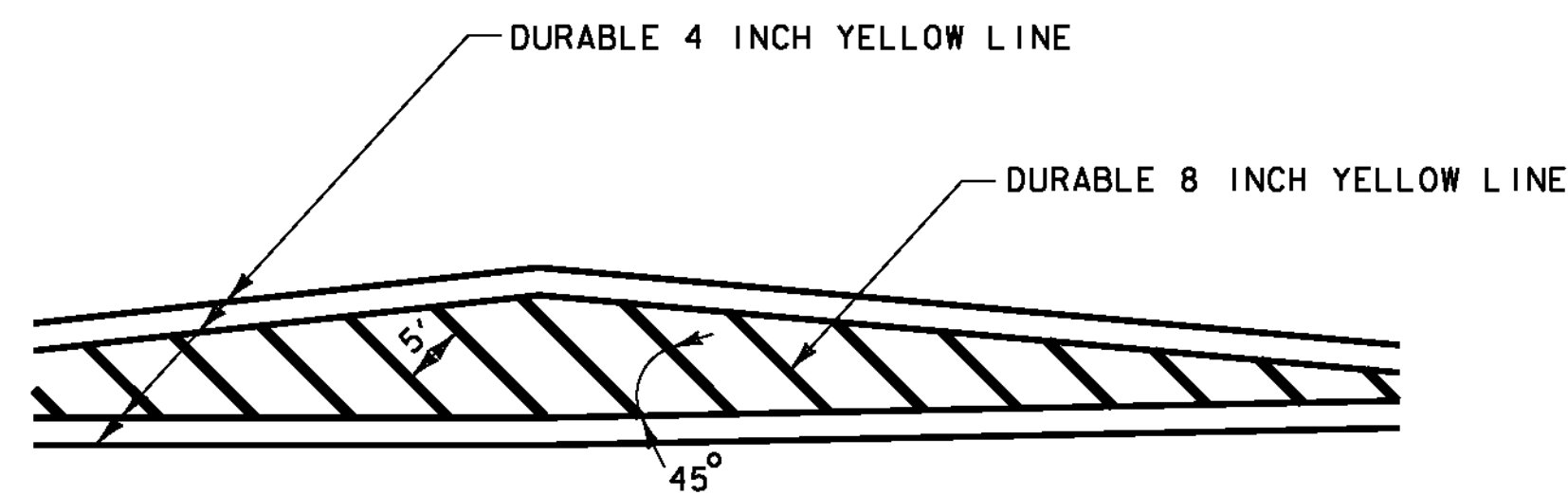

**GORE MARKING DETAIL (5 FOOT)**  
LYNDON U.S. ROUTE 5 STA. 72+69 TO 73+08

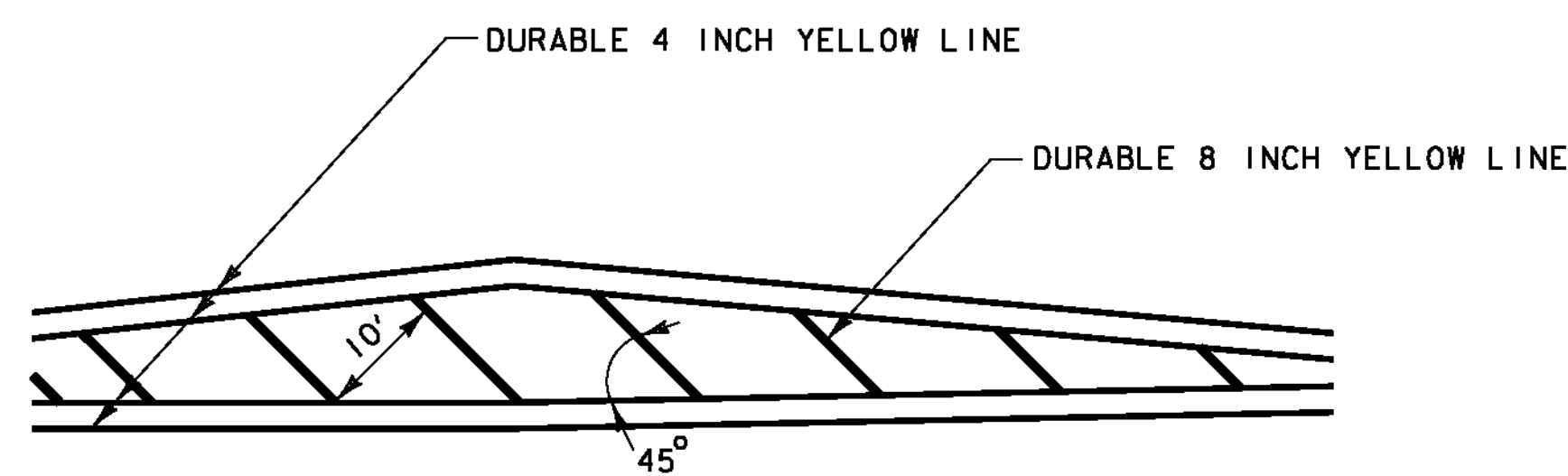

**GORE MARKING DETAIL (10 FOOT)**  
ST. JOHNSBURY U.S. ROUTE 5 STA. 188+81 TO 191+88  
ST. JOHNSBURY U.S. ROUTE 5 STA. 194+55 TO 196+55  
ST. JOHNSBURY U.S. ROUTE 5 STA. 252+33 TO 256+35  
LYNDON U.S. ROUTE 5 STA. 70+05 TO 72+21  
LYNDON U.S. ROUTE 5 STA. 74+87 TO 79+13  
LYNDON U.S. ROUTE 5 STA. 82+78 TO 83+71  
LYNDON U.S. ROUTE 5 STA. 93+84 TO 94+64  
LYNDON U.S. ROUTE 5 STA. 114+38 TO 116+61  
LYNDON U.S. ROUTE 5 STA. 117+97 TO 119+05

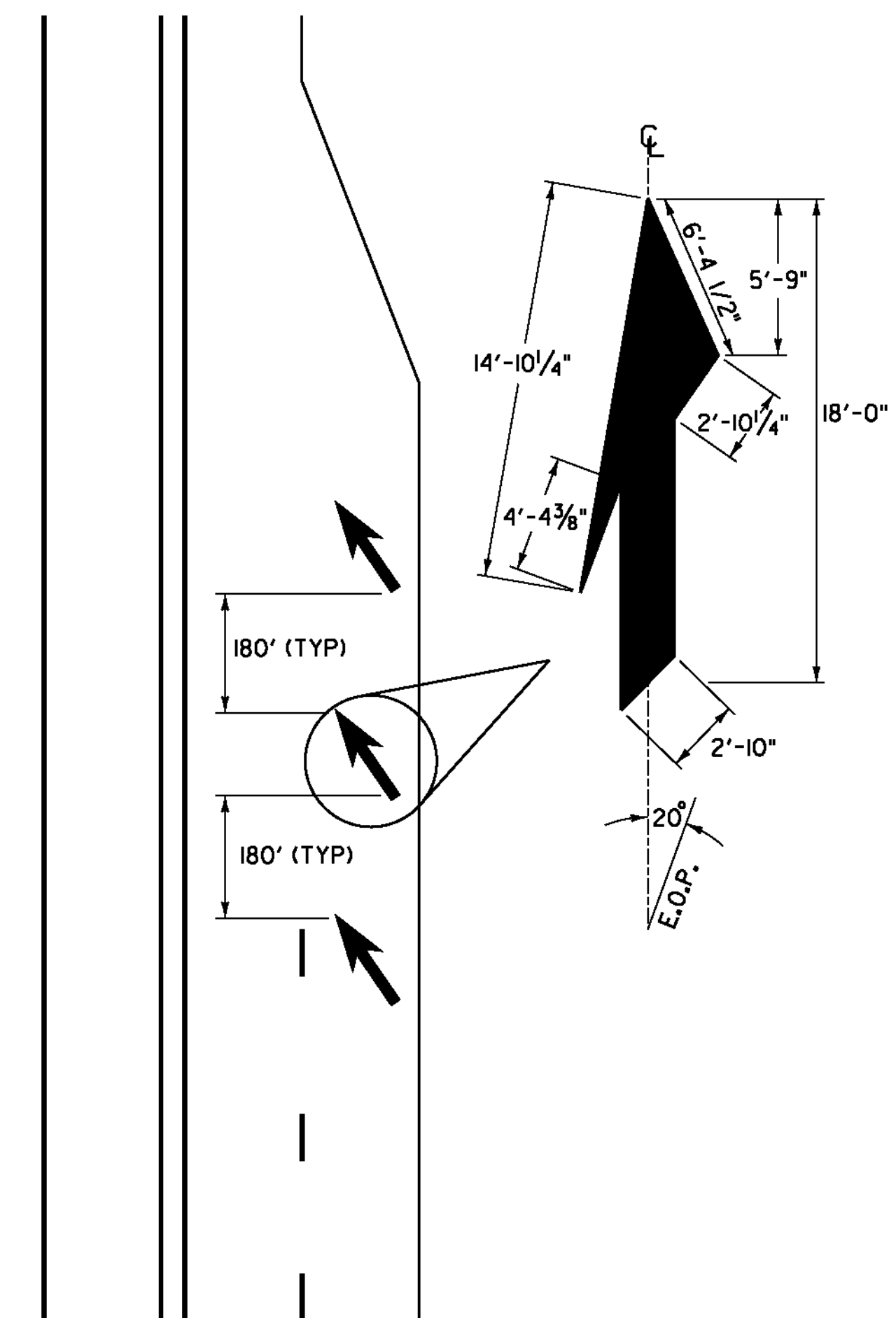

**LANE REDUCTION TRANSITION MARKINGS**

SEE SHEET 86 FOR LOCATIONS.

NOTE:  
FIRST LANE REDUCTION ARROW SHALL BE PLACED OPPOSITE THE LAST DASH.  
ARROWS TO BE PLACED EVERY 180'(MAX.) BETWEEN LAST DASH AND BEGINNING OF LANE TAPER.  
ARROWS TO BE PAID AS ITEM 646.30.

NOTE:  
DURABLE MARKINGS DETAILED ON THIS SHEET ARE OPTION BID ITEMS.  
SEE SHEETS 6-7

NOT TO SCALE

**MISCELLANEOUS  
DETAIL  
SHEET #2**

PROJECT NAME: ST. JOHNSBURY-LYNDON  
PROJECT NUMBER: STP 2928(1)

FILE NAME: p10c262.dgn  
PROJECT LEADER: JLL  
DESIGNED BY: MCF  
IPARM FILE: p10c262md02.i

PLOT DATE: 10/17/2013  
DRAWN BY: STANTEC  
CHECKED BY: JLL  
SHEET 30 OF 133

