

**DETAIL FOR PIPE PLACEMENT END TREATMENT LOCATION**

- U.S. ROUTE 5
- ST. JOHNSBURY STA. 214+50.5, RT
- ST. JOHNSBURY STA. 215+33.5, RT
- ST. JOHNSBURY STA. 295+19.5, LT
- ST. JOHNSBURY STA. 331+78.0, LT
- ST. JOHNSBURY STA. 332+78.0, LT
- ST. JOHNSBURY STA. 336+94.0, LT
- ST. JOHNSBURY STA. 360+09.0, LT
- ST. JOHNSBURY STA. 373+32.0, RT
- U.S. ROUTE 5
- LYNDON STA. 16+08.0, RT
- LYNDON STA. 16+48.0, LT
- LYNDON STA. 17+46.5, RT
- LYNDON STA. 45+31.5, LT

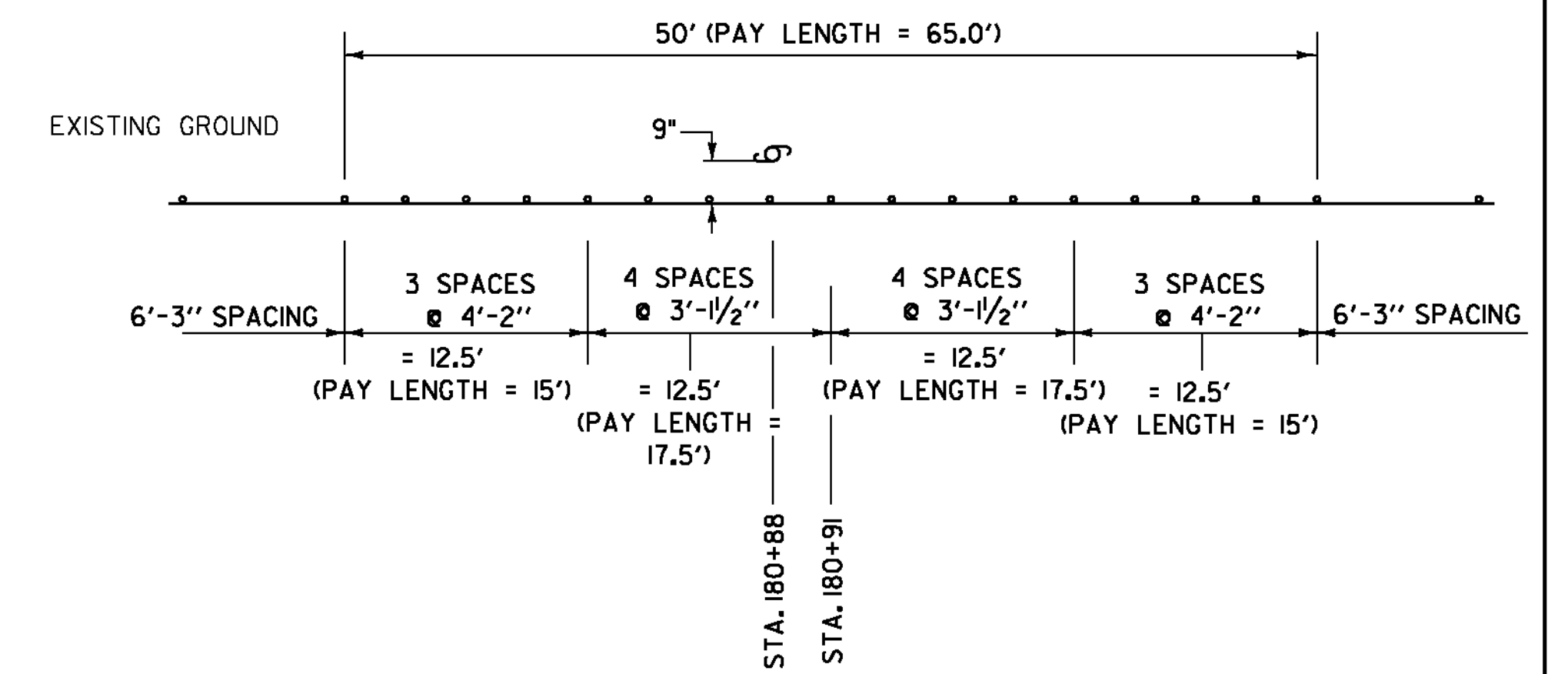

**REDUCED GUARDRAIL POST SPACING DETAIL #1**

LOCATION:  
U.S. ROUTE 5  
ST. JOHNSBURY STA. 180+88, LT - UTILITY POLE

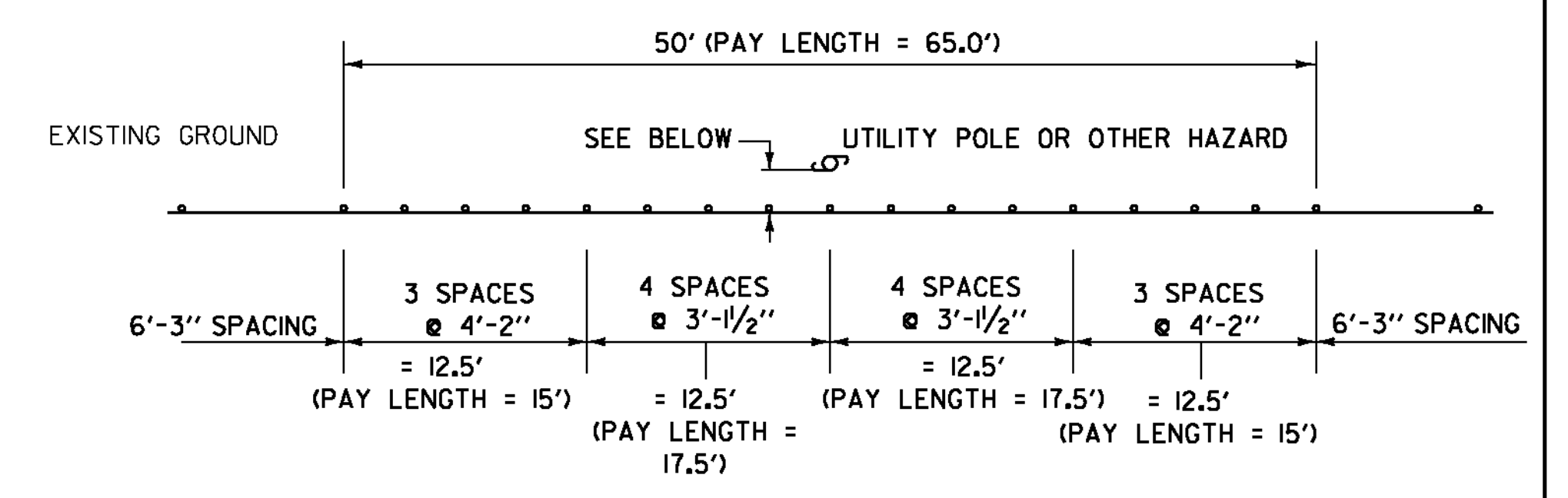

**REDUCED GUARDRAIL POST SPACING DETAIL #2**

LOCATION:  
U.S. ROUTE 5  
ST. JOHNSBURY STA. 211+95, LT - UTILITY POLE (4 FT BEHIND FACE OF GUARDRAIL)  
ST. JOHNSBURY STA. 229+57, LT - UTILITY POLE (4 FT BEHIND FACE OF GUARDRAIL)  
ST. JOHNSBURY STA. 264+97.5, LT - UTILITY POLE (1 FT BEHIND FACE OF GUARDRAIL)  
U.S. ROUTE 5  
LYNDON STA. 46+66, LT - UTILITY POLE (2 FT BEHIND FACE OF GUARDRAIL)

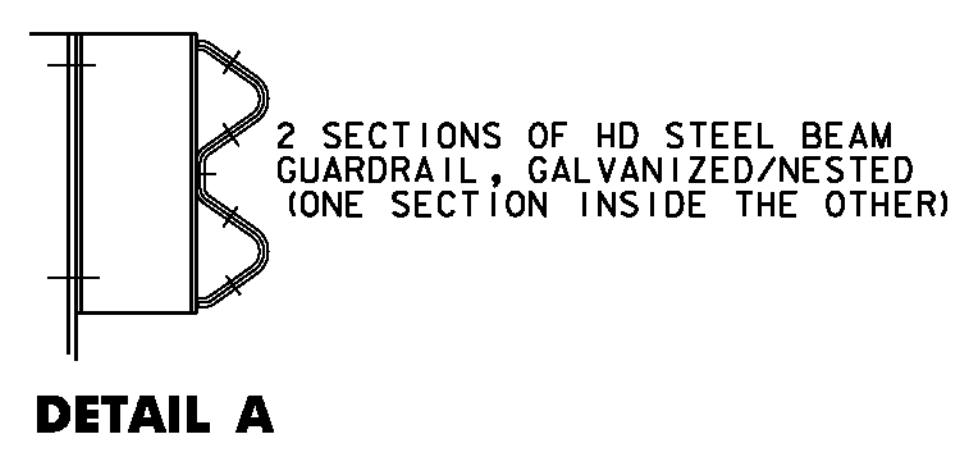

**DETAIL A**

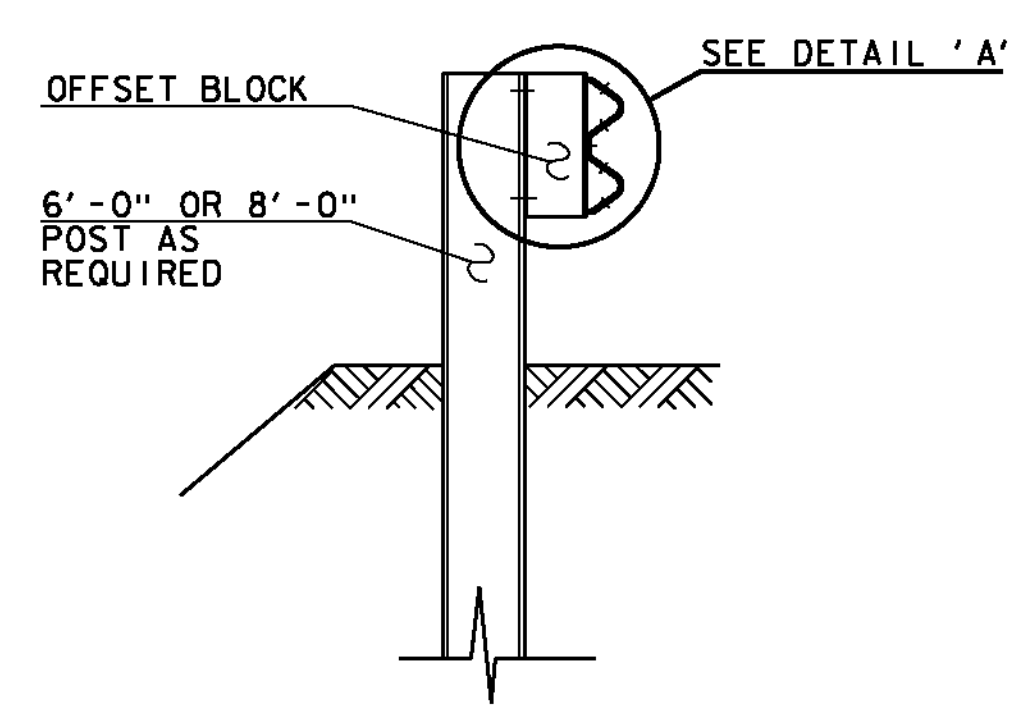

**SECTION A-A**

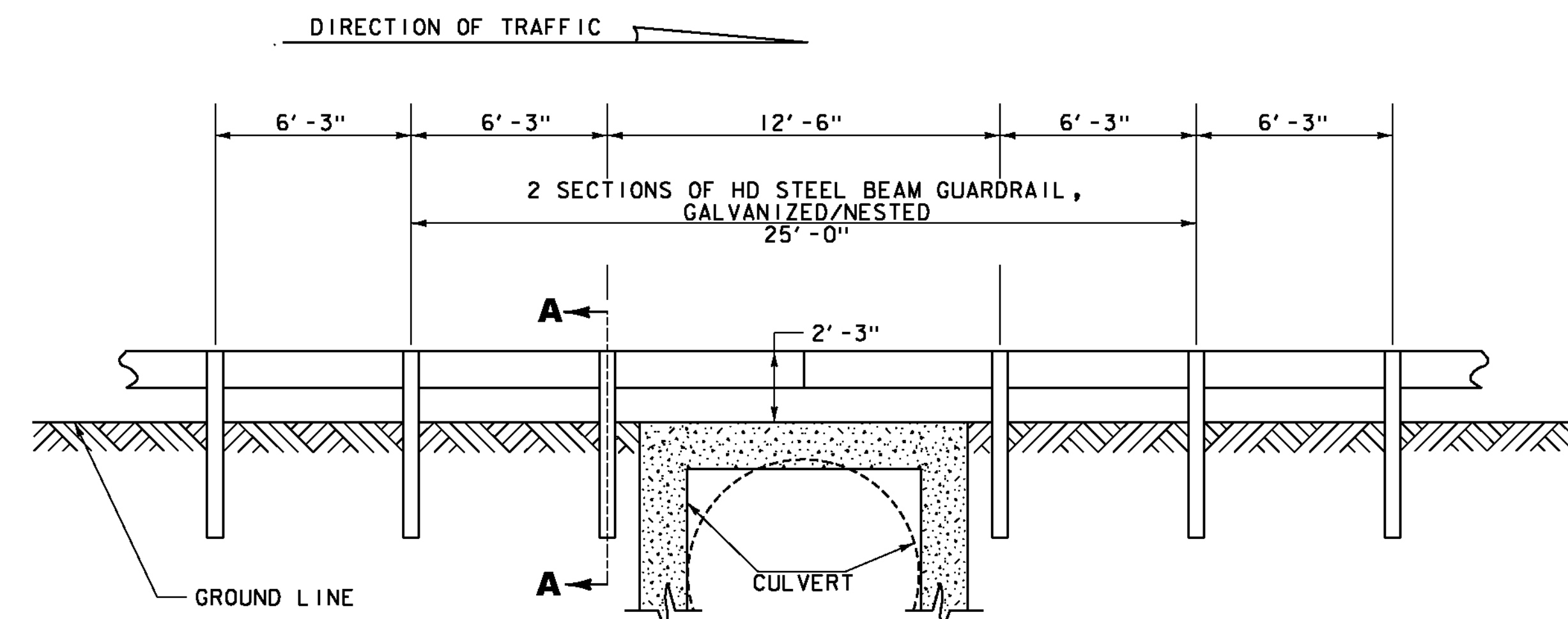

**DETAIL OF STEEL BEAM GUARDRAIL AT SMALL CULVERTS**

U.S. ROUTE 5  
ST. JOHNSBURY STA. 175+96, LT (BRIDGE #131)  
U.S. ROUTE 5  
LYNDON STA. 124+42, LT (BRIDGE #142)

**NOTES**

1. SEE STANDARDS G-1 & G-1D FOR STEEL BEAM GUARDRAIL DETAILS.
2. THIS WORK SHALL BE PAID UNDER ITEM 621.216 HD STEEL BEAM GUARDRAIL, GALVANIZED/NESTED AT A PAY FACTOR OF 1.0.
3. THIS DETAIL TO BE USED AS INDICATED ON SHEETS 9 TO 14 OR AS DIRECTED BY THE ENGINEER.

NOT TO SCALE

**GUARDRAIL  
DETAIL  
SHEET #1**



PROJECT NAME: ST. JOHNSBURY-LYNDON	
PROJECT NUMBER: STP 2928(I)	
FILE NAME: p10c262.dgn	PLOT DATE: 10/17/2013
PROJECT LEADER: JLL	DRAWN BY: STANTEC
DESIGNED BY: MCF	CHECKED BY: JLL
IPARM FILE: p10c262gds01.i	SHEET 17 OF 133