

CURVE #23
 DELTA = 22°05'28"
 D = 5°12'31"
 R = 1100.00'
 T = 214.73'
 L = 424.12'
 E = 20.76'
 BANKING 0.072 FT/FT
 DESIGN SPEED 50 MPH
 SEE BANKING DIAGRAMS
 FOR MORE INFORMATION

6 INCH UNDERDRAIN PIPE
 STA. 178+00 - STA. 181+45 LT
 STA. 182+50 - STA. 182+75 LT
 STA. 182+50 - STA. 182+75 RT
REMOVAL AND DISPOSAL OF GUARDRAIL
 STA. 180+11 - STA. 181+71.5 RT
 STA. 180+85 - STA. 182+52 LT

DURABLE 4 INCH WHITE LINE (SEE OPTION ITEMS)
 STA. 177+50 - STA. 182+75 (SOLID LT & RT)
DURABLE 4 INCH YELLOW LINE (SEE OPTION ITEMS)
 STA. 177+50 - STA. 182+75 (SOLID LT & RT)
TEMPORARY 4 INCH WHITE LINE, PAINT
 STA. 177+50 - STA. 182+75 (SOLID LT & RT)
TEMPORARY 4 INCH YELLOW LINE, PAINT
 STA. 177+50 - STA. 182+75 (SOLID LT & RT)

REMOVING SIGNS
 AS SHOWN -3
SPECIAL PROVISION (BOX BEAM GUARDRAIL W/7 FEET POSTS)
 STA. 179+55.5 - STA. 181+65.5 RT
 STA. 180+77.5 - STA. 182+75 LT

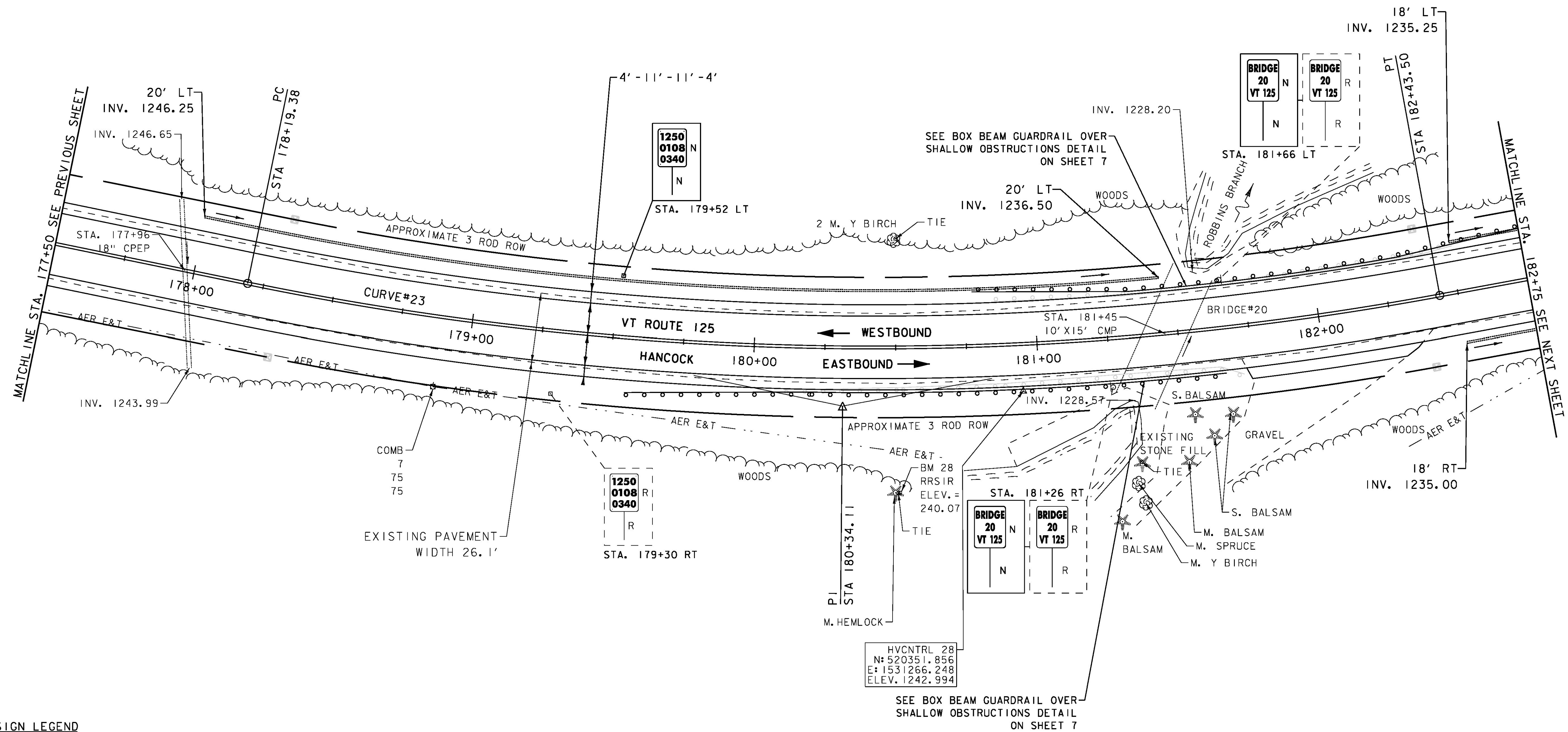
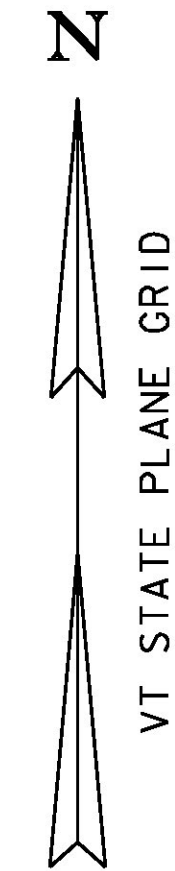

SIGN LEGEND

- R = REMOVE
- R&S = REMOVE AND SALVAGE
- RET = RETAIN
- S = SALVAGED
- N = NEW
- B-B = BACK TO BACK
- - = EXISTING
- = NEW

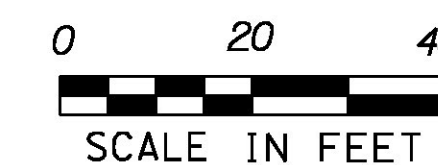

PROJECT NAME: HANCOCK	PLOT DATE: 3/18/2015
PROJECT NUMBER: STP 2923 (1)	DRAWN BY: J. GOODALL
FILE NAME: z10c252bdr.dgn	CHECKED BY: C. LATHROP
DESIGNED BY: B. MARTIN	SHEET 59 OF 207
PROJECT LAYOUT SHEET 27	