

CHANGE DI, CB OR MANHOLES  
STA. 226+40 RT

**REHAB. DROP INLETS, CATCH BASINS, OR MANHOLES, CLASS I OR CLASS II**

STA. 222+55 RT ✓ STA. 226+60 LT ✓  
STA. 222+64 LT ✓ STA. 226+62 RT ✓  
STA. 222+80 RT ✓ STA. 227+31 RT ✓  
STA. 222+89 LT ✓  
STA. 224+57 RT ✓  
STA. 224+60 LT ✓

**ADJUST ELEVATION OF VALVE BOX**

STA. 224+54 LT  
STA. 227+10 LT  
STA. 227+15 LT  
STA. 227+39 LT  
STA. 227+55 CL

**COMMON EXCAVATION**

STA. 224+07 - STA. 224+12 RT  
STA. 224+08 - STA. 224+13 LT  
STA. 227+11 - STA. 227+20 LT

**PORTLAND CEMENT CONCRETE SIDEWALK, 5 INCH**

STA. 224+07 - STA. 224+12 RT ← NOT DONE PER R.E.  
STA. 224+08 - STA. 224+13 LT ✓  
STA. 227+11 - STA. 227+20 LT ✓

**SUBBASE OF CRUSHED GRAVEL, FINE GRADED**

STA. 224+07 - STA. 224+12 RT  
STA. 224+08 - STA. 224+13 LT  
STA. 227+11 - STA. 227+20 LT

**REMOVING AND RESETTING CURB**

STA. 223+97 - STA. 224+22 RT  
STA. 223+99 - STA. 224+24 LT  
STA. 227+04 - STA. 227+26 LT  
STA. 227+69 - STA. 227+75 LT  
STA. 227+70 - STA. 227+75 RT

**DETECTABLE WARNING SURFACES**

STA. 224+10 RT (8 SF) ← NOT DONE PER R.E.  
STA. 224+11 LT (8 SF) ✓  
STA. 227+16 LT (8 SF) ✓

**DURABLE 4 INCH YELLOW LINE, TYPE I TAPE**

STA. 222+50 - STA. 227+75 (SOLID LT & RT)  
(WITH BREAKS AT SIDEROADS & CROSSWALKS)  
STA. 227+44 LT (CENTERLINE WATER ST)

**DURABLE 4 INCH WHITE LINE, TYPE I TAPE**

STA. 222+50 - STA. 227+25 (SOLID RT)  
STA. 222+50 - STA. 227+75 (SOLID LT)  
(WITH BREAKS AT SIDEROADS & CROSSWALKS)  
STA. 227+44 LT (EDGE LINES WATER ST)

**TEMPORARY 4 INCH WHITE LINE, PAINT**

STA. 222+50 - STA. 227+25 (SOLID RT)  
STA. 222+50 - STA. 227+75 (SOLID LT)  
(WITH BREAKS AT SIDEROADS & CROSSWALKS)  
STA. 227+44 LT (EDGE LINES WATER ST)

**DURABLE 8 INCH WHITE LINE, TYPE I TAPE**

STA. 222+63 - STA. 222+78 (HATCH RT)  
STA. 223+83 - STA. 224+04 (HATCH RT)  
STA. 224+51 - STA. 224+72 (HATCH LT)  
STA. 226+85 - STA. 227+14 (HATCH LT)

**TEMPORARY 8 INCH WHITE LINE, PAINT**

STA. 222+63 - STA. 222+78 (HATCH RT)  
STA. 223+83 - STA. 224+04 (HATCH RT)  
STA. 224+51 - STA. 224+72 (HATCH LT)  
STA. 226+85 - STA. 227+14 (HATCH LT)

**TEMPORARY 4 INCH YELLOW LINE, PAINT**

STA. 222+50 - STA. 227+75 (SOLID LT & RT)  
(WITH BREAKS AT SIDEROADS & CROSSWALKS)  
STA. 227+44 LT (CENTERLINE WATER ST)

**ERECTING SALVAGED SIGNS**

AS SHOWN - 1

**REMOVING SIGNS**

AS SHOWN - 10

REMOVE AND RECONSTRUCT  
SIDEWALK RAMP TYPE 6, EXAMPLE 2  
FROM STANDARD DRAWING C-3B  
SEE DETAILS ON SHEET 141

WATER ST  
MM 4.308  
STA. 227+44

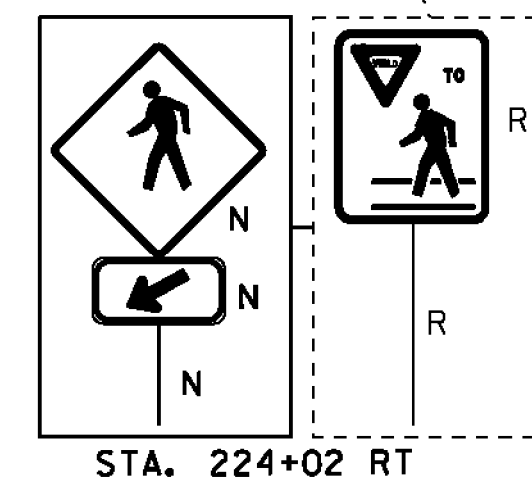
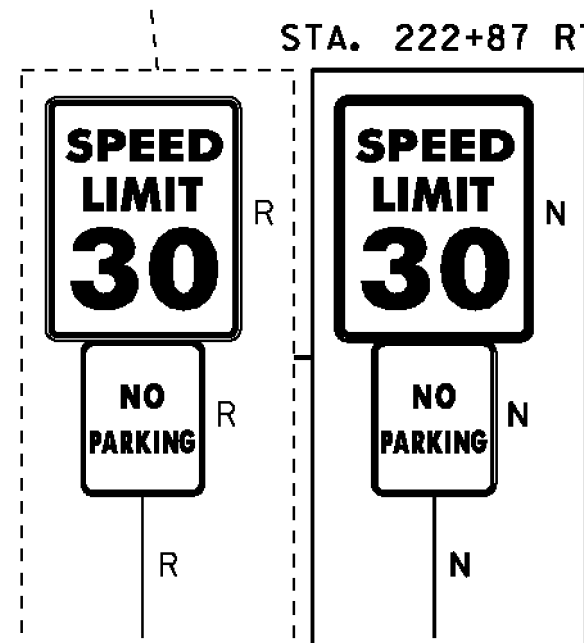
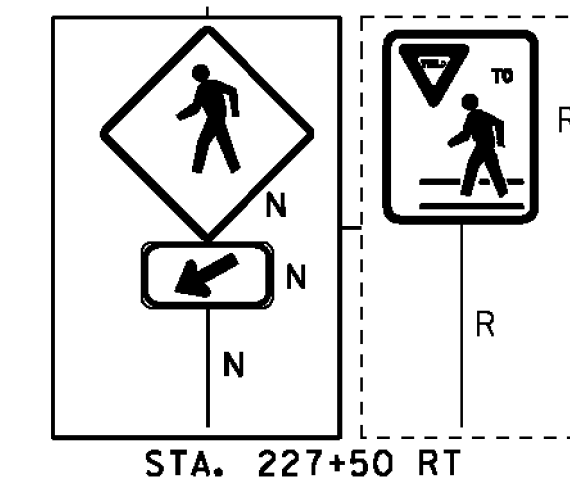
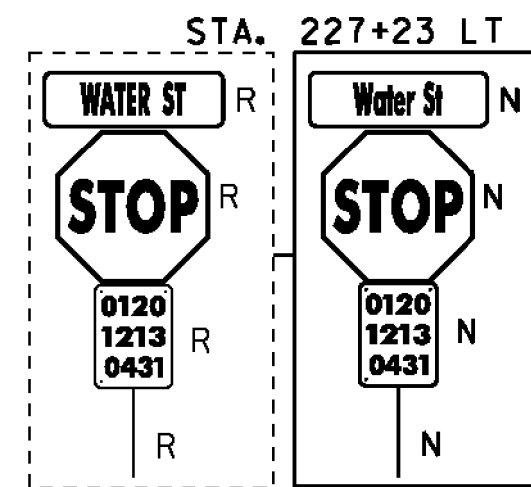
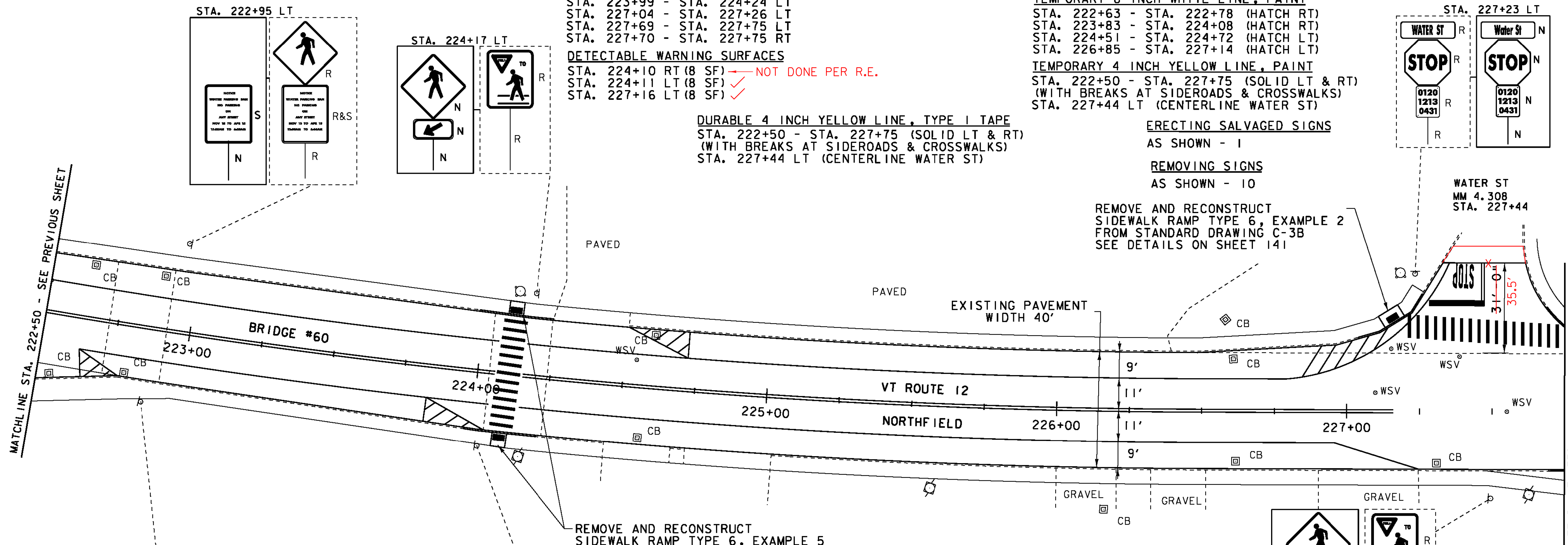

**LEGEND**

- SIGN
- HYDRANT
- MANHOLE
- VALVE
- GAS PIPELINE MARKER
- CATCH BASIN / DROP INLET
- CURB INLET
- TRAFFIC CONTROL BOX
- PARKING METER
- UTILITY POLE
- LIGHT POLE
- EX. DETECTABLE WARNINGS
- JUNCTION BOX
- PED BUTTON
- ELECTRICAL BOX
- SIGNAL
- PEDESTAL POST
- DETECTABLE WARNINGS

**SIGN LEGEND**

- R = REMOVE
- R&S = REMOVE AND SALVAGE
- RET = RETAIN
- S = SALVAGE
- N = NEW
- B-B = BACK TO BACK

**DURABLE 24 INCH STOP BAR, TYPE I TAPE**  
STA. 227+26 - STA. 227+49 LT

**TEMPORARY 24 INCH STOP BAR, PAINT**  
STA. 227+26 - STA. 227+49 LT

**DURABLE CROSSWALK MARKING, TYPE I TAPE**

STA. 224+11 LT & RT  
STA. 227+21 - STA. 227+73 LT

**TEMPORARY CROSSWALK MARKING, PAINT**

STA. 224+11 LT & RT  
STA. 227+21 - STA. 227+73 LT

**DURABLE LETTER OR SYMBOL, TYPE I TAPE**

STA. 227+40 LT "STOP"

**TEMPORARY LETTER OR SYMBOL, PAINT**

STA. 227+40 LT "STOP"

**PROJECT LAYOUT SHEET 49**

PROJECT NAME: BETHEL-NORTHFIELD  
PROJECT NUMBER: STP 2922(I)

FILE NAME: piOC246.dgn  
PROJECT LEADER: CDL  
DESIGNED BY: SJL  
PLOT FILE: piOC246\_68.1

PLOT DATE: 1/3/13  
DRAWN BY: JBG  
CHECKED BY: CDL  
SHEET 68 OF 149