

REHAB, DROP INLETS, CATCH BASINS, OR MANHOLES, CLASS I OR CLASS II

STA. 96+68 RT ✓ STA. 99+71 LT ✓
 STA. 96+88 RT ✓ STA. 101+29 RT ✓
 STA. 97+20 LT ✓ STA. 101+39 LT ✓
 STA. 99+37 RT ✓ STA. 97+25 LT ✓

CHANGING ELEVATION OF DROP INLETS, CATCH BASINS, OR MANHOLES

STA. 97+25 LT "DMH" PAID AS REHAB, HAS A GRATE
 CHANGING ELEVATION OF SEWER MANHOLE
 STA. 99+35 LT ✓ STA. 97+15 LT ✓

COMMON EXCAVATION

STA. 97+15 - STA. 97+23 RT ← NOT DONE PER R.E.

PORTLAND CEMENT CONCRETE SIDEWALK, 5 INCH
 STA. 97+15 - STA. 97+23 RT

SUBBASE OF CRUSHED GRAVEL, FINE GRADED
 STA. 97+15 - STA. 97+23 RT

REMOVAL OF EXISTING CURB
 STA. 97+16 - STA. 97+27 RT

CAST-IN-PLACE CONCRETE CURB, TYPE B
 STA. 97+16 - STA. 97+27 RT

DETECTABLE WARNING SURFACES

STA. 97+18 RT (8 SF) ← NOT DONE PER R.E.

ADJUST ELEVATION OF VALVE BOX
 STA. 97+22 LT "WSV" (NOT ON PLANS)

DURABLE 4 INCH WHITE LINE, TYPE I TAPE

STA. 96+25 - STA. 101+75 (SOLID LT & RT)
 (WITH BREAKS AT SIDEROADS)
 STA. 97+00 RT (EDGELINES TH #344)
 STA. 99+54 RT (EDGELINES TH #302)

DURABLE 4 INCH YELLOW LINE, TYPE I TAPE

STA. 96+25 - STA. 101+75 (SOLID LT & RT)
 (WITH BREAKS AT SIDEROADS)
 STA. 97+00 RT (CENTERLINE TH #344)
 STA. 99+54 RT (CENTERLINE TH #302)

DURABLE LETTER OR SYMBOL, TYPE I TAPE

STA. 97+00 RT "STOP"
 STA. 99+58 RT "STOP"

DURABLE 24 INCH STOP BAR, TYPE I TAPE

STA. 96+97 - STA. 97+08 RT
 STA. 99+52 - STA. 99+63 RT

DURABLE CROSSWALK MARKING, TYPE I TAPE

STA. 96+85 - STA. 97+14 RT
 STA. 99+42 - STA. 99+65 RT

TEMPORARY 4 INCH WHITE LINE, PAINT

STA. 96+25 - STA. 101+75 (SOLID LT & RT)
 (WITH BREAKS AT SIDEROADS)
 STA. 97+00 RT (EDGELINES TH #344)
 STA. 99+54 RT (EDGELINES TH #302)

TEMPORARY 4 INCH YELLOW LINE, PAINT

STA. 96+25 - STA. 101+75 (SOLID LT & RT)
 (WITH BREAKS AT SIDEROADS)
 STA. 97+00 RT (CENTERLINE TH #344)
 STA. 99+54 RT (CENTERLINE TH #302)

TEMPORARY LETTER OR SYMBOL, PAINT

STA. 97+00 RT "STOP"
 STA. 99+58 RT "STOP"

TEMPORARY 24 INCH STOP BAR, PAINT

STA. 96+97 - STA. 97+08 RT
 STA. 99+52 - STA. 99+63 RT

TEMPORARY CROSSWALK MARKING, PAINT

STA. 96+85 - STA. 97+14 RT
 STA. 99+42 - STA. 99+65 RT

REMOVING SIGNS
 AS SHOWN - 7

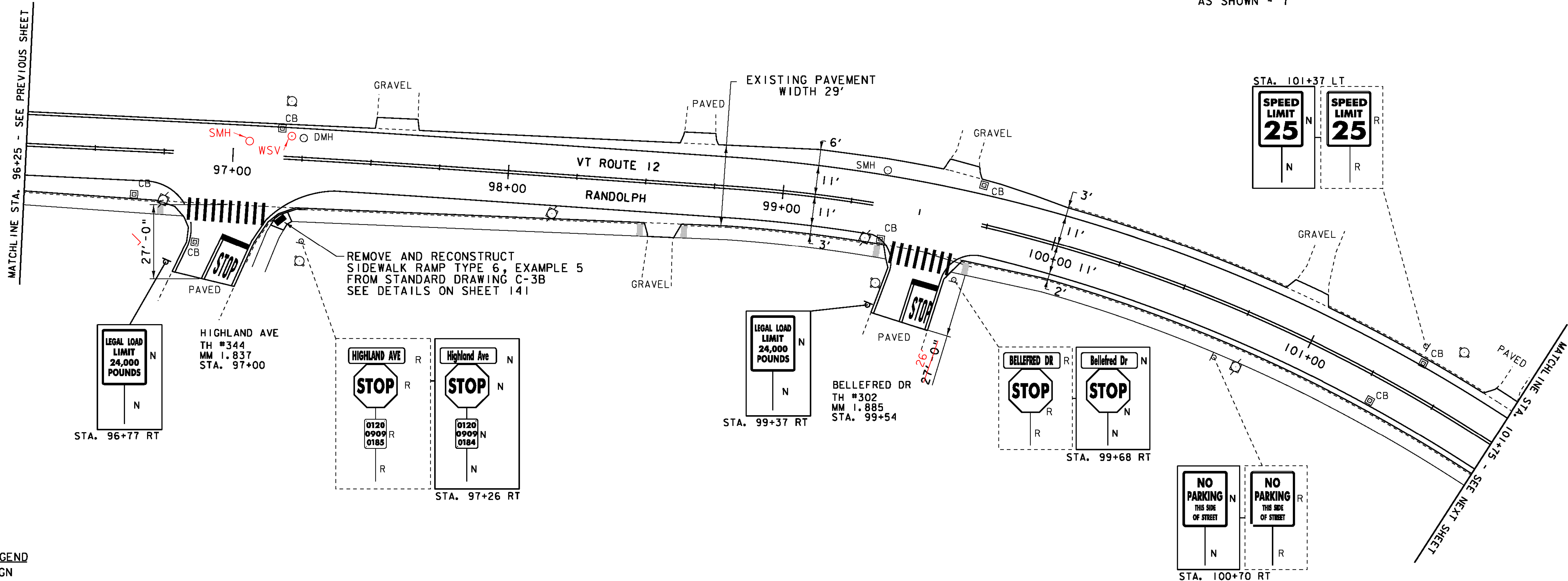

- LEGEND**
- SIGN
 - HYDRANT
 - MANHOLE
 - VALVE
 - GAS PIPELINE MARKER
 - CATCH BASIN / DROP INLET
 - CURB INLET
 - ⊠ TRAFFIC CONTROL BOX
 - ⊠ PARKING METER
 - ⊠ UTILITY POLE
 - DETECTABLE WARNINGS
 - LIGHT POLE
 - EX. DETECTABLE WARNINGS
 - JUNCTION BOX
 - ⊠ PED BUTTON
 - ⊠ ELECTRICAL BOX
 - ⊠ SIGNAL
 - ⊠ PEDESTAL POST
 - ⊠ STRAIN POLE
 - CAMERA
 - VIDEO DETECTION ZONE

- SIGN LEGEND**
- R = REMOVE
 - R&S = REMOVE AND SALVAGE
 - RET = RETAIN
 - S = SALVAGE
 - N = NEW
 - B-B = BACK TO BACK

NOT TO SCALE

PROJECT LAYOUT SHEET 14

PROJECT NAME: BETHEL-NORTHFIELD	PLOT DATE: 1/3/13
PROJECT NUMBER: STP 2922(I)	DRAWN BY: JBG
FILE NAME: piOC246.dgn	DESIGNED BY: SJL
PROJECT LEADER: CDL	CHECKED BY: CDL
PLOT FILE: piOC246_33.1	SHEET 33 OF 149