

REHAB. DROP INLETS, CATCH BASINS, OR MANHOLES, CLASS I OR CLASS II

- STA. 87+94 LT ✓
- STA. 88+03 RT ✓
- STA. 88+37 RT ✓
- STA. 89+53 LT ✓
- STA. 89+54 RT ✓
- STA. 91+12 LT ✓
- STA. 91+14 RT ✓
- STA. 92+35 LT ✓

CHANGING ELEVATION OF SEWER MANHOLES

- STA. 88+38 RT ✓
- STA. 89+13 LT ✓
- STA. 89+60 RT ✓
- STA. 89+96 RT ✓
- STA. 90+96 LT ✓
- STA. 90+98 RT ✓
- STA. 91+16 LT ✓
- STA. 88+85 RT ✓

ADJUST ELEVATION OF VALVE BOX

- STA. 87+25 RT "WSV"
- STA. 88+75 RT "WSV"
- STA. 91+06 RT "WSV"

NO RECONSTRUCTION IN THIS AREA

COMMON EXCAVATION

- STA. 88+49 - STA. 88+54 RT ✓
- STA. 88+75 - STA. 88+79 RT ✓
- STA. 88+77 - STA. 88+82 LT ✓
- STA. 90+79 - STA. 90+85 LT ✓
- STA. 90+80 - STA. 90+90 RT ✓
- STA. 91+88 - STA. 91+97 LT ✓

PORTLAND CEMENT CONCRETE SIDEWALK, 5 INCH

- STA. 88+49 - STA. 88+54 RT
- STA. 88+75 - STA. 88+79 RT
- STA. 88+77 - STA. 88+82 LT
- STA. 90+79 - STA. 90+85 LT
- STA. 90+80 - STA. 90+90 RT
- STA. 91+88 - STA. 91+97 LT

SUBBASE OF CRUSHED GRAVEL, FINE GRADED

- STA. 88+49 - STA. 88+54 RT
- STA. 88+75 - STA. 88+79 RT
- STA. 88+77 - STA. 88+82 LT
- STA. 90+79 - STA. 90+85 LT
- STA. 90+80 - STA. 90+90 RT
- STA. 91+88 - STA. 91+97 LT

REMOVE AND RESET CURB

- STA. 88+42 - STA. 88+52 RT
- STA. 88+66 - STA. 88+92 LT
- STA. 88+77 - STA. 88+87 RT
- STA. 90+69 - STA. 90+96 LT
- STA. 90+74 - STA. 90+84 RT
- STA. 91+89 - STA. 92+07 LT

DETECTABLE WARNING SURFACES

- STA. 88+51 RT (8 SF) ✓
- STA. 88+78 RT (8 SF) ✓
- STA. 88+79 LT (8 SF) ✓
- STA. 90+82 LT (8 SF) ✓
- STA. 90+85 RT (10 SF) 8 SF
- STA. 91+91 LT (8 SF) ✓

DURABLE 4 INCH WHITE LINE, TYPE I TAPE

- STA. 87+25 - STA. 94+25 (SOLID LT & RT)
- (WITH EDGELINE BREAKS AT SIDEROADS & CROSSWALKS)
- STA. 92+52 RT (EDGELINES TH#5)

DURABLE 4 INCH YELLOW LINE, TYPE I TAPE

- STA. 87+25 - STA. 94+25 (SOLID LT & RT)
- (WITH CENTERLINE BREAKS AT SIDEROADS & CROSSWALKS)
- STA. 92+52 RT (CENTERLINE TH#5)

TEMPORARY 4 INCH WHITE LINE, PAINT

- STA. 87+25 - STA. 94+25 (SOLID LT & RT)
- (WITH EDGELINE BREAKS AT SIDEROADS & CROSSWALKS)
- STA. 92+52 RT (EDGELINES TH#5)

TEMPORARY 4 INCH YELLOW LINE, PAINT

- STA. 87+25 - STA. 94+25 (SOLID LT & RT)
- (WITH CENTERLINE BREAKS AT SIDEROADS & CROSSWALKS)
- STA. 92+52 RT (CENTERLINE TH#5)

DURABLE 8 INCH WHITE LINE, TYPE I TAPE

- STA. 88+33 - STA. 88+53 (HATCH RT)
- STA. 88+55 - STA. 88+75 (HATCH LT)
- STA. 88+86 - STA. 89+06 (HATCH LT & RT)
- STA. 90+56 - STA. 90+76 (HATCH LT)
- STA. 90+60 - STA. 90+80 (HATCH RT)
- STA. 90+92 - STA. 91+12 (HATCH LT)

TEMPORARY 8 INCH WHITE LINE, PAINT

- STA. 88+33 - STA. 88+53 (HATCH RT)
- STA. 88+55 - STA. 88+75 (HATCH LT)
- STA. 88+86 - STA. 89+06 (HATCH LT & RT)
- STA. 90+56 - STA. 90+76 (HATCH LT)
- STA. 90+60 - STA. 90+80 (HATCH RT)
- STA. 90+92 - STA. 91+12 (HATCH LT)

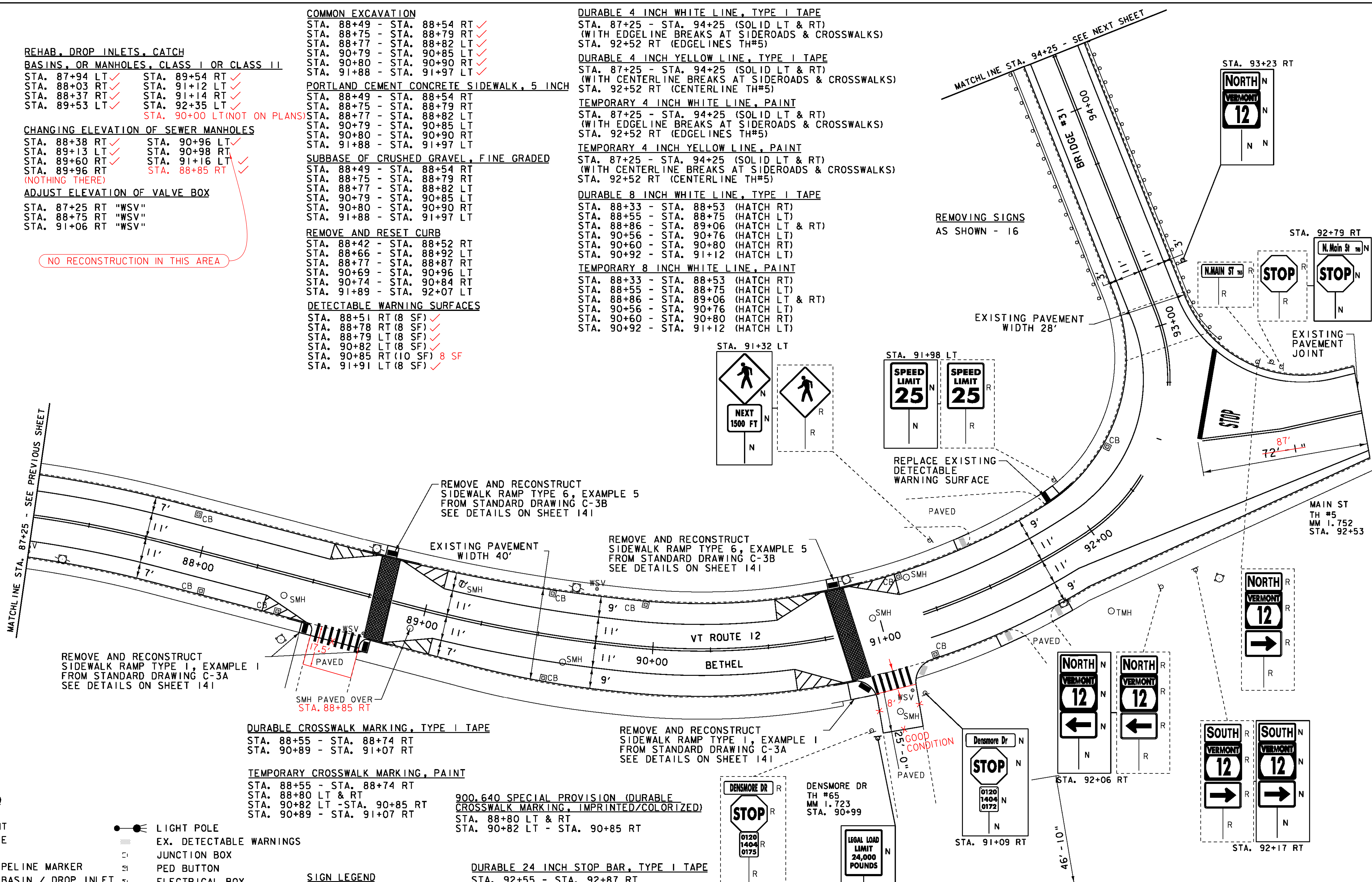

- LEGEND**
- SIGN
 - HYDRANT
 - MANHOLE
 - VALVE
 - GAS PIPELINE MARKER
 - CATCH BASIN / DROP INLET
 - CURB INLET
 - ⊠ TRAFFIC CONTROL BOX
 - ⊠ PARKING METER
 - ⊠ UTILITY POLE
 - DETECTABLE WARNINGS
 - LIGHT POLE
 - ▨ EX. DETECTABLE WARNINGS
 - JUNCTION BOX
 - ⊠ PED BUTTON
 - ⊠ ELECTRICAL BOX
 - ⊠ SIGNAL
 - ⊠ PEDESTAL POST
 - ⊠ STRAIN POLE
 - CAMERA
 - VDZ VIDEO DETECTION ZONE

- SIGN LEGEND**
- R = REMOVE
 - R&S = REMOVE AND SALVAGE
 - RET = RETAIN
 - S = SALVAGE
 - N = NEW
 - B-B = BACK TO BACK

- DURABLE 24 INCH STOP BAR, TYPE I TAPE**
- STA. 92+55 - STA. 92+87 RT
- TEMPORARY 24 INCH STOP BAR, PAINT**
- STA. 92+55 - STA. 92+87 RT
- DURABLE LETTER OR SYMBOL, TYPE I TAPE**
- STA. 92+64 RT "STOP"
- TEMPORARY LETTER OR SYMBOL, PAINT**
- STA. 92+64 RT "STOP"

NOT TO SCALE

PROJECT LAYOUT SHEET 3

PROJECT NAME: BETHEL-NORTHFIELD
 PROJECT NUMBER: STP 2922(I)

FILE NAME: piOC246.dgn
 PROJECT LEADER: CDL
 DESIGNED BY: SJL
 PLOT FILE: piOC246.22.1

PLOT DATE: 1/3/13
 DRAWN BY: JBG
 CHECKED BY: CDL
 SHEET 22 OF 149