

REHAB. DROP INLETS, CATCH BASINS, OR MANHOLES, CLASS I OR CLASS II

| | |
|---------------|---------------|
| STA. 87+94 LT | STA. 89+54 RT |
| STA. 88+03 RT | STA. 91+12 LT |
| STA. 88+37 RT | STA. 91+14 RT |
| STA. 89+53 LT | STA. 92+35 LT |

CHANGING ELEVATION OF SEWER MANHOLES

| | |
|---------------|---------------|
| STA. 88+38 RT | STA. 90+96 LT |
| STA. 89+13 LT | STA. 90+98 RT |
| STA. 89+60 RT | STA. 91+16 LT |
| STA. 89+96 RT | |

ADJUST ELEVATION OF VALVE BOX

| |
|---------------------|
| STA. 87+25 RT "WSV" |
| STA. 88+75 RT "WSV" |
| STA. 91+06 RT "WSV" |

COMMON EXCAVATION

| |
|----------------------------|
| STA. 88+49 - STA. 88+54 RT |
| STA. 88+75 - STA. 88+79 RT |
| STA. 88+77 - STA. 88+82 LT |
| STA. 90+79 - STA. 90+85 LT |
| STA. 90+80 - STA. 90+90 RT |
| STA. 91+88 - STA. 91+97 LT |

PORTLAND CEMENT CONCRETE SIDEWALK, 5 INCH

| |
|----------------------------|
| STA. 88+49 - STA. 88+54 RT |
| STA. 88+75 - STA. 88+79 RT |
| STA. 88+77 - STA. 88+82 LT |
| STA. 90+79 - STA. 90+85 LT |
| STA. 90+80 - STA. 90+90 RT |
| STA. 91+88 - STA. 91+97 LT |

SUBBASE OF CRUSHED GRAVEL, FINE GRADED

| |
|----------------------------|
| STA. 88+49 - STA. 88+54 RT |
| STA. 88+75 - STA. 88+79 RT |
| STA. 88+77 - STA. 88+82 LT |
| STA. 90+79 - STA. 90+85 LT |
| STA. 90+80 - STA. 90+90 RT |
| STA. 91+88 - STA. 91+97 LT |

REMOVE AND RESET CURB

| |
|----------------------------|
| STA. 88+42 - STA. 88+52 RT |
| STA. 88+66 - STA. 88+92 LT |
| STA. 88+77 - STA. 88+87 RT |
| STA. 90+69 - STA. 90+96 LT |
| STA. 90+74 - STA. 90+84 RT |
| STA. 91+89 - STA. 92+07 LT |

DETECTABLE WARNING SURFACES

| |
|-----------------------|
| STA. 88+51 RT (8 SF) |
| STA. 88+78 RT (8 SF) |
| STA. 88+79 LT (8 SF) |
| STA. 90+82 LT (8 SF) |
| STA. 90+85 RT (10 SF) |
| STA. 91+91 LT (8 SF) |

DURABLE 4 INCH WHITE LINE, TYPE I TAPE

| |
|--|
| STA. 87+25 - STA. 94+25 (SOLID LT & RT) |
| (WITH EDGELINE BREAKS AT SIDEROADS & CROSSWALKS) |
| STA. 92+52 RT (EDGELINES TH#5) |

DURABLE 4 INCH YELLOW LINE, TYPE I TAPE

| |
|--|
| STA. 87+25 - STA. 94+25 (SOLID LT & RT) |
| (WITH CENTERLINE BREAKS AT SIDEROADS & CROSSWALKS) |
| STA. 92+52 RT (CENTERLINE TH#5) |

TEMPORARY 4 INCH WHITE LINE, PAINT

| |
|--|
| STA. 87+25 - STA. 94+25 (SOLID LT & RT) |
| (WITH EDGELINE BREAKS AT SIDEROADS & CROSSWALKS) |
| STA. 92+52 RT (EDGELINES TH#5) |

TEMPORARY 4 INCH YELLOW LINE, PAINT

| |
|--|
| STA. 87+25 - STA. 94+25 (SOLID LT & RT) |
| (WITH CENTERLINE BREAKS AT SIDEROADS & CROSSWALKS) |
| STA. 92+52 RT (CENTERLINE TH#5) |

DURABLE 8 INCH WHITE LINE, TYPE I TAPE

| |
|---|
| STA. 88+33 - STA. 88+53 (HATCH RT) |
| STA. 88+55 - STA. 88+75 (HATCH LT) |
| STA. 88+86 - STA. 89+06 (HATCH LT & RT) |
| STA. 90+56 - STA. 90+76 (HATCH LT) |
| STA. 90+60 - STA. 90+80 (HATCH RT) |
| STA. 90+92 - STA. 91+12 (HATCH LT) |

TEMPORARY 8 INCH WHITE LINE, PAINT

| |
|---|
| STA. 88+33 - STA. 88+53 (HATCH RT) |
| STA. 88+55 - STA. 88+75 (HATCH LT) |
| STA. 88+86 - STA. 89+06 (HATCH LT & RT) |
| STA. 90+56 - STA. 90+76 (HATCH LT) |
| STA. 90+60 - STA. 90+80 (HATCH RT) |
| STA. 90+92 - STA. 91+12 (HATCH LT) |

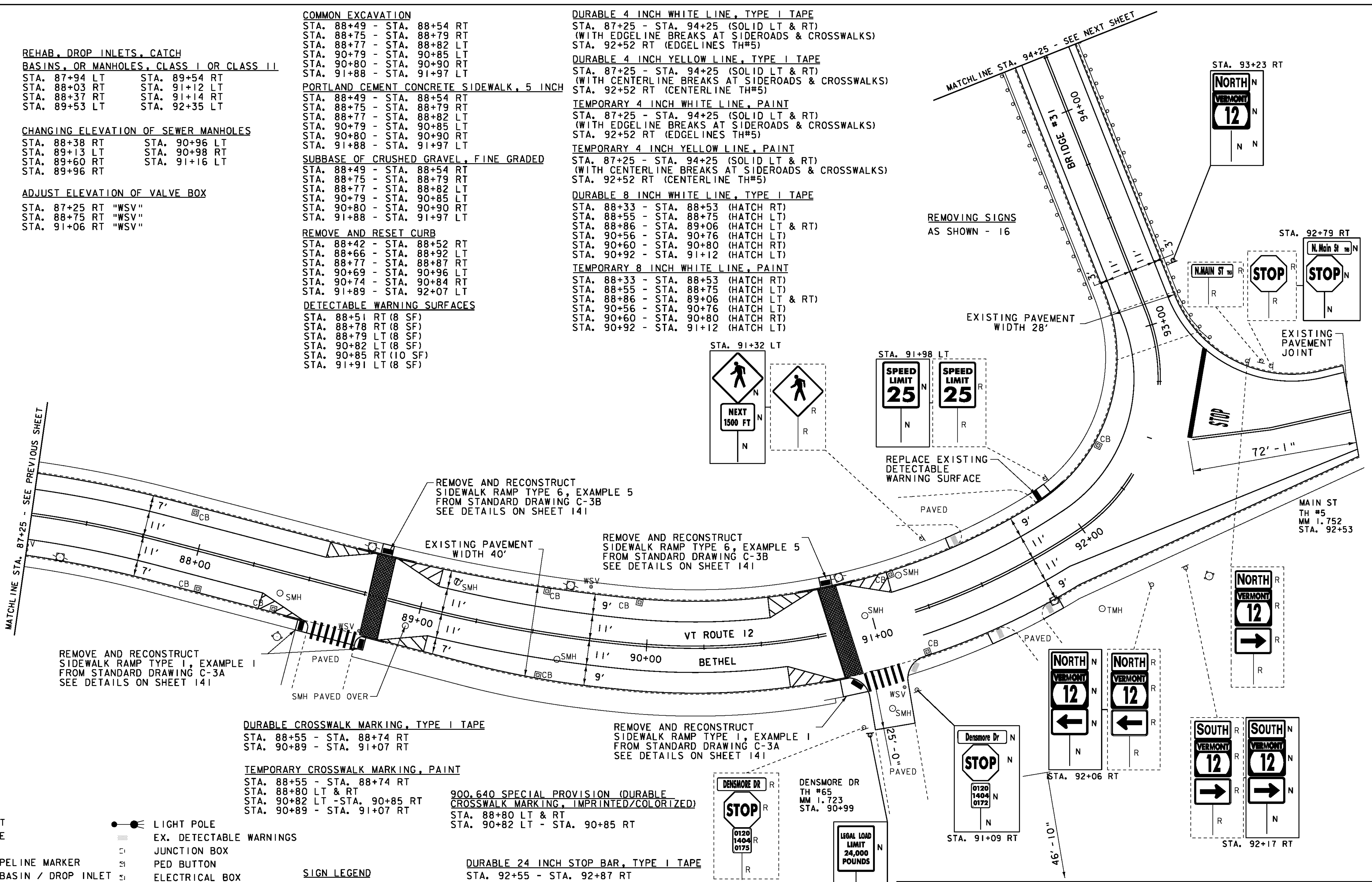

- LEGEND**
- SIGN
 - HYDRANT
 - MANHOLE
 - VALVE
 - GAS PIPELINE MARKER
 - CATCH BASIN / DROP INLET
 - CURB INLET
 - TRAFFIC CONTROL BOX
 - PARKING METER
 - UTILITY POLE
 - DETECTABLE WARNINGS
 - LIGHT POLE
 - EX. DETECTABLE WARNINGS
 - JUNCTION BOX
 - PED BUTTON
 - ELECTRICAL BOX
 - SIGNAL
 - PEDESTAL POST
 - STRAIN POLE
 - CAMERA
 - VIDEO DETECTION ZONE

DURABLE CROSSWALK MARKING, TYPE I TAPE

| |
|----------------------------|
| STA. 88+55 - STA. 88+74 RT |
| STA. 90+89 - STA. 91+07 RT |

TEMPORARY CROSSWALK MARKING, PAINT

| |
|-------------------------------|
| STA. 88+55 - STA. 88+74 RT |
| STA. 88+80 LT & RT |
| STA. 90+82 LT - STA. 90+85 RT |
| STA. 90+89 - STA. 91+07 RT |

900.640 SPECIAL PROVISION (DURABLE CROSSWALK MARKING, IMPRINTED/COLORIZED)

| |
|-------------------------------|
| STA. 88+80 LT & RT |
| STA. 90+82 LT - STA. 90+85 RT |

SIGN LEGEND

| |
|--------------------------|
| R = REMOVE |
| R&S = REMOVE AND SALVAGE |
| RET = RETAIN |
| S = SALVAGE |
| N = NEW |
| B-B = BACK TO BACK |

DURABLE 24 INCH STOP BAR, TYPE I TAPE

| |
|----------------------------|
| STA. 92+55 - STA. 92+87 RT |
|----------------------------|

TEMPORARY 24 INCH STOP BAR, PAINT

| |
|----------------------------|
| STA. 92+55 - STA. 92+87 RT |
|----------------------------|

DURABLE LETTER OR SYMBOL, TYPE I TAPE

| |
|----------------------|
| STA. 92+64 RT "STOP" |
|----------------------|

TEMPORARY LETTER OR SYMBOL, PAINT

| |
|----------------------|
| STA. 92+64 RT "STOP" |
|----------------------|

NOT TO SCALE

PROJECT LAYOUT SHEET 3

PROJECT NAME: BETHEL-NORTHFIELD
 PROJECT NUMBER: STP 2922(I)
 FILE NAME: p10C246.dgn
 PROJECT LEADER: CDL
 DESIGNED BY: SJL
 PLOT FILE: p10C246.22.i
 PLOT DATE: 1/3/13
 DRAWN BY: JBG
 CHECKED BY: CDL
 SHEET 22 OF 149