

DURABLE 4 INCH WHITE LINE, SEE OPTION ITEMS  
 STA. 322+50 - STA. 327+75 (SOLID LT & RT)

TEMPORARY 4 INCH WHITE LINE, PAINT  
 STA. 322+50 - STA. 327+75 (SOLID LT & RT)

PRECAST REINFORCED CONCRETE  
 DROP INLET WITH CAST IRON GRATE  
 STA. 325+91 LT

DURABLE 4 INCH YELLOW LINE, POLYUREA  
 STA. 322+50 - STA. 327+75 (CENTERLINE)

TEMPORARY 4 INCH YELLOW LINE, PAINT  
 STA. 322+50 - STA. 327+75 (CENTERLINE)

12" CSP .064 (2-2/3 X 1/2)  
~~STA. 325+91 LT 2.0'~~ 20.0'  
 STA. 325+69 - STA. 325+90 LT 21.0'  
 STA. 325+92 - STA. 325+98 LT 6.0'

MILLED RUMBLE STRIPS  
 STA. 322+50 - STA. 323+00 (CENTERLINE)

18" CPEP(SL)  
 STA. 325+91 LT-1.5'

8 REMOVE EXISTING CB AND  
 INSTALL NEW CB WITH  
 CAST IRON GRATE (TYPE D)  
 STA. 325+91 LT 17.0' 1.5'x18" CPEP  
 EXTEND 12" CMP 2.0' LT  
 MATCH EXISTING SLOPE  
 AND CONNECT TO NEW DI  
 RIM EL. = 673.23'

9 REMOVE EXISTING 12" CMP AND  
 INSTALL NEW 12" CMP 21.0' MIN. 20'x12" CSP  
 STA. 325+69 - STA. 325+90 LT  
 INV. IN = 671.67  
 INV. OUT = 670.83

10 REMOVE EXISTING 12" CMP AND  
 INSTALL NEW 12" CMP 6.0' MIN. 10'x12" CSP  
 STA. 325+92 - STA. 325+98 LT  
 INV. IN = 671.68  
 INV. OUT = 671.35

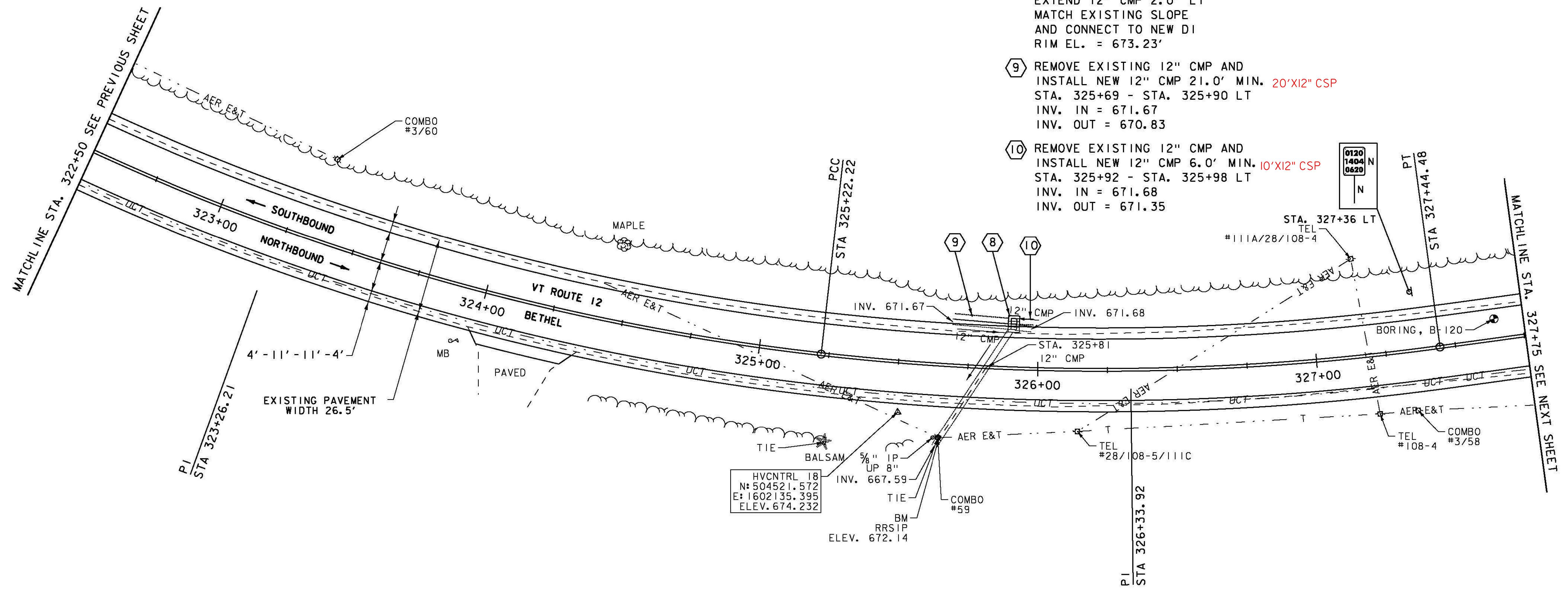
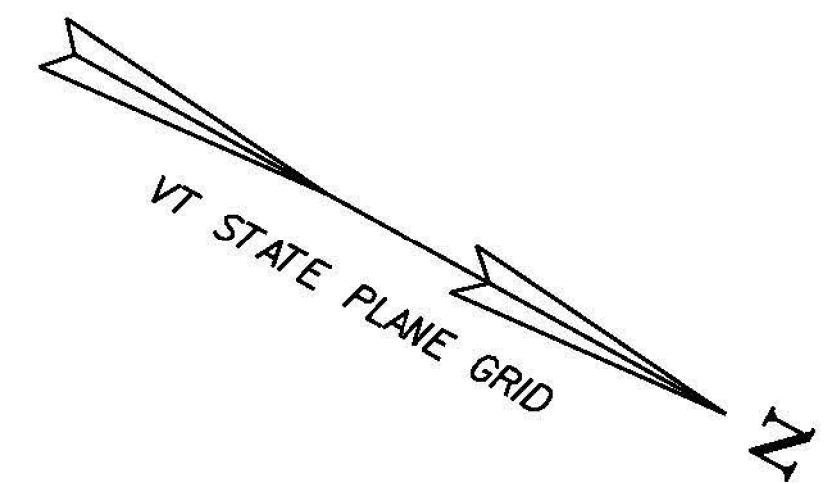

**SIGN LEGEND**  
 R = REMOVE  
 R&S = REMOVE AND SALVAGE  
 RET = RETAIN  
 S = SALVAGED  
 N = NEW  
 B-B = BACK TO BACK  
 - - = EXISTING  
 — = NEW

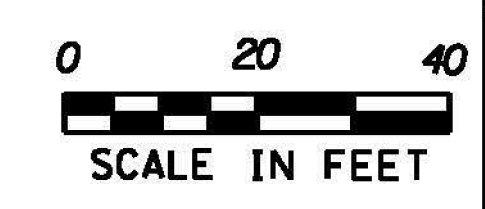

PROJECT NAME: BETHEL-RANDOLPH	PLOT DATE: 4/23/2015
PROJECT NUMBER: STP 292(I)	DRAWN BY: S. LAMPHERE
FILE NAME: z10c244bdr.dgn	CHECKED BY: C. LATHROP
DESIGNED BY: S. LAMPHERE	SHEET 63 OF 211