

~~REHAB DROP INLETS, CATCH BASINS,  
OR MANHOLES, CLASS 1~~  
~~STA. 295+05 RT (MANHOLE COVER)~~

DURABLE 4 INCH WHITE LINE, SEE OPTION ITEMS  
STA. 294+25 - STA. 299+75 (SOLID LT & RT)  
DURABLE 4 INCH YELLOW LINE, POLYUREA  
STA. 294+25 - STA. 299+75 (CENTERLINE)

TEMPORARY 4 INCH WHITE LINE, PAINT  
STA. 294+25 - STA. 299+75 (SOLID LT & RT)  
TEMPORARY 4 INCH YELLOW LINE, PAINT  
STA. 294+25 - STA. 299+75 (CENTERLINE)

STONE FILL, TYPE J  
STA. 299+53 - STA. 299+75 RT

6 INCH UNDERDRAIN PIPE  
~~STA. 294+25 - STA. 294+50 LT~~  
~~STA. 295+05 - STA. 296+75 RT 296+52~~  
~~STA. 296+75 - STA. 298+50 RT~~  
~~STA. 296+75 - STA. 299+75 LT~~

REMOVING SIGNS  
AS SHOWN - 5  
ERECTING SALVAGED SIGNS  
AS SHOWN - 4

CURVE #24  
DELTA = 14°07'36"  
D = 3°49'11"  
R = 1500.00'  
T = 185.86'  
L = 369.84'  
E = 11.47'  
BANKING 0.062 FT/FT  
DESIGN SPEED 50 MPH  
SEE SUPERELEVATION DIAGRAMS  
FOR MORE INFORMATION

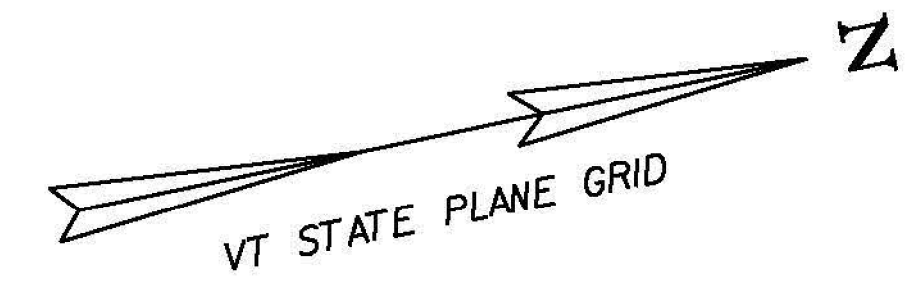
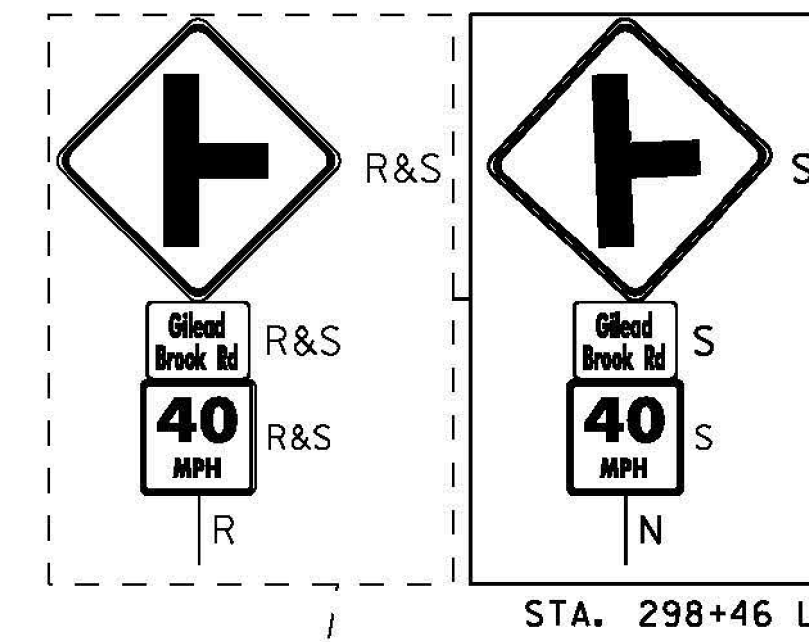

SOLID ROCK EXCAVATION  
STA. 297+00 - STA. 298+00 RT

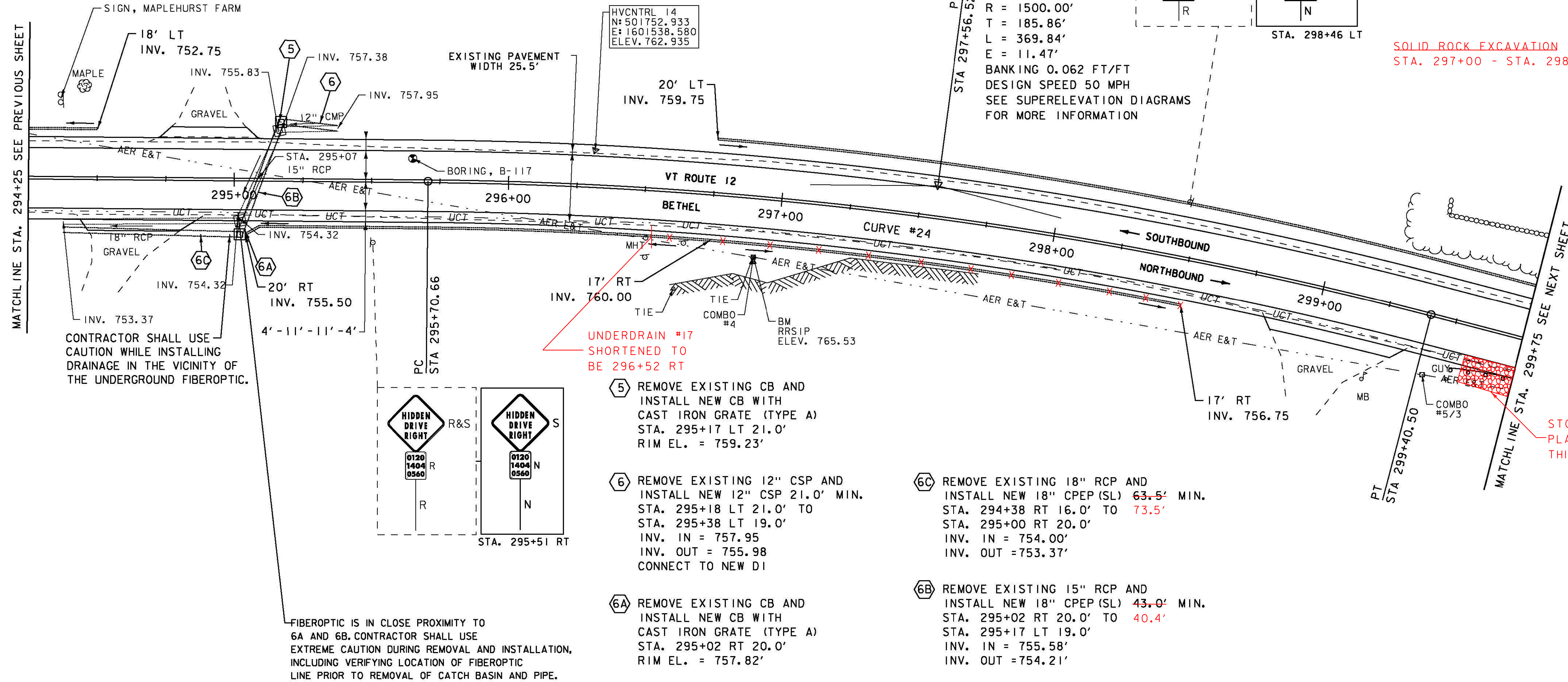

CONTRACTOR SHALL USE CAUTION WHILE INSTALLING DRAINAGE IN THE VICINITY OF THE UNDERGROUND FIBEROPTIC.

FIBEROPTIC IS IN CLOSE PROXIMITY TO 6A AND 6B. CONTRACTOR SHALL USE EXTREME CAUTION DURING REMOVAL AND INSTALLATION, INCLUDING VERIFYING LOCATION OF FIBEROPTIC LINE PRIOR TO REMOVAL OF CATCH BASIN AND PIPE.

- 5 REMOVE EXISTING CB AND INSTALL NEW CB WITH CAST IRON GRATE (TYPE A)  
STA. 295+17 LT 21.0'  
RIM EL. = 759.23'
- 6 REMOVE EXISTING 12" CSP AND INSTALL NEW 12" CSP 21.0' MIN.  
STA. 295+18 LT 21.0' TO STA. 295+38 LT 19.0'  
INV. IN = 757.95  
INV. OUT = 755.98  
CONNECT TO NEW DI
- 6A REMOVE EXISTING CB AND INSTALL NEW CB WITH CAST IRON GRATE (TYPE A)  
STA. 295+02 RT 20.0'  
RIM EL. = 757.82'
- 6B REMOVE EXISTING 15" RCP AND INSTALL NEW 18" CPEP (SL) 43.0' MIN.  
STA. 295+02 RT 20.0' TO STA. 295+17 LT 19.0'  
INV. IN = 755.58'  
INV. OUT = 754.21'
- 6C REMOVE EXISTING 18" RCP AND INSTALL NEW 18" CPEP (SL) 63.5' MIN.  
STA. 294+38 RT 16.0' TO 73.5'  
STA. 295+00 RT 20.0'  
INV. IN = 754.00'  
INV. OUT = 753.37'

SPECIAL PROVISION (BOX BEAM GUARDRAIL W/7 FEET POSTS)  
STA. 299+52 - STA. 299+75 RT

**SIGN LEGEND**  
R = REMOVE  
R&S = REMOVE AND SALVAGE  
RET = RETAIN  
S = SALVAGED  
N = NEW  
B-B = BACK TO BACK  
-- = EXISTING  
— = NEW

MILLED RUMBLE STRIPS  
STA. 295+50 - STA. 299+75 (CENTERLINE)

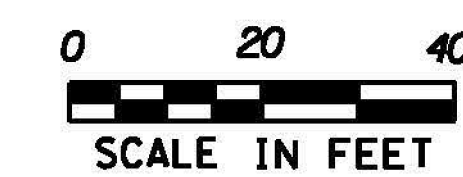

PROJECT NAME: BETHEL-RANDOLPH	PROJECT NUMBER: STP 292(I)
FILE NAME: z10c244bdr.dgn	PLOT DATE: 4/23/2015
PROJECT LEADER: C. LATHROP	DRAWN BY: S. LAMPHERE
DESIGNED BY: S. LAMPHERE	CHECKED BY: C. LATHROP
PLAN SHEET 32	SHEET 58 OF 211