

DURABLE 4 INCH WHITE LINE, SEE OPTION ITEMS
 STA. 250+75 - STA. 256+50 (SOLID LT & RT)

TEMPORARY 4 INCH WHITE LINE, PAINT
 STA. 250+75 - STA. 256+50 (SOLID LT & RT)

DURABLE 4 INCH YELLOW LINE, POLYUREA
 STA. 250+75 - STA. 255+66 (DASHED RT)
 STA. 255+66 - STA. 256+50 (DASHED LT, SOLID RT)
 255+57

TEMPORARY 4 INCH YELLOW LINE, PAINT
 STA. 250+75 - STA. 255+66 (DASHED RT)
 STA. 255+66 - STA. 256+50 (DASHED LT, SOLID RT)

MILLED RUMBLE STRIPS
 STA. 250+75 - STA. 254+50 (CENTERLINE)

REMOVING SIGNS
 AS SHOWN - 1

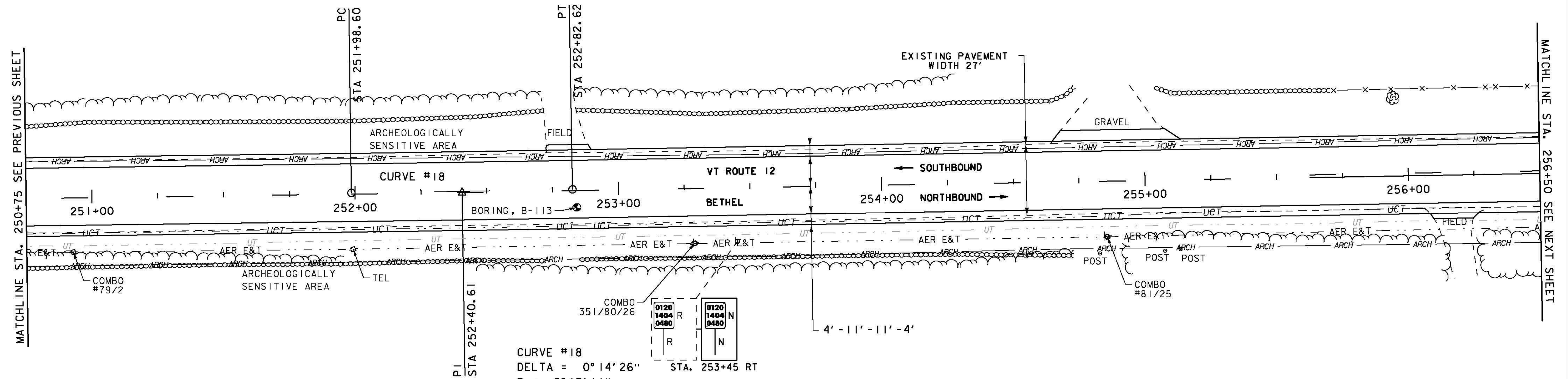
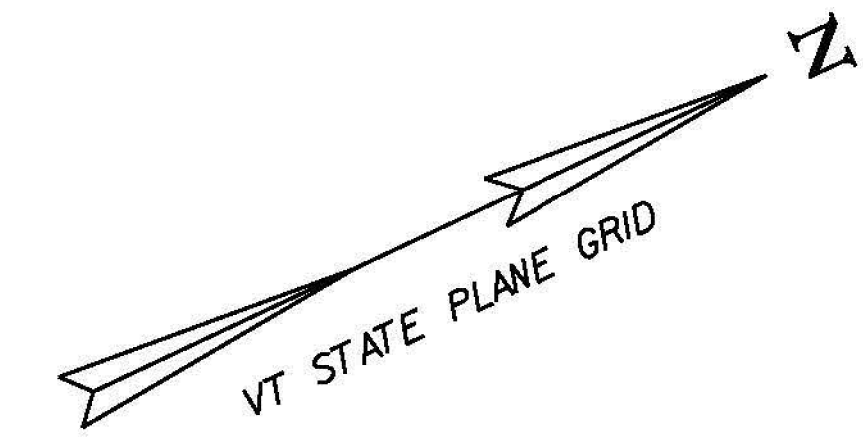

CURVE #18
 DELTA = 0° 14' 26"
 D = 0° 17' 11"
 R = 20000.00'
 T = 42.01'
 L = 84.01'
 E = 0.04'
 BANKING NORMAL CROWN
 DESIGN SPEED 50 MPH
 SEE SUPERELEVATION DIAGRAMS
 FOR MORE INFORMATION

SIGN LEGEND

- R = REMOVE
- R&S = REMOVE AND SALVAGE
- RET = RETAIN
- S = SALVAGED
- N = NEW
- B-B = BACK TO BACK
- - = EXISTING
- = NEW

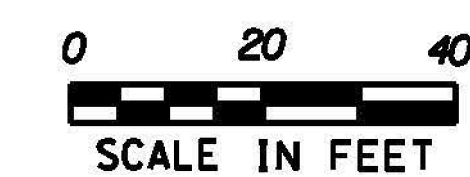

| | | |
|-------------------------------|----------------------------|------------------------|
| PROJECT NAME: BETHEL-RANDOLPH | FILE NAME: z10c244bdr.dgn | PLOT DATE: 4/23/2015 |
| PROJECT NUMBER: STP 292(I) | PROJECT LEADER: C. LATHROP | DRAWN BY: S. LAMPHERE |
| | DESIGNED BY: S. LAMPHERE | CHECKED BY: C. LATHROP |
| | PLAN SHEET 24 | SHEET 50 OF 211 |