

REMOVING SIGNS
AS SHOWN - 2

ERECTING SALVAGED SIGNS
AS SHOWN - 2

PRECAST REINFORCED CONCRETE
DROP INLET WITH CAST IRON GRATE
STA. 154+21 LT

15" RCP
~~24" CPEP (SL)~~ 7.0'
STA. 154+21 LT 3.0'

DURABLE 4 INCH WHITE LINE, SEE OPTION ITEMS
STA. 151+50 - STA. 156+75 (SOLID LT & RT)

TEMPORARY 4 INCH WHITE LINE, PAINT
STA. 151+50 - STA. 156+75 (SOLID LT & RT)

DURABLE 4 INCH YELLOW LINE, POLYUREA
STA. 151+50 - STA. 156+75 (CENTERLINE)

TEMPORARY 4 INCH YELLOW LINE, PAINT
STA. 151+50 - STA. 156+75 (CENTERLINE)

6 INCH UNDERDRAIN PIPE
STA. 153+25 - STA. 154+20 LT
STA. 154+25 - STA. 155+75 LT

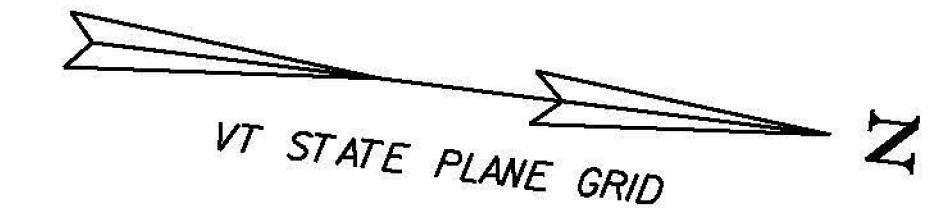

CURVE #4
DELTA = 28°24'48"
D = 3°46'55" (1) D = 9°32'57" (2)
R = 1515.00' (1) R = 600.00' (2)
T = 213.71' (1) T = 156.95' (2)
L = 109.79' (1) L = 254.06' (2)
E = 15.00'
BANKING 0.061 FT/FT, 0.080 FT/FT
DESIGN SPEED 50/45 MPH
SEE SUPERELEVATION DIAGRAMS
FOR MORE INFORMATION

ENVIRONMENTALLY SENSITIVE LOCATIONS:

NO.	LIMITS	POS.	TYPE
2.	STA. 151+50 - STA. 155+54	RT	-
3.	STA. 154+75 - STA. 156+75	LT	-

3 REMOVE EXISTING DI AND
INSTALL NEW DI WITH
CAST IRON GRATE (TYPE A)
STA. 154+21 LT 19.8'
EXTEND ~~24" CPEP (SL)~~ 15" RCP
MATCH EXISTING SLOPE
AND CONNECT TO NEW DI NEW 7.0'X15" RCP, CULV.
RIM EL. = 584.87'

CURVE #5
DELTA = 0°29'25"
D = 0°34'23"
R = 10000.00'
T = 42.79'
L = 85.59'
E = 0.09'
BANKING NORMAL CROWN
DESIGN SPEED 50 MPH
SEE SUPERELEVATION DIAGRAMS
FOR MORE INFORMATION

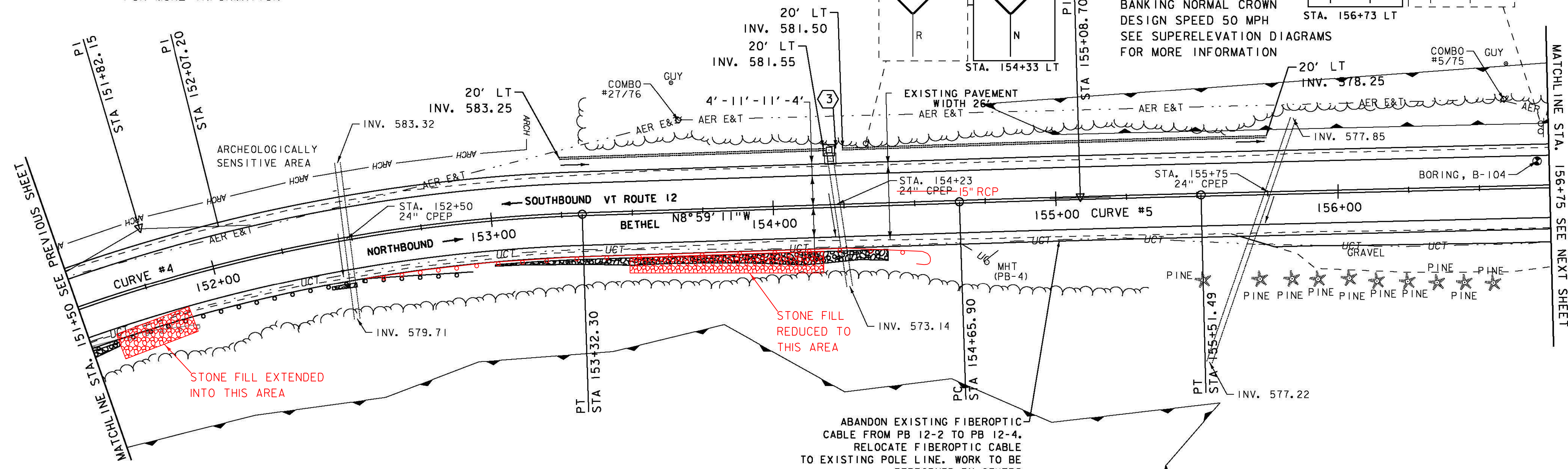
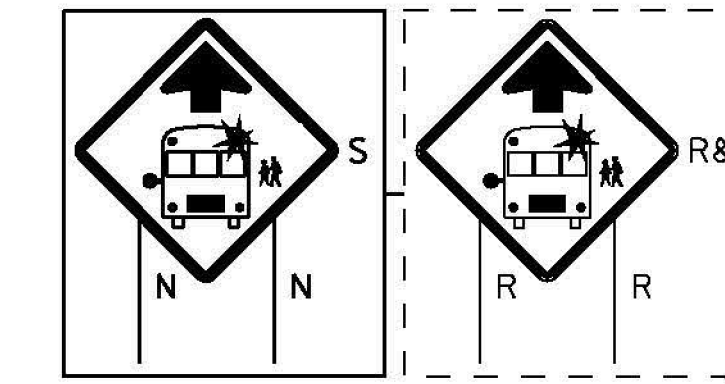

REMOVAL AND DISPOSAL OF GUARDRAIL
STA. 151+50 - STA. 151+79.25 RT
SPECIAL PROVISION (BOX BEAM GUARDRAIL W/7 FEET POSTS)
STA. 151+50 - STA. 152+92-RT
155+48

STONE FILL, TYPE | 151+85
STA. 151+50 - STA. 151+60 RT
STA. 152+40 - STA. 152+49 RT
STA. 153+00 - STA. 154+40 RT
153+50 154+20

MILLED RUMBLE STRIPS
STA. 153+00 - STA. 156+75 (CENTERLINE)

GEOTEXTILE FOR SILT FENCE
STA. 151+50 - STA. 151+60 RT
STA. 152+40 - STA. 152+49 RT
STA. 153+00 - STA. 154+40 RT

GRUBBING MATERIAL (6")
STA. 151+50 - STA. 151+60 RT
STA. 152+40 - STA. 152+49 RT
STA. 153+00 - STA. 154+40 RT

SIGN LEGEND
R = REMOVE
R&S = REMOVE AND SALVAGE
RET = RETAIN
S = SALVAGED
N = NEW
B-B = BACK TO BACK
- - = EXISTING
— = NEW

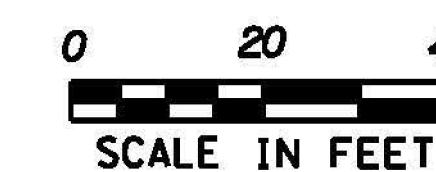

PROJECT NAME:	BETHEL-RANDOLPH	PLOT DATE:	4/23/2015
PROJECT NUMBER:	STP 292(I)	DRAWN BY:	S. LAMPHERE
FILE NAME:	z10c244bdr.dgn	DESIGNED BY:	S. LAMPHERE
		CHECKED BY:	C. LATHROP
		PLAN SHEET 6	SHEET 32 OF 211