

STONE FILL, TYPE I  
STA. 35+50 TO 36+10, RT

RELOCATE MAILBOX, SINGLE SUPPORT  
STA. 32+21, LT

DURABLE 4 INCH WHITE LINE  
(ALL LINES WILL INCLUDE EDGE LINE BREAKS AND RADII FOR SIDE ROADS)  
STA. 30+50 TO 36+50, SOLID LT & RT

DURABLE 4 INCH YELLOW LINE  
(ALL LINES WILL INCLUDE  $\phi$  BREAKS FOR SIDE ROADS)  
STA. 30+50 TO 32+74, SOLID LT & RT  
STA. 32+74 TO 36+50, SOLID LT, DASHED RT

TEMPORARY 4 INCH WHITE LINE, PAINT  
(ALL LINES WILL INCLUDE EDGE LINE BREAKS AND RADII FOR SIDE ROADS)  
STA. 30+50 TO 36+50, SOLID LT & RT

TEMPORARY 4 INCH YELLOW LINE, PAINT  
(ALL LINES WILL INCLUDE  $\phi$  BREAKS FOR SIDE ROADS)  
STA. 30+50 TO 32+74, SOLID LT & RT  
STA. 32+74 TO 36+50, SOLID LT, DASHED RT

GEOTEXTILE UNDER STONE FILL  
STA. 35+50 TO 36+10, RT

GRUBBING MATERIAL  
STA. 35+50 TO 36+10, RT

REMOVING SIGNS  
AS SHOWN - 2

ERECTING SALVAGED SIGNS  
AS SHOWN - 1

UD-150 STA 33+10 TO 42+10, LT  
CONSTRUCT 6 INCH UNDERDRAIN PIPE,  
SEE SHEET 12 FOR DETAIL.

UD-150 STA 33+15 TO 42+10, RT  
CONSTRUCT 6 INCH UNDERDRAIN PIPE,  
SEE SHEET 12 FOR DETAIL.

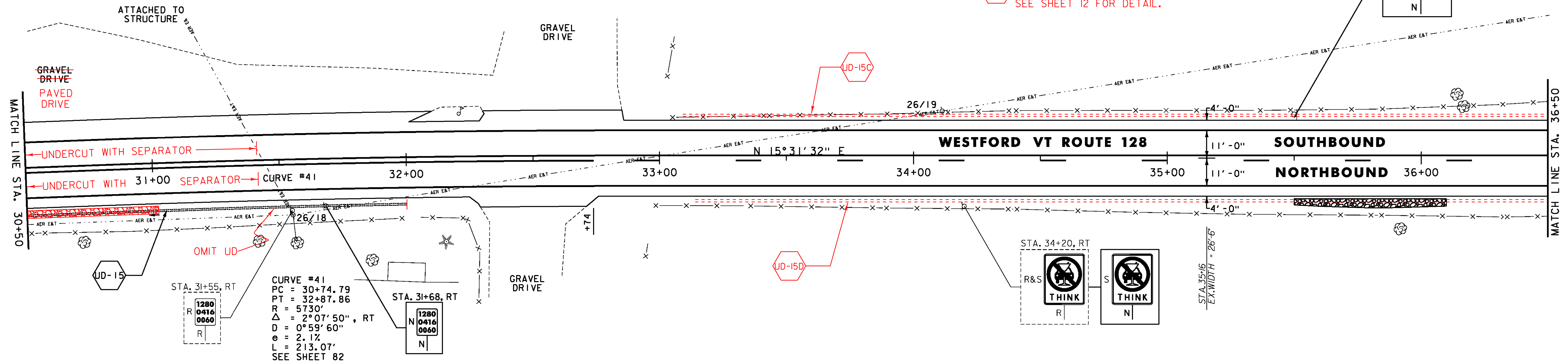

STONE FILL, TYPE I  
STA. 38+40 TO 39+20, RT  
STA. 41+40 TO 42+20, RT

RELOCATE MAILBOX, SINGLE SUPPORT  
STA. 39+31, LT

DURABLE 4 INCH WHITE LINE  
(ALL LINES WILL INCLUDE EDGE LINE BREAKS AND RADII FOR SIDE ROADS)  
STA. 36+50 TO 42+50, SOLID LT & RT

DURABLE 4 INCH YELLOW LINE  
(ALL LINES WILL INCLUDE  $\phi$  BREAKS FOR SIDE ROADS)  
STA. 36+50 TO 40+66, SOLID LT, DASHED RT  
STA. 40+66 TO 42+50, DASHED  $\phi$

TEMPORARY 4 INCH WHITE LINE, PAINT  
(ALL LINES WILL INCLUDE EDGE LINE BREAKS AND RADII FOR SIDE ROADS)  
STA. 36+50 TO 42+50, SOLID LT & RT

TEMPORARY 4 INCH YELLOW LINE, PAINT  
(ALL LINES WILL INCLUDE  $\phi$  BREAKS FOR SIDE ROADS)  
STA. 36+50 TO 40+66, SOLID LT, DASHED RT  
STA. 40+66 TO 42+50, DASHED  $\phi$

GEOTEXTILE UNDER STONE FILL  
STA. 38+40 TO 39+20, RT  
STA. 41+40 TO 42+20, RT

GRUBBING MATERIAL  
STA. 38+40 TO 39+20, RT  
STA. 41+40 TO 42+20, RT

REMOVING SIGNS  
AS SHOWN - 1

29A/14

STA. 38+40 TO 39+20, RT  
STA. 41+40 TO 42+20, RT

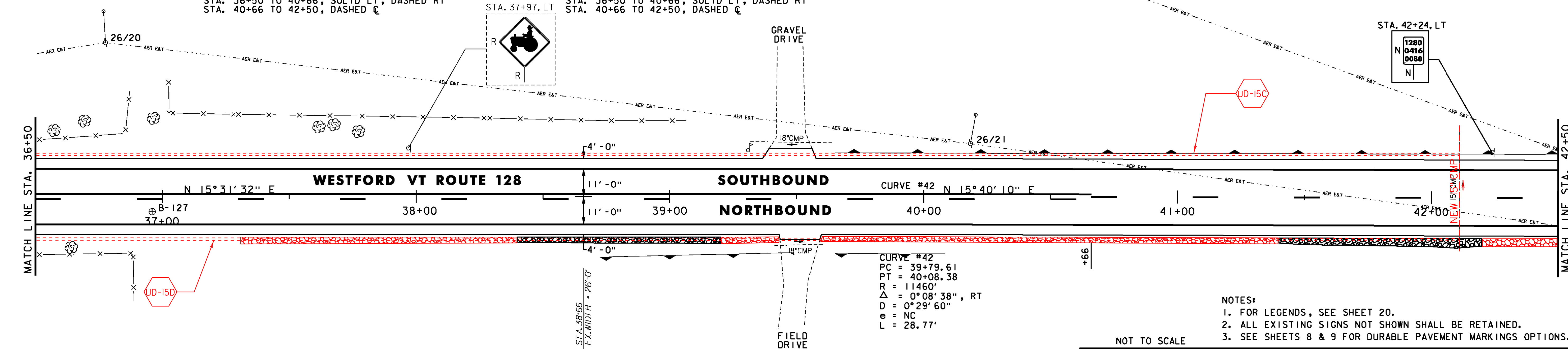

CURVE #42  
PC = 39+79.61  
PT = 40+08.38  
R = 11460'  
 $\Delta$  = 0° 08' 38", RT  
D = 0° 29' 60"  
e = NC  
L = 28.77'

- NOTES:
- FOR LEGENDS, SEE SHEET 20.
  - ALL EXISTING SIGNS NOT SHOWN SHALL BE RETAINED.
  - SEE SHEETS 8 & 9 FOR DURABLE PAVEMENT MARKINGS OPTIONS.

SOIL BORING DATA			
BORING#	DEPTH (FT.)	PCC	COMMENTS
B-127	5.0'	NO	



NOT TO SCALE

**PROJECT LAYOUT SHEET #28**

PROJECT NAME: ESSEX-WESTFORD  
PROJECT NUMBER: STP 2912(I)

FILE NAME: p10c226.dgn  
PROJECT LEADER: JLL  
DESIGNED BY: STANTEC  
IPARM FILE: p10c226128.i

PLOT DATE: 2/20/2013  
DRAWN BY: STANTEC  
CHECKED BY: STANTEC  
SHEET 47 OF 239