

RELOCATE MAILBOX, SINGLE SUPPORT
STA. 9+71, LT

DURABLE 4 INCH WHITE LINE
(ALL LINES WILL INCLUDE EDGE LINE BREAKS
AND RADII FOR SIDE ROADS)
STA. 6+50 TO 12+50, SOLID LT & RT

TEMPORARY 4 INCH WHITE LINE, PAINT
(ALL LINES WILL INCLUDE EDGE LINE BREAKS
AND RADII FOR SIDE ROADS)
STA. 6+50 TO 12+50, SOLID LT & RT

DURABLE 4 INCH YELLOW LINE
(ALL LINES WILL INCLUDE ϕ BREAKS FOR SIDE ROADS)
STA. 6+50 TO 6+86, SOLID LT, DASHED RT
STA. 6+86 TO 10+56, DASHED ϕ
STA. 10+56 TO 12+50, DASHED LT, SOLID RT

TEMPORARY 4 INCH YELLOW LINE, PAINT
(ALL LINES WILL INCLUDE ϕ BREAKS FOR SIDE ROADS)
STA. 6+50 TO 6+86, SOLID LT, DASHED RT
STA. 6+86 TO 10+56, DASHED ϕ
STA. 10+56 TO 12+50, DASHED LT, SOLID RT

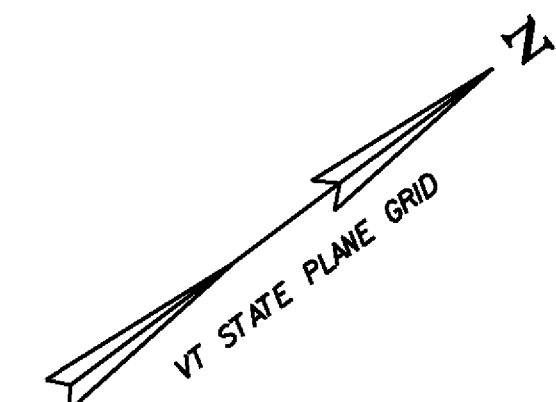

STA. 10+56, LT
N 1280
0416
0020
N

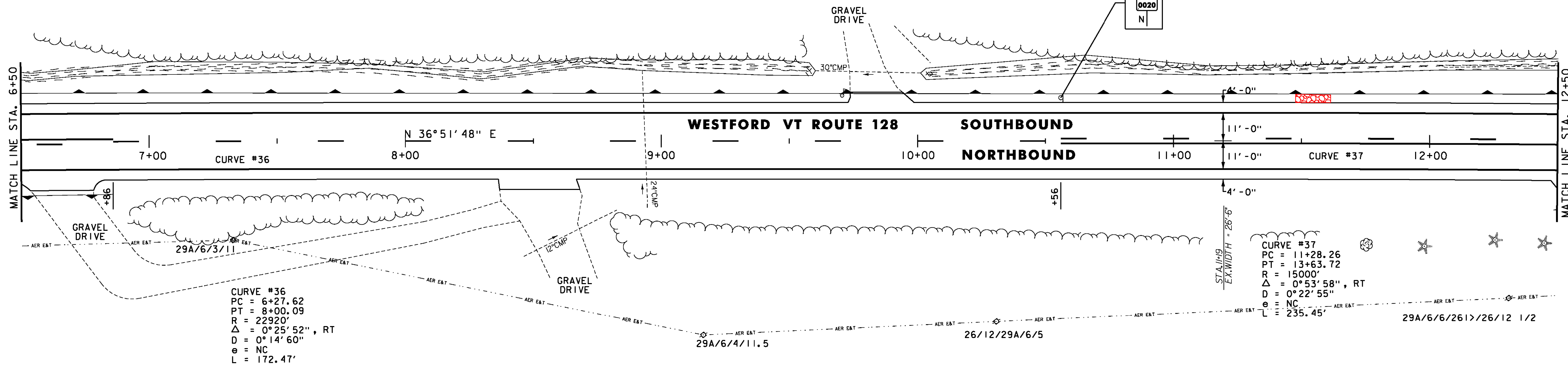

SOLID ROCK EXCAVATION
STA. 17+50 TO 18+50, LT

DURABLE 4 INCH WHITE LINE
(ALL LINES WILL INCLUDE EDGE LINE BREAKS
AND RADII FOR SIDE ROADS)
STA. 12+50 TO 18+50, SOLID LT & RT

TEMPORARY 4 INCH WHITE LINE, PAINT
(ALL LINES WILL INCLUDE EDGE LINE BREAKS
AND RADII FOR SIDE ROADS)
STA. 12+50 TO 18+50, SOLID LT & RT

GEOTEXTILE UNDER STONE FILL
STA. 16+50 TO 18+50, RT

REMOVING SIGNS
AS SHOWN - 1

STONE FILL, TYPE I
STA. 16+50 TO 18+50, RT

DURABLE 4 INCH YELLOW LINE
(ALL LINES WILL INCLUDE ϕ BREAKS FOR SIDE ROADS)
STA. 12+50 TO 18+48, DASHED LT, SOLID RT
STA. 18+48 TO 18+50, SOLID LT & RT

TEMPORARY 4 INCH YELLOW LINE, PAINT
(ALL LINES WILL INCLUDE ϕ BREAKS FOR SIDE ROADS)
STA. 12+50 TO 18+48, DASHED LT, SOLID RT
STA. 18+48 TO 18+50, SOLID LT & RT

GRUBBING MATERIAL
STA. 16+50 TO 18+50, RT

RELOCATE MAILBOX, SINGLE SUPPORT
STA. 12+60, LT
STA. 12+64, LT

UD-14C STA 17+25 TO 17+85, LT
CONSTRUCT 6 INCH UNDERDRAIN PIPE,
SEE SHEET 12 FOR DETAIL.

CURVE #38
PC = 17+01.85
PCC = 19+51.22
R = 725'
 Δ = 19°42'27", LT
D = 7°54'10"
e = 8.0%
L = 249.37'
SEE SHEET 81

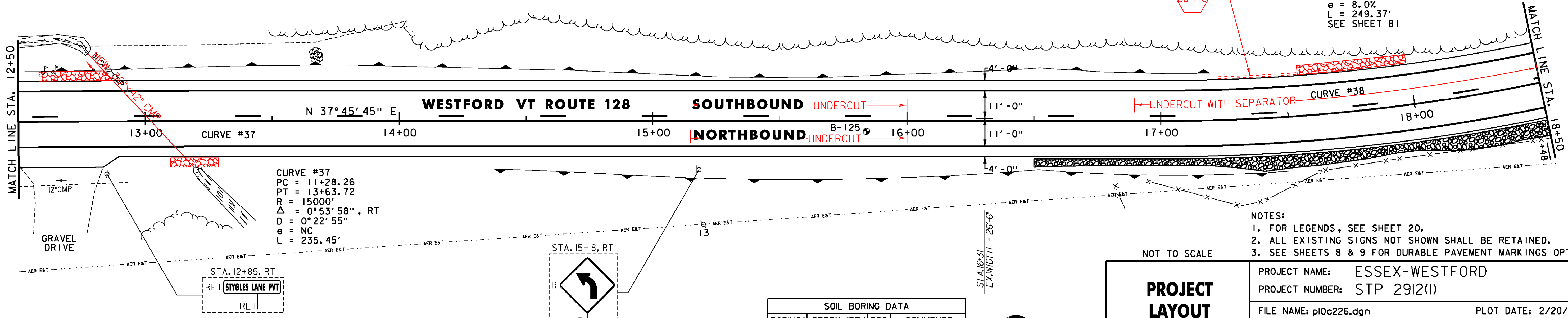
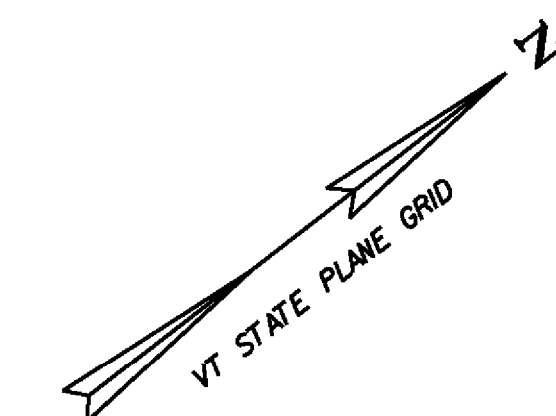

- NOTES:
1. FOR LEGENDS, SEE SHEET 20.
2. ALL EXISTING SIGNS NOT SHOWN SHALL BE RETAINED.
3. SEE SHEETS 8 & 9 FOR DURABLE PAVEMENT MARKINGS OPTIONS.

NOT TO SCALE

PROJECT LAYOUT SHEET #26

PROJECT NAME: ESSEX-WESTFORD
PROJECT NUMBER: STP 2912(I)
FILE NAME: p10c226.dgn
PROJECT LEADER: JLL
DESIGNED BY: STANTEC
IPARM FILE: p10c226126.i
PLOT DATE: 2/20/2013
DRAWN BY: STANTEC
CHECKED BY: STANTEC
SHEET 45 OF 239

SOIL BORING DATA			
BORING#	DEPTH (FT.)	PCC	COMMENTS
B-125	5.0'	NO	



STA. 12+85, RT
RET (STYGLES LANE PVT)
RET

