

STONE FILL, TYPE I
 STA. 227+50 TO 228+70, LT
 STA. 229+10 TO 229+50, LT

DURABLE 4 INCH WHITE LINE
 (ALL LINES WILL INCLUDE ϕ BREAKS
 AND RADII FOR SIDE ROADS)
 ESSEX STA. 227+50 TO 232+37.28, SOLID LT & RT
 WESTFORD STA. 0+00 TO 0+50, SOLID LT & RT

DURABLE 4 INCH YELLOW LINE
 (ALL LINES WILL INCLUDE ϕ BREAKS FOR SIDE ROADS)
 ESSEX STA. 227+50 TO 232+32, SOLID LT & RT
 ESSEX STA. 232+32 TO 232+37.28, SOLID LT, DASHED RT
 WESTFORD STA. 0+00 TO 0+50, SOLID LT, DASHED RT

TEMPORARY 4 INCH WHITE LINE, PAINT
 (ALL LINES WILL INCLUDE EDGE LINE BREAKS
 AND RADII FOR SIDE ROADS)
 ESSEX STA. 227+50 TO 232+37.28, SOLID LT & RT
 WESTFORD STA. 0+00 TO 0+50, SOLID LT & RT

TEMPORARY 4 INCH YELLOW LINE, PAINT
 (ALL LINES WILL INCLUDE ϕ BREAKS FOR SIDE ROADS)
 ESSEX STA. 227+50 TO 232+32, SOLID LT & RT
 ESSEX STA. 232+32 TO 232+37.28, SOLID LT, DASHED RT
 WESTFORD STA. 0+00 TO 0+50, SOLID LT, DASHED RT

GEOTEXTILE UNDER STONE FILL
 STA. 227+50 TO 228+70, LT
 STA. 229+10 TO 229+50, LT

REMOVING SIGNS
 AS SHOWN - 3

GRUBBING MATERIAL
 STA. 227+50 TO 228+70, LT
 STA. 229+10 TO 229+50, LT

UD-14B STA ESSEX 229+00 TO WESTFORD 0+80, RT
 CONSTRUCT 6 INCH UNDERDRAIN PIPE,
 SEE SHEET 12 FOR DETAIL.

CURVE #35
 PC = ESSEX 231+37.35
 PT = WESTFORD 1+63.50
 R = 2290'
 Δ = 6°35'03", RT
 D = 2°30'07"
 e = 4.6%
 L = 263.15'
 SEE SHEET 80

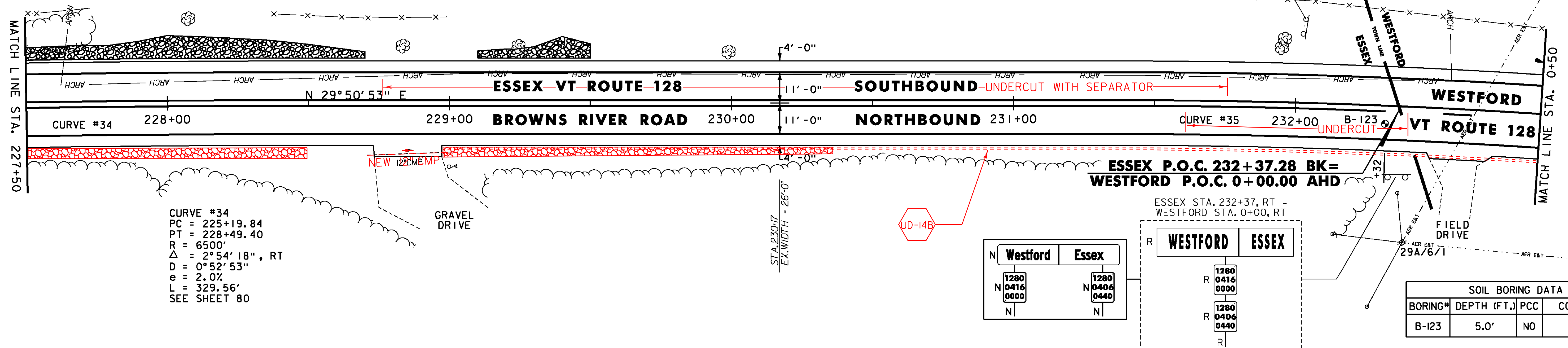
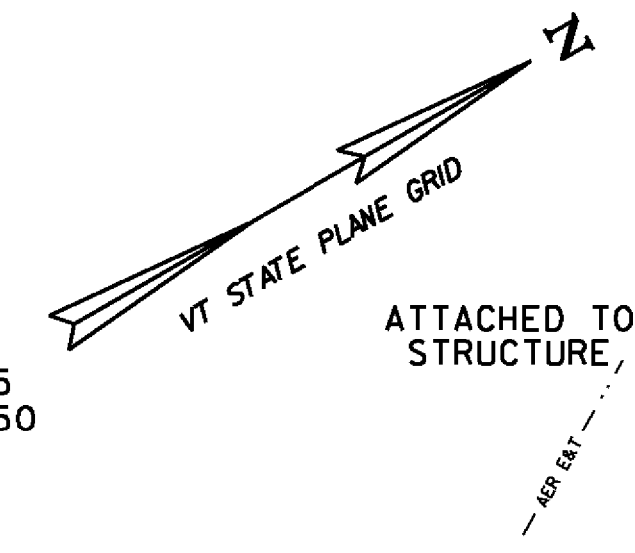

CURVE #34
 PC = 225+19.84
 PT = 228+49.40
 R = 6500'
 Δ = 2°54'18", RT
 D = 0°52'53"
 e = 2.0%
 L = 329.56'
 SEE SHEET 80

N	Westford	Essex
N	1280 0416 0000	1280 0404 0440
N		N

R	WESTFORD	ESSEX
R	1280 0416 0000	1280 0404 0440
R		R

SOIL BORING DATA			
BORING#	DEPTH (FT.)	PCC	COMMENTS
B-123	5.0'	NO	

STONE FILL, TYPE I
 STA. 0+50 TO 0+80, LT

RELOCATE MAILBOX, SINGLE SUPPORT
 STA. 1+57, LT
 STA. 4+92, LT
 STA. 6+11, LT

DURABLE 4 INCH WHITE LINE
 (ALL LINES WILL INCLUDE EDGE LINE BREAKS
 AND RADII FOR SIDE ROADS)
 STA. 0+50 TO 6+50, SOLID LT & RT

DURABLE 4 INCH YELLOW LINE
 (ALL LINES WILL INCLUDE ϕ BREAKS FOR SIDE ROADS)
 STA. 0+50 TO 6+50, SOLID LT, DASHED RT

TEMPORARY 4 INCH WHITE LINE, PAINT
 (ALL LINES WILL INCLUDE EDGE LINE BREAKS
 AND RADII FOR SIDE ROADS)
 STA. 0+50 TO 6+50, SOLID LT & RT

TEMPORARY 4 INCH YELLOW LINE, PAINT
 (ALL LINES WILL INCLUDE ϕ BREAKS FOR SIDE ROADS)
 STA. 0+50 TO 6+50, SOLID LT, DASHED RT

GEOTEXTILE UNDER STONE FILL
 STA. 0+50 TO 0+80, LT

GRUBBING MATERIAL
 STA. 0+50 TO 0+80, LT

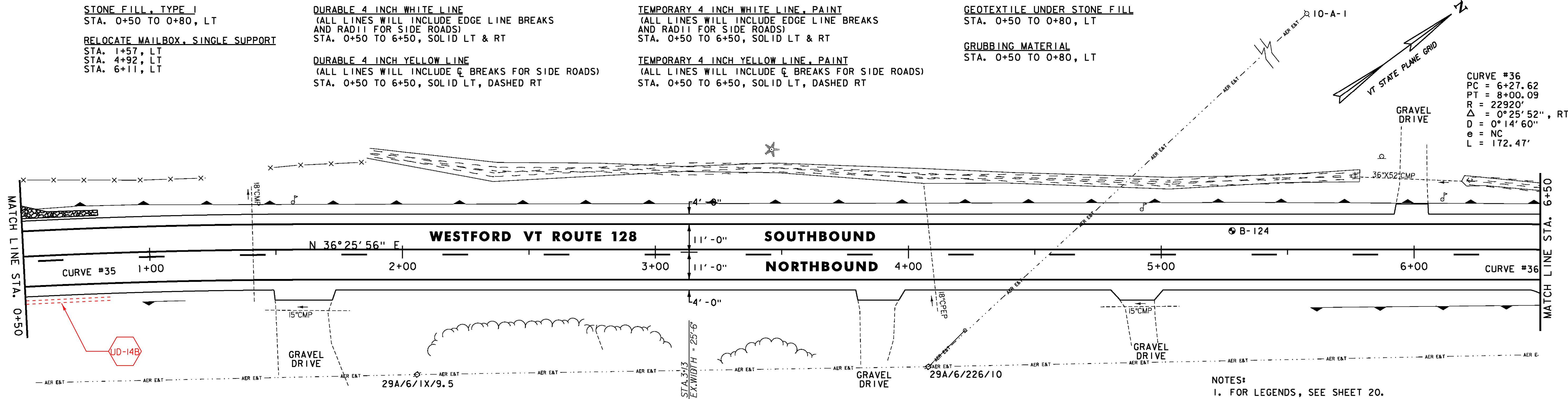

CURVE #35
 PC = ESSEX 231+37.35
 PT = WESTFORD 1+63.50
 R = 2290'
 Δ = 6°35'03", RT
 D = 2°30'07"
 e = 4.6%
 L = 263.15'
 SEE SHEET 80

SOIL BORING DATA			
BORING#	DEPTH (FT.)	PCC	COMMENTS
B-124	5.0'	NO	



NOT TO SCALE

PROJECT LAYOUT SHEET #25

- NOTES:
 1. FOR LEGENDS, SEE SHEET 20.
 2. ALL EXISTING SIGNS NOT SHOWN SHALL BE RETAINED.
 3. SEE SHEETS 8 & 9 FOR DURABLE PAVEMENT MARKINGS OPTIONS.

PROJECT NAME: ESSEX-WESTFORD
 PROJECT NUMBER: STP 2912(I)

FILE NAME: p10c226.dgn
 PROJECT LEADER: JLL
 DESIGNED BY: STANTEC
 IPARM FILE: p10c226125.i

PLOT DATE: 2/20/2013
 DRAWN BY: STANTEC
 CHECKED BY: STANTEC
 SHEET 44 OF 239