

STONE FILL, TYPE I
 STA. 174+70 TO 179+50, RT
 RELOCATE MAILBOX, SINGLE SUPPORT
 STA. 174+42, LT
 STA. 174+44, LT
 STA. 176+12, LT

DURABLE 4 INCH WHITE LINE
 (ALL LINES WILL INCLUDE EDGE LINE BREAKS AND RADII FOR SIDE ROADS)
 STA. 173+50 TO 179+50, SOLID LT & RT
 DURABLE 4 INCH YELLOW LINE
 (ALL LINES WILL INCLUDE ϕ BREAKS FOR SIDE ROADS)
 STA. 173+50 TO 179+50, SOLID LT & RT

TEMPORARY 4 INCH WHITE LINE, PAINT
 (ALL LINES WILL INCLUDE EDGE LINE BREAKS AND RADII FOR SIDE ROADS)
 STA. 173+50 TO 179+50, SOLID LT & RT
 TEMPORARY 4 INCH YELLOW LINE, PAINT
 (ALL LINES WILL INCLUDE ϕ BREAKS FOR SIDE ROADS)
 STA. 173+50 TO 179+50, SOLID LT & RT

GEOTEXTILE UNDER STONE FILL
 STA. 174+70 TO 179+50, RT
 GRUBBING MATERIAL
 STA. 174+70 TO 179+50, RT

DELINEATOR WITH STEEL POST
 STA. 173+70 TO 178+80, RT - AS SHOWN

CURVE #25
 PC = 174+54.78
 PT = 178+38.92
 R = 750'
 $\Delta = 29^\circ 20' 45''$, LT
 D = 7° 38' 22"
 e = 8.0%
 L = 384.14'
 SEE SHEET 77

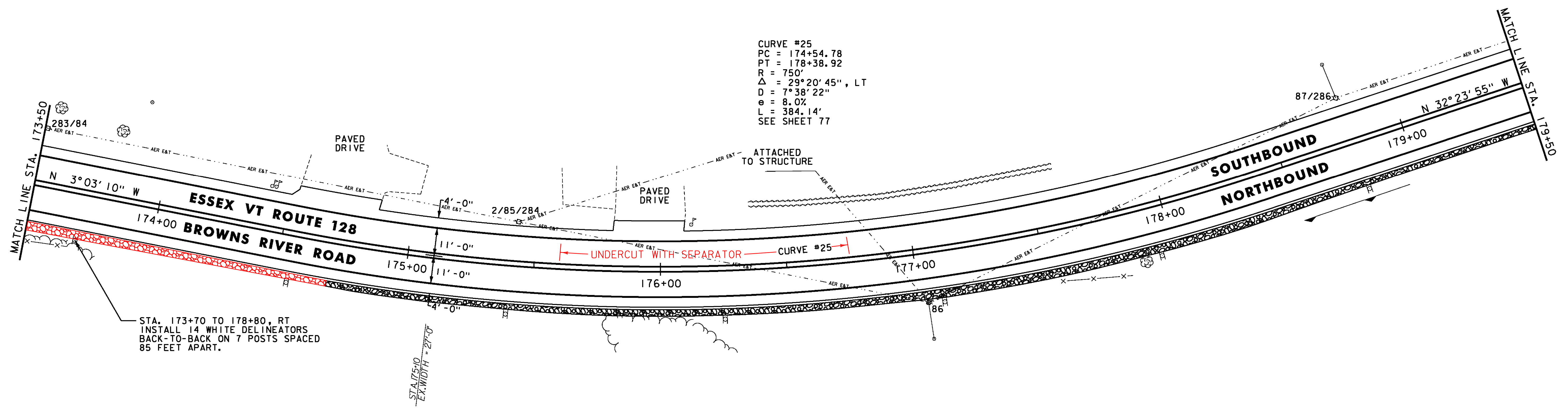

STA. 173+70 TO 178+80, RT
 INSTALL 14 WHITE DELINEATORS
 BACK-TO-BACK ON 7 POSTS SPACED
 85 FEET APART.

STONE FILL, TYPE I
 STA. 179+50 TO 179+80, RT
 STA. 180+60 TO 181+20, RT
 STA. 181+40 TO 183+50, RT
 STA. 185+00 TO 185+50, LT
 RELOCATE MAILBOX, SINGLE SUPPORT
 STA. 180+56, RT

DURABLE 4 INCH WHITE LINE
 (ALL LINES WILL INCLUDE EDGE LINE BREAKS AND RADII FOR SIDE ROADS)
 STA. 179+50 TO 185+50, SOLID LT & RT
 DURABLE 4 INCH YELLOW LINE
 (ALL LINES WILL INCLUDE ϕ BREAKS FOR SIDE ROADS)
 STA. 179+50 TO 185+50, SOLID LT & RT

TEMPORARY 4 INCH WHITE LINE, PAINT
 (ALL LINES WILL INCLUDE EDGE LINE BREAKS AND RADII FOR SIDE ROADS)
 STA. 179+50 TO 185+50, SOLID LT & RT
 TEMPORARY 4 INCH YELLOW LINE, PAINT
 (ALL LINES WILL INCLUDE ϕ BREAKS FOR SIDE ROADS)
 STA. 179+50 TO 185+50, SOLID LT & RT

GEOTEXTILE UNDER STONE FILL
 STA. 179+50 TO 179+80, RT
 STA. 180+60 TO 181+20, RT
 STA. 181+40 TO 183+50, RT
 STA. 185+00 TO 185+50, LT
 GRUBBING MATERIAL
 STA. 179+50 TO 179+80, RT
 STA. 180+60 TO 181+20, RT
 STA. 181+40 TO 183+50, RT
 STA. 185+00 TO 185+50, LT

REMOVING SIGNS
 AS SHOWN - 2

CURVE #26
 PC = 185+10.62
 PCC = 187+53.98
 R = 807'
 $\Delta = 17^\circ 16' 42''$, RT
 D = 7° 05' 59"
 e = 7.9%
 L = 243.36'
 SEE SHEET 77

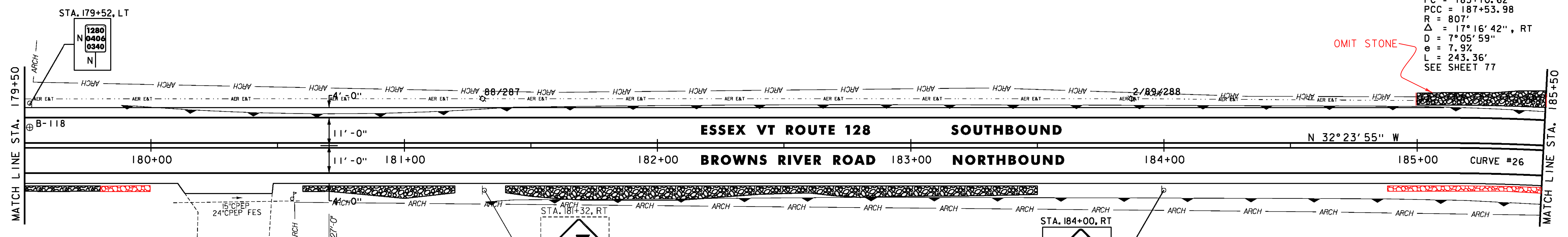

OMIT STONE

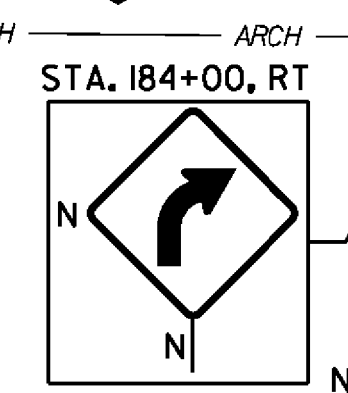
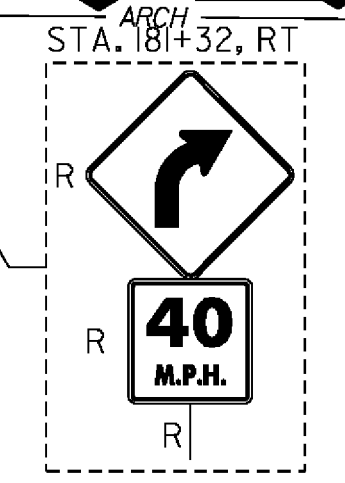
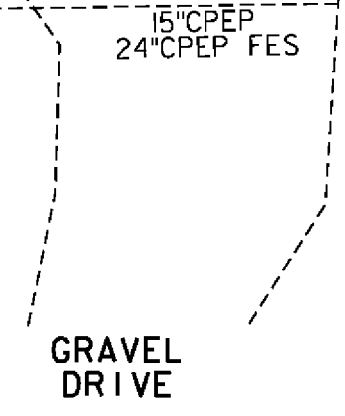

- NOTES:
 1. FOR LEGENDS, SEE SHEET 20.
 2. ALL EXISTING SIGNS NOT SHOWN SHALL BE RETAINED.
 3. SEE SHEETS 8 & 9 FOR DURABLE PAVEMENT MARKINGS OPTIONS.

SOIL BORING DATA			
BORING#	DEPTH (FT.)	PCC	COMMENTS
B-118	5.0'	NO	



PROJECT LAYOUT SHEET #20

PROJECT NAME: ESSEX-WESTFORD
 PROJECT NUMBER: STP 2912(I)
 FILE NAME: p10c226.dgn
 PROJECT LEADER: JLL
 DESIGNED BY: STANTEC
 IPARM FILE: p10c226120.i
 PLOT DATE: 2/20/2013
 DRAWN BY: STANTEC
 CHECKED BY: STANTEC
 SHEET 39 OF 239