

THINNING AND TRIMMING FOR SIGNS
 STA. 103+50, RT

STONE FILL, TYPE J
 STA. 103+50 TO 104+60, RT

RELOCATE MAILBOX, SINGLE SUPPORT
 STA. 107+07, RT

RELOCATE MAILBOX, MULTIPLE SUPPORT
 STA. 105+80, RT

STEEL BEAM GUARDRAIL, GALVANIZED W/8 FEET POSTS
 STA. 107+21.5 TO 108+50.0, LT
 STA. 107+36.0 TO 108+50.0, RT

ANCHOR FOR STEEL BEAM RAIL
 STA. 107+21.5, LT
 STA. 107+36.0, RT

REMOVAL AND DISPOSAL OF GUARDRAIL
 STA. 108+07 TO 108+50, LT

DURABLE 4 INCH WHITE LINE
 (ALL LINES WILL INCLUDE EDGE LINE BREAKS
 AND RADII FOR SIDE ROADS)
 STA. 103+50 TO 108+50, SOLID LT & RT

DURABLE 4 INCH YELLOW LINE
 (ALL LINES WILL INCLUDE ϕ BREAKS FOR SIDE ROADS)
 STA. 103+50 TO 108+50, SOLID LT & RT

TEMPORARY 4 INCH WHITE LINE, PAINT
 (ALL LINES WILL INCLUDE EDGE LINE BREAKS
 AND RADII FOR SIDE ROADS)
 STA. 103+50 TO 108+50, SOLID LT & RT

TEMPORARY 4 INCH YELLOW LINE, PAINT
 (ALL LINES WILL INCLUDE ϕ BREAKS FOR SIDE ROADS)
 STA. 103+50 TO 108+50, SOLID LT & RT

GEOTEXTILE UNDER STONE FILL
 STA. 103+50 TO 104+60, RT

GRUBBING MATERIAL
 STA. 103+50 TO 104+60, RT

REMOVING SIGNS
 AS SHOWN - 2

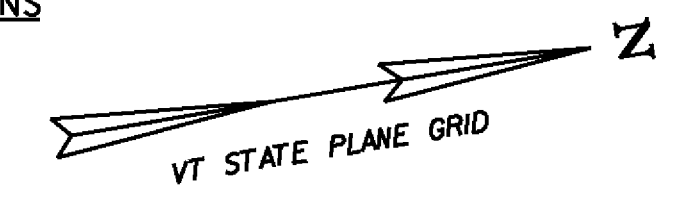

UD-10F STA 103+90 TO 108+00, LT
 CONSTRUCT 6 INCH UNDERDRAIN PIPE.
 SEE SHEET 12 FOR DETAIL.

UD-10G STA 104+00 TO 108+70, RT
 CONSTRUCT 6 INCH UNDERDRAIN PIPE.
 SEE SHEET 12 FOR DETAIL.

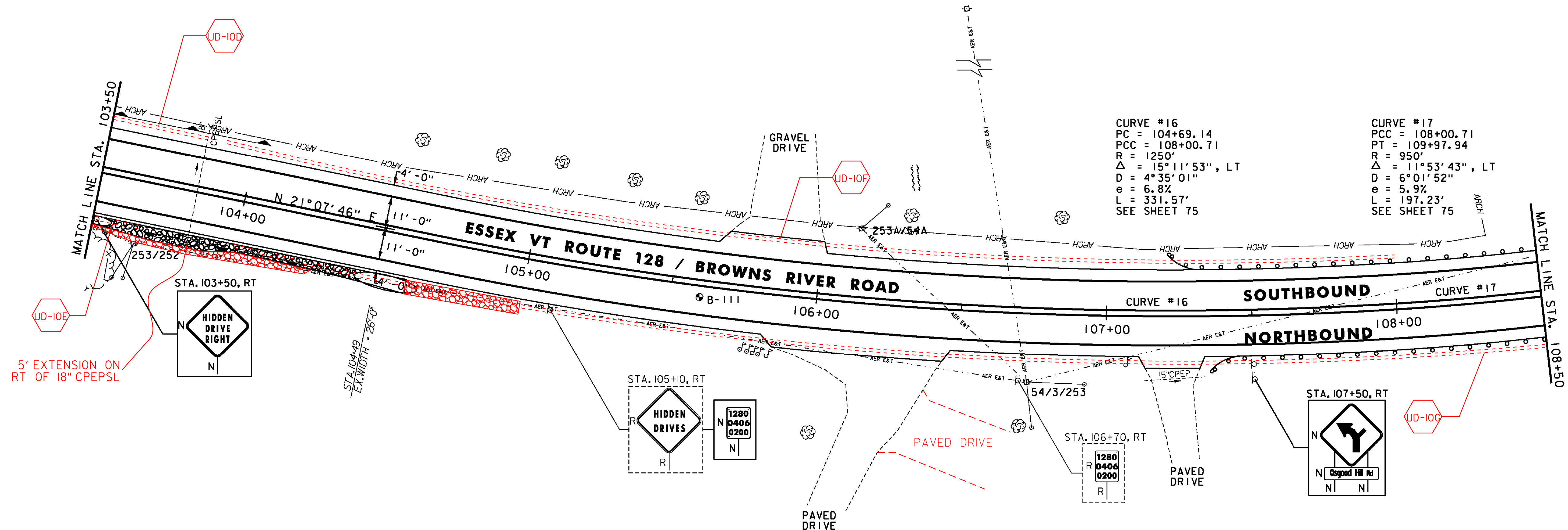

CURVE #16
 PC = 104+69.14
 PCC = 108+00.71
 R = 1250'
 $\Delta = 15^\circ 11' 53''$, LT
 D = 4°35'01"
 e = 6.8%
 L = 331.57'
 SEE SHEET 75

CURVE #17
 PCC = 108+00.71
 PT = 109+97.94
 R = 950'
 $\Delta = 11^\circ 53' 43''$, LT
 D = 6°01'52"
 e = 5.9%
 L = 197.23'
 SEE SHEET 75

- NOTES:**
- FOR LEGENDS, SEE SHEET 20.
 - ALL EXISTING SIGNS NOT SHOWN SHALL BE RETAINED.
 - SEE SHEETS 8 & 9 FOR DURABLE PAVEMENT MARKINGS OPTIONS.

NOT TO SCALE

PROJECT LAYOUT SHEET #13

PROJECT NAME: ESSEX-WESTFORD
 PROJECT NUMBER: STP 2912(I)
 FILE NAME: p10c226.dgn
 PROJECT LEADER: JLL
 DESIGNED BY: STANTEC
 IPARM FILE: p10c226113.j
 PLOT DATE: 2/20/2013
 DRAWN BY: STANTEC
 CHECKED BY: STANTEC
 SHEET 32 OF 239

SOIL BORING DATA			
BORING#	DEPTH (FT.)	PCC	COMMENTS
B-III	5.0'	NO	

