

THINNING AND TRIMMING FOR SIGNS
 STA. 7+88, RT
 REHAB. DIS, CBS OR MHS, CLASS 1
 STA. 4+91, LT
 STA. 6+01, LT

CHANGING ELEVATION OF SEWER MANHOLES (NON-PARTICIPATING)
 STA. 5+85, LT
 STA. 3+67, RT
 ADJUST ELEVATION OF VALVE BOX (NON-PARTICIPATING)
 STA. 5+52, RT
 STA. 5+58, RT
 STA. 5+84, RT
 STA. 5+90, LT
 STA. 5+91, RT
 STA. 6+83, RT

PORTLAND CEMENT CONCRETE SIDEWALK, 5 INCH
 STA. 5+99, LT
 DETECTABLE WARNING SURFACE
 STA. 5+99, LT

STEEL BEAM GUARDRAIL, GALVANIZED
 STA. 3+50.0 TO 4+67.5, RT
 STA. 3+50.0 TO 5+41.5, LT
 ANCHOR FOR STEEL BEAM RAIL
 STA. 4+67.5, RT
 STA. 5+41.5, LT
 REMOVAL AND DISPOSAL OF GUARDRAIL
 STA. 3+50.0 TO 4+47.0, RT
 STA. 3+71.0 TO 5+52.0, LT

DURABLE 4 INCH WHITE LINE
 (ALL LINES WILL INCLUDE EDGE LINE BREAKS AND RADII FOR SIDE ROADS)
 STA. 3+50 TO 9+50, SOLID LT & RT
 STA. 5+52, SOLID LT (EDGELINES, BIXBY HILL ROAD TH-714)
 STA. 5+55, SOLID RT (EDGELINES, ALDER LANE TH-718)
 DURABLE 4 INCH YELLOW LINE
 (ALL LINES WILL INCLUDE C BREAKS FOR SIDE ROADS)
 STA. 3+50 TO 9+50, SOLID LT & RT
 STA. 5+52, DOUBLE SOLID LT (BIXBY HILL ROAD TH-714)
 STA. 5+55, DOUBLE SOLID RT (ALDER LANE TH-718)

TEMPORARY 4 INCH WHITE LINE, PAINT
 (ALL LINES WILL INCLUDE EDGE LINE BREAKS AND RADII FOR SIDE ROADS)
 STA. 3+50 TO 9+50, SOLID LT & RT
 STA. 5+52, SOLID LT (EDGELINES, BIXBY HILL ROAD TH-714)
 STA. 5+55, SOLID RT (EDGELINES, ALDER LANE TH-718)

TEMPORARY 4 INCH YELLOW LINE, PAINT
 (ALL LINES WILL INCLUDE C BREAKS FOR SIDE ROADS)
 STA. 3+50 TO 9+50, SOLID LT & RT
 STA. 5+52, DOUBLE SOLID LT (BIXBY HILL ROAD TH-714)
 STA. 5+55, DOUBLE SOLID RT (ALDER LANE TH-718)

DURABLE 8 INCH WHITE LINE
 STA. 6+85, RT (HYDRANT)
 SEE DETAIL SHEET 18

TEMPORARY 8 INCH WHITE LINE, PAINT
 STA. 6+85, RT (HYDRANT)
 SEE DETAIL SHEET 18

DURABLE 24 INCH STOP BAR
 STA. 5+52, LT (BIXBY HILL ROAD TH-714)
 STA. 5+55, RT (ALDER LANE TH-718)

TEMPORARY 24 INCH STOP BAR, PAINT
 STA. 5+52, LT (BIXBY HILL ROAD TH-714)
 STA. 5+55, RT (ALDER LANE TH-718)

DURABLE LETTER OR SYMBOL
 STA. 3+51, RT "SCHOOL"
 STA. 5+52, LT (BIXBY HILL ROAD TH-714) "STOP"
 STA. 5+55, RT (ALDER LANE TH-718) "STOP"

TEMPORARY LETTER OR SYMBOL, PAINT
 STA. 3+51, RT "SCHOOL"
 STA. 5+52, LT (BIXBY HILL ROAD TH-714) "STOP"
 STA. 5+55, RT (ALDER LANE TH-718) "STOP"

DURABLE CROSSWALK MARKING
 STA. 5+31, RT TO STA. 5+34, LT
 STA. 5+52, LT (BIXBY HILL ROAD TH-714)

TEMPORARY CROSSWALK MARKING, PAINT
 STA. 5+31, RT TO STA. 5+34, LT
 STA. 5+52, LT (BIXBY HILL ROAD TH-714)

REMOVING SIGNS
 AS SHOWN - 23

SPECIAL PROVISION (RELOCATE FLASHING BEACON, GROUND MOUNTED)
 STA. 7+88, RT (2)

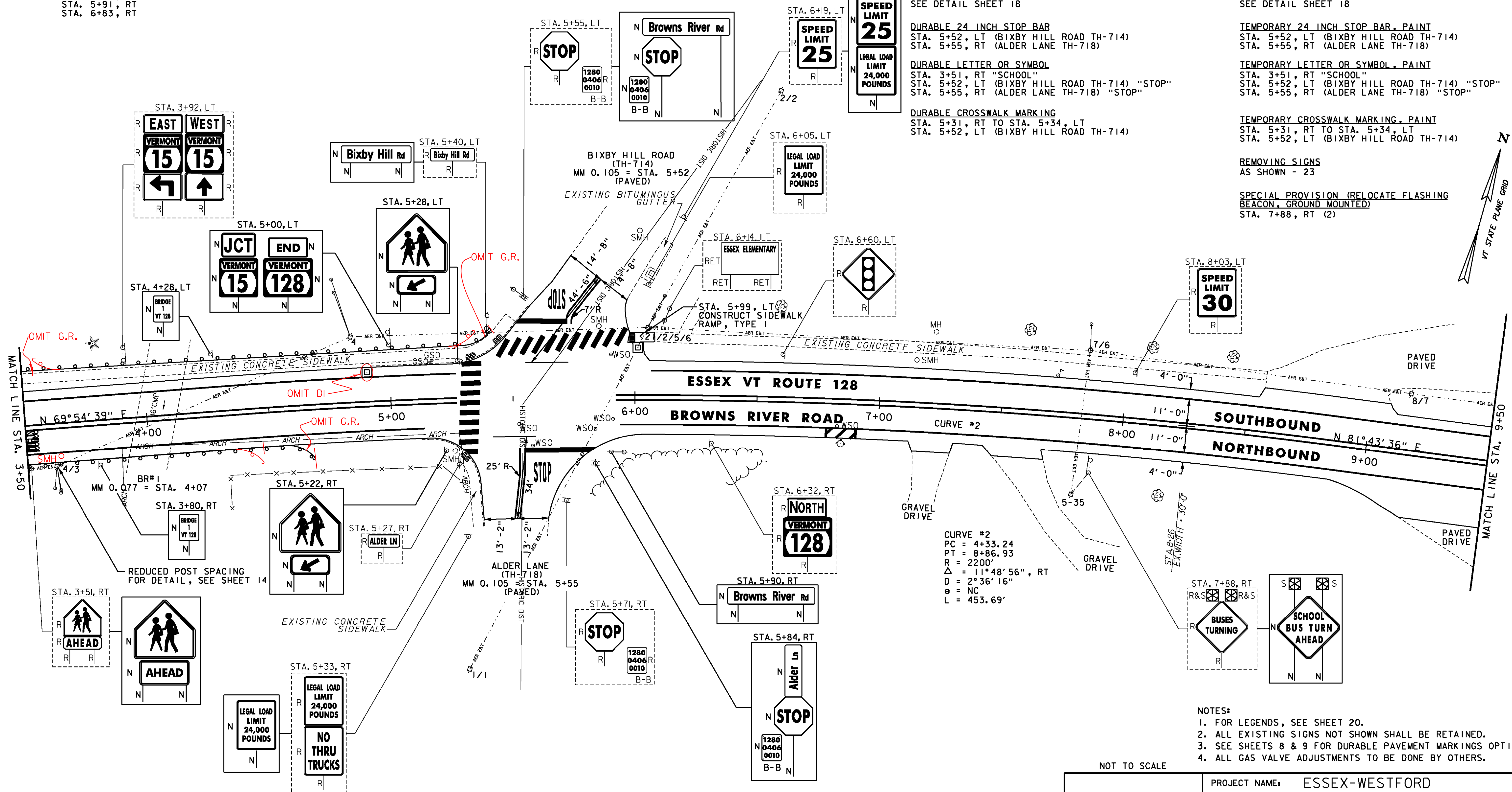

CURVE #2
 PC = 4+33.24
 PT = 8+86.93
 R = 2200'
 $\Delta = 11^\circ 48' 56''$, RT
 D = 2° 36' 16"
 e = NC
 L = 453.69'

- NOTES:
1. FOR LEGENDS, SEE SHEET 20.
 2. ALL EXISTING SIGNS NOT SHOWN SHALL BE RETAINED.
 3. SEE SHEETS 8 & 9 FOR DURABLE PAVEMENT MARKINGS OPTIONS.
 4. ALL GAS VALVE ADJUSTMENTS TO BE DONE BY OTHERS.

NOT TO SCALE

PROJECT LAYOUT SHEET #2

PROJECT NAME: ESSEX-WESTFORD	FILE NAME: p10c226.dgn	PLOT DATE: 2/20/2013
PROJECT NUMBER: STP 2912(I)	PROJECT LEADER: JLL	DRAWN BY: STANTEC
	DESIGNED BY: STANTEC	CHECKED BY: STANTEC
	IPARM FILE: p10c226i02.i	SHEET 21 OF 239

