

TEMPORARY 4 INCH WHITE LINE, PAINT
 DURABLE 4 INCH YELLOW LINE (OPTION BID ITEM)
 F6+50 TO F18+50 SOLID RT
 F6+50 TO F18+50 SOLID LT

TEMPORARY 4 INCH YELLOW LINE, PAINT
 DURABLE 4 INCH YELLOW LINE (OPTION BID ITEM)
 F6+50 TO F11+35 SOLID LT, DASHED RT
 F11+35 TO F12+41 SOLID LT & RT
 F12+41 TO F18+50 DASHED LT, SOLID RT

REMOVAL AND DISPOSAL OF GUARDRAIL
 F11+82 TO F14+09 LT

REMOVING SIGNS
 AS SHOWN - 2

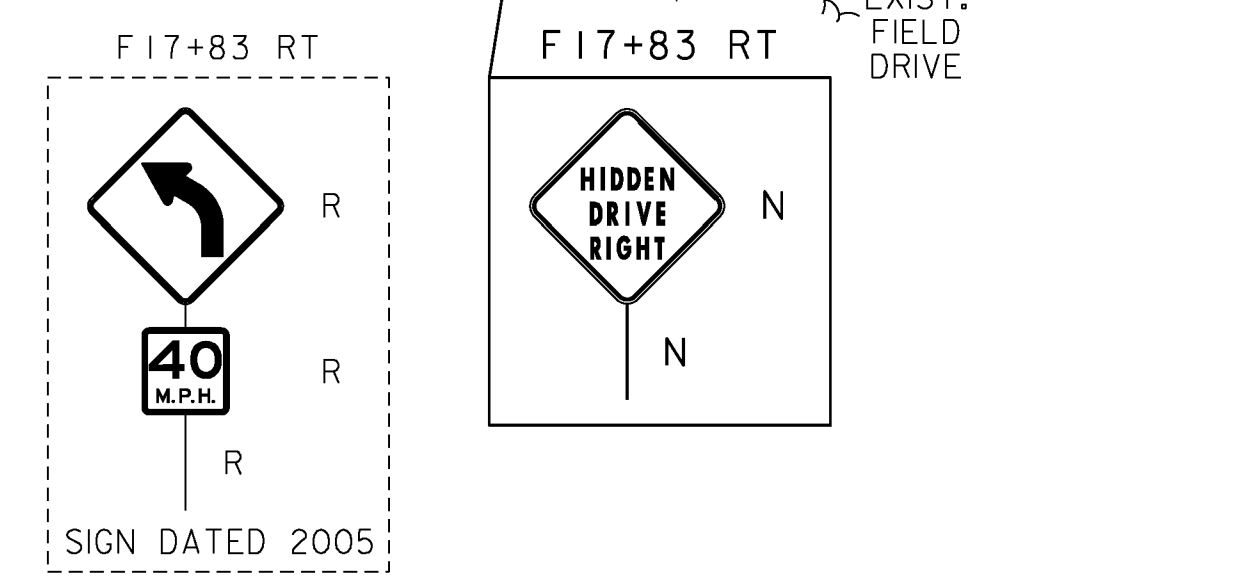
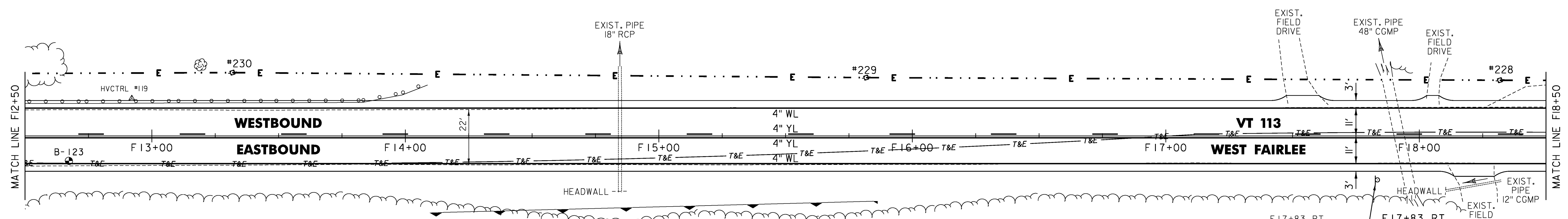
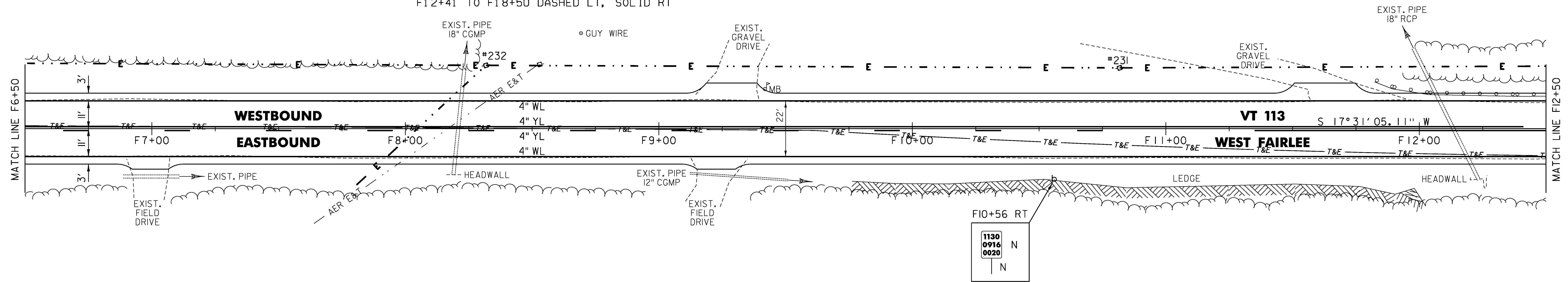

- LEGEND**
- R = REMOVE EXISTING
 - S = SALVAGE
 - R&S = REMOVE AND SALVAGE
 - N = NEW
 - RET = RETAIN
 - B-B = BACK TO BACK
 - = EXISTING GUARDRAIL
 - = PROPOSED GUARDRAIL
 - YL = YELLOW LINE
 - WL = WHITE LINE
 - = DELINEATOR
 - = PROPOSED UP

ROADWAY LAYOUT 23

PROJECT NAME: VERSHIRE-THETFORD
 PROJECT NUMBER: STP 2911(I)
 FILE NAME: pl0c224.dgn
 PROJECT LEADER: PTS
 DESIGNED BY: NLL
 IPARM FILE NAME: IOC224_50

PLOT DATE: 3/8/2013
 DRAWN BY: SNG
 CHECKED BY: PTS
 SHEET 50 OF 232