

TEMPORARY 4 INCH WHITE LINE, PAINT
 DURABLE 4 INCH WHITE LINE (OPTION BID ITEM)
 398+50 TO 404+50 SOLID RT
 398+50 TO 400+90 SOLID LT
 400+90 TO 401+14 SOLID LT (TH 15)
 401+35 TO 401+72 SOLID LT (TH 15)
 401+72 TO 404+50 SOLID LT

TEMPORARY 4 INCH YELLOW LINE, PAINT
 DURABLE 4 INCH YELLOW LINE (OPTION BID ITEM)
 398+50 TO 399+70 DASHED LT, SOLID RT
 399+70 TO 401+11 SOLID LT & RT
 401+24 TO 401+30 DOUBLE SOLID LT (TH 15)
 401+51 TO 404+50 SOLID LT & RT

TEMPORARY 24" STOP BAR, PAINT
 DURABLE 24" STOP BAR (OPTION BID ITEM)
 401+07 TO 401+30 LT (TH 15)

TEMPORARY LETTER OR SYMBOL, PAINT
 DURABLE LETTER OR SYMBOL (OPTION BID ITEM)
 401+19 LT - "STOP" (TH 15)

STEEL BEAM GUARDRAIL, GALVANIZED
 400+14.5 TO 400+52 LT
 400+89.5 TO 400+99.5 LT (ENDS ON TH 15)
 402+79 TO 403+66.5 RT

STEEL BEAM GUARDRAIL,
 GALVANIZED W/8 FEET POSTS
 399+54 TO 400+54 RT
 400+91.5 TO 401+91.5 RT
 402+98 TO 403+23 LT

STEEL BEAM GUARDRAIL, GALVANIZED/NESTED
 400+52 TO 400+89.5 LT

H.D. STEEL BEAM GUARDRAIL,
 GALVANIZED/NESTED W/8 FEET POSTS
 400+54 TO 400+91.5 RT

H.D. STEEL BEAM GUARDRAIL,
 GALVANIZED
 402+54 TO 402+79 RT

H.D. STEEL BEAM GUARDRAIL,
 GALVANIZED W/8 FEET POSTS
 401+91.5 TO 402+16.5 RT
 402+10.5 TO 402+35.5 LT
 402+73 TO 402+98 LT

ANCHOR FOR STEEL BEAM RAIL

399+54 RT
 400+14.5 LT
 400+99.5 LT (ON TH 15)
 402+10.5 LT
 403+23 LT
 403+66.5 RT

REMOVAL AND DISPOSAL OF GUARDRAIL
 399+60 TO 402+18 RT
 400+13 TO 400+99 LT (ENDS ON TH 15)
 402+14 TO 402+37 LT
 402+54 TO 403+67 RT
 402+73 TO 403+26 LT

DELINEATOR WITH STEEL POST

399+54 RT
 400+14.5 LT
 402+10.5 LT
 403+23 LT
 403+66.5 RT

REMOVING SIGNS

AS SHOWN - 2

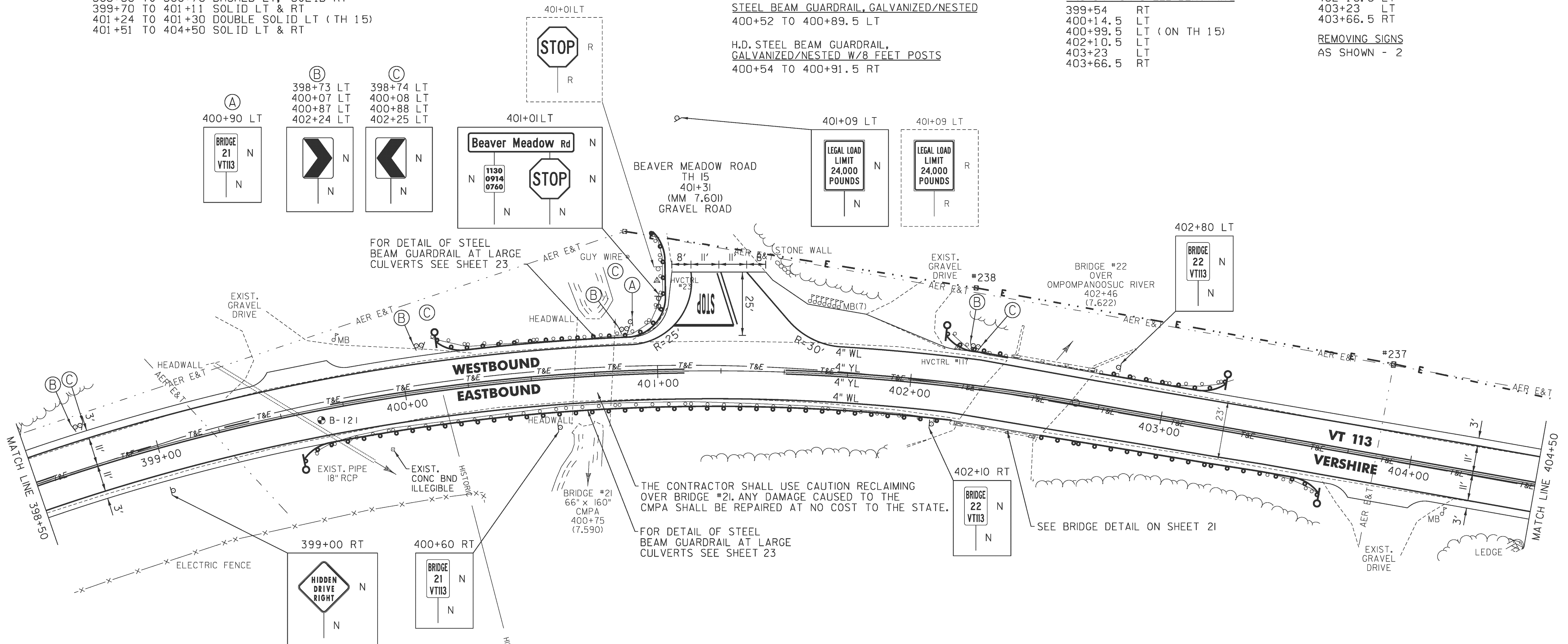
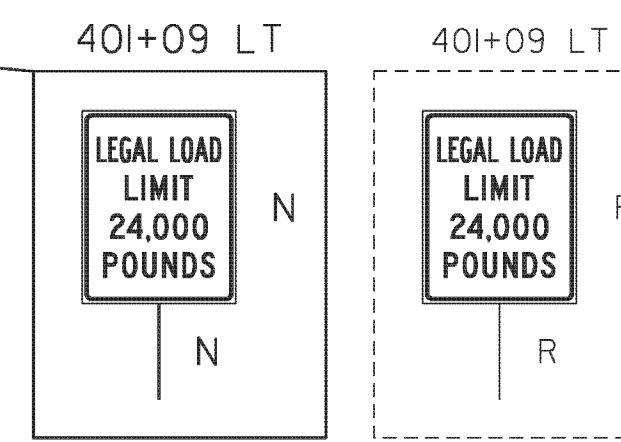
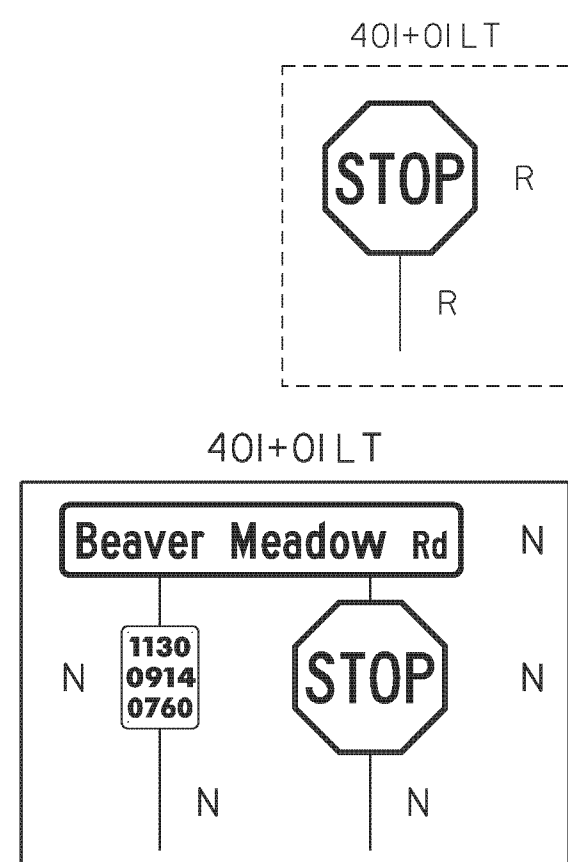
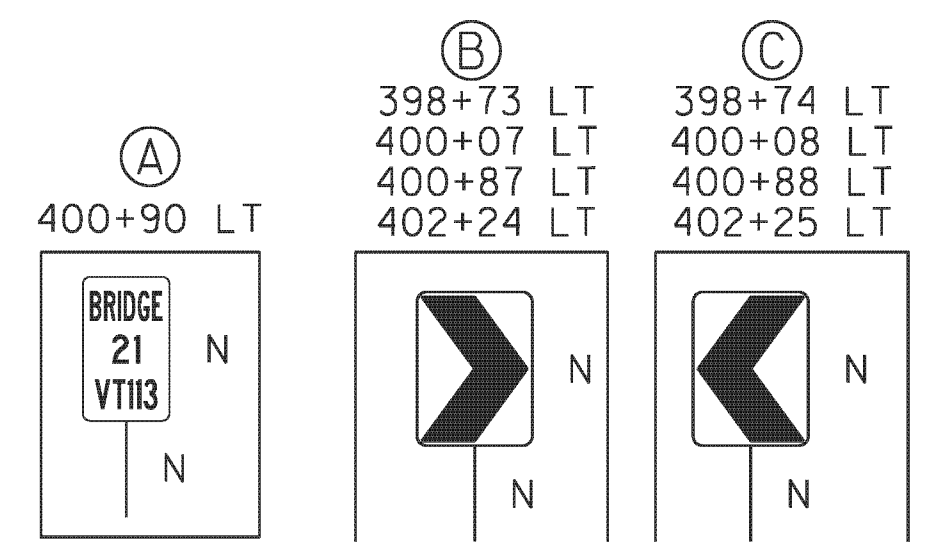

FOR DETAIL OF STEEL BEAM GUARDRAIL AT LARGE CULVERTS SEE SHEET 23

THE CONTRACTOR SHALL USE CAUTION RECLAIMING OVER BRIDGE #21. ANY DAMAGE CAUSED TO THE CMPA SHALL BE REPAIRED AT NO COST TO THE STATE.

FOR DETAIL OF STEEL BEAM GUARDRAIL AT LARGE CULVERTS SEE SHEET 23

CURVE (21)
 DELTA = 29° 14' 24" RT
 D = 6° 59' 14"
 R = 820.00'
 T = 213.90'
 L = 418.47'
 E = 27.44'
 BANK = 0.060

- LEGEND
- R = REMOVE EXISTING
 - S = SALVAGE
 - R&S = REMOVE AND SALVAGE
 - N = NEW
 - RET = RETAIN
 - B-B = BACK TO BACK
 - = EXISTING GUARDRAIL
 - = PROPOSED GUARDRAIL
 - YL = YELLOW LINE
 - WL = WHITE LINE
 - = DELINEATOR
 - = PROPOSED UP

ROADWAY LAYOUT 21

| | |
|---------------------------------|---------------------|
| PROJECT NAME: VERSHIRE-THETFORD | PLOT DATE: 3/8/2013 |
| PROJECT NUMBER: STP 2911(I) | DRAWN BY: SNG |
| FILE NAME: pl0c224.dgn | CHECKED BY: PTS |
| PROJECT LEADER: PTS | SHEET 48 OF 232 |
| DESIGNED BY: NLL | |
| IPARM FILE NAME: IOC224_48 | |