

TEMPORARY 4 INCH WHITE LINE, PAINT
 DURABLE 4 INCH WHITE LINE (OPTION BID ITEM)
 380+50 TO 392+50 SOLID LT
 380+50 TO 392+50 SOLID RT

REMOVAL AND DISPOSAL OF GUARDRAIL
 384+05 TO 388+81 RT

REMOVING SIGNS
 AS SHOWN - 1

TEMPORARY 4 INCH YELLOW LINE, PAINT
 DURABLE 4 INCH YELLOW LINE (OPTION BID ITEM)
 380+50 TO 382+80 SOLID LT & RT
 382+80 TO 389+66 SOLID LT, DASHED RT
 389+66 TO 391+78 DASHED CL
 391+78 TO 392+50 DASHED LT, SOLID RT

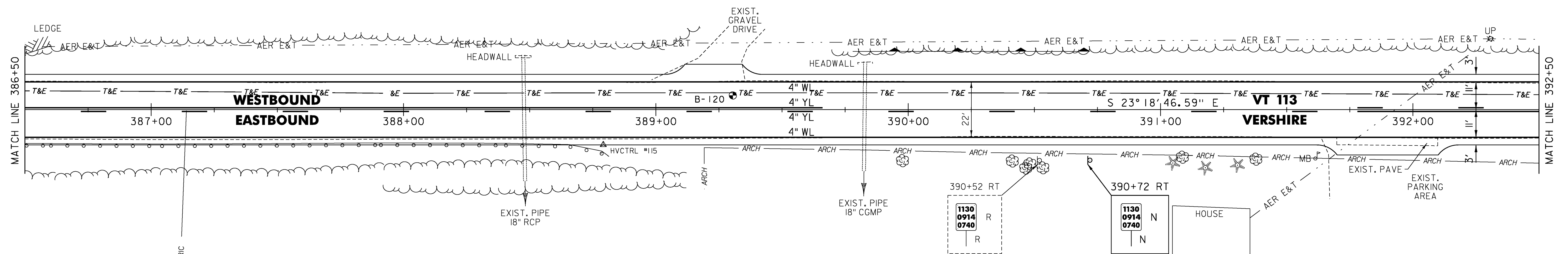
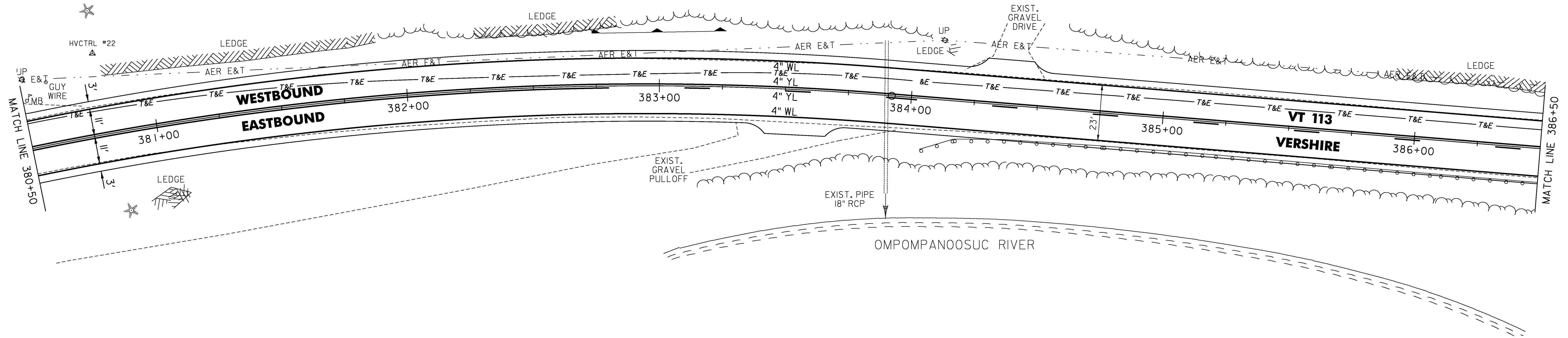

- LEGEND**
- R = REMOVE EXISTING
 - S = SALVAGE
 - R&S = REMOVE AND SALVAGE
 - N = NEW
 - RET = RETAIN
 - B-B = BACK TO BACK
 - = EXISTING GUARDRAIL
 - = PROPOSED GUARDRAIL
 - YL = YELLOW LINE
 - WL = WHITE LINE
 - = DELINEATOR
 - = PROPOSED UP

ROADWAY LAYOUT 19

PROJECT NAME: VERSHIRE-THETFORD
 PROJECT NUMBER: STP 2911(I)
 FILE NAME: pl0c224.dgn
 PROJECT LEADER: PTS
 DESIGNED BY: NLL
 IPARM FILE NAME: IOC224_46
 PLOT DATE: 3/8/2013
 DRAWN BY: SNG
 CHECKED BY: PTS
 SHEET 46 OF 232