

TEMPORARY 4 INCH WHITE LINE, PAINT  
 DURABLE 4 INCH WHITE LINE (OPTION BID ITEM)

185+08 TO 192+50 SOLID RT  
 185+08 TO 188+04 SOLID LT  
 188+04 TO 188+32 SOLID LT (TH 9)  
 188+53 TO 188+68 SOLID LT (TH 9)  
 188+68 TO 192+50 SOLID LT

TEMPORARY 4 INCH YELLOW LINE, PAINT  
 DURABLE 4 INCH YELLOW LINE (OPTION BID ITEM)

185+08 TO 188+19 SOLID LT & RT  
 188+39 TO 188+42 DOUBLE SOLID LT (TH 9)  
 188+59 TO 192+50 SOLID LT & RT

TEMPORARY 24" STOP BAR, PAINT  
 DURABLE 24" STOP BAR (OPTION BID ITEM)

188+23 TO 188+38 LT (TH 9)

TEMPORARY LETTER OR SYMBOL, PAINT  
 DURABLE LETTER OR SYMBOL (OPTION BID ITEM)

188+35 LT - "STOP" (TH 9)

REHAB. DROP INLETS, CATCH BASINS,  
 OR MANHOLES, CLASS I

187+21 LT (OTDI)

188+96 LT

6 INCH UNDERDRAIN PIPE

192+00 TO 192+50 LT

REMOVING SIGNS

AS SHOWN - 5

**185+08.00 (MM 3.505)  
 BEGIN PROJECT  
 STP 2911(1)**

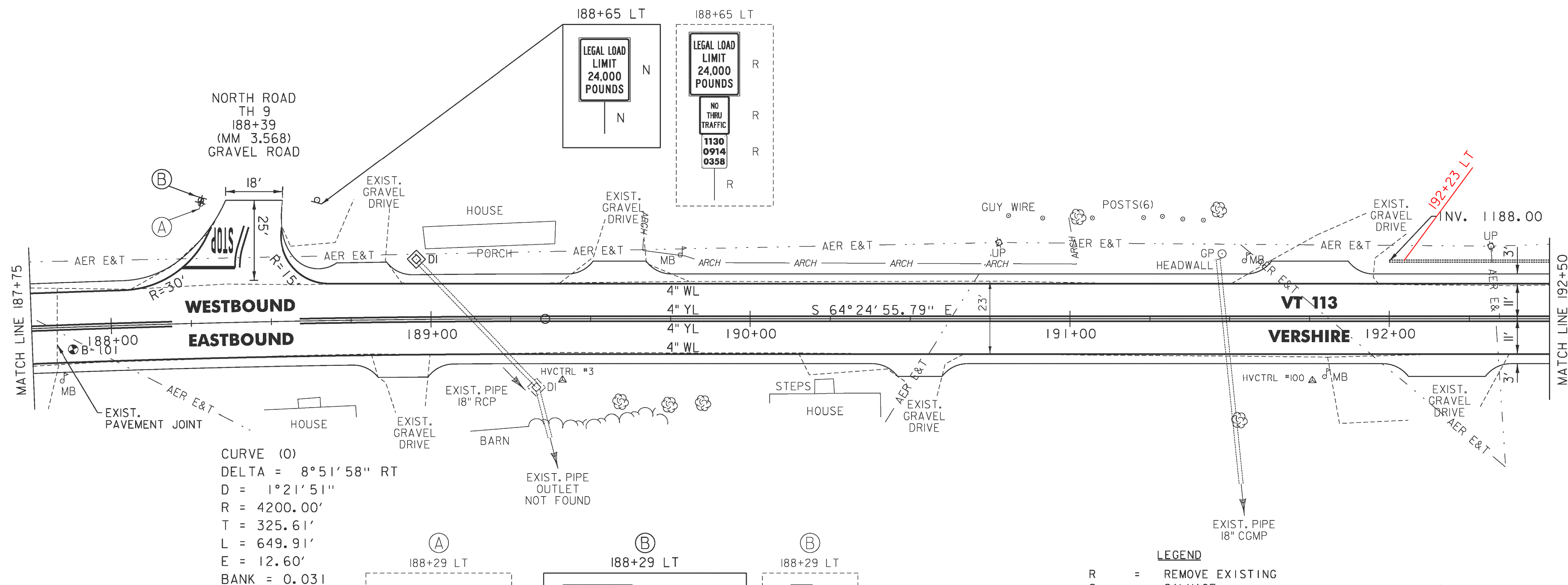
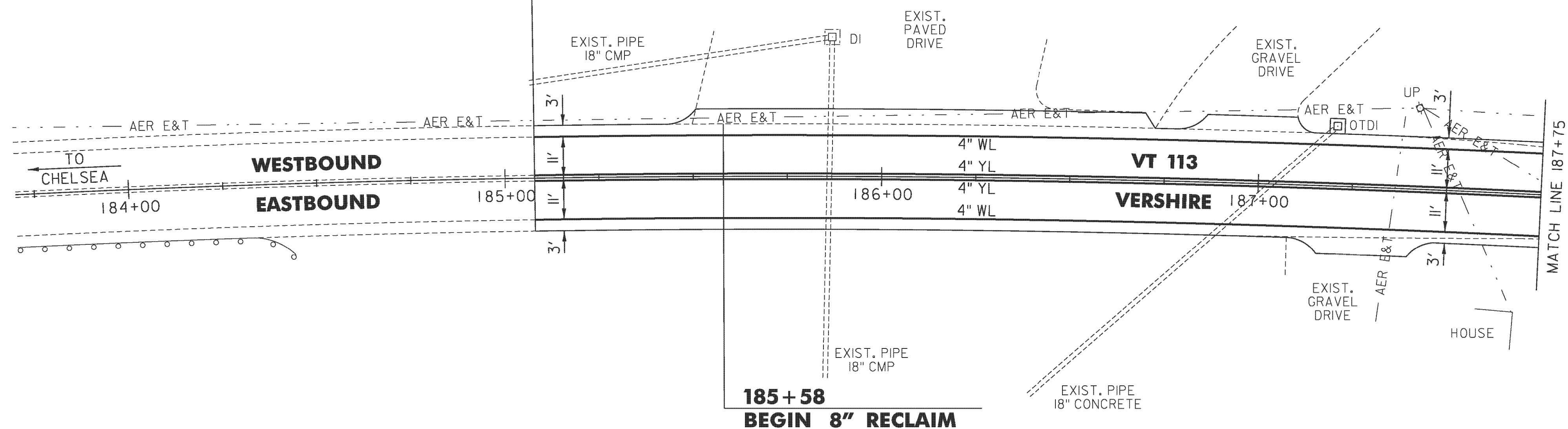

**LEGEND**

- R = REMOVE EXISTING
- S = SALVAGE
- R&S = REMOVE AND SALVAGE
- N = NEW
- RET = RETAIN
- B-B = BACK TO BACK
- = EXISTING GUARDRAIL
- = PROPOSED GUARDRAIL
- YL = YELLOW LINE
- WL = WHITE LINE
- = DELINEATOR
- = PROPOSED UP

**ROADWAY LAYOUT 1**

PROJECT NAME: VERSHIRE-THETFORD  
 PROJECT NUMBER: STP 2911(1)

FILE NAME: p10c224.dgn  
 PROJECT LEADER: PTS  
 DESIGNED BY: NLL  
 IPARM FILE NAME: IOC224.28

PLOT DATE: 3/8/2013  
 DRAWN BY: SNG  
 CHECKED BY: PTS  
 SHEET 28 OF 232

NOT TO SCALE