

RECEIVED

CK'D BY FDB OK'D BY HIS

May 19, 2015

RESUBMIT NO Approved
BY Carolyn Carlson DATE 05/21/2015

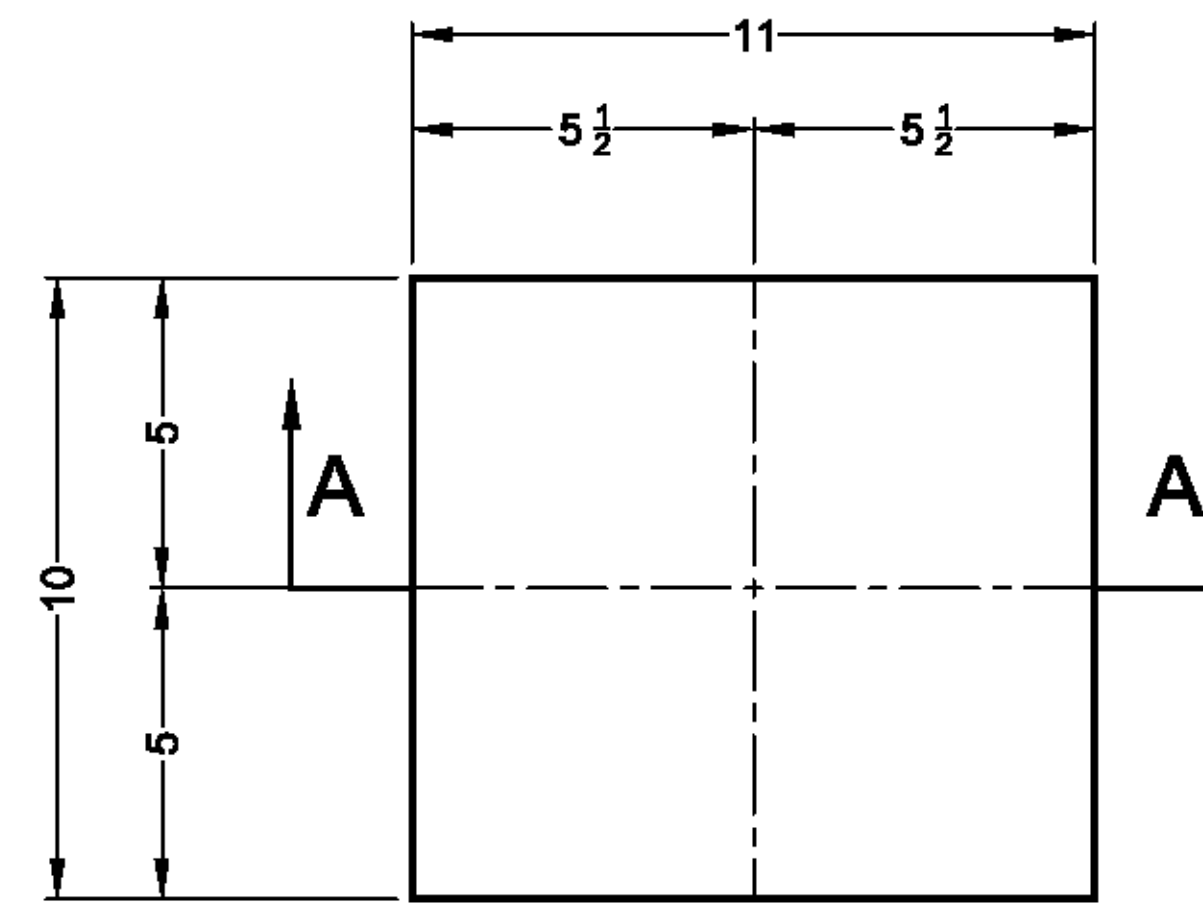

PLAN VIEW

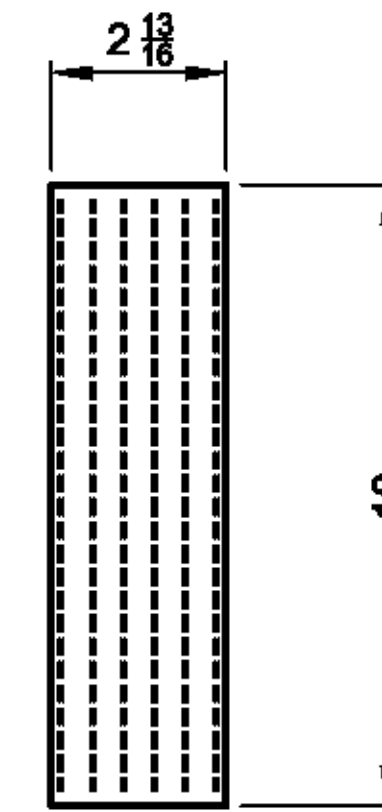

SIDE VIEW

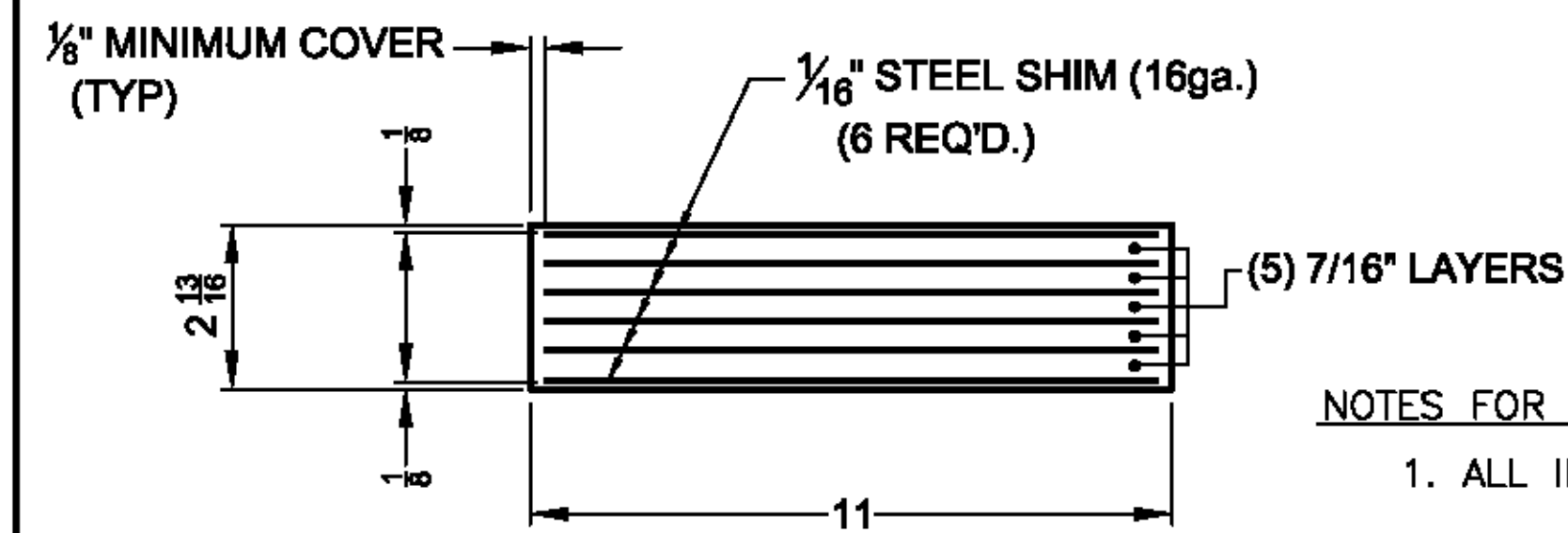

SECTION A-A

QTY. REQ'D. = 8

NOTES FOR LAMINATED ELASTOMERIC BEARING PADS (ITEM NO. 531.17):

1. ALL INTERNAL STEEL SHIMS SHALL BE ASTM A1011 GRADE 36
2. BEARINGS TO BE MANUFACTURED ACCORDING TO AASHTO LRFD STANDARD SPECIFICATIONS FOR HIGHWAY BRIDGES, SECTION 14 & 18, 17th. EDITION, 2002 AND 2010 INTERIMS. BEARINGS SHALL ALSO CONFORM TO VT AOT APPLICABLE SUBSECTIONS OF SECTIONS 531 AND 731.
3. ELASTOMERIC NATURAL RUBBER MATERIAL TO BE 50+/-5 DUROMETER HARDNESS, GR. 4
4. ALL STEEL PRODUCED IN THE U.S.A.
5. THE BEARINGS ARE DESIGNED SO THAT THE SUPERSTRUCTURE MAY BE ERECTED WHEN THE AMBIENT AIR TEMPERATURE IS WITHIN THE RANGE OF 40 DEG. F. TO 90 DEG. F.
6. ALL LOOSE STEEL SHIMS SHALL BE ASTM GRADE 36 AND SHALL BE GALVANIZED.

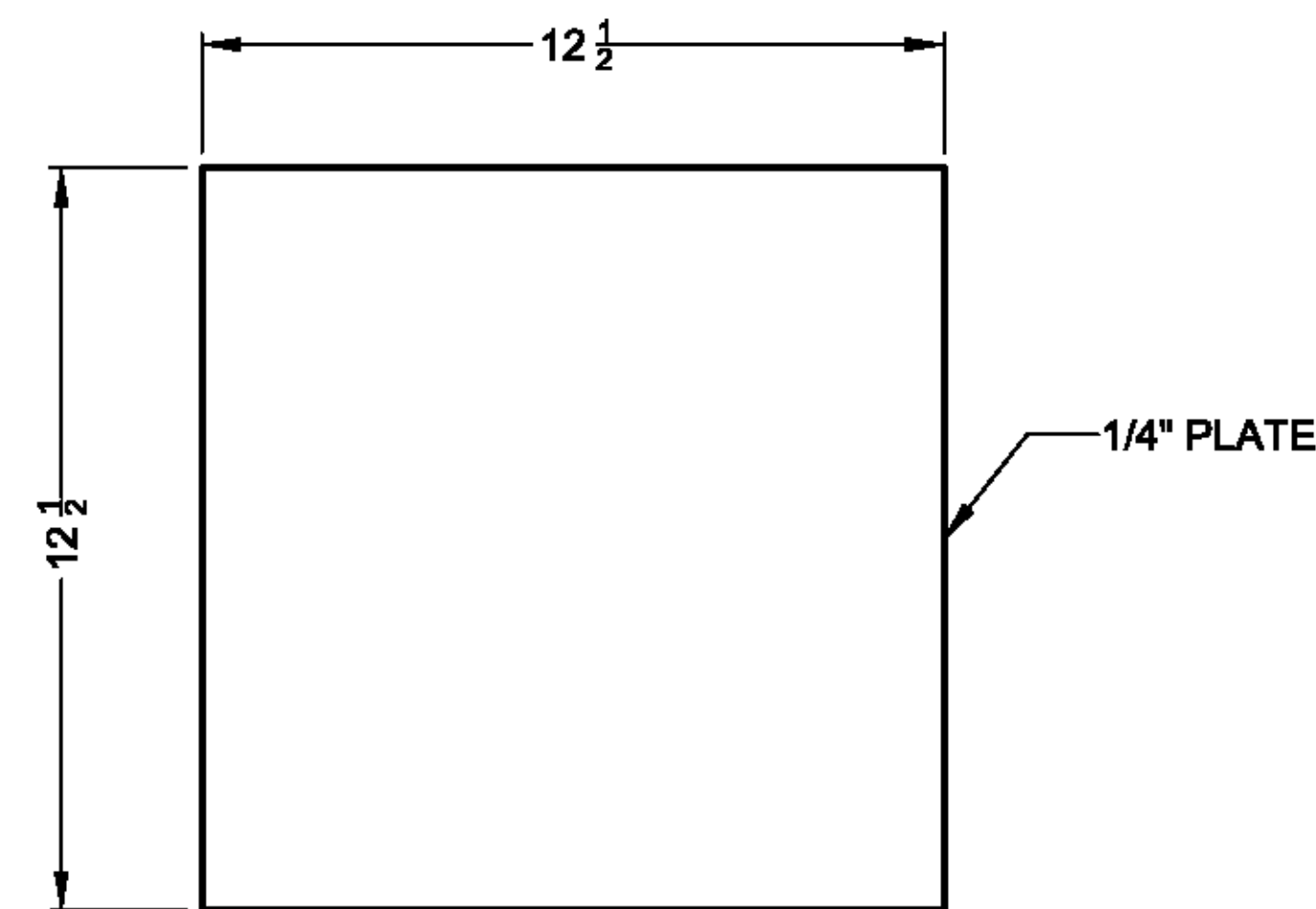

SHIM PLATE

QTY. REQ'D. = 8
GALVANIZED

VERMONT AOT
TOWN OF MIDDLESEX
WASHINGTON COUNTY, VERMONT

PROJECT NO. : BRF-024-1 (37)

ROUTE NO. : VT 12 BRIDGE NO. : 77

STEEL REINFORCED ELASTOMERIC BEARING
PAD & LOOSE SHIM DETAILS

AMSCOT
STRUCTURAL PRODUCTS CORP.

SCALE: N.T.S. APPR'D: BF DRAWN BY: E.J.G.
DATE: 4/21/15 REVISION: 0

FOR: A.L. St. ONGE

DWG NO: AS015C1R0 SHEET 1 OF 1

REVISIONS					
ZONE	REV	DESCRIPTION	REVISED BY	DATE	APPROVED