

BEGIN APPROACH  
STA 26+75.00  
MATCH EXISTING

BEGIN PROJECT  
STA 27+75.00  
FG = 727.29

BEGIN BRIDGE  
STA 28+97.11  
FG = 727.19

END BRIDGE  
STA 29+43.89  
FG = 726.84

END PROJECT  
STA 30+75.00  
FG = 725.53

END APPROACH  
STA 31+75.00  
MATCH EXISTING

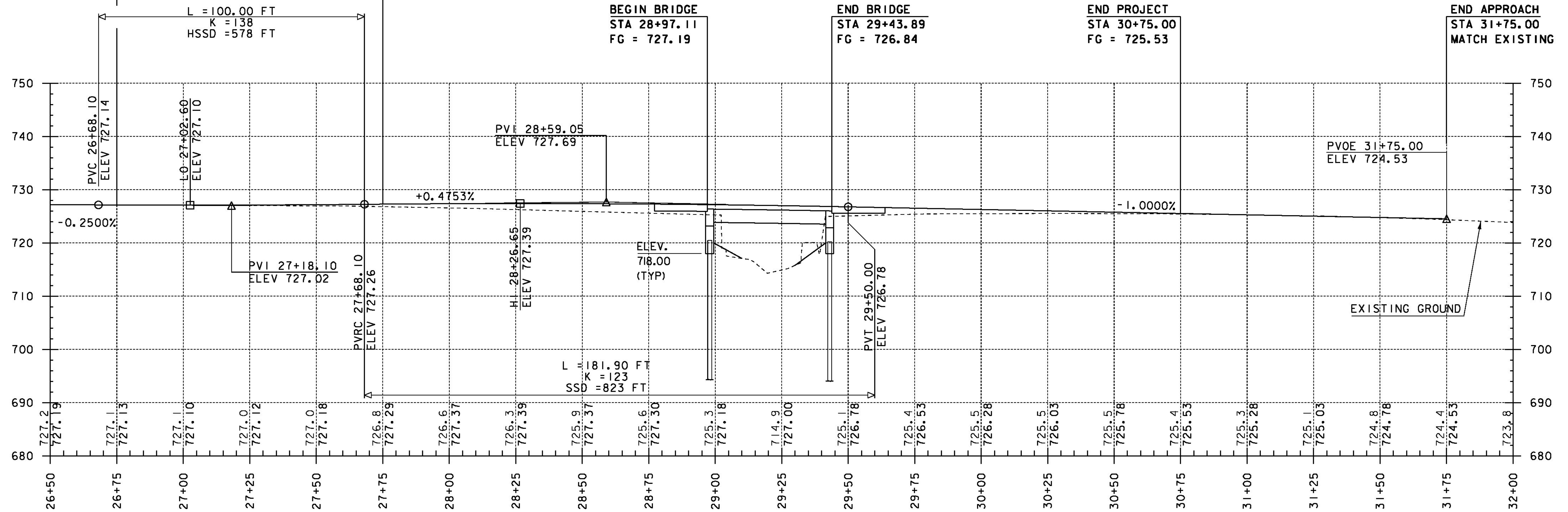

VT 12 PROFILE  
HORIZONTAL SCALE 1" = 20' -0"  
VERTICAL SCALE 1" = 10' -0"

THE GRADES SHOWN TO THE NEAREST TENTH ARE THE ORIGINAL  
GROUND ELEVATIONS ALONG THE PROPOSED ALIGNMENT.

THE GRADES SHOWN TO THE NEAREST HUNDREDTH ARE THE FINISH  
GRADES ALONG THE PROPOSED ALIGNMENT.

|                 |                |              |             |
|-----------------|----------------|--------------|-------------|
| PROJECT NAME:   | MIDDLESEX      | PLOT DATE:   | 13-JAN-2015 |
| PROJECT NUMBER: | BRF 024-(K37)  | DRAWN BY:    | R. PELLETT  |
| FILE NAME:      | sl0c220pro.dgn | DESIGNED BY: | H. SALLS    |
| PROJECT LEADER: | C. CARLSON     | CHECKED BY:  | H. SALLS    |
| VT 12 PROFILE   |                | SHEET        | 12 OF 46    |