

INDEX OF SHEETS

- 1. TITLE SHEET
- 2. GENERAL NOTES
- 3. QUANTITY SHEET
- 4. PLAN & ELEVATION
- 5.-7. TYPICAL SECTIONS - 1-3
- 8. LAYOUT SHEET
- 9. DETOUR PLAN
- 10. EPSC NARRATIVE
- 11. EPSC - EXISTING CONDITIONS
- 12. EPSC - DETAILS
- 13. MAINLINE CROSS SECTIONS
- 14-15. DETAIL SHEETS 1-2
- 16. BORING & MONITORING LAYOUT SHEET
- 17. SUBSURFACE PROFILE
- 19.-20. AS-BUILT PLANS

LIST OF STRUCTURES DETAILS

SD-516.10 BRIDGE JOINT ASPHALTIC PLUG 05-07-2010

LIST OF STANDARDS

D-30 UNDERDRAIN CONSTRUCTION DETAILS 08-13-2007
 E-100 CONSTRUCTION APPROACH SIGNS 01-02-2004
 E-101 CONSTRUCTION SIGN DETAILS 01-02-2004
 E-102 CONSTRUCTION SIGN DETAILS 06-30-2003
 E-102A CONSTRUCTION SIGN DETAILS 05-01-2004
 G-1 STEEL BEAM GUARDRAIL DETAILS 01-03-2000

STATE OF VERMONT AGENCY OF TRANSPORTATION



PROPOSED IMPROVEMENT BRIDGE PROJECT TOWN OF HIGHGATE CENTER, FRANKLIN COUNTY BRIDGE #6, VERMONT ROUTE 207

PROJECT LOCATION : TRAVELLING SOUTH ON VERMONT ROUTE 207 FROM THE INTERSECTION OF VERMONT ROUTE 78 TO MM 1.714 (STA 90+50) AND PROCEEDING NORTH TO MM 1.733 (STA 91+50)

PROJECT DESCRIPTION : INSTALLATION OF SLOPE STABILIZATION AND UNDERDRAIN AT EXISTING BRIDGE ABUTMENT, WITH MINOR APPROACH WORK.

LENGTH OF PROJECT: 100.00 FEET

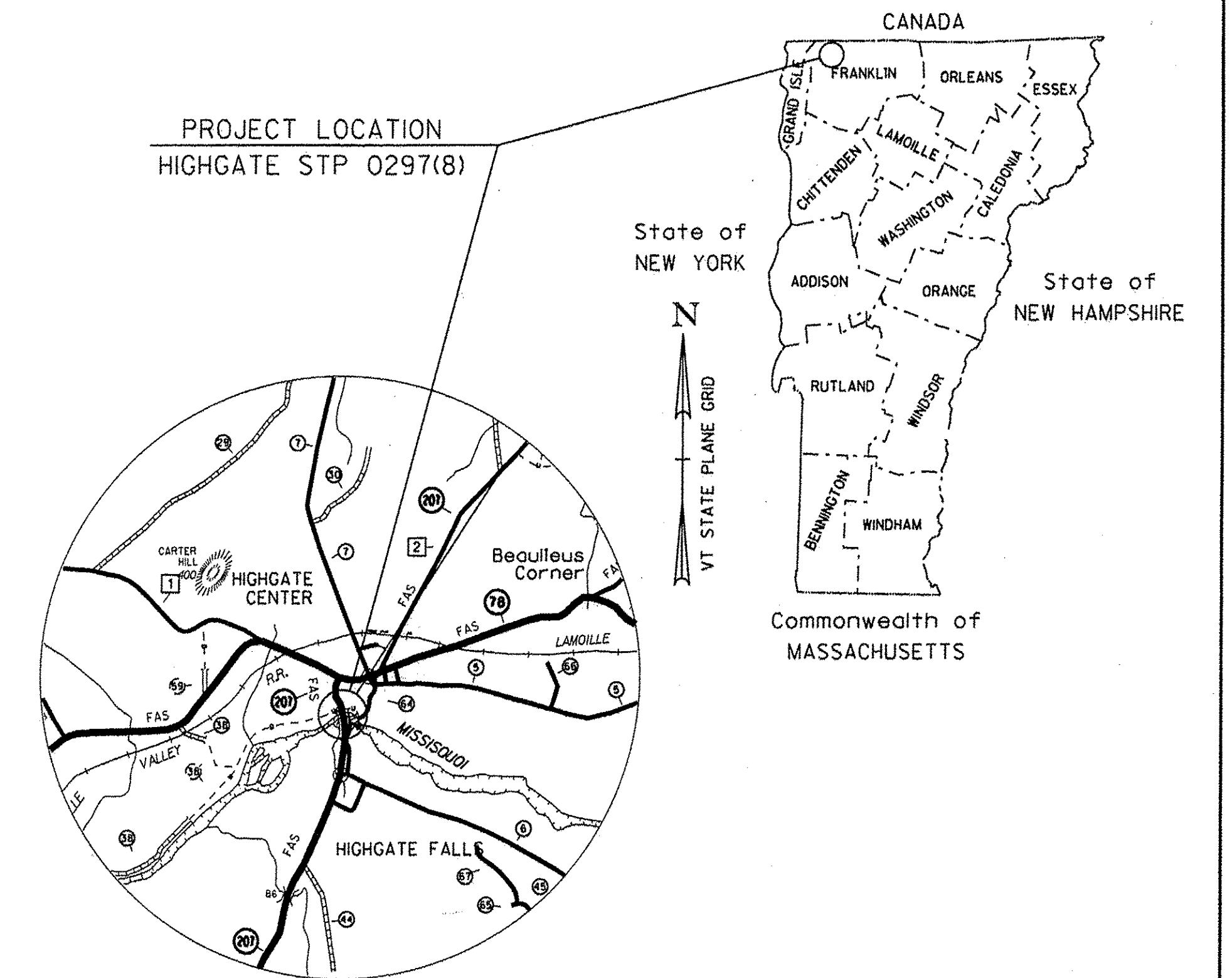
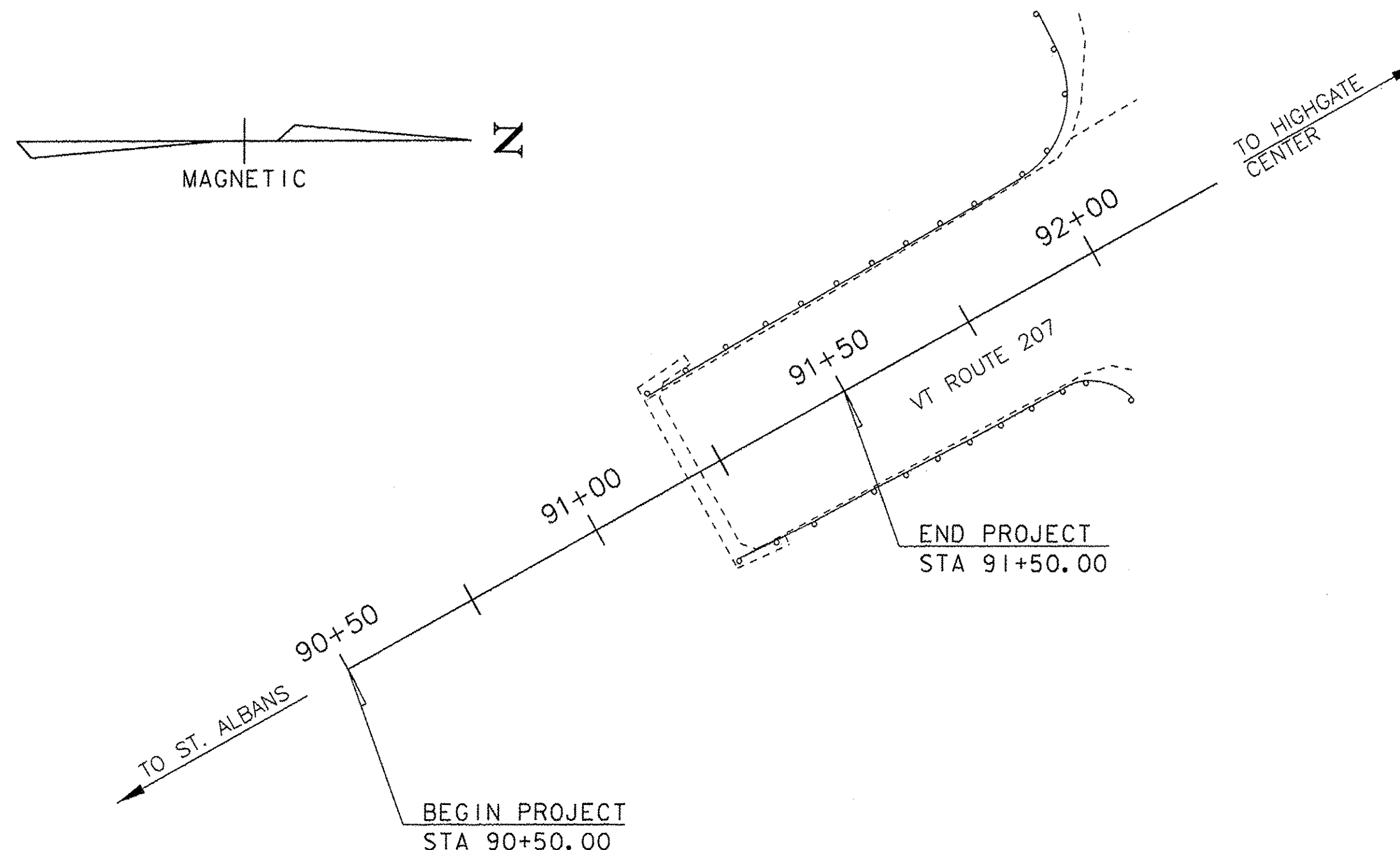

RECORD PLANS	
CONTRACTOR:	ENGINEERS CONSTR., INC. - SO. BURLINGTON, VT
RESIDENT ENGINEER:	SCOTT WHEATLEY
CONSTRUCTION BEGAN:	JULY 8, 2013
CONSTRUCTION COMPLETE:	NOVEMBER 2, 2013
RECORD PLANS BY:	SCOTT WHEATLEY & JENNA HYDE
I HEREBY CERTIFY THAT ALL THE CONSTRUCTION REQUIRED BY THIS SET OF DRAWINGS HAS BEEN ACCOMPLISHED AS INDICATED HEREIN.	
BY:	<i>Scott Wheatley</i> RESIDENT ENGINEER
DATE:	1-6-2016
NOTE: Any further information concerning final quantities, amounts or other details relative to this project may be found at Central Files in the electronic archives.	

QUALITY ASSURANCE PROGRAM: LEVEL 2

CONVENTIONAL SYMBOLS	
COUNTY LINE	
TOWN LINE	
LIMITS OF ACCESS	
POINT OF ACCESS	
FENCE LINE	
STONE WALL	
TRAVELED WAY	
GUARD RAIL	
RAILROAD	
SURVEY LINE	
CULVERT	
POWER POLE	
TELEPHONE POLE	
TREES	
CONTROL OF ACCESS	
PROPERTY LINE	
R.O.W. TAKING LINE	
SLOPE RIGHTS	
TOP OF CUT	
TOE OF SLOPE	

SURVEYED BY :	CLD ENGINEERS
SURVEYED DATE :	JULY 2008
DATUM	
VERTICAL	NAVD88
HORIZONTAL	NAD83/07

SCALE 1" = 20'-0"
20 0 20

THESE PLANS ARE SUBJECT TO SUCH ENGINEERING CHANGES AS MAY BE REQUIRED BY THE FEDERAL HIGHWAY ADMINISTRATION OR THE DIRECTOR OF PROGRAM DEVELOPMENT.
 CONSTRUCTION IS TO BE CARRIED ON IN ACCORDANCE WITH THESE PLANS AND THE STANDARD SPECIFICATIONS FOR CONSTRUCTION DATED 2011, AS APPROVED BY THE FEDERAL HIGHWAY ADMINISTRATION ON JULY 20, 2011 FOR USE ON THIS PROJECT, INCLUDING ALL SUBSEQUENT REVISIONS AND SUCH REVISED SPECIFICATIONS AND SPECIAL PROVISIONS AS ARE INCORPORATED IN THESE PLANS.

DIRECTOR OF PROGRAM DEVELOPMENT	
APPROVED <i>Richard Johnson</i>	DATE 1-2-13
PROJECT MANAGER : KRISTIN HIGGINS	
PROJECT NAME : HIGHGATE	
PROJECT NUMBER : STP 0297 (8) (RE-ADVERTISED)	
SHEET 1 OF 20 SHEETS	