

INDEX OF SHEETS
SEE SHEET 2

STATE OF VERMONT AGENCY OF TRANSPORTATION



PROPOSED IMPROVEMENT TOWNS OF SUDBURY AND BRANDON COUNTY OF RUTLAND VT ROUTE 73 (MAJOR COLLECTOR)

BEGINNING AT A POINT AT THE INTERSECTION OF VT ROUTE 73 AND VT ROUTE 30, IN THE TOWN
OF SUDBURY AT APPROXIMATE STATION 20+22 (MM0.383), AND EXTENDING EASTERLY APPROXIMATELY 4.462 MILES INTO
THE TOWN OF BRANDON AT APPROXIMATELY STATION 87+25 (MM 1.652).

SUDBURY = 14,836 FEET = 2.810 MILES.
BRANDON = 8,725 FEET = 1.652 MILES.
LENGTH OF PROJECT = 23,561 FEET = 4.462 MILES.

WORK TO BE PERFORMED UNDER THIS PROJECT INCLUDES PAVEMENT RECLAMATION,
PAVEMENT RESURFACING, GUARDRAIL ADJUSTMENT AND REPLACEMENT, NEW SIGNS,
AND OTHER HIGHWAY RELATED ITEMS.

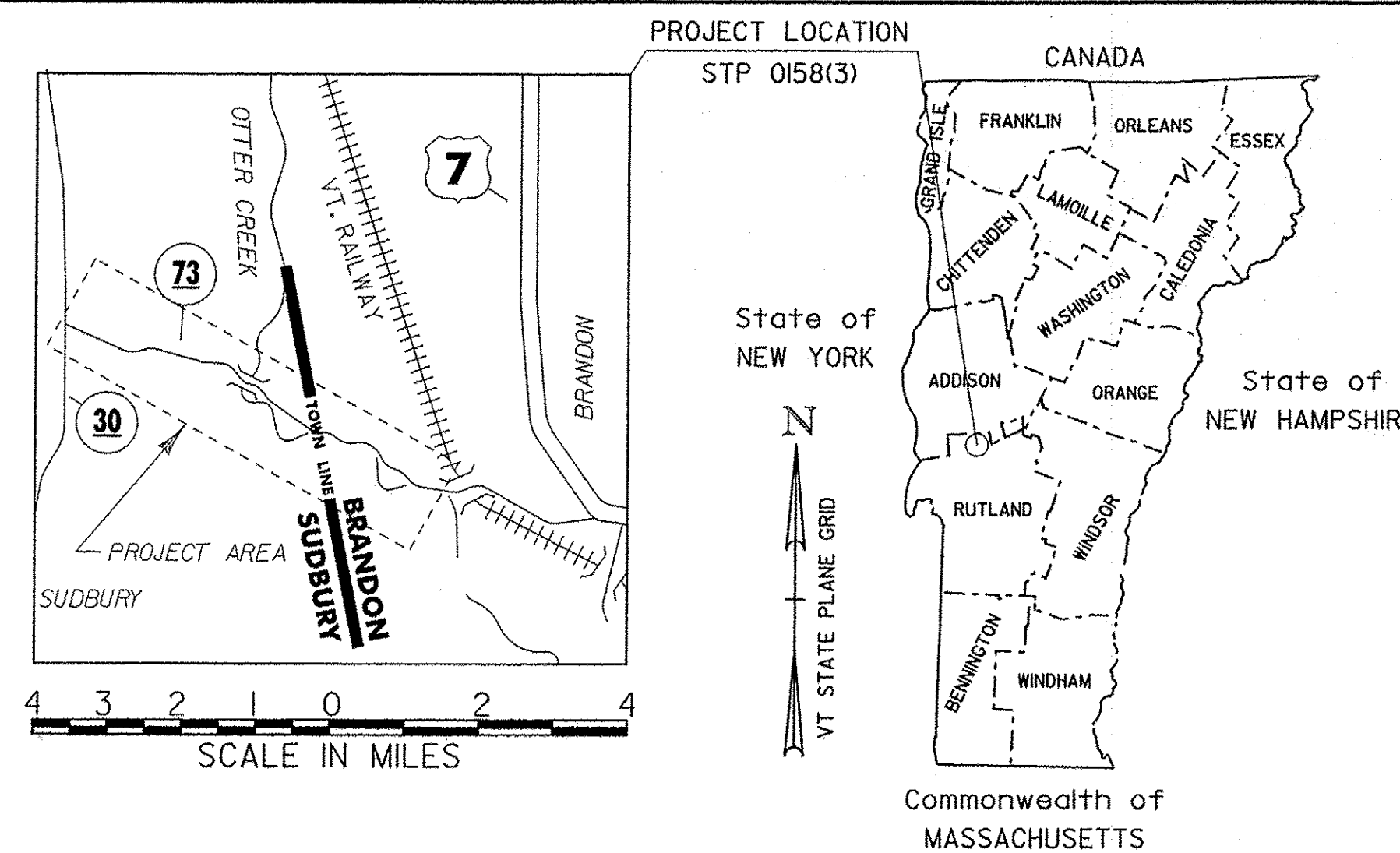

TRAFFIC DATA			
VT 73			
YEAR	2012	2032	2052
ADT	1900	2000	-
DHV	210	230	-
ADTT	140	210	-
ZD	58	58	-
ZT	7.4	10.4	-
DESIGN SPEED	50 MPH		
YEAR	2014-2034	2014-2054	
ESAL'S	811,000	1,784,000	

BITUMINOUS CONCRETE PAVEMENT SUPERPAVE MIXTURE DESIGN CRITERIA	
DESIGN LIFE ESAL'S (DESIGN LANE)	470,380
DESIGN NUMBER OF GYRATIONS	65
PERFORMANCE GRADED ASPHALT BINDER	SEE SUBSECTION 490.03 (b)

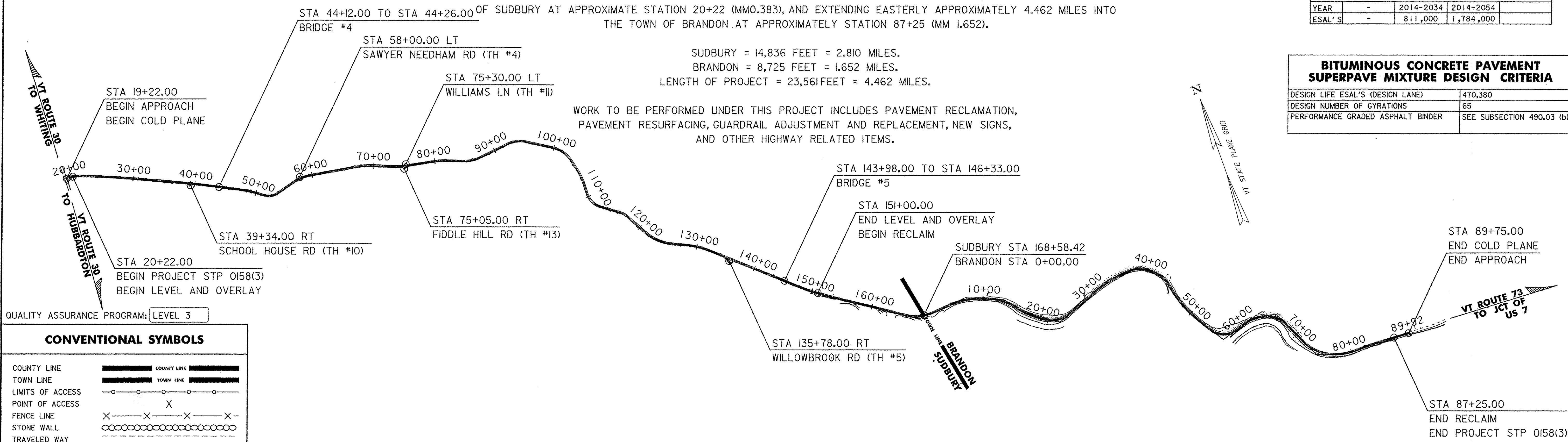

CONVENTIONAL SYMBOLS	
COUNTY LINE	
TOWN LINE	
LIMITS OF ACCESS	
POINT OF ACCESS	
FENCE LINE	
STONE WALL	
TRAVELED WAY	
GUARD RAIL	
RAILROAD	
SURVEY LINE	
CULVERT	
POWER POLE	
TELEPHONE POLE	
TREES	
CONTROL OF ACCESS	
PROPERTY LINE	
R.O.W. TAKING LINE	
SLOPE RIGHTS	
TOP OF CUT	
TOE OF SLOPE	

SURVEYED BY : L. Orvis P.C. & R. Bullock
SURVEYED DATE : 4/19/99

DATUM
VERTICAL NAVD_88
HORIZONTAL NAD_83_(96)

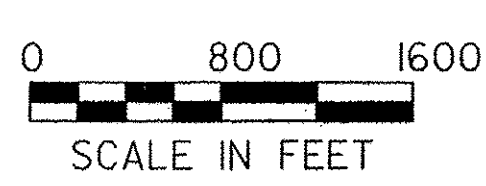

THESE PLANS ARE SUBJECT TO SUCH ENGINEERING CHANGES AS MAY BE REQUIRED BY THE FEDERAL HIGHWAY ADMINISTRATION OR THE DIRECTOR OF PROGRAM DEVELOPMENT.

CONSTRUCTION IS TO BE CARRIED ON IN ACCORDANCE WITH THESE PLANS AND THE STANDARD SPECIFICATIONS FOR CONSTRUCTION DATED 2011, AS APPROVED BY THE FEDERAL HIGHWAY ADMINISTRATION ON JULY 20, 2011 FOR USE ON THIS PROJECT, INCLUDING ALL SUBSEQUENT REVISIONS AND SUCH REVISED SPECIFICATIONS AND SPECIAL PROVISIONS AS ARE INCORPORATED IN THESE PLANS.

DIRECTOR OF PROGRAM DEVELOPMENT
APPROVED: *[Signature]* DATE 2-11-15
PROJECT MANAGER : K. UPMAL

PROJECT NAME : SUDBURY-BRANDON
PROJECT NUMBER : STP 0158 (3)

SHEET 1 OF 137 SHEETS