

DURABLE 4 INCH WHITE LINE (SEE OPTION ITEMS)
 STA. A 136+75 - STA. A 138+65.00 (SOLID LT & RT)

TEMPORARY 4 INCH WHITE LINE, PAINT
 STA. A 136+75 - STA. A 138+65.00 (SOLID LT & RT)

DURABLE 4 INCH YELLOW LINE (SEE OPTION ITEMS)
 STA. A 136+75 - STA. A 138+65.00 (SOLID LT & RT)

TEMPORARY 4 INCH YELLOW LINE, PAINT
 STA. A 136+75 - STA. A 138+65.00 (SOLID LT & RT)

REMOVING SIGNS
 AS SHOWN - 2

CURVE #22
 DELTA = 6° 12' 08"
 D = 2° 43' 42"
 R = 2100.00'
 T = 113.77'
 L = 227.32'
 E = 3.08'

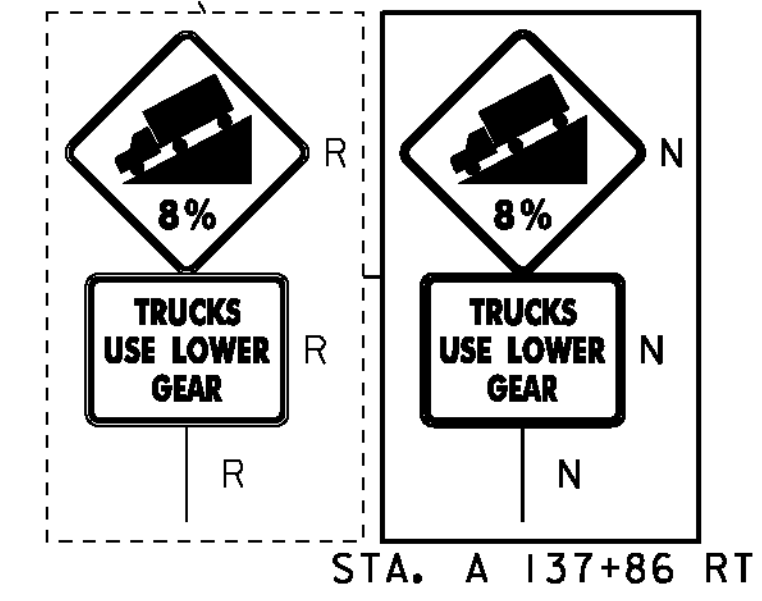
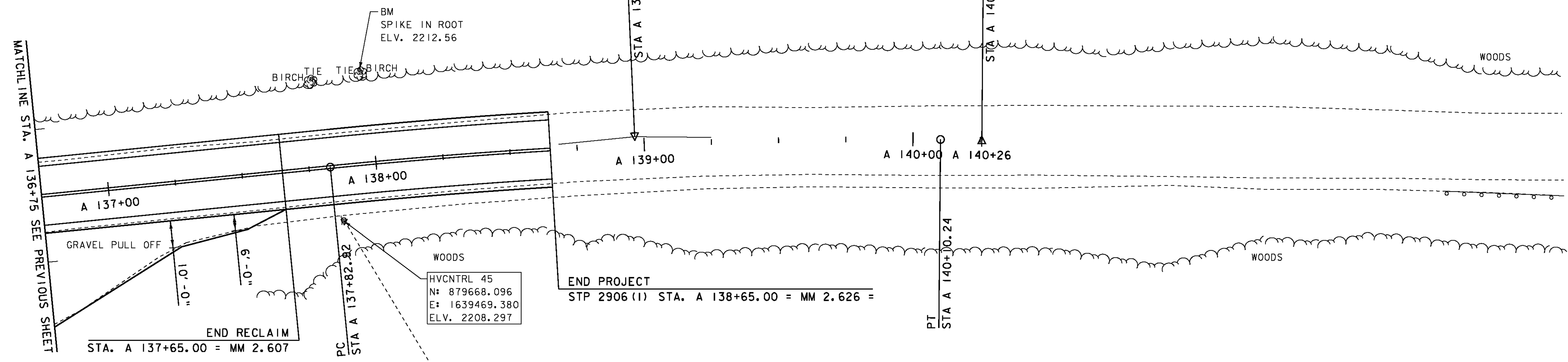

- LEGEND**
- MAILBOX
 - BORING
 - SIGN
 - HYDRANT
 - MANHOLE
 - WATER SHUT OFF (WSO)
 - GAS PIPELINE MARKER
 - CATCH BASIN / DROP INLET
 - CURB INLET
 - ⊠ TRAFFIC CONTROL BOX
 - ⊕ PARKING METER
 - ⊖ UTILITY POLE

- SIGN LEGEND**
- R = REMOVE
 - R&S = REMOVE AND SALVAGE
 - RET = RETAIN
 - S = SALVAGED
 - N = NEW
 - B-B = BACK TO BACK
 - = EXISTING
 - = NEW

DATUM
 VERTICAL NAVD 88
 HORIZONTAL NAD 83



PROJECT LAYOUT SHEET 61	PROJECT NAME: MONTGOMERY-WESTFIELD PROJECT NUMBER: STP 2906(I)
	FILE NAME: p10ci90.dgn PROJECT LEADER: CDL DESIGNED BY: SJL PLOT FILE: p10ci90_8IB.I