

DURABLE 4 INCH WHITE LINE (SEE OPTION ITEMS)  
 STA. 190+50 - STA. 196+50 (SOLID LT & RT)

TEMPORARY 4 INCH WHITE LINE, PAINT  
 STA. 190+50 - STA. 196+50 (SOLID LT & RT)

REMOVING SIGNS  
 AS SHOWN - 2

BARRIER FENCE  
 STA. 191+54 - STA. 193+47 LT

DURABLE 4 INCH YELLOW LINE (SEE OPTION ITEMS)  
 STA. 190+50 - STA. 196+50 (SOLID LT & RT)

TEMPORARY 4 INCH YELLOW LINE, PAINT  
 STA. 190+50 - STA. 196+50 (SOLID LT & RT)

EROSION LOG  
 STA. 191+54 - STA. 193+47 LT

6" UNDERDRAIN PIPE  
 STA. 190+50 - STA. 191+50 LT  
 STA. 193+36 - STA. 195+56 LT

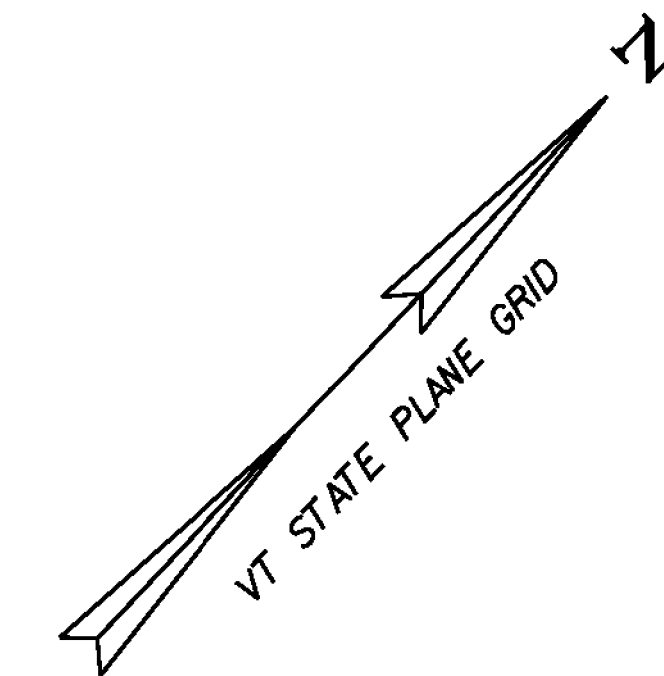

**ENVIRONMENTALLY SENSITIVE LOCATIONS:**

NO.	LIMITS	POS.	TYPE
23.	STA. 191+54 - STA. 193+47	LT	-

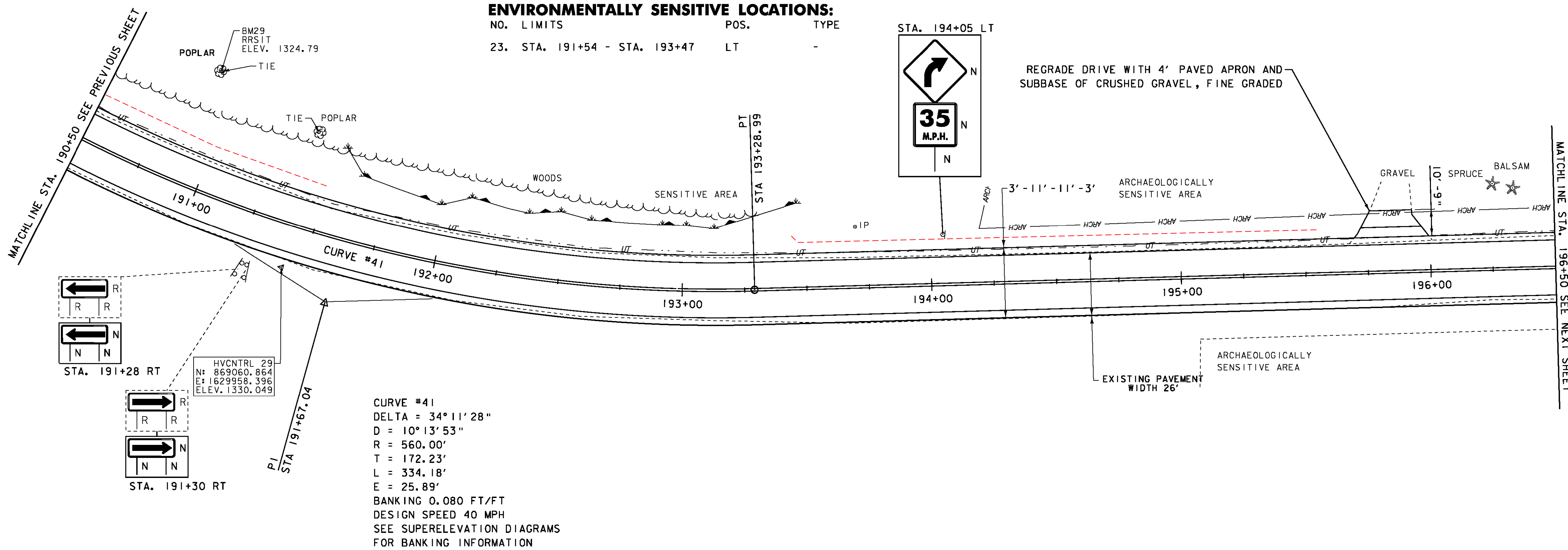

**CURVE #41**  
 DELTA = 34° 11' 28"  
 D = 10° 13' 53"  
 R = 560.00'  
 T = 172.23'  
 L = 334.18'  
 E = 25.89'  
 BANKING 0.080 FT/FT  
 DESIGN SPEED 40 MPH  
 SEE SUPERELEVATION DIAGRAMS  
 FOR BANKING INFORMATION

BM29  
 RRSIT  
 ELEV. 1324.79  
 POPLAR  
 TIE

TIE  
 POPLAR

PT  
 STA 193+28.99

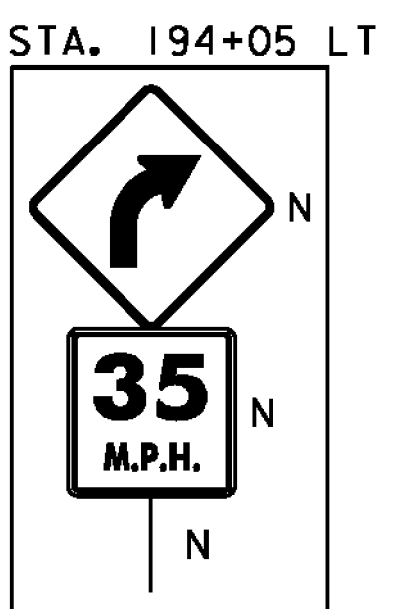

REGRADE DRIVE WITH 4' PAVED APRON AND  
 SUBBASE OF CRUSHED GRAVEL, FINE GRADED

3' - 11' - 11' - 3'

ARCHAEOLOGICALLY SENSITIVE AREA

GRAVEL  
 10' - 9"  
 SPRUCE  
 BALSAM

EXISTING PAVEMENT  
 WIDTH 26'

ARCHAEOLOGICALLY SENSITIVE AREA

- LEGEND**
- MAILBOX
  - BORING
  - SIGN
  - HYDRANT
  - MANHOLE
  - WATER SHUT OFF (WSO)
  - GAS PIPELINE MARKER
  - CATCH BASIN / DROP INLET
  - CURB INLET
  - TRAFFIC CONTROL BOX
  - PARKING METER
  - UTILITY POLE

- SIGN LEGEND**
- R = REMOVE
  - R&S = REMOVE AND SALVAGE
  - RET = RETAIN
  - S = SALVAGED
  - N = NEW
  - B-B = BACK TO BACK
  - = EXISTING
  - = NEW

DATUM  
 NAVD 88  
 NAD 83



<b>PROJECT LAYOUT SHEET 35</b>	PROJECT NAME: MONTGOMERY-WESTFIELD
	PROJECT NUMBER: STP 2906(I)
	FILE NAME: p10C190.dgn
	PLOT DATE: 9/5/12
PROJECT LEADER: CDL	DRAWN BY: SJL
DESIGNED BY: SJL	CHECKED BY: EPD
PLOT FILE: p10C190_56.1	SHEET 56 OF 178

SEH  
 2-25-14