

DURABLE 4 INCH WHITE LINE (SEE OPTION ITEMS)
 STA. 101+75 - STA. 107+25 (SOLID LT & RT)

TEMPORARY 4 INCH WHITE LINE, PAINT
 STA. 101+75 - STA. 107+25 (SOLID LT & RT)

6 INCH UNDERDRAIN PIPE
 STA. 101+75 - STA. ~~102+00~~ LT
 103+40

STONE FILL, TYPE I
 STA. 103+00 - STA. 103+39 LT
 STA. 103+75 - STA. 103+90 RT

DURABLE 4 INCH YELLOW LINE (SEE OPTION ITEMS)
 STA. 101+75 - STA. 107+25 (SOLID LT & RT)

TEMPORARY 4 INCH YELLOW LINE, PAINT
 STA. 101+75 - STA. 107+25 (SOLID LT & RT)

REMOVING SIGNS
 AS SHOWN - 1

GRUBBING MATERIAL
 STA. 103+00 - STA. 103+39 LT
 STA. 103+75 - STA. 103+90 RT

GEOTEXTILE UNDER STONE FILL
 STA. 103+00 - STA. 103+39 LT
 STA. 103+75 - STA. 103+90 RT

GEOTEXTILE FOR SILT FENCE
 STA. 103+00 - STA. 103+39 LT
 STA. 103+75 - STA. 103+90 RT

ENVIRONMENTALLY SENSITIVE LOCATIONS:

NO.	LIMITS	POS.	TYPE
8.	STA. 101+75 - STA. 104+53	LT	-
9.	STA. 103+90 - STA. 107+25	RT	-
10.	STA. 105+43 - STA. 107+25	LT	-

CURVE #22
 DELTA = 18°15'34"
 D = 3°22'13"
 R = 1700.00'
 T = 273.20'
 L = 541.77'
 E = 21.81'

BANKING 0.056 FT/FT
 DESIGN SPEED 50 MPH
 SEE SUPERELEVATION DIAGRAMS
 FOR BANKING INFORMATION

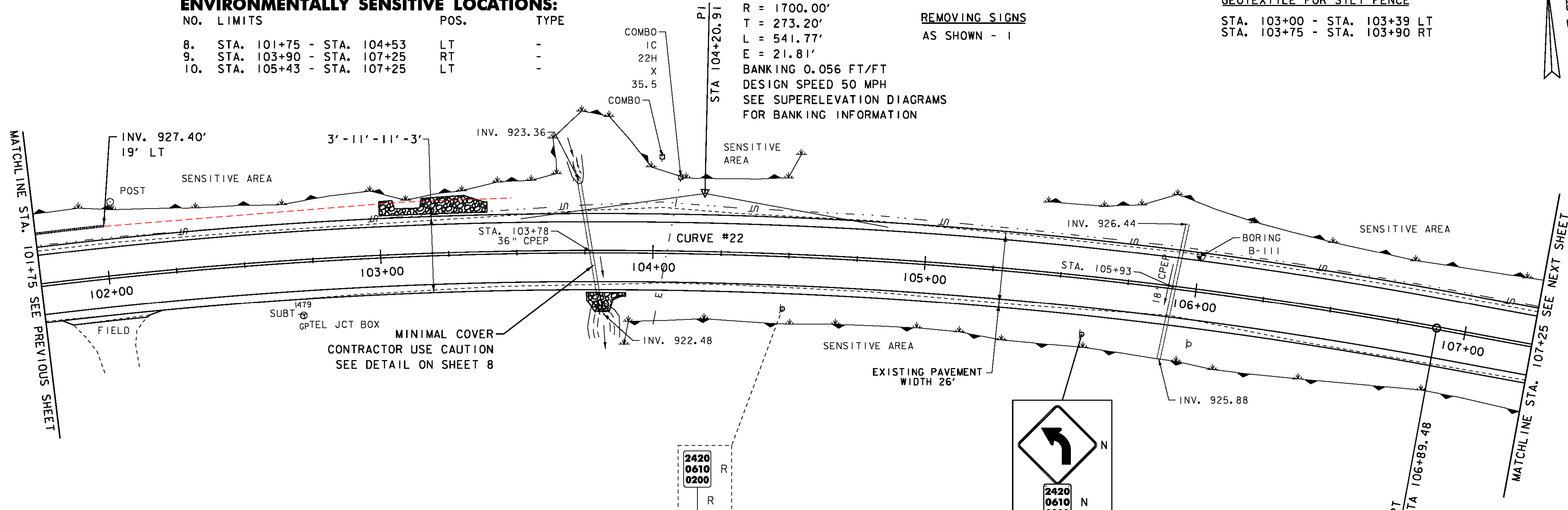

BARRIER FENCE

STA. 101+75 - STA. 104+53 LT
 STA. 103+90 - STA. 107+25 RT
 STA. 105+43 - STA. 107+25 LT

EROSION LOG

STA. 101+75 - STA. 104+53 LT
 STA. 103+90 - STA. 107+25 RT
 STA. 105+43 - STA. 107+25 LT

LEGEND

- MAILBOX
- BORING
- SIGN
- HYDRANT
- MANHOLE
- WATER SHUT OFF (WSO)
- GAS PIPELINE MARKER
- CATCH BASIN / DROP INLET
- CURB INLET
- ⊠ TRAFFIC CONTROL BOX
- ⊕ PARKING METER
- ⊖ UTILITY POLE

SIGN LEGEND

- R = REMOVE
- R&S = REMOVE AND SALVAGE
- RET = RETAIN
- S = SALVAGED
- N = NEW
- B-B = BACK TO BACK
- = EXISTING
- = NEW

DATUM
 VERTICAL NAVD 88
 HORIZONTAL NAD 83

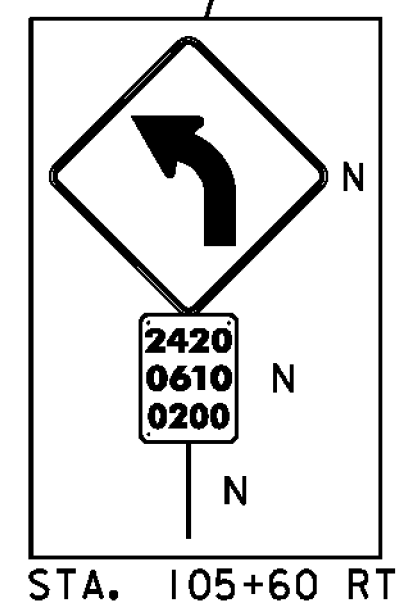

STA. 105+60 RT

SCALE IN FEET
 20 0 20

PROJECT LAYOUT SHEET 19

PROJECT NAME: MONTGOMERY-WESTFIELD
 PROJECT NUMBER: STP 2906(I)

FILE NAME: piOC190.dgn
 PROJECT LEADER: CDL
 DESIGNED BY: SJL
 PLOT FILE: piOC190_40.I

PLOT DATE: 9/5/12
 DRAWN BY: SJL
 CHECKED BY: EPD
 SHEET 40 OF 178

SEH
 2-25-14