

PHASE 1
SCALE: 3/8" = 1'-0"

VARIES
3'-8 3/8" MAX
3'-0 1/2" MIN

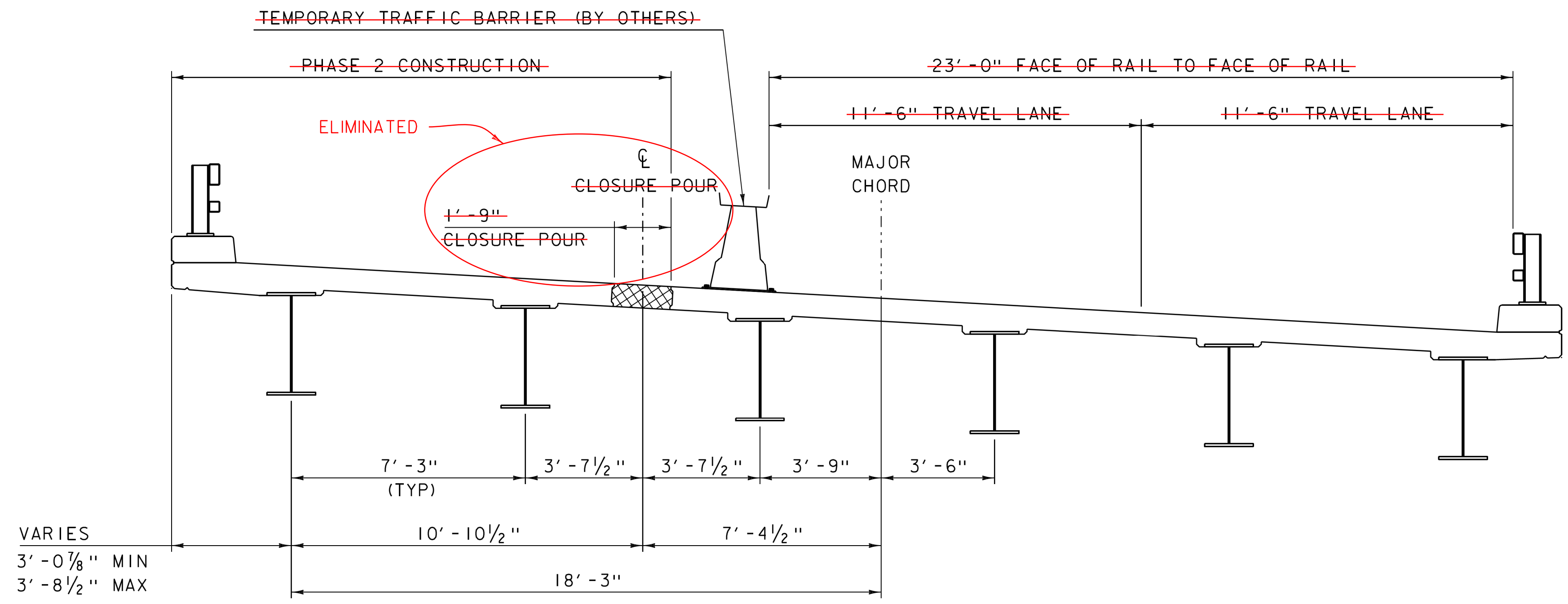

PHASE 2
SCALE: 3/8" = 1'-0"

CONTRACTOR WAS ABLE TO PLACE GIRDERS AND DECK WITHOUT PHASING. TRAFFIC WAS KEPT ON TEMPORARY BRIDGE THROUGHOUT. DECK WAS PLACED FULL WIDTH.

NOTE:

CENTERLINE RUMBLE STRIPS ARE CURRENTLY IN PLACE ON THIS PORTION OF VERMONT ROUTE 9. IF FINAL PHASING PLAN REQUIRES MASKING OF ANY EXISTING CENTERLINE PAVEMENT MARKINGS, THE RUMBLE STRIPS WILL HAVE TO BE FILLED. IF THIS OCCURS, THE RUMBLE STRIP SHALL BE RESTORED AT THE END OF CONSTRUCTION. PAYMENT WILL BE INCIDENTAL TO CONTRACT ITEM 900.645 SPECIAL PROVISION (TRAFFIC CONTROL, ALL-INCLUSIVE).

AS APPROVED, RUMBLE STRIPS WERE NOT RESTORED.

△ - SHEET REVISED 4/8/2014.
REPLACES SHEET 13 IN CONTRACT PLANS.

PROJECT NAME: MARLBORO	
PROJECT NUMBER: BRF 010-1(43)	
FILE NAME: s10b414phasewrk.dgn	PLOT DATE: 08-APR-2014
PROJECT LEADER: K. HIGGINS	DRAWN BY: R. KLINEFELTER
DESIGNED BY: R. KLINEFELTER	CHECKED BY: J. SALVATORI
PHASE CONSTRUCTION DETAILS 1	SHEET 13 OF 50

