

NOTES:

1) PIPE OPTION I SHALL BE THE CONTRACTORS OPTION FOR EITHER CAAP OR PCCSP

100 STA. 120+41.0, LT. - STA. 120+45.0, RT.
 CONSTRUCT 42" x 64' PIPE OPTION I
 CONSTRUCT HEADWALL @ INLET AND OUTLET
 CONSTRUCT STONE FILL TYPE II INLET AND OUTLET PROTECTION
 INVERT IN = 457.87
 INVERT OUT = 454.48

EXISTING ROW

BEGIN FULL DEPTH CONSTRUCTION
 STA. 119+39.00 = MM 2.261

RESUME FLETCHER STP 027-1(22)
STOP CAMBRIDGE-BAKERSFIELD STP 2926(1)
 STA. 118+86.00 = MM 2.251 VT ROUTE 108

END FULL DEPTH CONSTRUCTION
 STA. 120+19.00 = MM 2.276

END FLETCHER STP 027-1(22)
RESUME CAMBRIDGE-BAKERSFIELD STP 2926(1)
 STA. 120+82.33 = MM 2.288 VT ROUTE 108

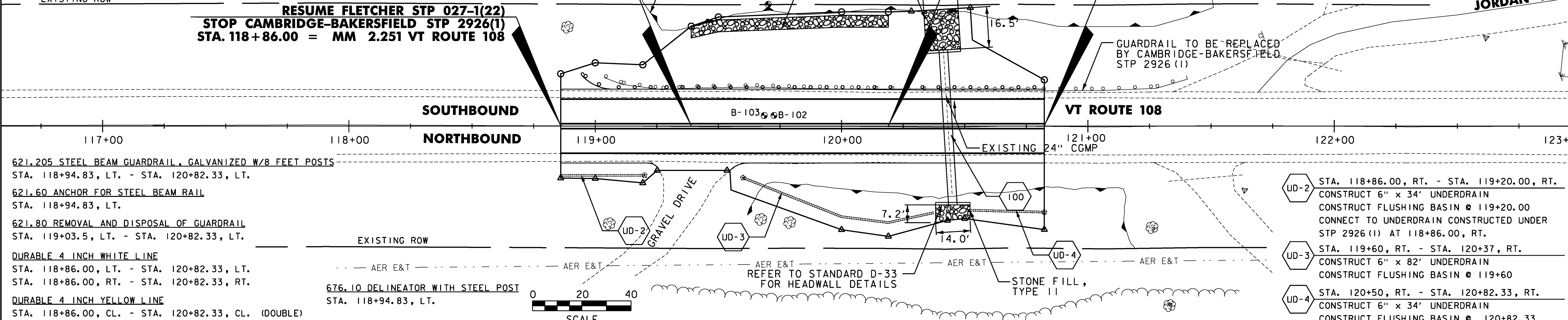
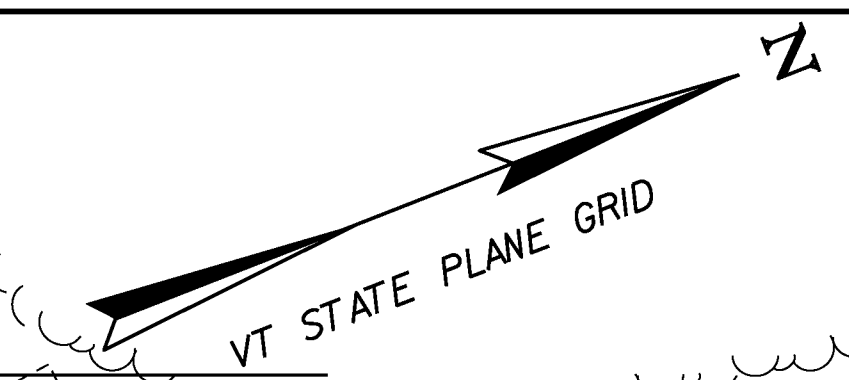

- 621.205 STEEL BEAM GUARDRAIL, GALVANIZED W/8 FEET POSTS
 STA. 118+94.83, LT. - STA. 120+82.33, LT.
- 621.60 ANCHOR FOR STEEL BEAM RAIL
 STA. 118+94.83, LT.
- 621.80 REMOVAL AND DISPOSAL OF GUARDRAIL
 STA. 119+03.5, LT. - STA. 120+82.33, LT.
- DURABLE 4 INCH WHITE LINE
 STA. 118+86.00, LT. - STA. 120+82.33, LT.
 STA. 118+86.00, RT. - STA. 120+82.33, RT.
- DURABLE 4 INCH YELLOW LINE
 STA. 118+86.00, CL. - STA. 120+82.33, CL. (DOUBLE)

- UD-2 STA. 118+86.00, RT. - STA. 119+20.00, RT.
 CONSTRUCT 6" x 34' UNDERDRAIN
 CONSTRUCT FLUSHING BASIN @ 119+20.00
 CONNECT TO UNDERDRAIN CONSTRUCTED UNDER
 STP 2926 (1) AT 118+86.00, RT.
- UD-3 STA. 119+60, RT. - STA. 120+37, RT.
 CONSTRUCT 6" x 82' UNDERDRAIN
 CONSTRUCT FLUSHING BASIN @ 119+60
- UD-4 STA. 120+50, RT. - STA. 120+82.33, RT.
 CONSTRUCT 6" x 34' UNDERDRAIN
 CONSTRUCT FLUSHING BASIN @ 120+82.33

676.10 DELINEATOR WITH STEEL POST
 STA. 118+94.83, LT.

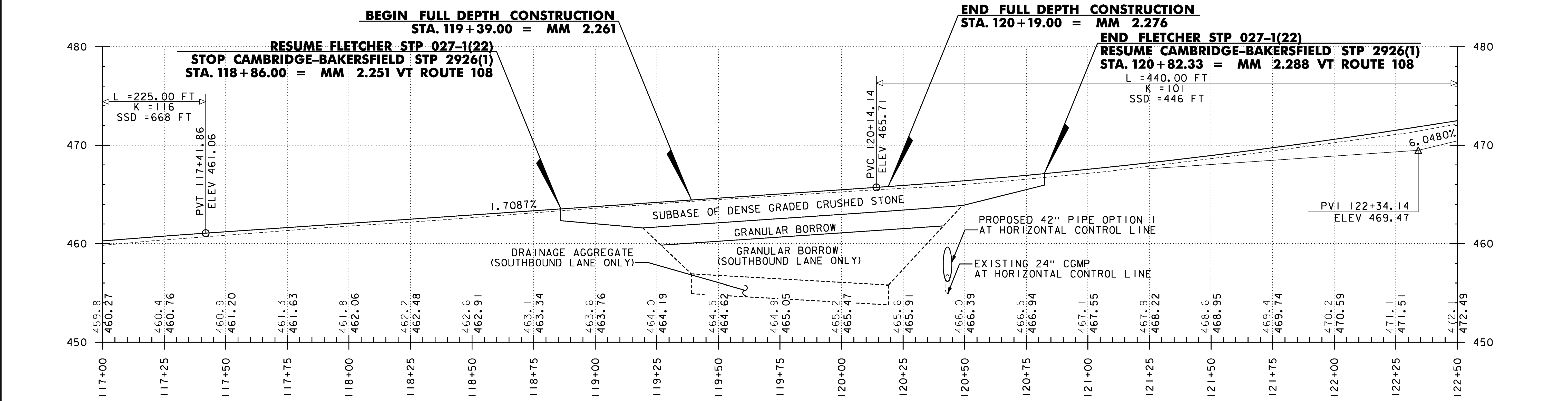

BEGIN FULL DEPTH CONSTRUCTION
 STA. 119+39.00 = MM 2.261

RESUME FLETCHER STP 027-1(22)
STOP CAMBRIDGE-BAKERSFIELD STP 2926(1)
 STA. 118+86.00 = MM 2.251 VT ROUTE 108

END FULL DEPTH CONSTRUCTION
 STA. 120+19.00 = MM 2.276

END FLETCHER STP 027-1(22)
RESUME CAMBRIDGE-BAKERSFIELD STP 2926(1)
 STA. 120+82.33 = MM 2.288 VT ROUTE 108

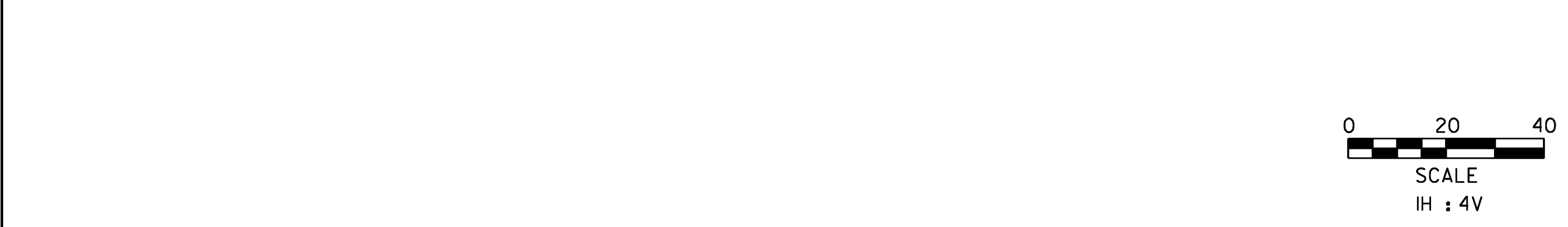

SITE 2 PLAN-PROFILE SHEET	PROJECT NAME: FLETCHER
	PROJECT NUMBER: STP 027-1(22)
	FILE NAME: ...\\plottiles\zllb064bdr_lay2.dgn PLOT DATE: 11/15/2012
	DESIGNED BY: ISM
	PROJECT LEADER: GAE
	DRAWN BY: STANTEC
	CHECKED BY: MCF
	SHEET 360 OF 387

