

STONE FILL, TYPE J  
STA. 157+25 TO 160+50, LT

RELOCATE MAILBOX, SINGLE SUPPORT  
STA. 156+64, LT  
STA. 156+65, LT

STEEL BEAM GUARDRAIL, GALVANIZED W/8 FEET POSTS  
STA. 156+91 TO 160+50, LT  
STA. 158+18 TO 160+50, RT

ANCHOR FOR STEEL BEAM RAIL  
STA. 156+91, LT  
STA. 158+18, RT

REMOVAL AND DISPOSAL OF GUARDRAIL  
STA. 156+90 TO 160+50, LT  
STA. 158+21 TO 160+50, RT

DURABLE 4 INCH WHITE LINE  
(ALL LINES WILL INCLUDE EDGE LINE BREAKS AND RADII FOR SIDE ROADS)  
STA. 155+50 TO 160+50, SOLID LT & RT

DURABLE 4 INCH YELLOW LINE  
(ALL LINES WILL INCLUDE  $\phi$  BREAKS FOR SIDE ROADS)  
STA. 155+50 TO 160+50, SOLID LT, DASHED RT

TEMPORARY 4 INCH WHITE LINE, PAINT  
(ALL LINES WILL INCLUDE EDGE LINE BREAKS AND RADII FOR SIDE ROADS)  
STA. 155+50 TO 160+50, SOLID LT & RT

TEMPORARY 4 INCH YELLOW LINE, PAINT  
(ALL LINES WILL INCLUDE  $\phi$  BREAKS FOR SIDE ROADS)  
STA. 155+50 TO 160+50, SOLID LT, DASHED RT

GEOTEXTILE UNDER STONE FILL  
STA. 157+25 TO 158+25, LT  
STA. 159+25 TO 160+50, LT

GRUBBING MATERIAL  
STA. 157+25 TO 158+25, LT  
STA. 159+25 TO 160+50, LT

BARRIER FENCE  
STA. 158+00 TO 160+50, LT  
(WITH BREAKS FOR DRIVES AND SIDEROADS)

REMOVING SIGNS  
AS SHOWN - 1

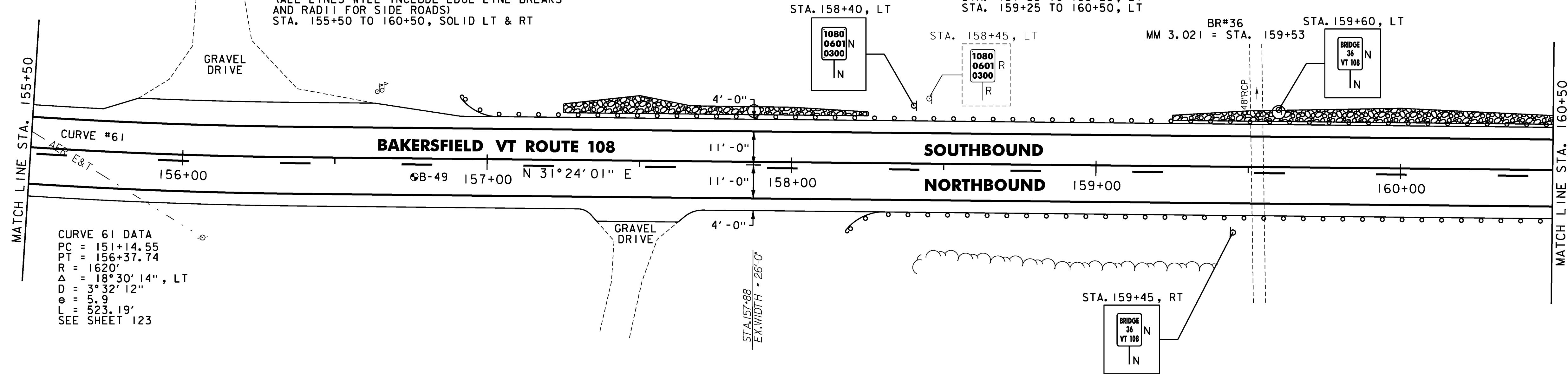

CURVE #61 DATA  
PC = 151+14.55  
PT = 156+37.74  
R = 1620'  
 $\Delta = 18^\circ 30' 14''$ , LT  
D = 3° 32' 12"  
e = 5.9  
L = 523.19'  
SEE SHEET 123

SOIL BORING DATA			
BORING#	DEPTH (FT.)	PCC	COMMENTS
B-49	5.0'	NO	

**ENVIRONMENTALLY SENSITIVE LOCATIONS:**

NO.	LIMITS	POSITION
26.	158+00 TO 160+50	LT

STEEL BEAM GUARDRAIL, GALVANIZED W/8 FEET POSTS  
STA. 160+50 TO 162+05.5, RT  
STA. 160+50 TO 162+16, LT

ANCHOR FOR STEEL BEAM RAIL  
STA. 162+05.5, RT  
STA. 162+16, LT

REMOVAL AND DISPOSAL OF GUARDRAIL  
STA. 160+50 TO 162+06, RT  
STA. 160+50 TO 162+13, LT

DURABLE 4 INCH WHITE LINE  
(ALL LINES WILL INCLUDE EDGE LINE BREAKS AND RADII FOR SIDE ROADS)  
STA. 160+50 TO 165+50, SOLID LT & RT

DURABLE 4 INCH YELLOW LINE  
(ALL LINES WILL INCLUDE  $\phi$  BREAKS FOR SIDE ROADS)  
STA. 160+50 TO 161+83, SOLID LT, DASHED RT  
STA. 161+83 TO 165+50, DASHED  $\phi$

TEMPORARY 4 INCH WHITE LINE, PAINT  
(ALL LINES WILL INCLUDE EDGE LINE BREAKS AND RADII FOR SIDE ROADS)  
STA. 160+50 TO 165+50, SOLID LT & RT

TEMPORARY 4 INCH YELLOW LINE, PAINT  
(ALL LINES WILL INCLUDE  $\phi$  BREAKS FOR SIDE ROADS)  
STA. 160+50 TO 161+83, SOLID LT, DASHED RT  
STA. 161+83 TO 165+50, DASHED  $\phi$

BARRIER FENCE  
STA. 160+50 TO 161+00, LT  
STA. 163+00 TO 165+00, LT  
(WITH BREAKS FOR DRIVES AND SIDEROADS)

GEOTEXTILE UNDER STONE FILL  
STA. 160+50 TO 160+75, LT

GRUBBING MATERIAL  
STA. 160+50 TO 160+75, LT

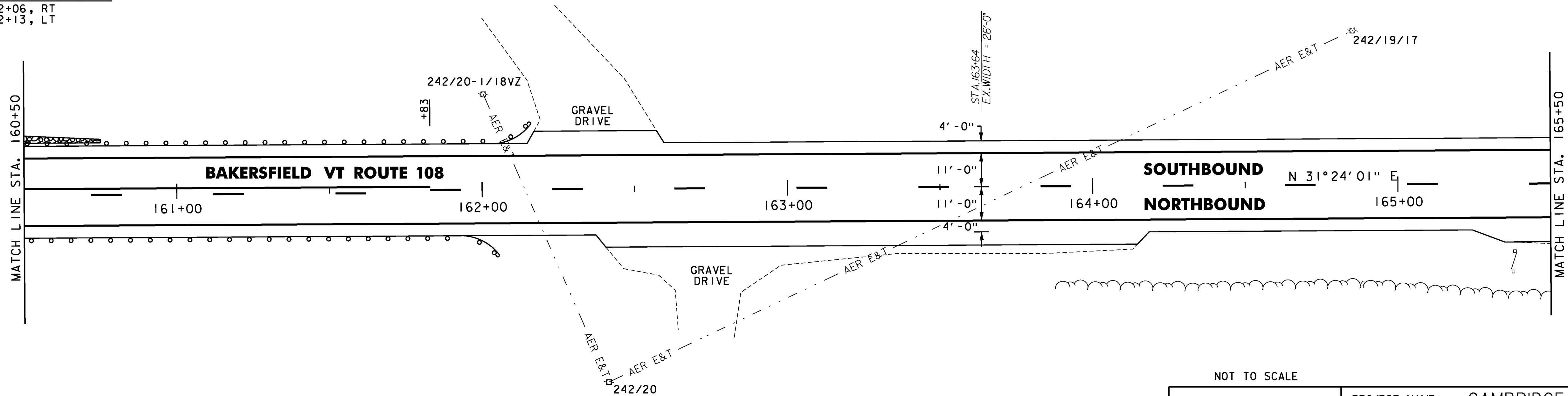

**ENVIRONMENTALLY SENSITIVE LOCATIONS:**

NO.	LIMITS	POSITION
26.	160+50 TO 161+00	LT
27.	163+00 TO 165+00	LT

**NOTES:**

- FOR LEGENDS, SEE SHEET 27.
- ALL EXISTING SIGNS NOT SHOWN SHALL BE RETAINED.
- DURABLE MARKINGS DETAILED ON THIS SHEET ARE OPTION BID ITEMS. SEE SHEET 14.



NOT TO SCALE

**PROJECT LAYOUT SHEET #52**

PROJECT NAME: CAMBRIDGE-BAKERSFIELD  
PROJECT NUMBER: STP 2926(I)

FILE NAME: p10b258.dgn  
PROJECT LEADER: JLL  
DESIGNED BY: STANTEC  
IPARM FILE: p10b258152.i

PLOT DATE: 11/15/2012  
DRAWN BY: STANTEC  
CHECKED BY: STANTEC  
SHEET 78 OF 387