

RELOCATE MAILBOX, SINGLE SUPPORT
 STA. 147+21, LT
 STA. 147+23, LT
 STA. 147+24, LT

DURABLE 4 INCH YELLOW LINE
 (ALL LINES WILL INCLUDE $\frac{1}{2}$ BREAKS FOR SIDE ROADS)
 STA. 145+50 TO 150+50, SOLID LT & RT

TEMPORARY 4 INCH WHITE LINE, PAINT
 (ALL LINES WILL INCLUDE EDGE LINE BREAKS
 AND RADII FOR SIDE ROADS)
 STA. 145+50 TO 150+50, SOLID LT & RT

TEMPORARY 4 INCH YELLOW LINE, PAINT
 (ALL LINES WILL INCLUDE $\frac{1}{2}$ BREAKS FOR SIDE ROADS)
 STA. 145+50 TO 150+50, SOLID LT & RT

REMOVING SIGNS
 AS SHOWN - 1

DURABLE 4 INCH WHITE LINE
 (ALL LINES WILL INCLUDE EDGE LINE BREAKS
 AND RADII FOR SIDE ROADS)
 STA. 145+50 TO 150+50, SOLID LT & RT

CURVE 60 DATA
 PC = 146+60.30
 PT = 149+31.60
 R = 2500'
 Δ = 6° 13' 04", LT
 D = 2° 17' 31"
 e = 4.3
 L = 271.30'
 SEE SHEET 123

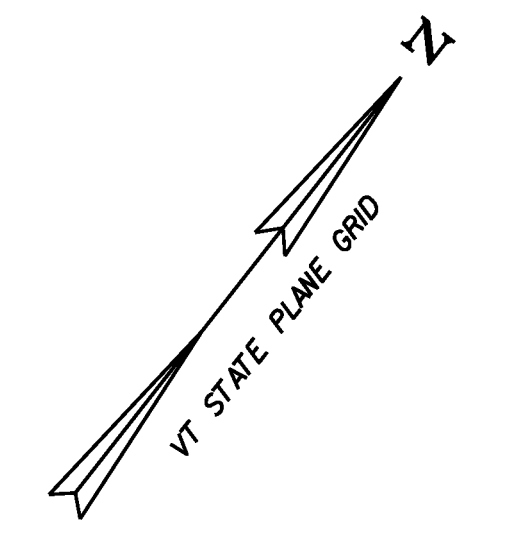
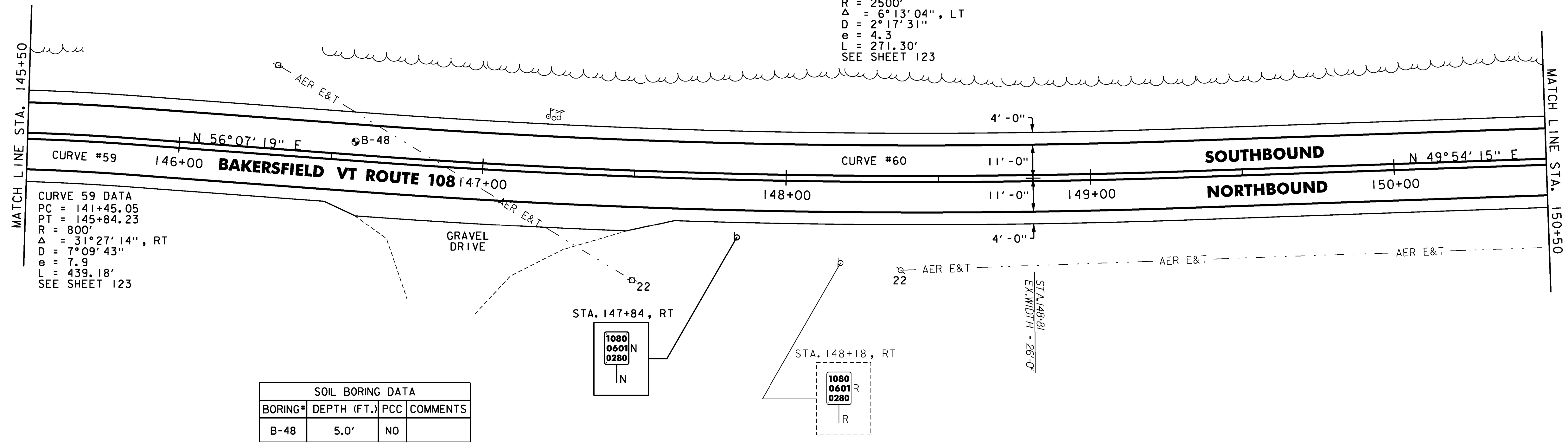

STONE FILL, TYPE 1
 STA. 152+00 TO 152+80, LT

DURABLE 4 INCH WHITE LINE
 (ALL LINES WILL INCLUDE EDGE LINE BREAKS
 AND RADII FOR SIDE ROADS)
 STA. 150+50 TO 155+50, SOLID LT & RT

TEMPORARY 4 INCH WHITE LINE, PAINT
 (ALL LINES WILL INCLUDE EDGE LINE BREAKS
 AND RADII FOR SIDE ROADS)
 STA. 150+50 TO 155+50, SOLID LT & RT

TEMPORARY 4 INCH YELLOW LINE, PAINT
 (ALL LINES WILL INCLUDE $\frac{1}{2}$ BREAKS FOR SIDE ROADS)
 STA. 150+50 TO 153+12, SOLID LT & RT
 STA. 153+12 TO 155+50, SOLID LT, DASHED RT

GEOTEXTILE UNDER STONE FILL
 STA. 152+25 TO 152+75, LT

REHAB. DIS. CBS OR MHS. CLASS 1
 STA. 150+88, RT "THROAT DI"
 SEE DETAIL ON SHEET 25

DURABLE 4 INCH YELLOW LINE
 (ALL LINES WILL INCLUDE $\frac{1}{2}$ BREAKS FOR SIDE ROADS)
 STA. 150+50 TO 153+12, SOLID LT & RT
 STA. 153+12 TO 155+50, SOLID LT, DASHED RT

RELOCATE MAILBOX, SINGLE SUPPORT
 STA. 154+04, LT

GRUBBING MATERIAL
 STA. 152+25 TO 152+75, LT

CURVE 61 DATA
 PC = 151+14.55
 PT = 156+37.74
 R = 1620'
 Δ = 18° 30' 14", LT
 D = 3° 32' 12"
 e = 5.9
 L = 523.19'
 SEE SHEET 123

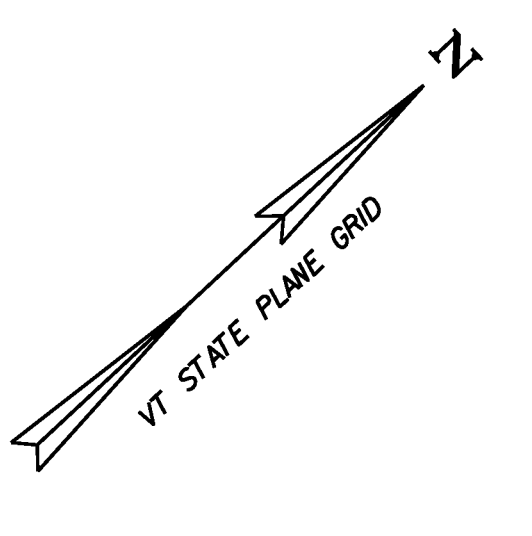
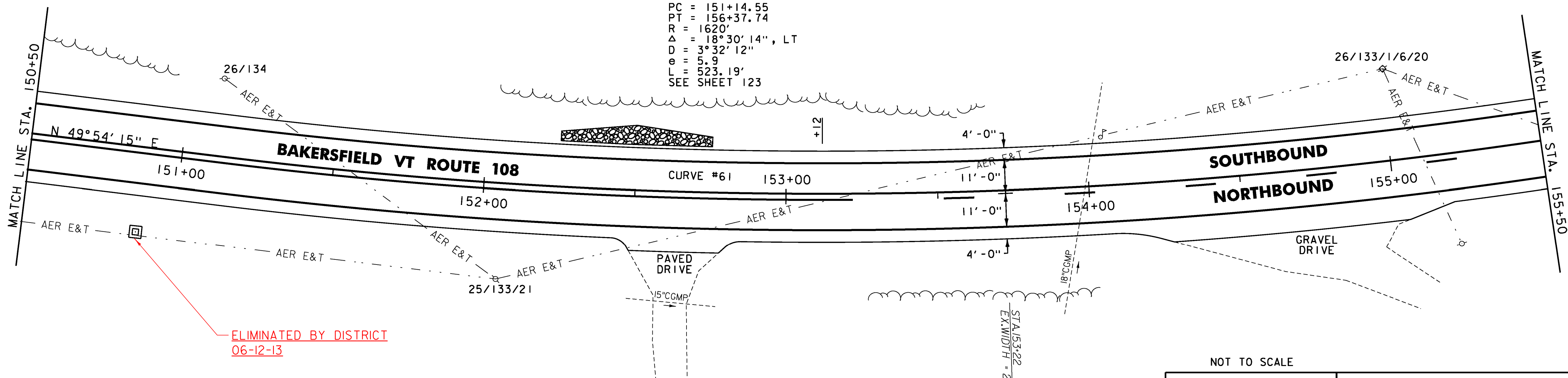

- NOTES:
- FOR LEGENDS, SEE SHEET 27.
 - ALL EXISTING SIGNS NOT SHOWN SHALL BE RETAINED.
 - DURABLE MARKINGS DETAILED ON THIS SHEET ARE OPTION BID ITEMS. SEE SHEET 14.



NOT TO SCALE

PROJECT LAYOUT SHEET #51

PROJECT NAME: CAMBRIDGE-BAKERSFIELD

PROJECT NUMBER: STP 2926(1)

FILE NAME: p10b258.dgn

PROJECT LEADER: JLL

DESIGNED BY: STANTEC

IPARM FILE: p10b258151.1

PLOT DATE: 11/15/2012

DRAWN BY: STANTEC

CHECKED BY: STANTEC

SHEET 77 OF 387