

STONE FILL, TYPE I
 FLETCHER STA. 122+25 TO 123+12.96, LT
 FLETCHER STA. 122+50 TO 123+12.96, RT
 BAKERSFIELD STA. 0+00 TO 0+25, LT
 BAKERSFIELD STA. 0+00 TO 1+00, LT
 BAKERSFIELD STA. 1+00 TO 2+50, RT

ANCHOR FOR STEEL BEAM RAIL
 FLETCHER STA. 121+45.0, LT
 REMOVAL AND DISPOSAL OF GUARDRAIL
 FLETCHER STA. 121+00.0 TO 121+41.0, LT

DURABLE 4 INCH WHITE LINE
 (ALL LINES WILL INCLUDE EDGE LINE BREAKS AND RADII FOR SIDE ROADS)
 FLETCHER STA. 121+00 TO STA. 123+12.96, SOLID LT & RT
 BAKERSFIELD STA. 0+00 TO STA. 2+50, SOLID LT & RT

DURABLE 4 INCH YELLOW LINE
 (ALL LINES WILL INCLUDE ϕ BREAKS FOR SIDE ROADS)
 FLETCHER STA. 121+00 TO STA. 123+12.96, SOLID LT & RT
 BAKERSFIELD STA. 0+00 TO STA. 2+50, SOLID LT & RT

TEMPORARY 4 INCH WHITE LINE, PAINT
 (ALL LINES WILL INCLUDE EDGE LINE BREAKS AND RADII FOR SIDE ROADS)
 FLETCHER STA. 121+00 TO STA. 123+12.96, SOLID LT & RT
 BAKERSFIELD STA. 0+00 TO STA. 2+50, SOLID LT & RT

TEMPORARY 4 INCH YELLOW LINE, PAINT
 (ALL LINES WILL INCLUDE ϕ BREAKS FOR SIDE ROADS)
 FLETCHER STA. 121+00 TO STA. 123+12.96, SOLID LT & RT
 BAKERSFIELD STA. 0+00 TO STA. 2+50, SOLID LT & RT

GEOTEXTILE UNDER STONE FILL
 FLETCHER STA. 122+25 TO 123+12.96, LT
 BAKERSFIELD STA. 0+00 TO 0+25, LT
 BAKERSFIELD STA. 0+75 TO 1+25, LT
 BAKERSFIELD STA. 2+25 TO 2+50, RT

GRUBBING MATERIAL
 FLETCHER STA. 122+25 TO 123+12.96, LT
 BAKERSFIELD STA. 0+00 TO 0+25, LT
 BAKERSFIELD STA. 0+75 TO 1+25, LT
 BAKERSFIELD STA. 2+25 TO 2+50, RT

REMOVING SIGNS
 AS SHOWN - 6

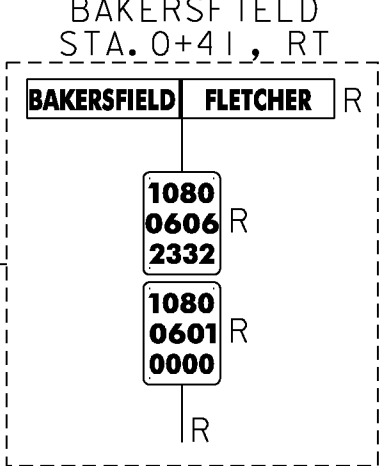
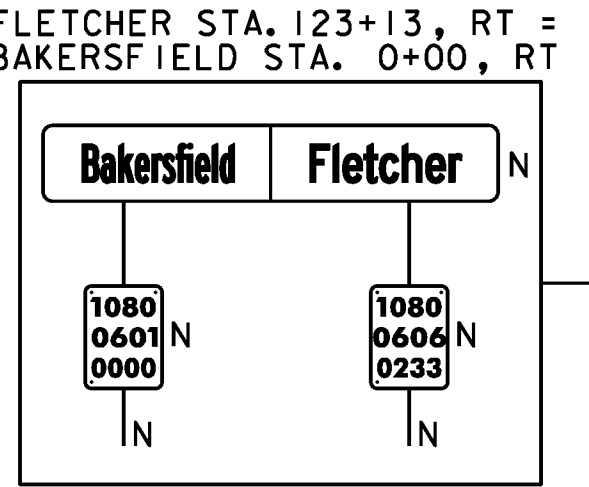
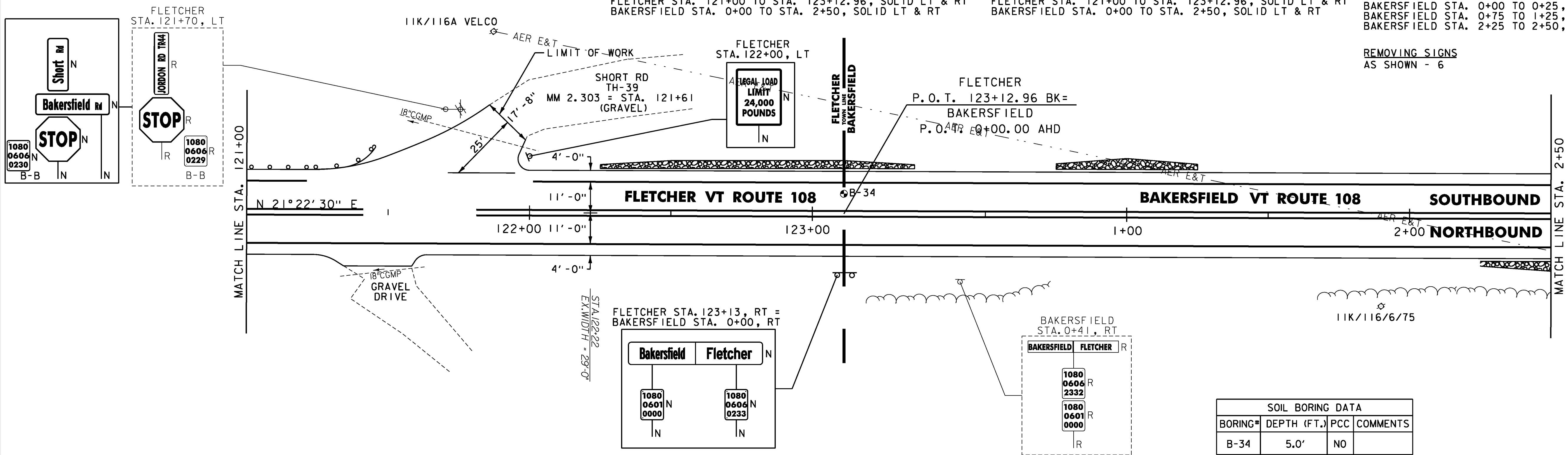
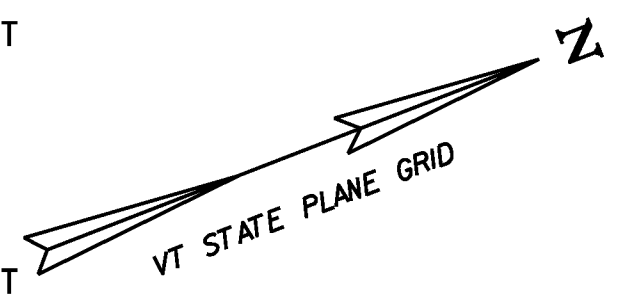

SOIL BORING DATA			
BORING#	DEPTH (FT.)	PCC	COMMENTS
B-34	5.0'	NO	

STONE FILL, TYPE I
 STA. 2+50 TO 2+72, RT
 RELOCATE MAILBOX, SINGLE SUPPORT
 BAKERSFIELD STA. 4+97, RT

DURABLE 4 INCH WHITE LINE
 (ALL LINES WILL INCLUDE EDGE LINE BREAKS AND RADII FOR SIDE ROADS)
 BAKERSFIELD STA. 2+50 TO STA. 7+50, SOLID LT & RT

DURABLE 4 INCH YELLOW LINE
 (ALL LINES WILL INCLUDE ϕ BREAKS FOR SIDE ROADS)
 BAKERSFIELD STA. 2+50 TO STA. 5+28, SOLID LT & RT
 BAKERSFIELD STA. 5+28 TO STA. 7+50, SOLID LT, DASHED RT

TEMPORARY 4 INCH WHITE LINE, PAINT
 (ALL LINES WILL INCLUDE EDGE LINE BREAKS AND RADII FOR SIDE ROADS)
 BAKERSFIELD STA. 2+50 TO STA. 7+50, SOLID LT & RT

TEMPORARY 4 INCH YELLOW LINE, PAINT
 (ALL LINES WILL INCLUDE ϕ BREAKS FOR SIDE ROADS)
 BAKERSFIELD STA. 2+50 TO STA. 5+28, SOLID LT & RT
 BAKERSFIELD STA. 5+28 TO STA. 7+50, SOLID LT, DASHED RT

GEOTEXTILE UNDER STONE FILL
 STA. 2+50 TO 2+75, RT

GRUBBING MATERIAL
 STA. 2+50 TO 2+75, RT

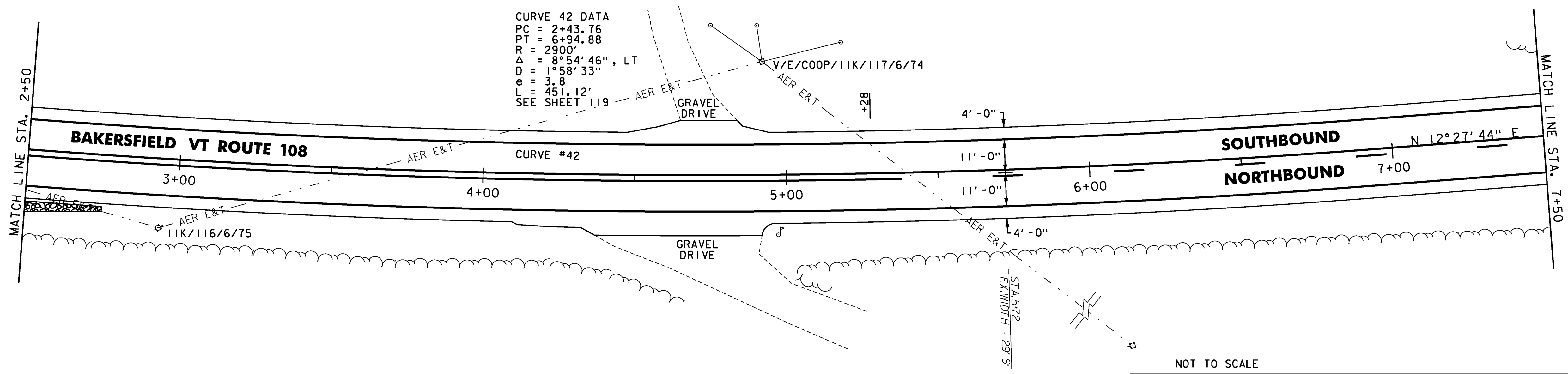
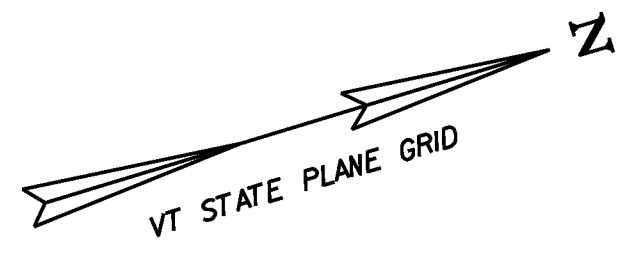

CURVE 42 DATA
 PC = 2+43.76
 PT = 6+94.88
 R = 2900'
 $\Delta = 8^{\circ}54'46''$, LT
 D = 1°58'33"
 e = 3.8
 L = 451.12'
 SEE SHEET 119 — AER E&T

- NOTES:
- FOR LEGENDS, SEE SHEET 27.
 - ALL EXISTING SIGNS NOT SHOWN SHALL BE RETAINED.
 - DURABLE MARKINGS DETAILED ON THIS SHEET ARE OPTION BID ITEMS. SEE SHEET 14.



NOT TO SCALE

PROJECT LAYOUT SHEET #36

PROJECT NAME: CAMBRIDGE-BAKERSFIELD	PLOT DATE: 11/15/2012
PROJECT NUMBER: STP 2926(1)	DRAWN BY: STANTEC
FILE NAME: p10b258.dgn	CHECKED BY: STANTEC
PROJECT LEADER: JLL	SHEET 62 OF 387
DESIGNED BY: STANTEC	
IPARM FILE: p10b258i36.i	