

DURABLE 4 INCH WHITE LINE
 (ALL LINES WILL INCLUDE EDGE LINE BREAKS
 AND RADII FOR SIDE ROADS)
 STA. 81+50 TO 86+50, SOLID LT & RT

DURABLE 4 INCH YELLOW LINE
 (ALL LINES WILL INCLUDE ϕ BREAKS FOR SIDE ROADS)
 STA. 81+50 TO 86+50, SOLID LT & RT

TEMPORARY 4 INCH WHITE LINE, PAINT
 (ALL LINES WILL INCLUDE EDGE LINE BREAKS
 AND RADII FOR SIDE ROADS)
 STA. 81+50 TO 86+50, SOLID LT & RT

TEMPORARY 4 INCH YELLOW LINE, PAINT
 (ALL LINES WILL INCLUDE ϕ BREAKS FOR SIDE ROADS)
 STA. 81+50 TO 86+50, SOLID LT & RT

BARRIER FENCE
 STA. 81+50 TO 86+50, LT
 STA. 84+00 TO 86+50, RT
 (WITH BREAKS FOR DRIVES AND SIDEROADS)

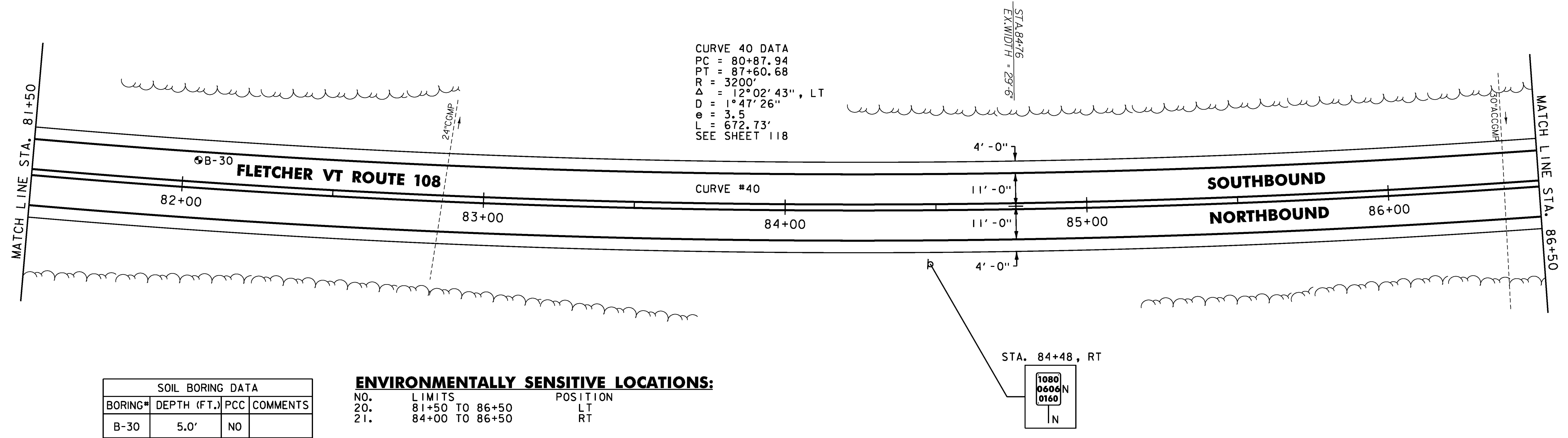
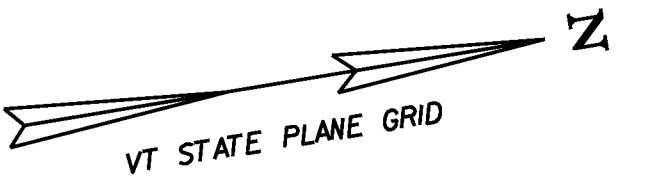

CURVE 40 DATA
 PC = 80+87.94
 PT = 87+60.68
 R = 3200'
 Δ = 12°02'43", LT
 D = 1°47'26"
 e = 3.5
 L = 672.73'
 SEE SHEET 118

SOIL BORING DATA			
BORING#	DEPTH (FT.)	PCC	COMMENTS
B-30	5.0'	NO	

ENVIRONMENTALLY SENSITIVE LOCATIONS:

NO.	LIMITS	POSITION
20.	81+50 TO 86+50	LT
21.	84+00 TO 86+50	RT

DURABLE 4 INCH WHITE LINE
 (ALL LINES WILL INCLUDE EDGE LINE BREAKS
 AND RADII FOR SIDE ROADS)
 STA. 86+50 TO 91+50, SOLID LT & RT

DURABLE 4 INCH YELLOW LINE
 (ALL LINES WILL INCLUDE ϕ BREAKS FOR SIDE ROADS)
 STA. 86+50 TO 87+12, SOLID LT & RT
 STA. 87+12 TO 91+50, SOLID LT, DASHED RT

TEMPORARY 4 INCH WHITE LINE, PAINT
 (ALL LINES WILL INCLUDE EDGE LINE BREAKS
 AND RADII FOR SIDE ROADS)
 STA. 86+50 TO 91+50, SOLID LT & RT

TEMPORARY 4 INCH YELLOW LINE, PAINT
 (ALL LINES WILL INCLUDE ϕ BREAKS FOR SIDE ROADS)
 STA. 86+50 TO 87+12, SOLID LT & RT
 STA. 87+12 TO 91+50, SOLID LT, DASHED RT

BARRIER FENCE
 STA. 86+50 TO 91+50, LT
 STA. 86+50 TO 89+00, RT
 (WITH BREAKS FOR DRIVES AND SIDEROADS)

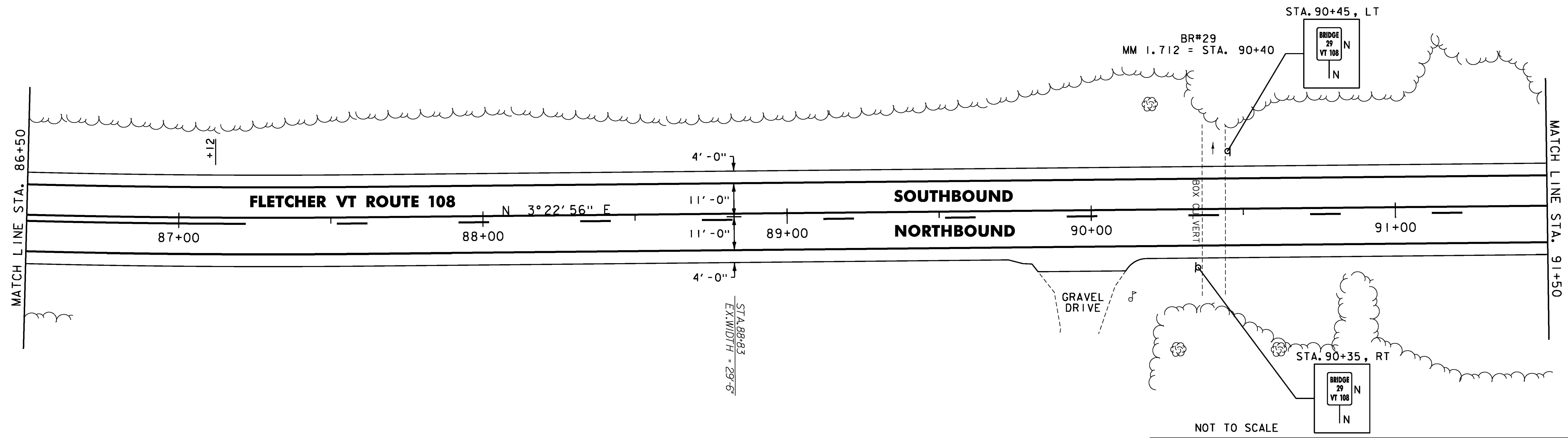
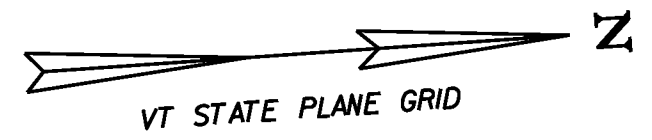

ENVIRONMENTALLY SENSITIVE LOCATIONS:

NO.	LIMITS	POSITION
20.	86+50 TO 91+50	LT
21.	86+50 TO 89+00	RT

NOTES:

- FOR LEGENDS, SEE SHEET 27.
- ALL EXISTING SIGNS NOT SHOWN SHALL BE RETAINED.
- DURABLE MARKINGS DETAILED ON THIS SHEET ARE OPTION BID ITEMS. SEE SHEET 14.



PROJECT LAYOUT SHEET #32

PROJECT NAME: CAMBRIDGE-BAKERSFIELD
 PROJECT NUMBER: STP 2926(I)

FILE NAME: p10b258.dgn
 PROJECT LEADER: JLL
 DESIGNED BY: STANTEC
 IPARM FILE: p10b258i32.i

PLOT DATE: 11/15/2012
 DRAWN BY: STANTEC
 CHECKED BY: STANTEC
 SHEET 58 OF 387