

STONE FILL, TYPE J
 STA. 46+20 TO 46+50, LT
 STA. 46+20 TO 46+50, RT

DURABLE 4 INCH YELLOW LINE
 (ALL LINES WILL INCLUDE $\frac{1}{2}$ BREAKS FOR SIDE ROADS)
 STA. 41+50 TO 46+50, SOLID LT & RT

TEMPORARY 4 INCH WHITE LINE, PAINT
 (ALL LINES WILL INCLUDE EDGE LINE BREAKS
 AND RADII FOR SIDE ROADS)
 STA. 41+50 TO 46+50, SOLID LT & RT

TEMPORARY 4 INCH YELLOW LINE, PAINT
 (ALL LINES WILL INCLUDE $\frac{1}{2}$ BREAKS FOR SIDE ROADS)
 STA. 41+50 TO 46+50, SOLID LT & RT

BARRIER FENCE
 STA. 41+50 TO 43+00, RT
 (WITH BREAKS FOR DRIVES AND SIDEROADS)

REMOVING SIGNS
 AS SHOWN - 2

RELOCATE MAILBOX, SINGLE SUPPORT
 STA. 43+60, RT

DURABLE 4 INCH WHITE LINE
 (ALL LINES WILL INCLUDE EDGE LINE BREAKS
 AND RADII FOR SIDE ROADS)
 STA. 41+50 TO 46+50, SOLID LT & RT

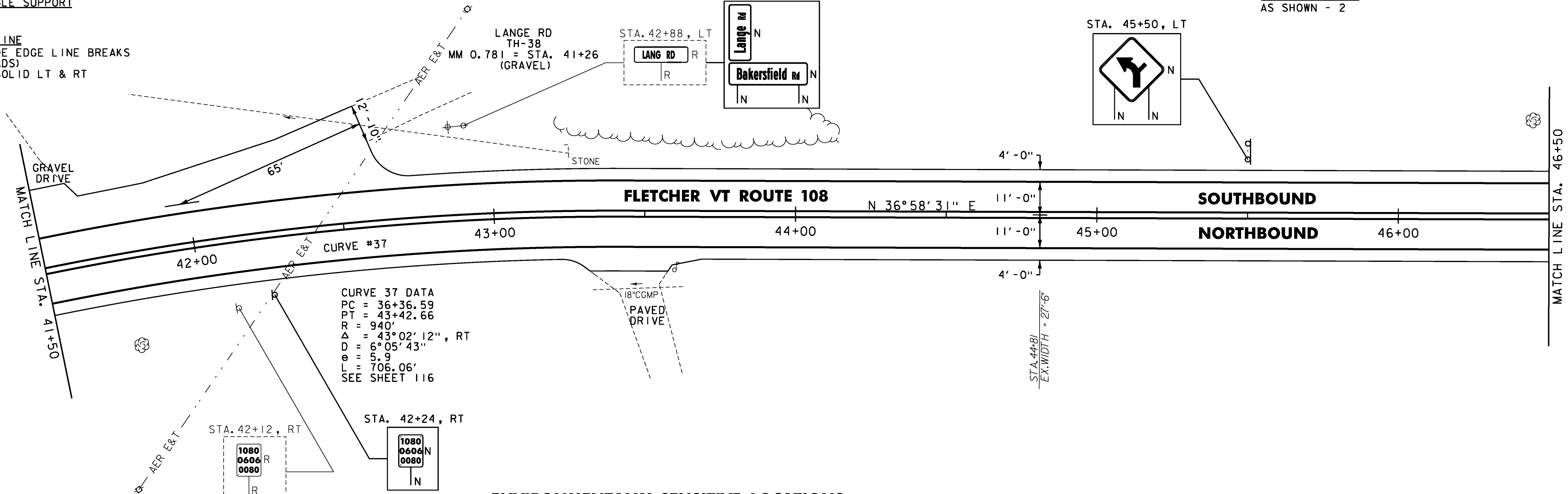

ENVIRONMENTALLY SENSITIVE LOCATIONS:

NO.	LIMITS	POSITION
18.	41+50 TO 43+00	RT

STONE FILL, TYPE J
 STA. 46+50 TO 47+75, LT
 STA. 46+50 TO 48+25, RT

DURABLE 4 INCH WHITE LINE
 (ALL LINES WILL INCLUDE EDGE LINE BREAKS
 AND RADII FOR SIDE ROADS)
 STA. 46+50 TO 51+50, SOLID LT & RT

DURABLE 4 INCH YELLOW LINE
 (ALL LINES WILL INCLUDE $\frac{1}{2}$ BREAKS FOR SIDE ROADS)
 STA. 46+50 TO 51+50, SOLID LT & RT

TEMPORARY 4 INCH WHITE LINE, PAINT
 (ALL LINES WILL INCLUDE EDGE LINE BREAKS
 AND RADII FOR SIDE ROADS)
 STA. 46+50 TO 51+50, SOLID LT & RT

TEMPORARY 4 INCH YELLOW LINE, PAINT
 (ALL LINES WILL INCLUDE $\frac{1}{2}$ BREAKS FOR SIDE ROADS)
 STA. 46+50 TO 51+50, SOLID LT & RT

GEOTEXTILE UNDER STONE FILL
 STA. 47+25 TO 47+75, LT

GRUBBING MATERIAL
 STA. 47+25 TO 47+75, LT

REMOVING SIGNS
 AS SHOWN - 1

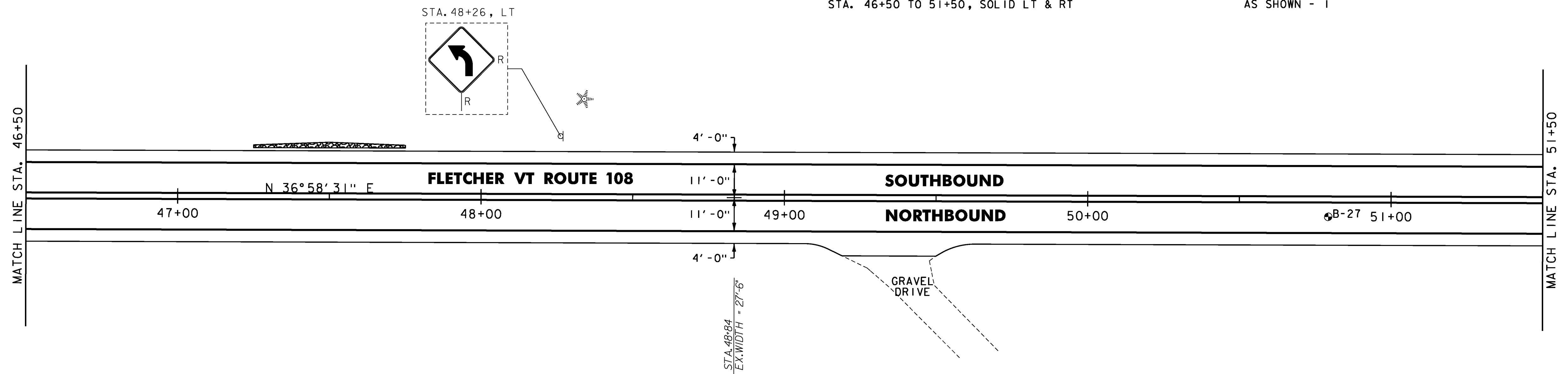

NOTES:

- FOR LEGENDS, SEE SHEET 27.
- ALL EXISTING SIGNS NOT SHOWN SHALL BE RETAINED.
- DURABLE MARKINGS DETAILED ON THIS SHEET ARE OPTION BID ITEMS. SEE SHEET 14.

SOIL BORING DATA			
BORING#	DEPTH (FT.)	PCC	COMMENTS
B-27	5.0'	NO	



NOT TO SCALE

PROJECT LAYOUT SHEET #28

PROJECT NAME: CAMBRIDGE-BAKERSFIELD
 PROJECT NUMBER: STP 2926(I)

FILE NAME: p10b258.dgn
 PROJECT LEADER: JLL
 DESIGNED BY: STANTEC
 IPARM FILE: p10b258I28.i

PLOT DATE: 11/15/2012
 DRAWN BY: STANTEC
 CHECKED BY: STANTEC
 SHEET 54 OF 387