

STONE FILL, TYPE J
 STA. 620+00 TO 623+25, LT
 STA. 622+07 TO 624+25, RT
 STA. 623+75 TO 624+50, LT

RELOCATE MAILBOX, SINGLE SUPPORT
 STA. 621+37, LT
 STA. 621+39, LT
 STA. 623+79, LT

DURABLE 4 INCH WHITE LINE
 (ALL LINES WILL INCLUDE EDGE LINE BREAKS AND RADII FOR SIDE ROADS)
 STA. 620+00 TO 624+50, SOLID LT & RT

DURABLE 4 INCH YELLOW LINE
 (ALL LINES WILL INCLUDE ϕ BREAKS FOR SIDE ROADS)
 STA. 620+00 TO 624+50, SOLID LT & RT
 STA. 621+11, DOUBLE SOLID RT (ROBINSON RD, TH-11)

DURABLE 24 INCH STOP BAR
 STA. 621+11, RT (ROBINSON RD, TH-11)

DURABLE LETTER OR SYMBOL, PAINT
 STA. 621+11, RT (ROBINSON RD, TH-11) "STOP"

TEMPORARY 4 INCH WHITE LINE, PAINT
 (ALL LINES WILL INCLUDE EDGE LINE BREAKS AND RADII FOR SIDE ROADS)
 STA. 620+00 TO 624+50, SOLID LT & RT

TEMPORARY 4 INCH YELLOW LINE, PAINT
 (ALL LINES WILL INCLUDE ϕ BREAKS FOR SIDE ROADS)
 STA. 620+00 TO 624+50, SOLID LT & RT
 STA. 621+11, DOUBLE SOLID RT (ROBINSON RD, TH-11)

TEMPORARY 24 INCH STOP BAR, PAINT
 STA. 621+11, RT (ROBINSON RD, TH-11)

TEMPORARY LETTER OR SYMBOL, PAINT
 STA. 621+11, RT (ROBINSON RD, TH-11) "STOP"

GEOTEXTILE UNDER STONE FILL
 STA. 620+00 TO 623+25, LT
 STA. 622+25 TO 624+25, RT
 STA. 624+25 TO 624+50, LT

GRUBBING MATERIAL
 STA. 620+00 TO 623+25, LT
 STA. 622+25 TO 624+25, RT
 STA. 624+25 TO 624+50, LT

BARRIER FENCE
 STA. 620+00 TO 623+00, LT
 (WITH BREAKS FOR DRIVES AND SIDEROADS)

REMOVING SIGNS
 AS SHOWN - 7

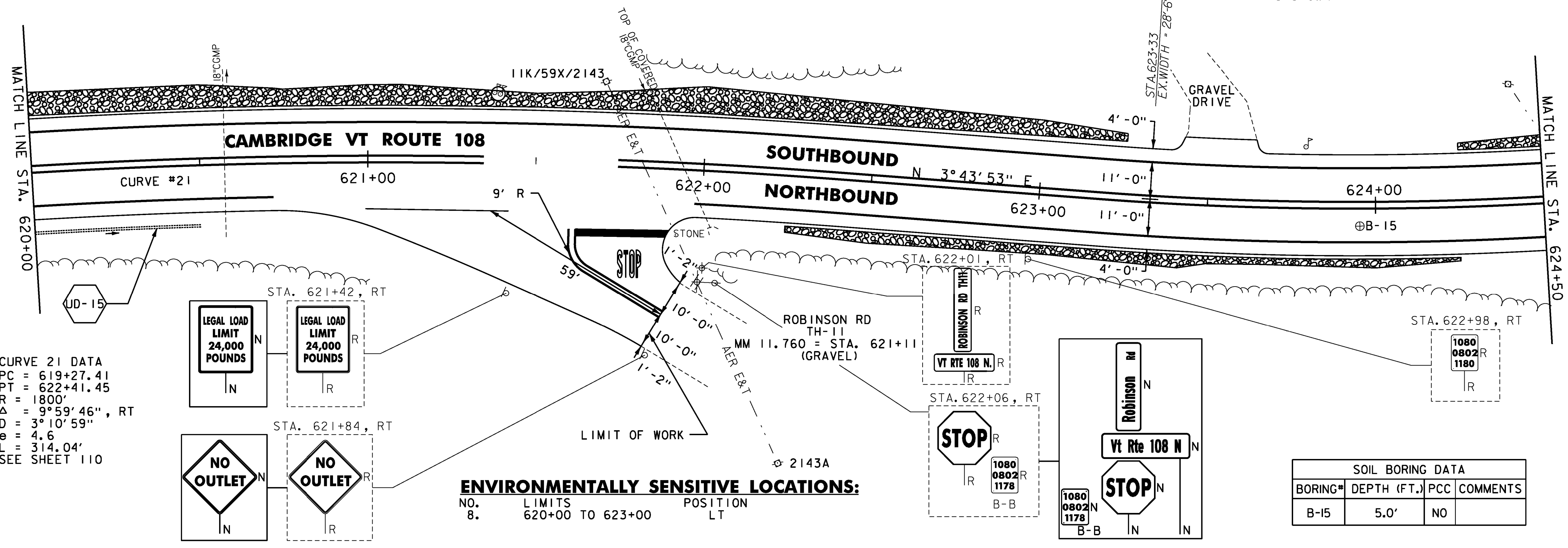
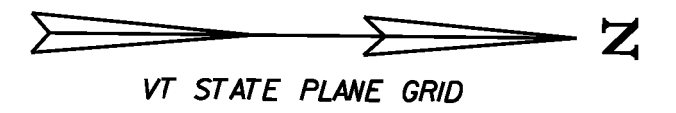

STONE FILL, TYPE J
 STA. 625+75 TO 628+25, RT
 STA. 628+75 TO 629+50, RT OMIT

RELOCATE MAILBOX, SINGLE SUPPORT
 STA. 624+79, LT

DURABLE 4 INCH WHITE LINE
 (ALL LINES WILL INCLUDE EDGE LINE BREAKS AND RADII FOR SIDE ROADS)
 STA. 624+50 TO 629+50, SOLID LT & RT

DURABLE 4 INCH YELLOW LINE
 (ALL LINES WILL INCLUDE ϕ BREAKS FOR SIDE ROADS)
 STA. 624+50 TO 629+50, SOLID LT & RT

TEMPORARY 4 INCH WHITE LINE, PAINT
 (ALL LINES WILL INCLUDE EDGE LINE BREAKS AND RADII FOR SIDE ROADS)
 STA. 624+50 TO 629+50, SOLID LT & RT

TEMPORARY 4 INCH YELLOW LINE, PAINT
 (ALL LINES WILL INCLUDE ϕ BREAKS FOR SIDE ROADS)
 STA. 624+50 TO 629+50, SOLID LT & RT

GEOTEXTILE UNDER STONE FILL
 STA. 625+50 TO 624+75, LT
 STA. 625+75 TO 627+75, RT

GRUBBING MATERIAL
 STA. 625+50 TO 624+75, LT
 STA. 625+75 TO 627+75, RT

BARRIER FENCE
 STA. 624+50 TO 629+50, LT
 STA. 626+00 TO 628+00, RT
 (WITH BREAKS FOR DRIVES AND SIDEROADS)

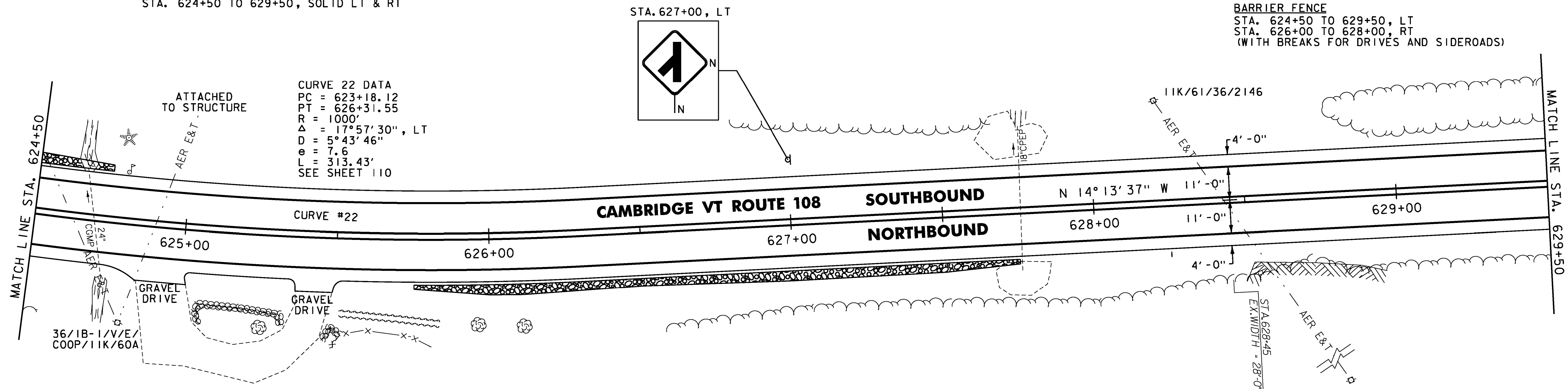
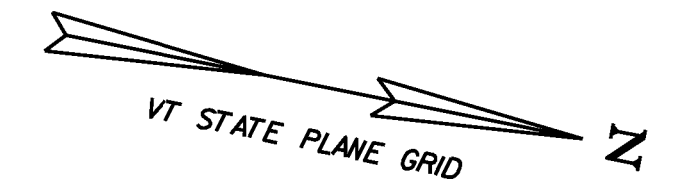

ENVIRONMENTALLY SENSITIVE LOCATIONS:

NO.	LIMITS	POSITION
9.	624+50 TO 629+50	LT
10.	626+00 TO 628+00	RT

NOTES:

- FOR LEGENDS, SEE SHEET 27.
- ALL EXISTING SIGNS NOT SHOWN SHALL BE RETAINED.
- DURABLE MARKINGS DETAILED ON THIS SHEET ARE OPTION BID ITEMS. SEE SHEET 14.



NOT TO SCALE

PROJECT LAYOUT SHEET #15

PROJECT NAME: CAMBRIDGE-BAKERSFIELD

PROJECT NUMBER: STP 2926(1)

FILE NAME: p10b258.dgn

PROJECT LEADER: JLL

DESIGNED BY: STANTEC

IPARM FILE: p10b258i15.i

PLOT DATE: 11/15/2012

DRAWN BY: STANTEC

CHECKED BY: STANTEC

SHEET 41 OF 387