

STONE FILL, TYPE I
 STA. 561+50 TO 562+25, LT
 STA. 561+50 TO 563+25, RT
 STA. 562+79 TO 563+00, LT
 STA. 566+25 TO 566+50, LT

ANCHOR FOR STEEL BEAM RAIL
 STA. 566+10, LT
 REMOVAL AND DISPOSAL OF GUARDRAIL
 STA. 566+14 TO 566+50, LT

DURABLE 4 INCH WHITE LINE
 (ALL LINES WILL INCLUDE EDGE LINE BREAKS
 AND RADII FOR SIDE ROADS)
 STA. 561+50 TO 566+50, SOLID LT & RT

TEMPORARY 4 INCH WHITE LINE, PAINT
 (ALL LINES WILL INCLUDE EDGE LINE BREAKS
 AND RADII FOR SIDE ROADS)
 STA. 561+50 TO 566+50, SOLID LT & RT

GEOTEXTILE UNDER STONE FILL
 STA. 561+50 TO 562+75, RT
 STA. 561+75 TO 562+25, LT
 STA. 562+75 TO 563+25, LT
 STA. 566+25 TO 566+50, LT

RELOCATE MAILBOX, SINGLE SUPPORT
 STA. 562+37, LT
 STA. 565+94, LT

DURABLE 4 INCH YELLOW LINE
 (ALL LINES WILL INCLUDE ϕ BREAKS FOR SIDE ROADS)
 STA. 561+50 TO 566+50, SOLID LT & RT

TEMPORARY 4 INCH YELLOW LINE, PAINT
 (ALL LINES WILL INCLUDE ϕ BREAKS FOR SIDE ROADS)
 STA. 561+50 TO 566+50, SOLID LT & RT

GRUBBING MATERIAL
 STA. 561+50 TO 562+75, RT
 STA. 561+75 TO 562+25, LT
 STA. 562+75 TO 563+25, LT
 STA. 566+25 TO 566+50, LT

STEEL BEAM GUARDRAIL, GALVANIZED
 W/8 FEET POSTS
 STA. 566+10 TO 566+50, LT

UD-11 STA 563+00 TO 566+00, RT
 CONSTRUCT 6 INCH UNDERDRAIN PIPE,
 SEE SHEET 18 FOR DETAIL AND
 ASSOCIATED QUANTITIES.

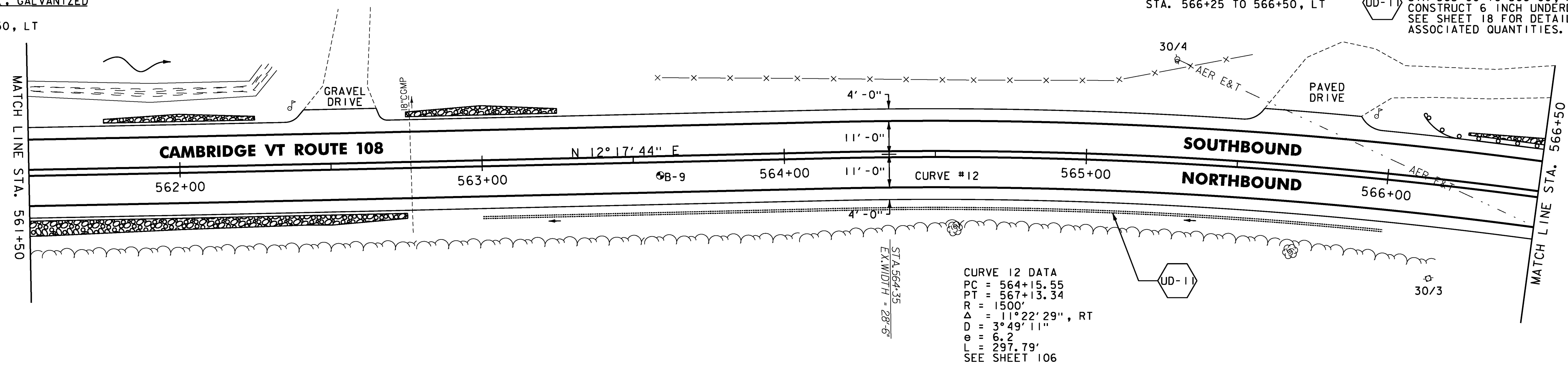

CURVE 12 DATA
 PC = 564+15.55
 PT = 567+13.34
 R = 1500'
 Δ = 11° 22' 29", RT
 D = 3° 49' 11"
 e = 6.2
 L = 297.79'
 SEE SHEET 106

SOIL BORING DATA			
BORING #	DEPTH (FT.)	PCC	COMMENTS
B-9	5.0'	NO	

STONE FILL, TYPE I
 STA. 566+50 TO 567+60, LT
 STEEL BEAM GUARDRAIL, GALVANIZED W/8 FEET POSTS
 STA. 566+50 TO 568+47.5, LT

DURABLE 4 INCH WHITE LINE
 (ALL LINES WILL INCLUDE EDGE LINE BREAKS
 AND RADII FOR SIDE ROADS)
 STA. 566+50 TO 571+50, SOLID LT & RT

TEMPORARY 4 INCH WHITE LINE, PAINT
 (ALL LINES WILL INCLUDE EDGE LINE BREAKS
 AND RADII FOR SIDE ROADS)
 STA. 566+50 TO 571+50, SOLID LT & RT

GEOTEXTILE UNDER STONE FILL
 STA. 566+50 TO 567+75, LT

BARRIER FENCE
 STA. 567+00 TO 570+00, LT
 (WITH BREAKS FOR DRIVES AND SIDEROADS)

ANCHOR FOR STEEL BEAM RAIL
 STA. 568+47.5, LT

DURABLE 4 INCH YELLOW LINE
 (ALL LINES WILL INCLUDE ϕ BREAKS FOR SIDE ROADS)
 STA. 566+50 TO 571+50, SOLID LT & RT

TEMPORARY 4 INCH YELLOW LINE, PAINT
 (ALL LINES WILL INCLUDE ϕ BREAKS FOR SIDE ROADS)
 STA. 566+50 TO 571+50, SOLID LT & RT

GRUBBING MATERIAL
 STA. 566+50 TO 567+75, LT

REMOVING SIGNS
 AS SHOWN - 1

REMOVAL AND DISPOSAL OF GUARDRAIL
 STA. 566+50 TO 568+48, LT
 STA. 569+14 TO 571+50, LT

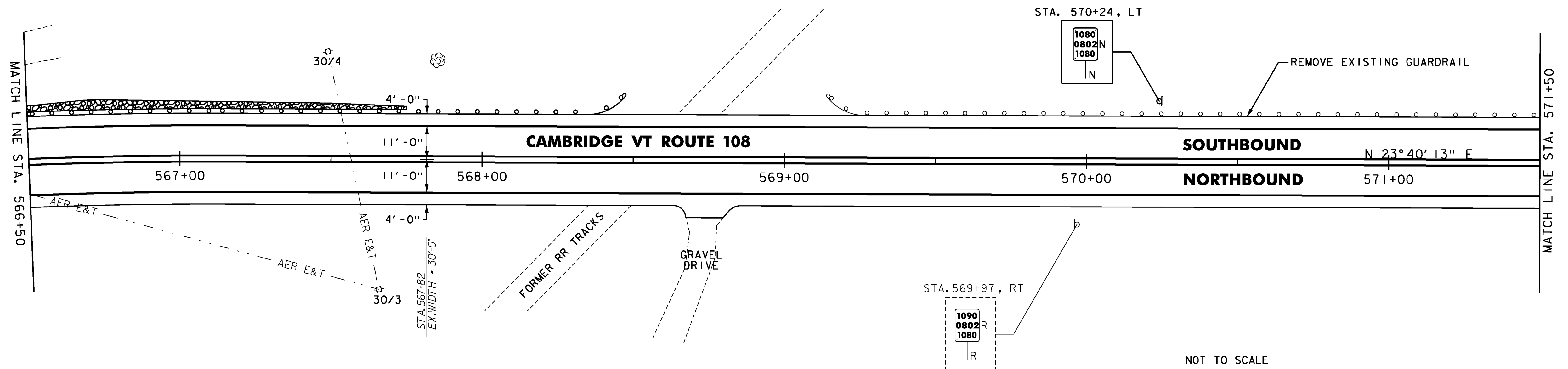

ENVIRONMENTALLY SENSITIVE LOCATIONS:

NO.	LIMITS	POSITION
4.	567+00 TO 570+00	LT

NOTES:

- FOR LEGENDS, SEE SHEET 27.
- ALL EXISTING SIGNS NOT SHOWN SHALL BE RETAINED.
- DURABLE MARKINGS DETAILED ON THIS SHEET ARE OPTION BID ITEMS. SEE SHEET 14.



NOT TO SCALE

PROJECT LAYOUT SHEET #9

PROJECT NAME: CAMBRIDGE-BAKERSFIELD
 PROJECT NUMBER: STP 2926(1)

FILE NAME: p10b258.dgn
 PROJECT LEADER: JLL
 DESIGNED BY: STANTEC
 IPARM FILE: p10b258109.i

PLOT DATE: 11/15/2012
 DRAWN BY: STANTEC
 CHECKED BY: STANTEC
 SHEET 35 OF 387