

STONE FILL, TYPE I
 STA. 551+75 TO 555+25, LT
 STA. 554+13 TO 554+40, RT

DURABLE 4 INCH WHITE LINE
 (ALL LINES WILL INCLUDE EDGE LINE BREAKS
 AND RADII FOR SIDE ROADS)
 STA. 551+50 TO 556+50, SOLID LT & RT

TEMPORARY 4 INCH WHITE LINE, PAINT
 (ALL LINES WILL INCLUDE EDGE LINE BREAKS
 AND RADII FOR SIDE ROADS)
 STA. 551+50 TO 556+50, SOLID LT & RT

GEOTEXTILE UNDER STONE FILL
 STA. 551+75 TO 555+25, LT
GRUBBING MATERIAL
 STA. 551+75 TO 555+25, LT

UD-8 STA. 554+08, LT TO 556+50, RT
 CONSTRUCT 6 INCH UNDERDRAIN PIPE,
 SEE SHEET 18 FOR DETAIL AND
 ASSOCIATED QUANTITIES.

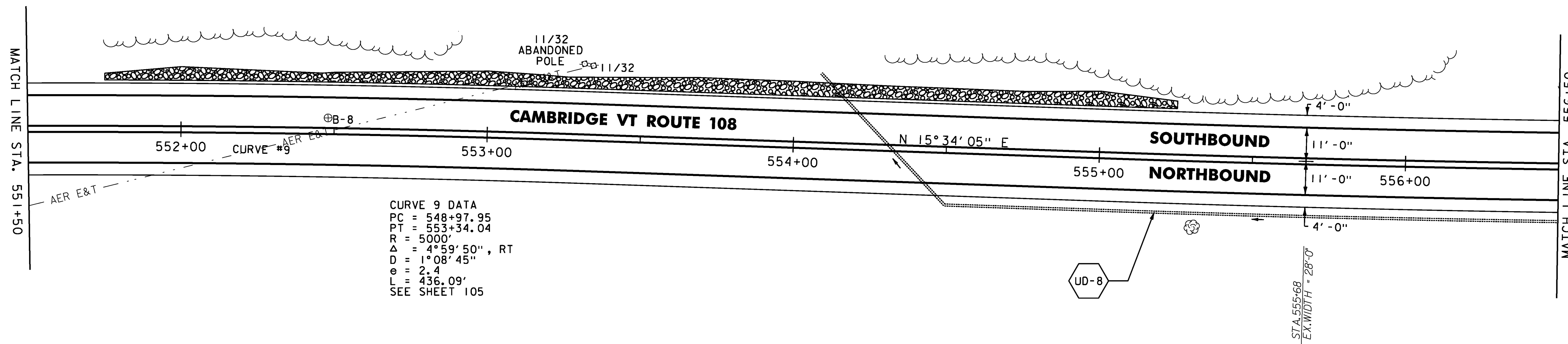
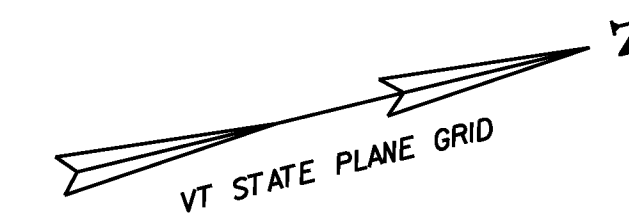

CURVE 9 DATA
 PC = 548+97.95
 PT = 553+34.04
 R = 5000'
 $\Delta = 4^{\circ}59'50''$, RT
 D = $1^{\circ}08'45''$
 e = 2.4
 L = 436.09'
 SEE SHEET 105

SOIL BORING DATA			
BORING#	DEPTH (FT.)	PCC	COMMENTS
B-8	5.0'	NO	

STONE FILL, TYPE I
 STA. 558+33 TO 558+79, LT
 STA. 560+67 TO 561+50, LT
 STA. 561+25 TO 561+50, RT

DURABLE 4 INCH WHITE LINE
 (ALL LINES WILL INCLUDE EDGE LINE BREAKS
 AND RADII FOR SIDE ROADS)
 STA. 556+50 TO 561+50, SOLID LT & RT

TEMPORARY 4 INCH WHITE LINE, PAINT
 (ALL LINES WILL INCLUDE EDGE LINE BREAKS
 AND RADII FOR SIDE ROADS)
 STA. 556+50 TO 561+50, SOLID LT & RT

GEOTEXTILE UNDER STONE FILL
 STA. 558+25 TO 558+75, LT
 STA. 560+75 TO 561+25, LT
 STA. 561+25 TO 561+50, RT

UD-9 STA. 557+00 TO 558+50, RT
 CONSTRUCT 6 INCH UNDERDRAIN PIPE,
 SEE SHEET 18 FOR DETAIL AND
 ASSOCIATED QUANTITIES.

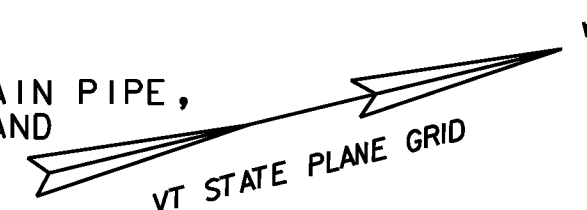

RELOCATE MAILBOX, SINGLE SUPPORT
 STA. 557+02, LT
 STA. 557+03, LT

DURABLE 4 INCH YELLOW LINE
 (ALL LINES WILL INCLUDE ϕ BREAKS FOR SIDE ROADS)
 STA. 556+50 TO 561+50, SOLID LT & RT

TEMPORARY 4 INCH YELLOW LINE, PAINT
 (ALL LINES WILL INCLUDE ϕ BREAKS FOR SIDE ROADS)
 STA. 556+50 TO 561+50, SOLID LT & RT

GRUBBING MATERIAL
 STA. 558+25 TO 558+75, LT
 STA. 560+75 TO 561+25, LT
 STA. 561+25 TO 561+50, RT

UD-10 STA. 559+50 TO 561+50, RT
 CONSTRUCT 6 INCH UNDERDRAIN PIPE,
 SEE SHEET 18 FOR DETAIL AND
 ASSOCIATED QUANTITIES.

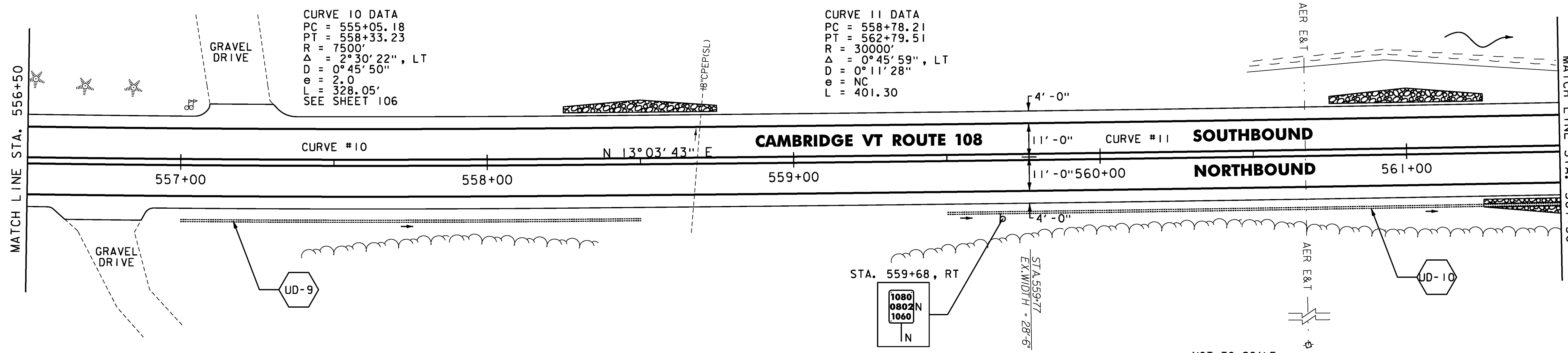

CURVE 10 DATA
 PC = 555+05.18
 PT = 558+33.23
 R = 7500'
 $\Delta = 2^{\circ}30'22''$, LT
 D = $0^{\circ}45'50''$
 e = 2.0
 L = 328.05'
 SEE SHEET 106

CURVE 11 DATA
 PC = 558+78.21
 PT = 562+79.51
 R = 30000'
 $\Delta = 0^{\circ}45'59''$, LT
 D = $0^{\circ}11'28''$
 e = NC
 L = 401.30

NOT TO SCALE

NOTES:

- FOR LEGENDS, SEE SHEET 27.
- ALL EXISTING SIGNS NOT SHOWN SHALL BE RETAINED.
- DURABLE MARKINGS DETAILED ON THIS SHEET ARE OPTION BID ITEMS. SEE SHEET 14.



PROJECT LAYOUT SHEET #8

PROJECT NAME: CAMBRIDGE-BAKERSFIELD
 PROJECT NUMBER: STP 2926(I)

FILE NAME: p10b258.dgn
 PROJECT LEADER: JLL
 DESIGNED BY: STANTEC
 IPARM FILE: p10b258108.i

PLOT DATE: 11/15/2012
 DRAWN BY: STANTEC
 CHECKED BY: STANTEC
 SHEET 34 OF 387