

STONE FILL, TYPE I
 STA. 523+00 TO 523+50, RT
 STA. 524+50 TO 527+13, RT

RELOCATE MAILBOX, SINGLE SUPPORT
 STA. 523+79, LT
 STA. 527+12, LT

DURABLE 4 INCH WHITE LINE
 (ALL LINES WILL INCLUDE EDGE LINE BREAKS
 AND RADII FOR SIDE ROADS)
 STA. 523+00 TO 527+50, SOLID LT & RT

DURABLE 4 INCH YELLOW LINE
 (ALL LINES WILL INCLUDE ϕ BREAKS FOR SIDE ROADS)
 STA. 523+00 TO 527+50, SOLID LT & RT

TEMPORARY 4 INCH WHITE LINE, PAINT
 (ALL LINES WILL INCLUDE EDGE LINE BREAKS
 AND RADII FOR SIDE ROADS)
 STA. 523+00 TO 527+50, SOLID LT & RT

TEMPORARY 4 INCH YELLOW LINE, PAINT
 (ALL LINES WILL INCLUDE ϕ BREAKS FOR SIDE ROADS)
 STA. 523+00 TO 527+50, SOLID LT & RT

GEOTEXTILE UNDER STONE FILL
 STA. 523+00 TO 523+50, RT
 STA. 524+25 TO 526+75, RT

GRUBBING MATERIAL
 STA. 523+00 TO 523+50, RT
 STA. 524+25 TO 526+75, RT

REMOVING SIGNS
 AS SHOWN - 4

CURVE 6 DATA
 PC = 523+36.40
 PT = 525+69.62
 R = 2000'
 Δ = 6°40'53", LT
 D = 2°51'53"
 e = 5.1
 L = 233.22'
 SEE SHEET 104

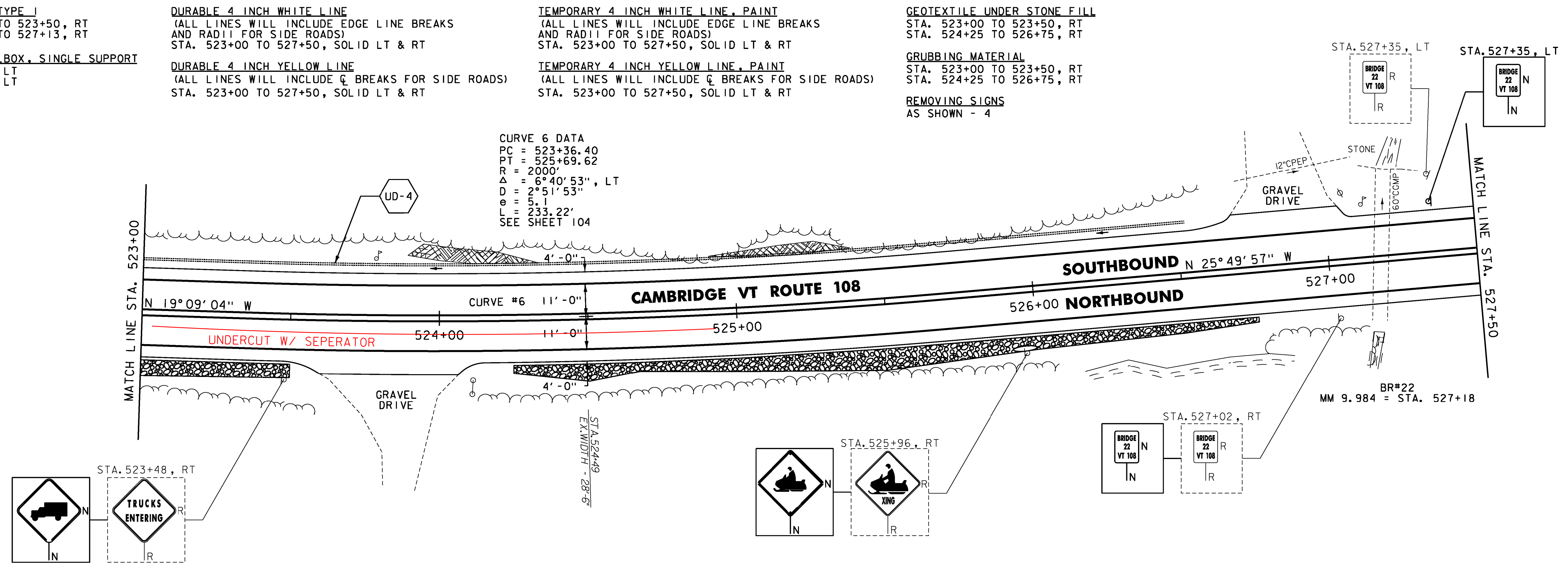

STONE FILL, TYPE I
 STA. 531+75 TO 532+00, LT

DURABLE 4 INCH WHITE LINE
 (ALL LINES WILL INCLUDE EDGE LINE BREAKS
 AND RADII FOR SIDE ROADS)
 STA. 527+50 TO 532+00, SOLID LT & RT

DURABLE 4 INCH YELLOW LINE
 (ALL LINES WILL INCLUDE ϕ BREAKS FOR SIDE ROADS)
 STA. 527+50 TO 532+00, SOLID LT & RT

TEMPORARY 4 INCH WHITE LINE, PAINT
 (ALL LINES WILL INCLUDE EDGE LINE BREAKS
 AND RADII FOR SIDE ROADS)
 STA. 527+50 TO 532+00, SOLID LT & RT

TEMPORARY 4 INCH YELLOW LINE, PAINT
 (ALL LINES WILL INCLUDE ϕ BREAKS FOR SIDE ROADS)
 STA. 527+50 TO 532+00, SOLID LT & RT

GEOTEXTILE UNDER STONE FILL
 STA. 531+75 TO 532+00, LT

GRUBBING MATERIAL
 STA. 531+75 TO 532+00, LT

REMOVING SIGNS
 AS SHOWN - 1

UD-5 STA 529+50 TO 531+25, RT
 CONSTRUCT 6 INCH UNDERDRAIN PIPE,
 SEE SHEET 18 FOR DETAIL AND
 ASSOCIATED QUANTITIES.

CURVE 7 DATA
 PC = 527+52.83
 PT = 532+31.60
 R = 660'
 Δ = 41°33'46", RT
 D = 8°40'52"
 e = 6.0
 L = 478.77'
 SEE SHEET 104

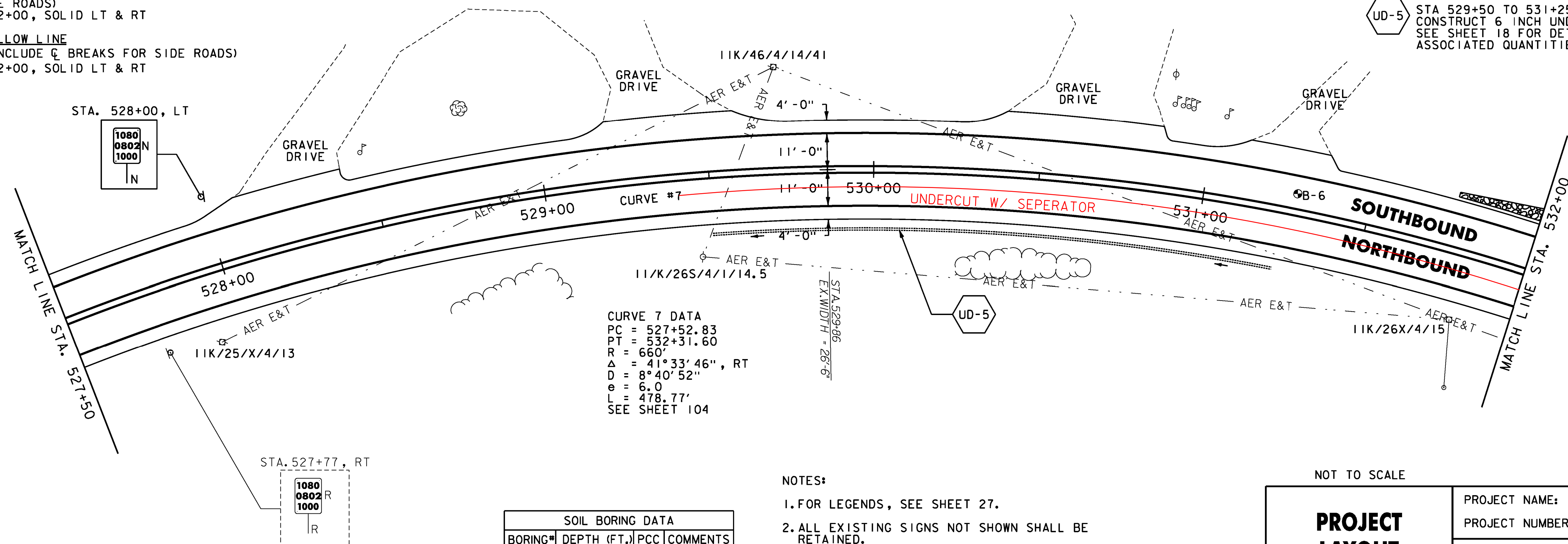

NOTES:

- FOR LEGENDS, SEE SHEET 27.
- ALL EXISTING SIGNS NOT SHOWN SHALL BE RETAINED.
- DURABLE MARKINGS DETAILED ON THIS SHEET ARE OPTION BID ITEMS. SEE SHEET 14.

| SOIL BORING DATA | | | |
|------------------|-------------|-----|----------|
| BORING# | DEPTH (FT.) | PCC | COMMENTS |
| B-6 | 5.0' | NO | |

NOT TO SCALE

PROJECT LAYOUT SHEET #5



PROJECT NAME: CAMBRIDGE-BAKERSFIELD

PROJECT NUMBER: STP 2926(I)

FILE NAME: pl0b258.dgn

PROJECT LEADER: JLL

DESIGNED BY: STANTEC

IPARM FILE: p10b258105.i

PLOT DATE: 11/15/2012

DRAWN BY: STANTEC

CHECKED BY: STANTEC

SHEET 31 OF 387