

TEMPORARY 4 INCH WHITE LINE, PAINT  
DURABLE 4 INCH WHITE LINE

B36+00 TO B38+50 SOLID LT  
B36+00 TO B37+47 SOLID RT  
B37+47 TO B37+57 SOLID RT (TH 71)  
B37+89 TO B38+02 SOLID RT (TH 71)  
B38+02 TO B38+41 SOLID RT  
B38+41 TO B38+44 SOLID RT (TH 71)  
B38+52 TO B39+60 SOLID RT (TH 71)  
B39+30 TO B41+50 SOLID LT  
B39+60 TO B41+50 SOLID RT

TEMPORARY 4 INCH YELLOW LINE, PAINT  
DURABLE 4 INCH YELLOW LINE

B36+00 TO B37+50 SOLID LT & RT  
B37+69 TO B37+72 DOUBLE SOLID RT (TH 71)  
B37+90 TO B38+70 SOLID LT & RT  
B38+48 TO B38+92 DOUBLE SOLID RT (TH 71)  
B39+10 TO B41+50 SOLID LT & RT

TEMPORARY 12 INCH WHITE LINE, PAINT  
DURABLE 12 INCH WHITE LINE

B38+85 LT (2 LINES) (TH 65) (FOR X-WALK)

TEMPORARY 24 INCH STOP BAR, PAINT  
DURABLE 24 INCH STOP BAR

B37+69 TO B37+82 RT (TH 71)  
B38+93 TO B39+18 RT (TH 71)

TEMPORARY LETTER OR SYMBOL, PAINT  
DURABLE LETTER OR SYMBOL

B37+76 RT - "STOP" (TH 71)  
B38+95 RT - "STOP" (TH 71)

REHAB. DROP  
INLETS, CATCH BASINS, OR MANHOLES,  
CLASS I OR CLASS II

B38+69 LT (DI)  
B41+36 RT (DI)

CHANGING ELEVATION  
OF SEWER MANHOLES (NON-PART.)

B36+06 RT  
B38+90 LT  
B39+20 RT

ADJUST ELEVATION OF  
VALVE BOX (NON-PART.)  
B37+65 RT (TH 71)

BITUMINOUS CONCRETE  
GUTTERS AND TRAFFIC ISLANDS

B37+26 TO B38+72 LT  
B37+38 TO B37+59 RT

DETECTABLE  
WARNING SURFACE (DWS)

B38+77 LT  
B38+93 LT

PORTLAND CEMENT  
CONCRETE SIDEWALK, 5 INCH

B38+72 TO B38+77 LT (LEVEL LANDING)  
B38+93 TO B38+98 LT (LEVEL LANDING)

REMOVING SIGNS  
AS SHOWN - 16

ERECTING SALVAGED SIGNS  
AS SHOWN - 2

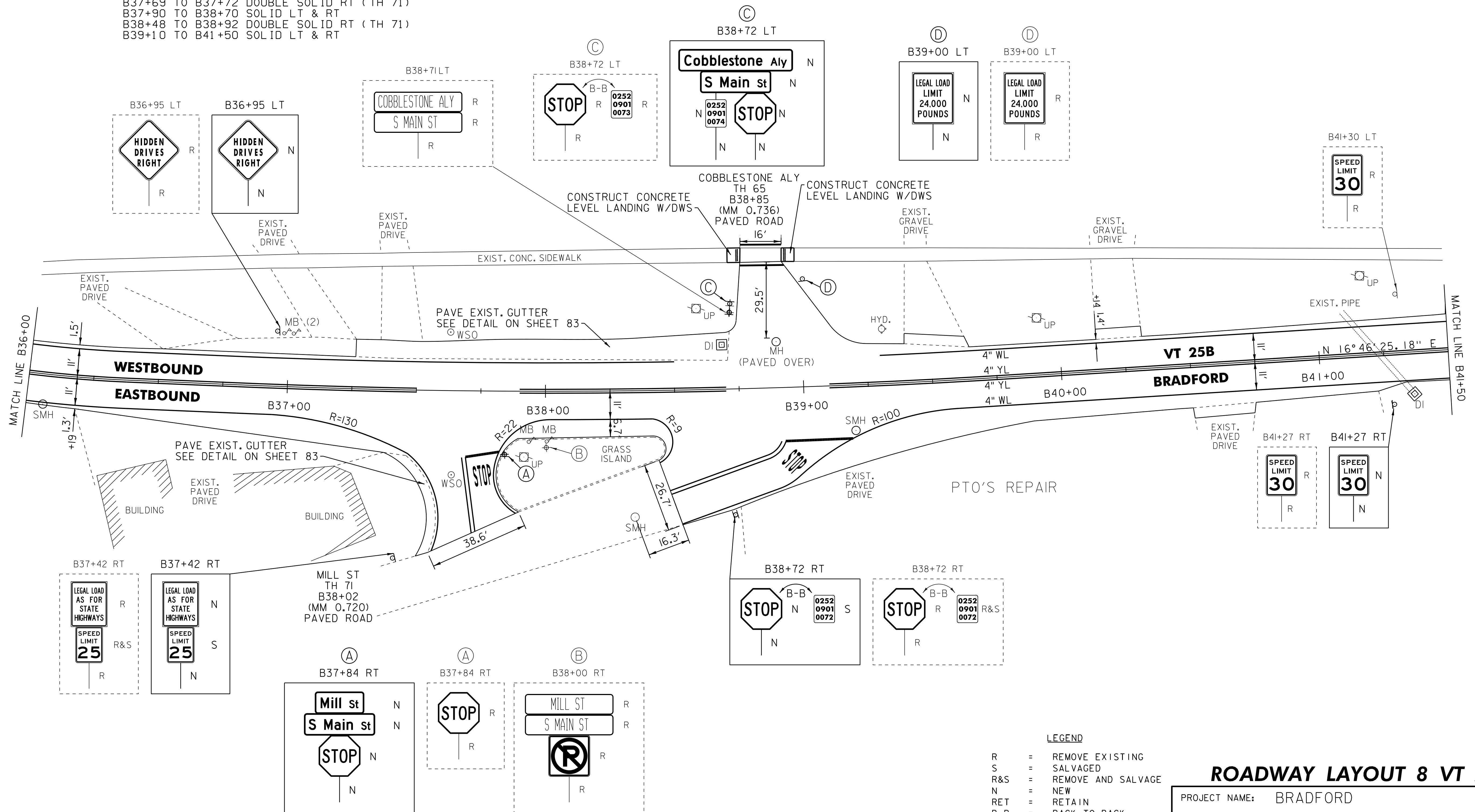

LEGEND

- R = REMOVE EXISTING
- S = SALVAGED
- R&S = REMOVE AND SALVAGE
- N = NEW
- RET = RETAIN
- B-B = BACK TO BACK
- = EXISTING GUARDRAIL
- = PROPOSED GUARDRAIL
- YL = YELLOW LINE
- WL = WHITE LINE
- = DELINEATOR
- = PAVEMENT CORE

ROADWAY LAYOUT 8 VT 25B

PROJECT NAME: BRADFORD	PLOT DATE: 03-SEP-2014 12:51
PROJECT NUMBER: STP 2918(I)	DRAWN BY: SNG
FILE NAME: p10b236.dgn	CHECKED BY: PTS
PROJECT LEADER: PTS	SHEET 95 OF 105
DESIGNED BY: NLL	
IPARM FILE NAME: p10c238_95	

NOT TO SCALE