

TEMPORARY 4 INCH WHITE LINE, PAINT
 DURABLE 4 INCH WHITE LINE
 275+50 TO 286+50 SOLID LT & RT
 TEMPORARY 4 INCH YELLOW LINE, PAINT
 DURABLE 4 INCH YELLOW LINE
 275+50 TO 286+50 SOLID LT & RT

STEEL BEAM GUARDRAIL, GALVANIZED W/8 FEET POSTS
 278+16 TO 286+50 LT
 ANCHOR FOR STEEL BEAM RAIL
 278+16 LT

REMOVAL AND DISPOSAL OF GUARDRAIL
 278+16 TO 286+50 LT
 DELINEATOR WITH STEEL POST
 278+16 LT

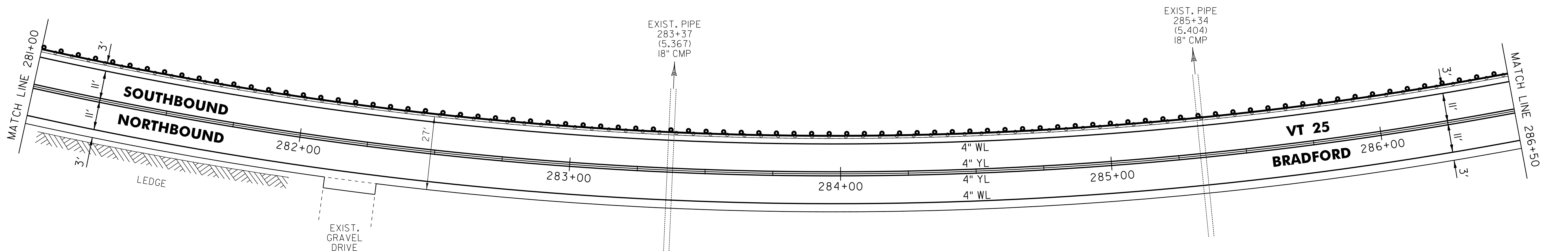
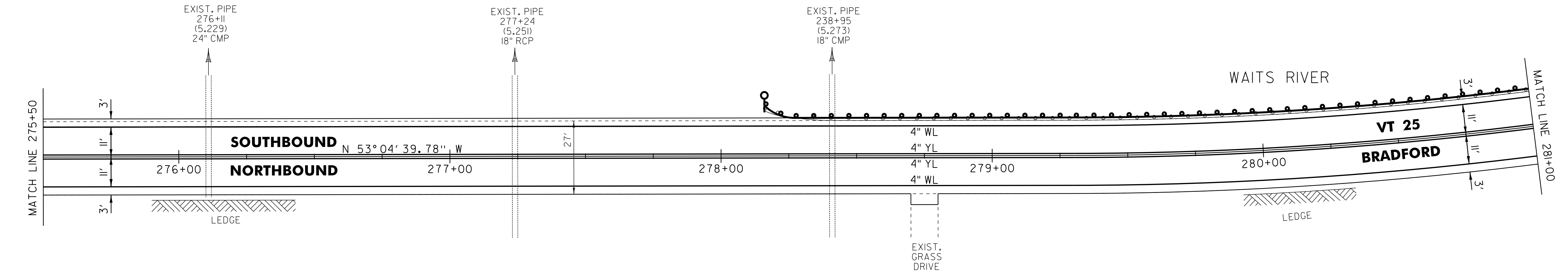

LEGEND

- R = REMOVE EXISTING
- S = SALVAGED
- R&S = REMOVE AND SALVAGE
- N = NEW
- RET = RETAIN
- B-B = BACK TO BACK
- = EXISTING GUARDRAIL
- = PROPOSED GUARDRAIL
- YL = YELLOW LINE
- WL = WHITE LINE
- = DELINEATOR
- ||||||| = RUMBLE STRIP

ROADWAY LAYOUT 32 VT 25

PROJECT NAME: BRADFORD	PLOT DATE: 03-SEP-2014 12:51
PROJECT NUMBER: STP 2917(I)	DRAWN BY: SNG
FILE NAME: p10b236.dgn	CHECKED BY: PTS
PROJECT LEADER: PTS	SHEET 73 OF 105
DESIGNED BY: NULL	
IPARM FILE NAME: p10b236_73	

NOT TO SCALE