

TEMPORARY 4 INCH WHITE LINE, PAINT
 DURABLE 4 INCH WHITE LINE
 223+00 TO 233+00 SOLID LT & RT

TEMPORARY 4 INCH YELLOW LINE, PAINT
 DURABLE 4 INCH YELLOW LINE
 223+00 TO 233+00 SOLID LT & RT

STEEL BEAM GUARDRAIL, GALVANIZED
 227+57.5 TO 229+45 LT

STEEL BEAM GUARDRAIL, GALVANIZED W/8 FEET POSTS
 225+70 TO 227+57.5 LT

ANCHOR FOR STEEL BEAM RAIL
 225+70 LT
 229+45 LT

REMOVAL AND DISPOSAL OF GUARDRAIL
 225+67 TO 229+47 LT

DELINEATOR WITH STEEL POST
 225+70 LT
 229+45 LT

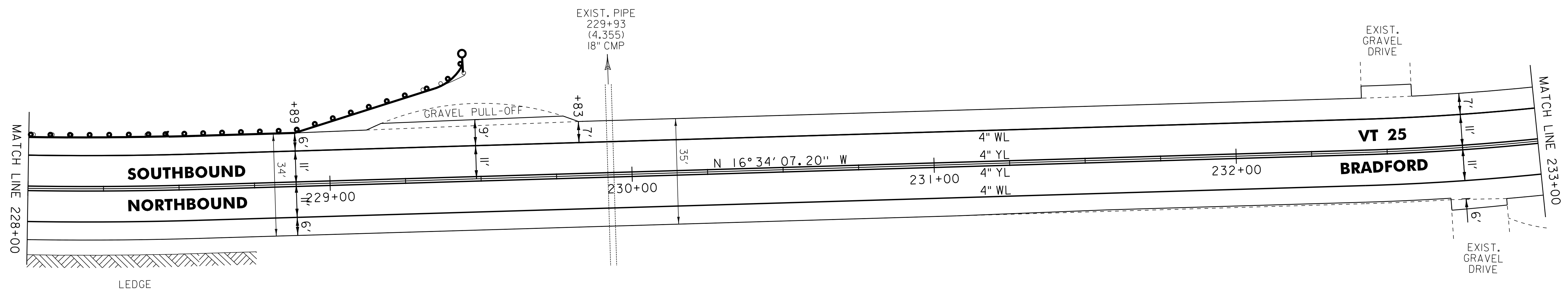
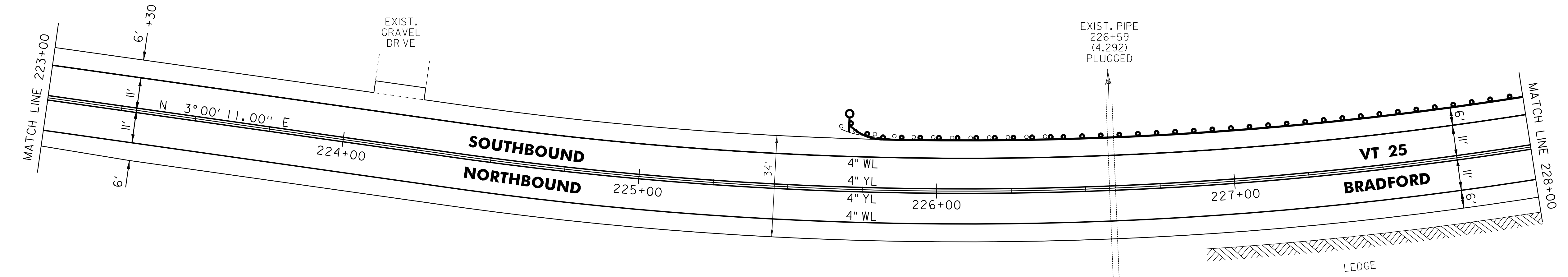

LEGEND

- R = REMOVE EXISTING
- S = SALVAGED
- R&S = REMOVE AND SALVAGE
- N = NEW
- RET = RETAIN
- B-B = BACK TO BACK
- = EXISTING GUARDRAIL
- = PROPOSED GUARDRAIL
- YL = YELLOW LINE
- WL = WHITE LINE
- = DELINEATOR
- ||||||| = RUMBLE STRIP

ROADWAY LAYOUT 27 VT 25

PROJECT NAME: BRADFORD

PROJECT NUMBER: STP 2917(I)

FILE NAME: p10b236.dgn

PROJECT LEADER: PTS

DESIGNED BY: NULL

IPARM FILE NAME: p10b236_68

PLOT DATE: 03-SEP-2014 12:51

DRAWN BY: SNG

CHECKED BY: PTS

SHEET 68 OF 105

NOT TO SCALE